

**NEW MEXICO OIL CONSERVATION COMMISSION
WELL LOCATION AND ACERAGE DEDICATION PLAT**

All distances must be from the outer boundaries of the Section

TENNECO OIL COMPANY

S.F.P.R.R.

"B"

1

71 JAN 25 1971

L 29 20 NORTH 10 WEST Mc KINLEY
1980 SOUTH 660 WEST
6392.0 Morrison Wildcat -80 40

1. Out of the acreage shown on the attached well location plat, how much is to be dedicated to the public?

2. How much of the acreage shown on the attached well location plat is to be dedicated to the public for working interest and royalty?

3. If a non-unit production is to be made, what is the estimated value of the production of all wells in the unit, and how much of the production is to be dedicated to the public for working interest and royalty?

4. If you are not a unit owner, what is the estimated value of the production of all wells in the unit, and how much of the production is to be dedicated to the public for working interest and royalty?

5. If answer is "No", list the owners and tract description, with acreage, and consolidate. (Use name of owner if necessary.)

No allowable will be assigned to the well until all interests have been consolidated. (By continuation, unitization, forced pooling, or otherwise, or under a non-standard unit, eliminating such interests, has been approved by the Commission.



CERTIFICATION

I hereby certify that the information contained herein is true and complete to the best of my knowledge and belief.

R. H. Ritchie

Name **R. H. Ritchie**

Position

District Office Supervisor

Company

TENNECO OIL COMPANY

Date

January 22, 1971

I hereby certify that the well location shown on this plat was plotted from field notes of actual surveys made by me or under my supervision, and that the same is true and correct to the best of my knowledge and belief.

19 January, 1971

James P. Lee

Registered Professional Engineer
and/or Land Surveyor

JAMES P. LEESE

1463

Certificate No

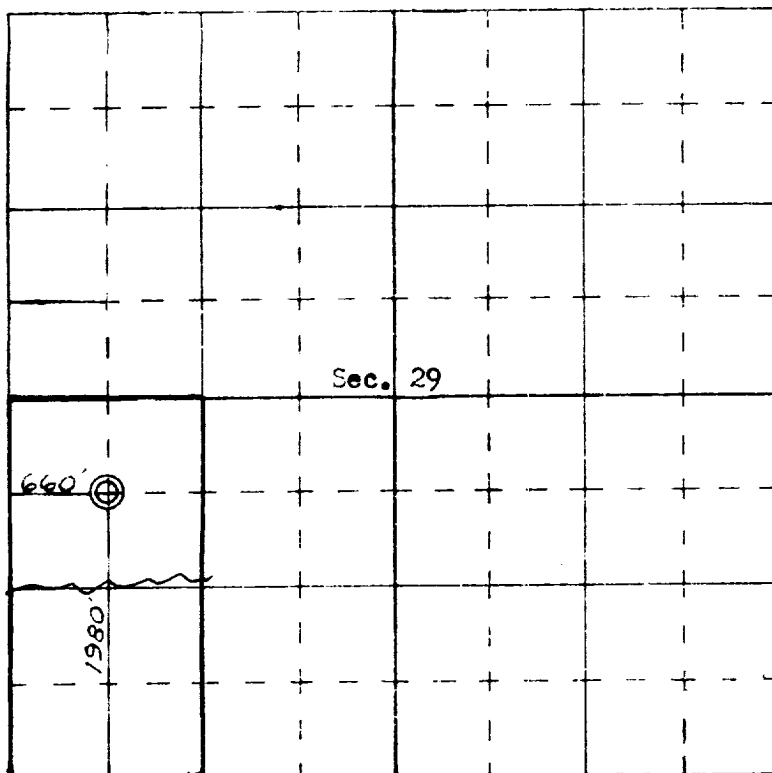

SCALE—4 INCHES EQUALS 1 MILE

SAN JUAN ENGINEERING COMPANY, FARMINGTON, N. M.