

NO. OF COPIES RECEIVED	5
DISTRIBUTION	
SANTA FE	1
FILE	1
U.S.G.S.	2
LAND OFFICE	
OPERATOR	1

NEW MEXICO OIL CONSERVATION COMMISSION

Form C-101

Revised 1-1-65 30-031-20-200

5A. Indicate Type of Lease	
STATE <input type="checkbox"/>	FEE <input checked="" type="checkbox"/>

5. State Oil & Gas Lease No.

APPLICATION FOR PERMIT TO DRILL, DEEPEN, OR PLUG BACK

1a. Type of Work				7. Unit Agreement Name	
b. Type of Well DRILL <input type="checkbox"/> DEEPEN <input type="checkbox"/> PLUG BACK <input type="checkbox"/> OIL WELL <input checked="" type="checkbox"/> GAS WELL <input type="checkbox"/> OTHER <input type="checkbox"/> SINGLE ZONE <input type="checkbox"/> MULTIPLE ZONE <input type="checkbox"/>				8. Farm or Lease Name SFP-RR "C"	
2. Name of Operator Tenneco Oil Company				9. Well No. 1	
3. Address of Operator Suite 1200 Lincoln Tower Building, Denver, Colorado 80203				10. Field and Pool, or Wildcat Wildcat	
4. Location of Well UNIT LETTER A LOCATED 980 FEET FROM THE North LINE AND 660 FEET FROM THE East LINE OF SEC. 9 TWP. 17N RGE. 7W NMPM				12. County McKinley	
19. Proposed Depth 3200'				19A. Formation Morrison	
20. Rotary or C.T. Rotary				21. Elevations (Show whether DF, RT, etc.) 6666 GR	
21A. Kind & Status Plug. Bond				21B. Drilling Contractor	
22. Approx. Date Work will start Upon Approval					

23.

PROPOSED CASING AND CEMENT PROGRAM

SIZE OF HOLE	SIZE OF CASING	WEIGHT PER FOOT	SETTING DEPTH	SACKS OF CEMENT	EST. TOP
12-1/4"	8-5/8	24	60	suff. to circ.	
7-7/8	5-1/2	15.5	3200	suff. to fill	
				500' above all prospective zones	

Above well to be a 3200' Morrison well. Well will be drilled to T.D. of 3200', logged, and if commercial production is indicated, casing will be run to T.D., perforated, and formation treated as necessary to establish commercial production. B.O.P. to be tested each 24 hours.

MAILED
FEB 12 1971
MAY 13 1971

CONFIDENTIAL



IN ABOVE SPACE DESCRIBE PROPOSED PROGRAM: IF PROPOSAL IS TO DEEPEN OR PLUG BACK, GIVE DATA ON PRESENT PRODUCTIVE ZONE AND PROPOSED NEW PRODUCTIVE ZONE. GIVE BLOWOUT PREVENTER PROGRAM, IF ANY.

I hereby certify that the information above is true and complete to the best of my knowledge and belief.

Signed G. A. Jant Title Sr. Production Clerk Date Feb 9, 1971

(This space for State Use)

APPROVED BY Emory Clavel TITLE Sr. Prod. Clerk DATE 2-12-71

CONDITIONS OF APPROVAL, IF ANY:

**NEW MEXICO OIL CONSERVATION COMMISSION
WELL LOCATION AND ACERAGE DEDICATION PLAT**

All distances must be from the outer boundaries of the Section

Operator **TENNECO OIL COMPANY** S.F.P.R.R. "C" Well No. **1**
Unit Owner Section Township Range County
A **9** **17 NORTH** **7 WEST** **Mc KINLEY**
Actual Section of Well 980 NORTH 660 East from the Line
6666.0 **Morrison** **Wildcat** **40** Acres

Other than the foregoing, the subject well be correct, correct or back-survey marks on the plat below

1. If more than one lease is dedicated to the well, outline each and describe the ownership thereof (both as to working interest and royalty).

2. If more than one lease or different ownership is dedicated to the well, have the interests of all owners been consolidated by communitization, unitization, force-pooling, etc?

3. Yes No If answer is "yes," type of consolidation

If answer is "no," list the owners and tract descriptions which have actually consolidated. (Use reverse side of this form if necessary)

No allowable will be attached to the well until all interests have been consolidated by communitization, unitization, forced-pooling, or otherwise, or until a non-stANDARD unit, eliminating such interests, has been approved by the Commission.



CERTIFICATION

I hereby certify that the information contained herein is true and complete to the best of my knowledge and belief.

G. A. Ford
Name **G. A. Ford**
Position **Sr. Production Clerk**
Company **Tenneco Oil Company**
Date **2-4-71**

I hereby certify that the well location shown on this plat was plotted from field notes of actual surveys made by me or under my supervision, and that the same is true and correct to the best of my knowledge and belief.

19 January, 1971
James P. Leese
Professional Engineer
and/or Land Surveyor
JAMES P. LEESE

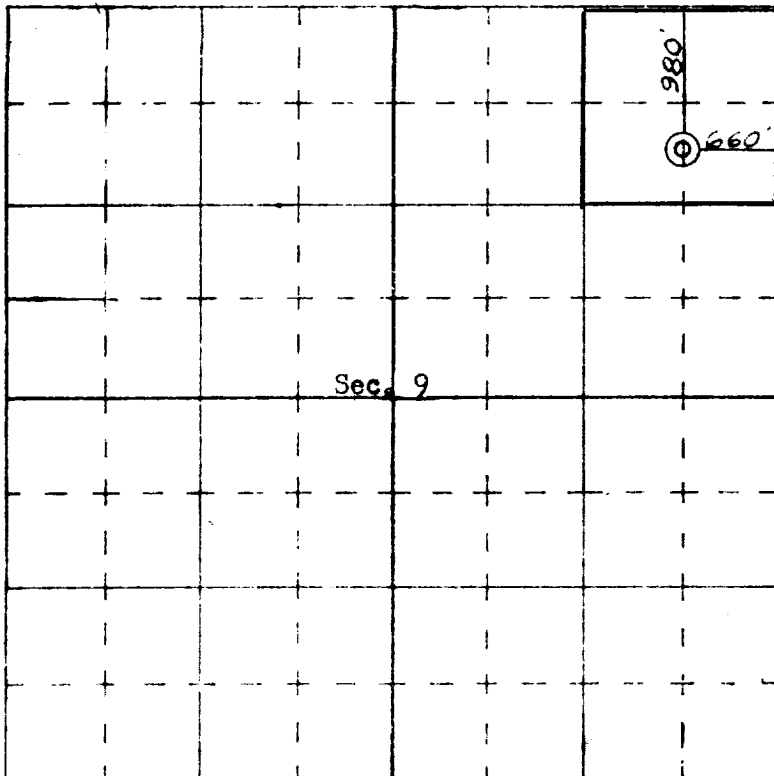

SCALE—4 INCHES EQUALS 1 MILE