

NO. OF COPIES RECEIVED	5
DISTRIBUTION	
SANTA FE	1
FILE	1
U.S.G.S.	2
LAND OFFICE	
OPERATOR	1

NEW MEXICO OIL CONSERVATION COMMISSION

Form C-101  
Revised 1-1-65 30-031-20201

5A. Indicate Type of Lease STATE <input type="checkbox"/> FEE <input checked="" type="checkbox"/>
5. State Oil & Gas Lease No.
7. Unit Agreement Name
8. Farm or Lease Name SFP-RR
9. Well No. 14
10. Field and Pool, or Wildcat Lone Pine Dakota "D"
12. County McKinley

APPLICATION FOR PERMIT TO DRILL, DEEPEN, OR PLUG BACK

1a. Type of Work DRILL <input checked="" type="checkbox"/> DEEPEN <input type="checkbox"/> PLUG BACK <input type="checkbox"/>
b. Type of Well OIL WELL <input checked="" type="checkbox"/> GAS WELL <input type="checkbox"/> OTHER <input type="checkbox"/> SINGLE ZONE <input type="checkbox"/> MULTIPLE ZONE <input type="checkbox"/>
2. Name of Operator Tenneco Oil Company
3. Address of Operator Suite 1200 Lincoln Tower Building, Denver, Colorado 80203
4. Location of Well UNIT LETTER K LOCATED 1650 FEET FROM THE South LINE AND 2310 FEET FROM THE West LINE OF SEC. 13 TWP. 17 RGE. 9 NMPM
19. Proposed Depth 3000
19A. Formation Dakota
20. Rotary or C.T. Rotary
21. Elevations (Show whether DF, RT, etc.) 6949 GR
21A. Kind & Status Plug. Bond
21B. Drilling Contractor Young Drilling Co.
22. Approx. Date Work will start Upon Approval

23. PROPOSED CASING AND CEMENT PROGRAM

SIZE OF HOLE	SIZE OF CASING	WEIGHT PER FOOT	SETTING DEPTH	SACKS OF CEMENT	EST. TOP
12-1/4	8-5/8	24	60	Suff. to circ.	
7-7/8	5-1/2	15.5	3000	Suff. to fill	
				500 ft. above	Hospah Sand

Above well to be a 3000' Lone Pine Dakota "D" Well.

Well will be drilled to T.D., Logged, and if commercial production is indicated, casing will be run to TD., perforated, and formation treated as necessary to establish commercial production.  
B.O.P. to be tested each 24 hours.

APPROVAL VALID  
FOR 90 DAYS UNLESS  
DRILLING COMMENCED,  
EXPIRES June 1, 1971



IN ABOVE SPACE DESCRIBE PROPOSED PROGRAM: IF PROPOSAL IS TO DEEPEN OR PLUG BACK, GIVE DATA ON PRESENT PRODUCTIVE ZONE AND PROPOSED NEW PRODUCTIVE ZONE. GIVE BLOWOUT PREVENTER PROGRAM, IF ANY.

I hereby certify that the information above is true and complete to the best of my knowledge and belief.  
Signed G. G. Ford Title Sr. Production Clerk Date 2-26-71

(This space for State Use)  
APPROVED BY A. R. Kendrick PETROLEUM ENGINEER DIST. NO. 8  
CONDITIONS OF APPROVAL, IF ANY: TITLE \_\_\_\_\_ DATE MAR 3 1971



**NEW MEXICO OIL CONSERVATION COMMISSION  
WELL LOCATION AND ACERAGE DEDICATION PLAT**

All distances must be from the outer boundaries of the Section

Operator <b>TENNECO OIL COMPANY</b>		S.F.P.R.R.		Well No. <b>14</b>
Unit Letter <b>K</b>	Section <b>13</b>	Township <b>17 NORTH</b>	Range <b>9 WEST</b>	County <b>Mc KINLEY</b>
Actual Footage Location of Well: <b>1650</b> feet from the <b>SOUTH</b> <b>2310</b> feet from the <b>WEST</b> line				
Ground Level Elev. <b>6949.0</b>	Producing Formation <b>Dakota</b>	Dedicated Acreage <b>80</b>		Acres

1. Outline the acreage dedicated to the subject well by colored pencil or hashure marks on the plat below.
2. If more than one lease is dedicated to the well, outline each and identify the ownership thereof (both as to working interest and royalty).
3. If more than one lease of different ownership is dedicated to the well, have the interests of all owners been consolidated by communitization, unitization, force-pooling, etc.

( ) Yes ( ) No If answer is "yes," type of consolidation \_\_\_\_\_

If answer is "no," list the owners and tract descriptions which have actually consolidated. (Use reverse side of this form if necessary.) \_\_\_\_\_

No allowable well be assigned to the well until all interests have been consolidated (by communitization, unitization, forced-pooling, or otherwise) or until a non standard unit, eliminating such interests, has been approved by the Commission.

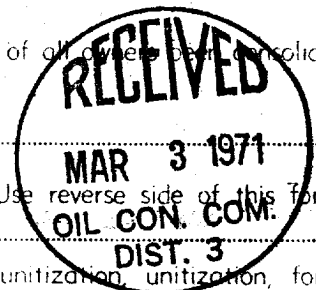

**CERTIFICATION**

I hereby certify that the information contained herein is true and complete to the best of my knowledge and belief.

Name *G. A. Ford*

Position **G. A. Ford**

Company **Sr. Production Clerk**

Company **Tenneco Oil Company**

Date **3/1/71**

I hereby certify that the well location shown on this plat was plotted from field notes of actual surveys made by me or under my supervision, and that the same is true and correct to the best of my knowledge and belief.

Date Surveyed **25 February, 1971**

*James P. Lense*  
Registered Professional Engineer  
and/or Land Surveyor

**JAMES P. LENSE**

**1463**  
Certificate No.

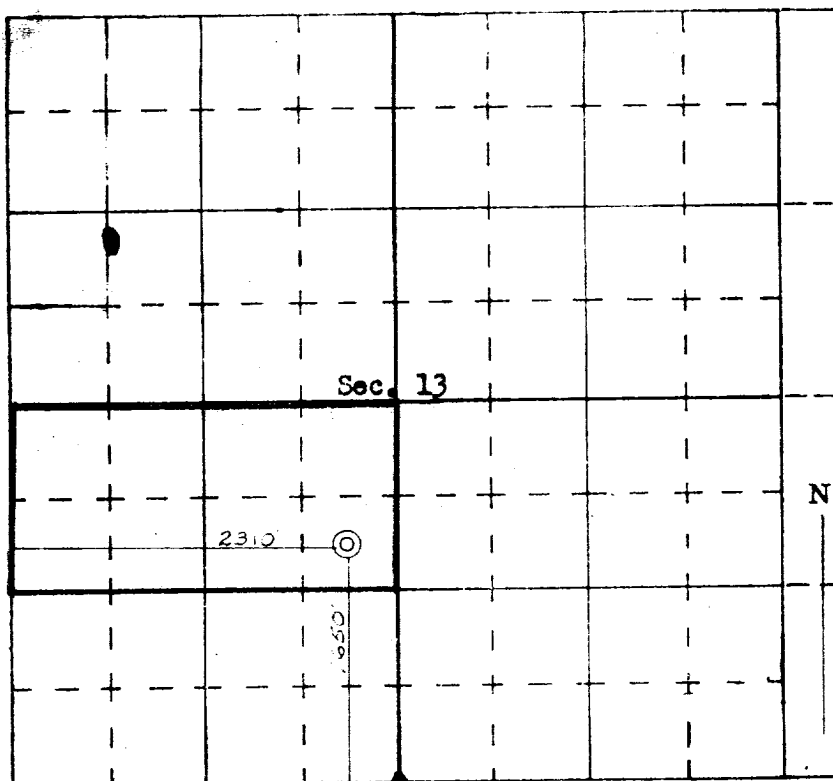

SCALE—4 INCHES EQUALS 1 MILE Found - Mc K

