

NEW MEXICO OIL CONSERVATION COMMISSION
WELL LOCATION AND ACREAGE DEDICATION PLAT

Form O-117
Supersedes O-128
Effective 1-1-65

All distances must be from the outer boundaries of the Section

Owner TESORO PETROLEUM CORPORATION			Lease Santa Fe Railroad		Well No. 28
Unit Letter H	Section 7	Township 17 North	Range 8 West	County McKinley	
Actual Rectangular Location of Well:					
2160	feet from the	North	line and	380	feet from the East line
Ground Level Elev. 6955	Producing Formation Dakota		Pool Lone Pine - Dakota "D"		Dedicated Acreage: 80 Acres

1. Outline the acreage dedicated to the subject well by colored pencil or hatchure marks on the plat below.

2. If more than one lease is dedicated to the well, outline each and identify the ownership thereof (both as to working interest and royalty).

3. If more than one lease of different ownership is dedicated to the well, have the interests of all owners been consolidated by communitization, unitization, force-pooling, etc?

☐ Yes ☐ No If answer is "yes," type of consolidation _____

If answer is "no," list the owners and tract descriptions which have actually been consolidated. (Use reverse side of this form if necessary.) _____

No allowable will be assigned to the well until all interests have been consolidated (by communitization, unitization, forced-pooling, or otherwise) or until a non-standard unit, eliminating such interests, has been approved by the Commission.

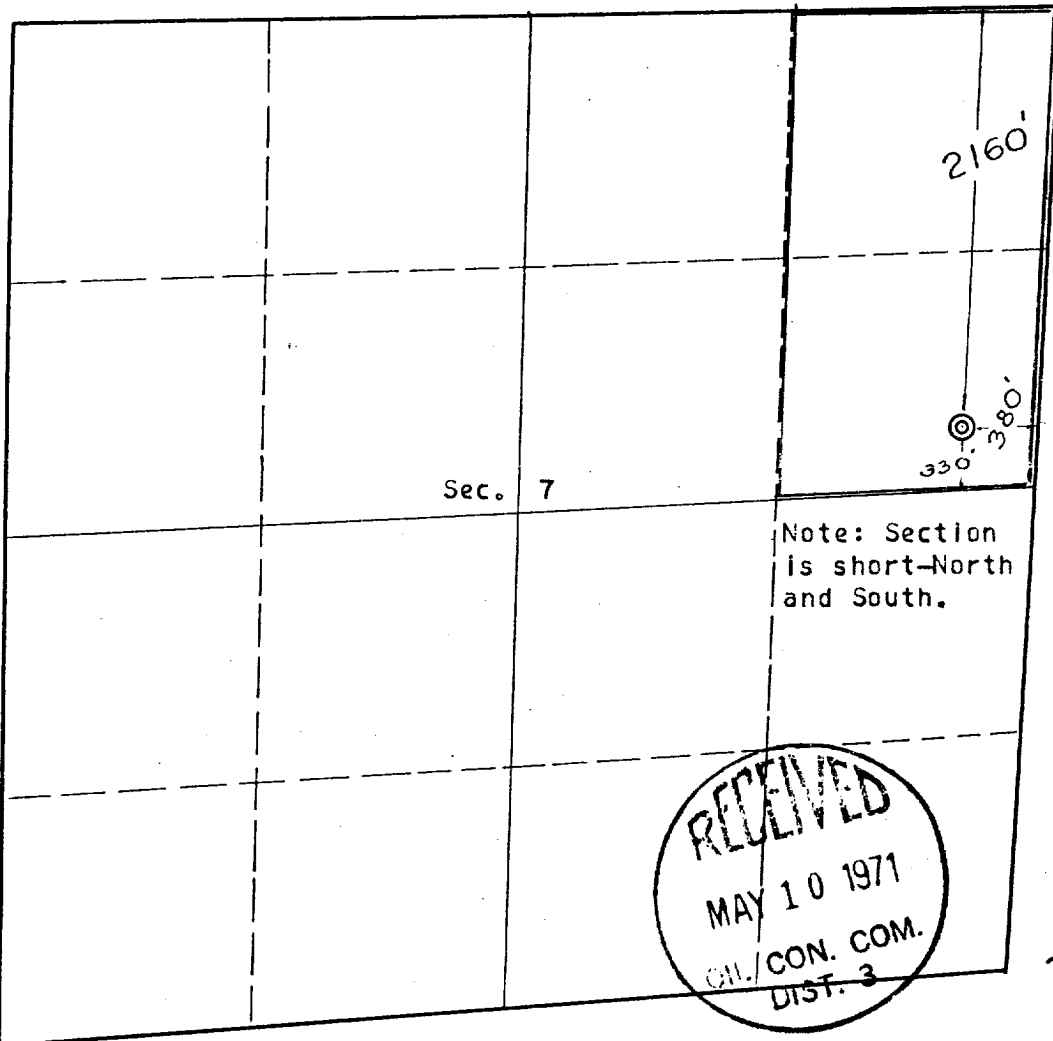

CERTIFICATION	
I hereby certify that the information contained herein is true and complete to the best of my knowledge and belief.	
Name	R. H. Denman
Position	Mgr. of Prod. Engineering
Company	TESORO PETROLEUM CORPORATION
Date	March 12, 1971
Date Surveyed	March 8, 1971
Registered Professional Engineer and/or Land Surveyor	
E. V. Echohawk	
Certificate No.	3602
E. V. Echohawk LS	