

NO. OF COPIES RECEIVED	5
DISTRIBUTION	
SANTA FE	1
FILE	1
U.S.G.S.	2
LAND OFFICE	
OPERATOR	1

NEW MEXICO OIL CONSERVATION COMMISSION

Form C-101
Revised 1-1-65 30-231-20217

5A. Indicate Type of Lease
STATE ☐ FEE ☒

5. State Oil & Gas Lease No.

APPLICATION FOR PERMIT TO DRILL, DEEPEN, OR PLUG BACK

1a. Type of Work b. Type of Well OIL WELL <input type="checkbox"/> GAS WELL <input type="checkbox"/> OTHER <input type="checkbox"/> SINGLE ZONE <input type="checkbox"/> MULTIPLE ZONE <input type="checkbox"/>		DRILL <input checked="" type="checkbox"/> DEEPEN <input type="checkbox"/> PLUG BACK <input type="checkbox"/>		7. Unit Agreement Name
2. Name of Operator DAVIS OIL COMPANY		3. Address of Operator 1230 Denver Club Building - Denver, Colorado 80202		8. Farm or Lease Name EL NARIZ
4. Location of Well UNIT LETTER <u>E</u> LOCATED <u>1250</u> FEET FROM THE <u>N</u> LINE AND <u>660</u> FEET FROM THE <u>W</u> LINE OF SEC. <u>19</u> TWP <u>16N</u> RGE. <u>10W</u> NMPM		9. Well No. #1		10. Field and Pool, or Wildcat Wildcat
21. Elevations (Show whether D.F., R.T., etc.)		21A. Kind & Status Plug. Bond Blanket		12. County McKinley
21B. Drilling Contractor Allison Drilling Co.		22. Approx. Date Work will start 10-19-71		

23.

PROPOSED CASING AND CEMENT PROGRAM

SIZE OF HOLE	SIZE OF CASING	WEIGHT PER FOOT	SETTING DEPTH	SACKS OF CEMENT	EST. TOP
12 1/4"	8 5/8"	24#	60'	cmd. to surf.	
If oil string is run, it will be 5 1/2" thru producing zone, cemented to displace 600'.					

LOGGING: Induction Electrical Survey and BHC Formation Density log with Gamma Ray from base of surface casing to total depth. BHC Sonic log with Caliper over the Dakota formation.

MUD PROGRAM: Fresh water native mud which will be converted to a 10 cc water loss or less chemical base mud for drilling the Dakota.

Good oil field practice will be used in determining the necessity of coring and/or drill stem testing any shows of oil or gas encountered.

APPROVAL VALID
FOR 90 DAYS UNLESS
DRILLING COMMENCED,

EXPIRES 1-27-72



Confidential

IN ABOVE SPACE DESCRIBE PROPOSED PROGRAM: IF PROPOSAL IS TO DEEPEN OR PLUG BACK, GIVE DATA ON PREVIOUS PRODUCTIVE ZONE AND PROPOSED NEW PRODUCTIVE ZONE. GIVE BLOWOUT PREVENTER PROGRAM, IF ANY.

I hereby certify that the information above is true and complete to the best of my knowledge and belief.

Signed [Signature] Title Geological Assistant Date 10-13-71

(This space for State Use)

APPROVED BY [Signature] TITLE SUPERVISOR DIST DATE OCT 29 1971

CONDITIONS OF APPROVAL, IF ANY:

NEW MEXICO OIL CONSERVATION COMMISSION

WELL LOCATION AND ACERAGE DEDICATION PLAT

All distances must be from the outer boundaries of the Section

Operator DAVIS OIL COMPANY		Lease EL NARIZ		Well No. 1	
Unit Letter E	Section 19	Township 16 NORTH	Range 10 WEST	County Mc KINLEY	
Actual Footage Location of Well: 1750 feet from the NORTH line and 660 feet from the WEST line					
Ground Level Elev. 6984.0		Producing Formation CRETACEOUS		Dedicated Acreage 40 Acres	
		Pool WILDCAT			

1. Outline the acreage dedicated to the subject well by colored pencil or hachure marks on the plat below.
 2. If more than one lease is dedicated to the well, outline each and identify the ownership thereof (both as to working interest and royalty).
 3. If more than one lease of different ownership is dedicated to the well, have the interests of all owners actually consolidated by communitization, unitization, force-pooling, etc?
- () Yes () No If answer is "yes," type of consolidation _____

If answer is "no," list the owners and tract descriptions which have actually consolidated. (Use reverse side of this form, if necessary.) _____

No allowable will be assigned to the well until all interests have been consolidated (by communitization, unitization, forced-pooling, or otherwise) or until a non standard unit, eliminating such interests, has been approved by the Commission.

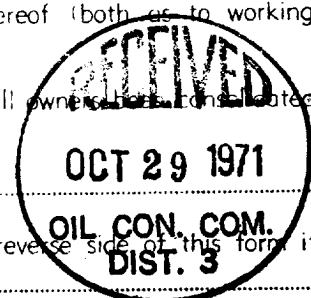

CERTIFICATION

I hereby certify that the information contained herein is true and complete to the best of my knowledge and belief.

Shelia Bergamo
Name
Geological Assistant
Position
Davis Oil Company
Company
10-27-71
Date

I hereby certify that the well location shown on this plat was plotted from field notes of actual surveys made by me or under my supervision, and that the same is true and correct to the best of my knowledge and belief.

14 October, 1971
Date Surveyed:
[Signature]
Registered Professional Engineer
and/or Land Surveyor
JAMES P. LEESE
1463
Certificate No.

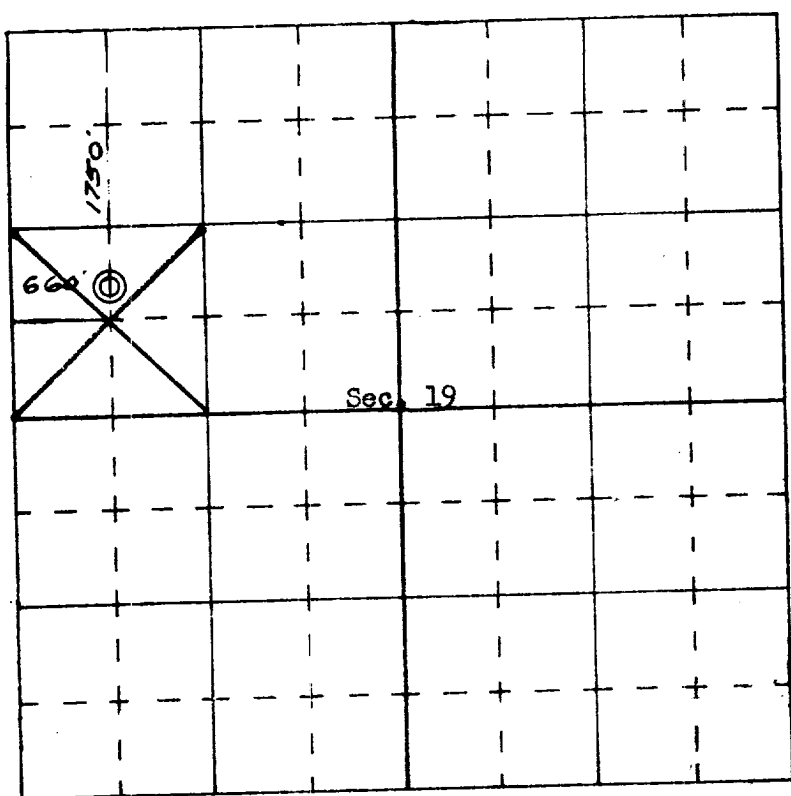

SCALE—4 INCHES EQUALS 1 MILE