

NO. OF COPIES RECEIVED	5
DISTRIBUTION	
SANTA FE	1
FILE	1
U.S.G.S.	2
LAND OFFICE	
OPERATOR	1

NEW MEXICO OIL CONSERVATION COMMISSION

Form C-101
Revised 1-1-65 30-031-20234

5A. Indicate Type of Lease	
STATE <input type="checkbox"/>	FEE <input checked="" type="checkbox"/>
5. State Oil & Gas Lease No.	
7. Unit Agreement Name	
8. Farm or Lease Name	
Fernandez	
9. Well No.	
3	
10. Field and Pool, or Wildcat	
Wildcat	
12. County	
McKinley	
19. Proposed Depth	19A. Formation
1600	Gallup
20. Rotary or C.T.	
Rotary	
21. Elevations (Show whether DF, RT, etc.)	21A. Kind & Status Plug. Bond
6803	Statewide
21B. Drilling Contractor	22. Approx. Date Work will start
Stewart Bros.	Upon Approval

APPLICATION FOR PERMIT TO DRILL, DEEPEN, OR PLUG BACK

1a. Type of Work	
b. Type of Well	
DRILL <input checked="" type="checkbox"/>	DEEPEN <input type="checkbox"/>
OIL WELL <input type="checkbox"/>	GAS WELL <input type="checkbox"/>
OTHER <input type="checkbox"/>	
2. Name of Operator	
Northern Minerals, Inc.,	
3. Address of Operator	
143 Rio Vista Place, Santa Fe, New Mexico 87501	
4. Location of Well	
UNIT LETTER <u>O</u>	LOCATED <u>440'</u>
FEET FROM THE <u>South</u> LINE	
AND <u>2100'</u>	FEET FROM THE <u>East</u> LINE OF SEC. <u>6</u>
TWP. <u>14N</u> RGE. <u>7W</u> NMPM	
21. Elevations (Show whether DF, RT, etc.)	
6803	
21A. Kind & Status Plug. Bond	
Statewide	
21B. Drilling Contractor	
Stewart Bros.	
22. Approx. Date Work will start	
Upon Approval	

PROPOSED CASING AND CEMENT PROGRAM

SIZE OF HOLE	SIZE OF CASING	WEIGHT PER FOOT	SETTING DEPTH	SACKS OF CEMENT	EST. TOP
9"	7"	20 lb.	34'	Suff. to Circ.	
6 1/2"	4 1/2"	9 1/2 lb.	1600	Suff. to cover	
				500' above	Upper Hospah sand.

This well will be a 1600' Gallup sand wildcat well. 5" hole will be drilled to total depth, logged and, if commercial production is indicated, hole will be reamed out to 6 1/2", casing will be run to total depth, perforated and treated as necessary to establish commercial production.

APPROVAL VALID
FOR 90 DAYS UNLESS
DRILLING COMMENCED,

EXPIRES 6-5-72



IN ABOVE SPACE DESCRIBE PROPOSED PROGRAM: IF PROPOSAL IS TO DEEPEN OR PLUG BACK, GIVE DATA ON PRESENT PRODUCTIVE ZONE. GIVE BLOWOUT PREVENTER PROGRAM, IF ANY.

I hereby certify that the information above is true and complete to the best of my knowledge and belief.

Signed Leoyd Davidson Title President Date 3-3-72
(This space for State Use)

APPROVED BY Ernest Lewis TITLE SUPERVISOR DIST. 3 DATE MAR 6 1972
CONDITIONS OF APPROVAL, IF ANY:



NEW MEXICO OIL CONSERVATION COMMISSION
WELL LOCATION AND ACREAGE DEDICATION PLAT

Form C-102
Supersedes C-128
Effective 1-1-65

All distances must be from the outer boundaries of the Section.

Operator NORTHERN MINERALS INCORPORATED		Lease Fernandez		Well No. 3	
Unit Letter C	Section 6	Township 14 North	Range 7 West	County McKinley	
Actual Footage Location of Well: 440 feet from the South line and 2100 feet from the East line					
Ground Level Elev. 6803	Production Wildcat	Pool		Dedicated acreage: 40	Acres

1. Outline the acreage dedicated to the subject well by colored pencil or hachure marks on the plat below.
2. If more than one lease is dedicated to the well, outline each and identify the ownership thereof (both as to working interest and royalty).
3. If more than one lease of different ownership is dedicated to the well, have the interests of all leases be consolidated by communitization, unitization, force-pooling, etc?

☐ Yes ☐ No If answer is "yes," type of consolidation _____

If answer is "no," list the owners and tract descriptions which have actually been consolidated. (Reverse side of this form if necessary.) _____

No allowable will be assigned to the well until all interests have been consolidated (by communitization, unitization, forced-pooling, or otherwise) or until a non-standard unit, eliminating such interests, has been approved by the Commission.

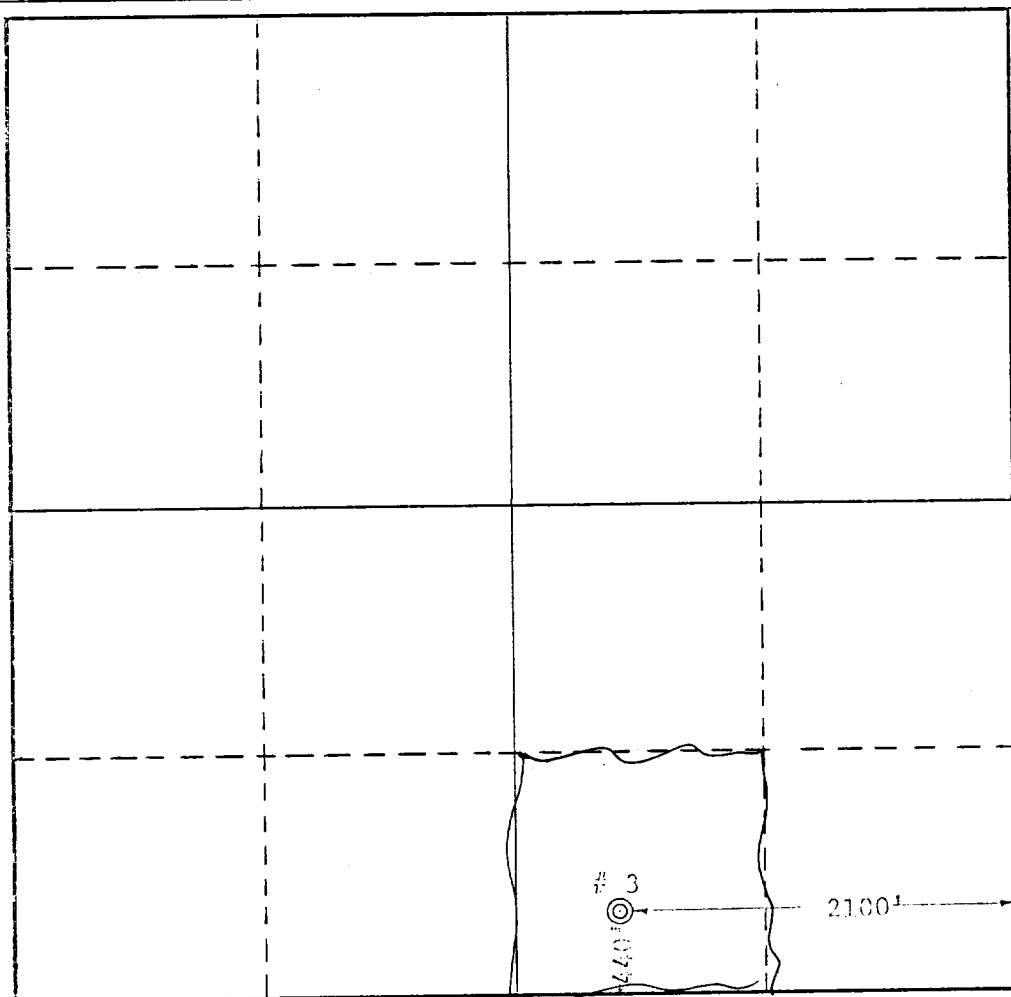
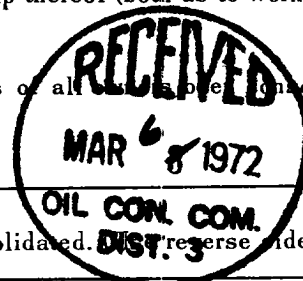

CERTIFICATION

I hereby certify that the information contained herein is true and complete to the best of my knowledge and belief.

Name **Lloyd Davidson**

Position **President**

Company **Northern Minerals, Inc.**

Date **3-3-72**

I hereby certify that the well location shown on this plat was plotted from field notes of actual surveys made by me or under my supervision, and that the same is true and correct to the best of my knowledge and belief.

Date Surveyed
February 28, 1972

Registered Professional Engineer
and/or Land Surveyor

Fred D. Mannon

Certificate No.
2031

