

NO. OF COPIES RECEIVED	5
DISTRIBUTION	
SANTA FE	1
FILE	1
U.S.G.S.	2
LAND OFFICE	
OPERATOR	1

# NEW MEXICO OIL CONSERVATION COMMISSION

Form C-101  
Revised 1-1-65 30-031-20255

5A. Indicate Type of Lease	
STATE <input type="checkbox"/>	FEE <input checked="" type="checkbox"/>
5. State Oil & Gas Lease No.	

## APPLICATION FOR PERMIT TO DRILL, DEEPEN, OR PLUG BACK

1a. Type of Work		7. Unit Agreement Name	
b. Type of Well OIL WELL <input checked="" type="checkbox"/> GAS WELL <input type="checkbox"/> OTHER <input type="checkbox"/>		Castillo	
DRILL <input checked="" type="checkbox"/> DEEPEN <input type="checkbox"/> PLUG BACK <input type="checkbox"/>		8. Farm or Lease Name	
SINGLE ZONE <input type="checkbox"/> MULTIPLE ZONE <input type="checkbox"/>		Tenneco Castillo	
2. Name of Operator		9. Well No.	
Eastern Petroleum Company		1	
3. Address of Operator		10. Well and Pool, or Wildcat	
P. O. Box 226, Farmington, New Mexico 87401		Wildcat-Dakota	
4. Location of Well		12. County	
UNIT LETTER <u>P</u> LOCATED <u>660</u> FEET FROM THE <u>south</u> LINE		McKinley	
AND <u>660</u> FEET FROM THE <u>east</u> LINE OF SEC. <u>35</u> TWP. <u>20N</u> RGE. <u>7W</u> NMPM			
19. Proposed Depth		19A. Formation	
4500		Dakota	
21. Elevations (Show whether DE, RT, etc.)		Rotary or C.T.	
6675 GL		Rotary	
21A. Kind & Status Plug. Bond		22. Approx. Date Work will start -	
Blanket		May 21, 1972	
21B. Drilling Contractor			
Coleman - Andes			

## PROPOSED CASING AND CEMENT PROGRAM

SIZE OF HOLE	SIZE OF CASING	WEIGHT PER FOOT	SETTING DEPTH	SACKS OF CEMENT	EST. TOP
12"	9 5/8	34#	60ft.	40 sks.	+6672
7 7/8	4 1/2	9.5#	4500	125 sks.	+6675

Propose to drill and test the Dakota Sandstone. If productive - will set and cement 4 1/2 csg.

APPROVED FOR 90 DAYS TESTING  
DURING COMPLETION  
EXPIRES 8-9-72

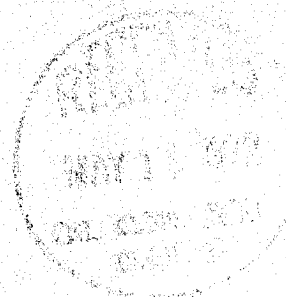

IN ABOVE SPACE DESCRIBE PROPOSED PROGRAM; IF PROPOSAL IS TO DEEPEN OR PLUG BACK, GIVE DATA ON PRESENT PRODUCTIVE ZONE AND PROPOSED NEW PRODUCTIVE ZONE. GIVE BLOWOUT PREVENTER PROGRAM, IF ANY.

I hereby certify that the information above is true and complete to the best of my knowledge and belief.

Signed Robert C. Sullips Title Vice President Date 5-09-72

(This space for State Use)

APPROVED BY Emmy L. Lueders TITLE SECRETARY DATE MAY 11 1972

CONDITIONS OF APPROVAL, IF ANY:

**NEW MEXICO OIL CONSERVATION COMMISSION  
WELL LOCATION AND ACREAGE DEDICATION PLAT**

Form C-102  
Supersedes C-128  
Effective 1-1-65

All distances must be from the outer boundaries of the Section.

Operator <b>Eastern Petroleum Co.</b>			Lease <b>Castillo</b>		Well No. <b>2</b>
Unit Letter	Section <b>35</b>	Township <b>20 N</b>	Range <b>7 W</b>	County <b>McKinley</b>	
Actual Footage Location of Well: <b>660</b> feet from the <b>South</b> line and <b>660</b> feet from the <b>East</b> line					
Ground Level Elev. <b>6675</b>	Producing Formation <b>Dak</b>		Pool <b>WC</b>		Dedicated Acreage: <b>40</b> Acres

1. Outline the acreage dedicated to the subject well by colored pencil or hachure marks on the plat below.
2. If more than one lease is dedicated to the well, outline each and identify the ownership thereof (both as to working interest and royalty).
3. If more than one lease of different ownership is dedicated to the well, have the interests of all owners been consolidated by communitization, unitization, force-pooling, etc?

☐ Yes    ☐ No    If answer is "yes," type of consolidation \_\_\_\_\_

If answer is "no," list the owners and tract descriptions which have actually been consolidated. (Use reverse side of this form if necessary.) \_\_\_\_\_

No allowable will be assigned to the well until all interests have been consolidated (by communitization, unitization, forced-pooling, or otherwise) or until a non-standard unit, eliminating such interests, has been approved by the Commission.

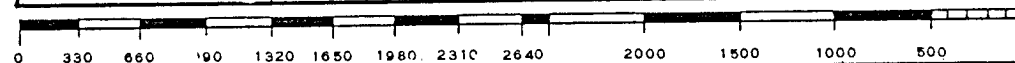
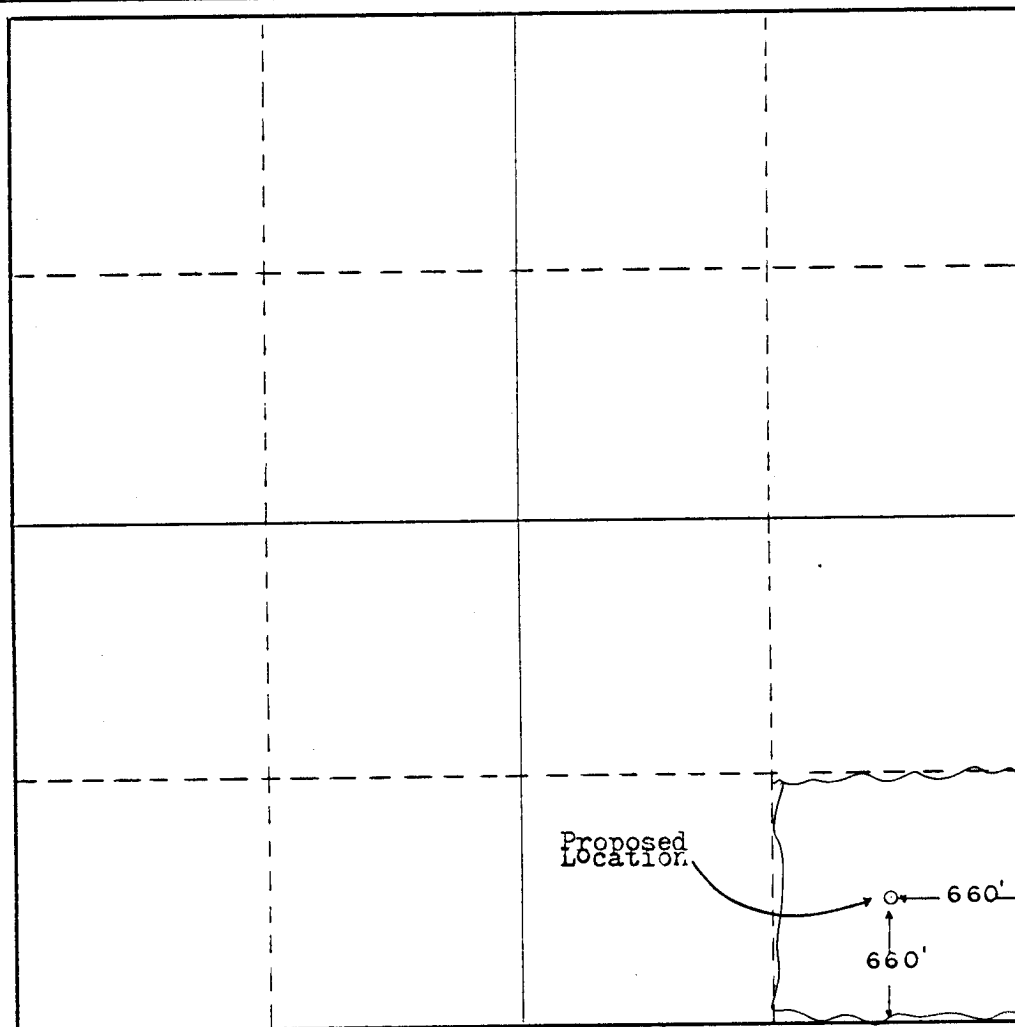

**CERTIFICATION**

I hereby certify that the information contained herein is true and complete to the best of my knowledge and belief.

Name **Robert G. Eulys**  
 Position **Vice President**  
 Company **Eastern Petroleum Company**  
 Date **5-15-72**

I hereby certify that the well location shown on this plat was plotted from field notes of actual surveys made by me or under my supervision, and that the same is true and correct to the best of my knowledge and belief.

**May 2, 1972**

Date Surveyed **Frederick H. Reed**  
 Registered Professional Engineer  
 and/or Land Surveyor

**3795**

Certificate No.

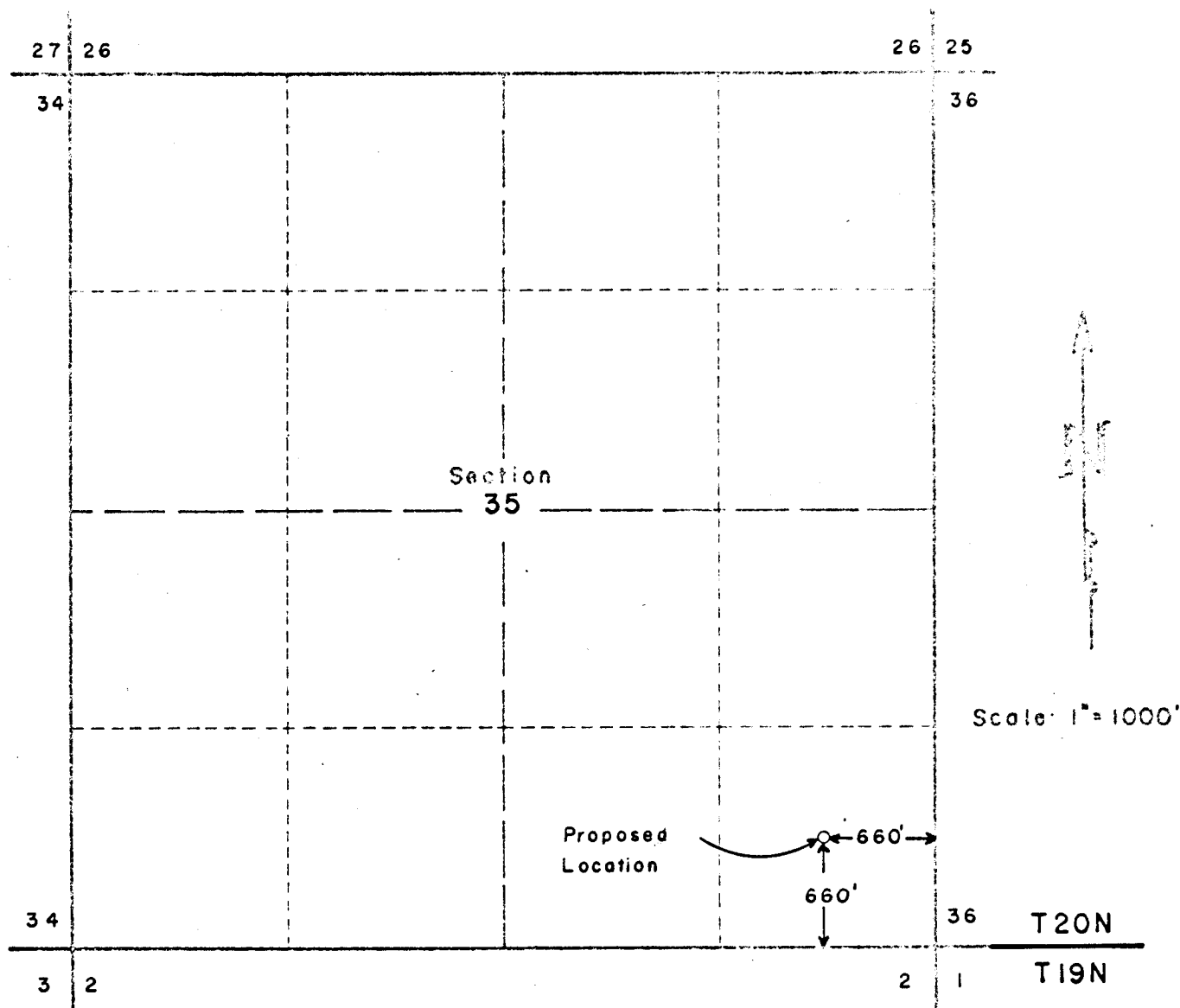

**WELL LOCATION: EASTERN PETROLEUM CO. NO. 1 CASTILLO**

Located 660 feet North of the South line and 660 feet West of the East line of Section 35  
 Township 20 North Range 7 West of the New Mexico Principal Meridian

Existing ground elevation determined at 6675 feet based on U. S. G. S. Datum

McKinley County, New Mexico

I hereby certify the above plat represents a survey  
 made under my supervision and that it is accurate  
 to the best of my knowledge and belief

*Frederick H. Reed*

FREDERICK H. REED  
 Registered Land Surveyor

New Mexico No. 3795

EASTERN PETROLEUM CO.  
 Carmi, Illinois

**WELL LOCATION PLAT**  
**SEC. 35, T20N, R7W, NMPM**  
**McKinley County, N. M.**

CLARK-REED & ASSOC.  
 Durango, Colorado

DATE: May 2, 1972  
 FILE NO 72038