

NO. OF COPIES RECEIVED	5
DISTRIBUTION	
SANTA FE	1
FILE	1
U.S.G.S.	2
LAND OFFICE	
OPERATOR	1

NEW MEXICO OIL CONSERVATION COMMISSION

Form C-101
Revised 1-1-65 30-031-20262

5A. Indicate Type of Lease	
STATE <input type="checkbox"/>	FEE <input checked="" type="checkbox"/>
5. State Oil & Gas Lease No.	

APPLICATION FOR PERMIT TO DRILL, DEEPEN, OR PLUG BACK

1a. Type of Work				7. Unit Agreement Name	
b. Type of Well DRILL <input checked="" type="checkbox"/> DEEPEN <input type="checkbox"/> PLUG BACK <input type="checkbox"/> OIL WELL <input type="checkbox"/> GAS WELL <input type="checkbox"/> OTHER <input type="checkbox"/> SINGLE ZONE <input checked="" type="checkbox"/> MULTIPLE ZONE <input type="checkbox"/>				8. Farm or Lease Name Fernandez Co.	
2. Name of Operator Northern Minerals, Inc.				9. Well No. 6	
3. Address of Operator 220 Otero Street, Santa Fe, New Mexico 87501				10. Field and Pool, or Wildcat Wildcat	
4. Location of Well UNIT LETTER F LOCATED 1650' FEET FROM THE North LINE AND 1650' FEET FROM THE West LINE OF SEC. 8 TWP. 14N RGE. 7W NMPM				12. County McKinley	
21. Elevations (Show whether DF, RT, etc.) 6823 G. L.				22. Approx. Date Work will start Upon Approval	
21A. Kind & Status Plug. Bond Statewide		21B. Drilling Contractor Stewart Bros.		20. Rotary or C.T. Rotary	
19. Proposed Depth 1700		19A. Formation Gallup		20. Rotary or C.T. Rotary	

PROPOSED CASING AND CEMENT PROGRAM

SIZE OF HOLE	SIZE OF CASING	WEIGHT PER FOOT	SETTING DEPTH	SACKS OF CEMENT	EST. TOP
9"	7"	20 lb.	30'	Suff to Circ.	
6 1/2"	4 1/2"	9 1/2 lb.	1600'	Suff to cover	
				500' above Upper Hoshah	

This well will be a 1700' Gallup wildcat well. 5" hole will be drilled to total depth, logged and, if commercial production is indicated, hole will be reamed out to 6 1/2", casing will be run to total depth, perforated and treated as necessary to establish commercial production.

APPROVAL VALID
FOR 90 DAYS UNLESS
DRILLING COMMENCED,
EXPIRES 9-25-72



IN ABOVE SPACE DESCRIBE PROPOSED PROGRAM: IF PROPOSAL IS TO DEEPEN OR PLUG BACK, GIVE DATA ON PRESENT PRODUCTIVE ZONE AND PROPOSED NEW PRODUCTIVE ZONE. GIVE BLOWOUT PREVENTER PROGRAM, IF ANY.

I hereby certify that the information above is true and complete to the best of my knowledge and belief.

Signed Clayton Davidson Title President Date 6-24-72
(This space for State Use)

APPROVED BY Ernest Chavez TITLE SUPERVISOR DIST. #3 DATE JUN 27 1972
CONDITIONS OF APPROVAL, IF ANY:

NEW MEXICO OIL CONSERVATION COMMISSION
WELL LOCATION AND ACREAGE DEDICATION PLAT

Form C-102
Supersedes C-128
Effective 1-1-65

All distances must be from the outer boundaries of the Section.

Operator Northern Minerals, Inc.		Lease Fernandez Co.		Well No. No. 6	
Unit Letter F	Section 8	Township 14 North	Range 7 West	County McKinley	
Actual Footage Location of Well:					
1650 feet from the North line and		1650 feet from the West line			
Ground Level Elev. 6823	Producing Formation Wildcat	Pool	Dedicated Acreage: 40 Acres		

1. Outline the acreage dedicated to the subject well by colored pencil or hachure marks on the plat below.
2. If more than one lease is dedicated to the well, outline each and identify the ownership thereof (as to working interest and royalty).
3. If more than one lease of different ownership is dedicated to the well, have the interests of all owners been consolidated by communitization, unitization, force-pooling, etc?

☐ Yes ☐ No If answer is "yes," type of consolidation _____

If answer is "no," list the owners and tract descriptions which have actually been consolidated. (Use reverse side of this form if necessary.) _____

No allowable will be assigned to the well until all interests have been consolidated (by communitization, unitization, forced-pooling, or otherwise) or until a non-standard unit, eliminating such interests, has been approved by the Commission.

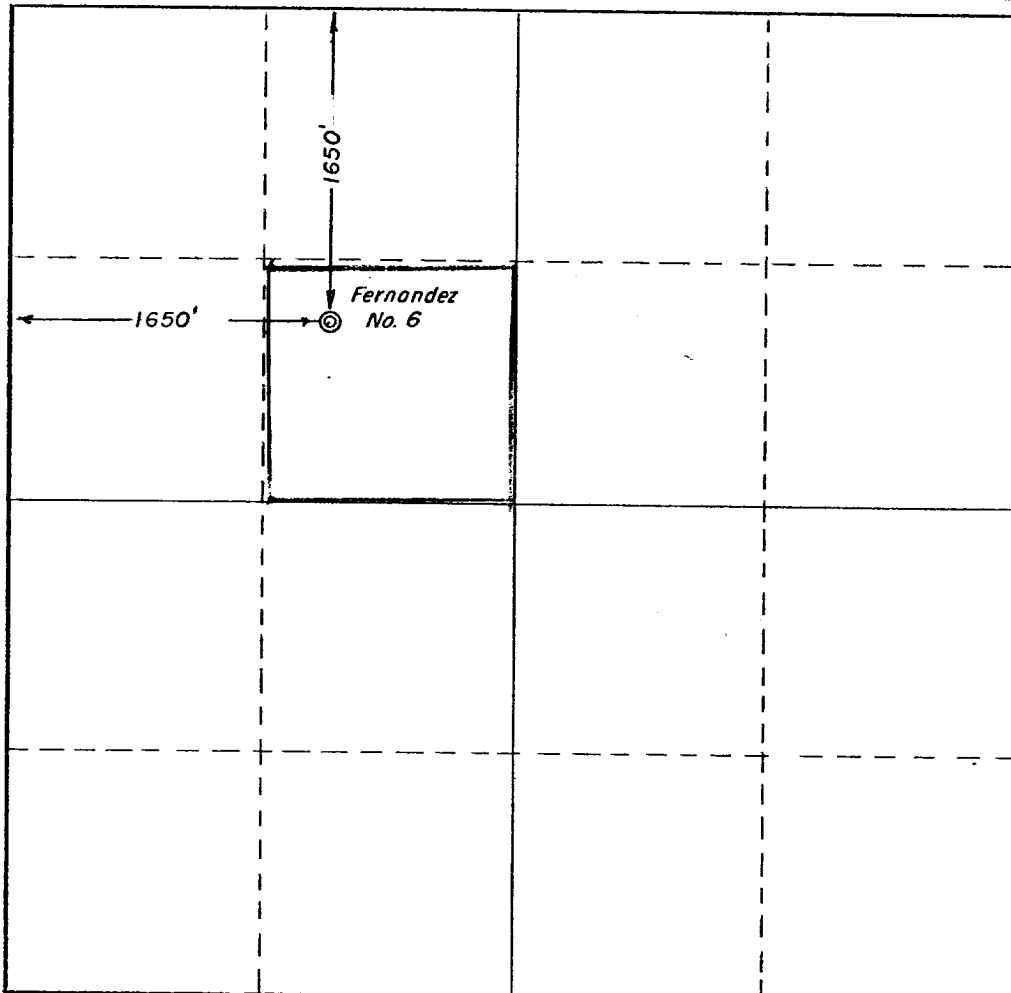
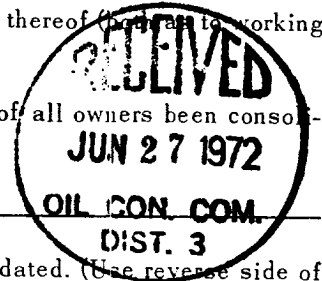

CERTIFICATION

I hereby certify that the information contained herein is true and complete to the best of my knowledge and belief.

Lloyd Davidson
Name

Lloyd Davidson

Position
President

Company
Northern Minerals, Inc.

Date
6-24-72

I hereby certify that the well location shown on this plat was plotted from field notes of actual surveys made by me or under my supervision, and that the same is true and correct to the best of my knowledge and belief.

Date Surveyed

June 19 1972

Registered Professional Engineer
and/or Land Surveyor

Ray D. Morrow

Certificate No.

2031

NO. OF COPIES RECEIVED	5
DISTRIBUTION	
SANTA FE	1
FILE	1
U.S.G.S.	2
LAND OFFICE	
OPERATOR	1

Form C-105
Revised 1-1-65

NEW MEXICO OIL CONSERVATION COMMISSION WELL COMPLETION OR RECOMPLETION REPORT AND LOG

5a. Indicate Type of Lease	
State <input type="checkbox"/>	Fee <input checked="" type="checkbox"/>
5. State Oil & Gas Lease No.	

1a. TYPE OF WELL		OIL WELL <input type="checkbox"/>		GAS WELL <input type="checkbox"/>		DRY <input checked="" type="checkbox"/>		OTHER <input type="checkbox"/>	
b. TYPE OF COMPLETION		NEW WELL <input type="checkbox"/>		WORK OVER <input type="checkbox"/>		DEEPEN <input type="checkbox"/>		PLUG BACK <input type="checkbox"/>	
				DIFF. RESVR. <input type="checkbox"/>		OTHER		P & A	
2. Name of Operator									
Northern Minerals, Inc.									
3. Address of Operator									
220 Otero Street, Santa Fe, New Mexico 87501									
4. Location of Well									
UNIT LETTER F LOCATED 1650 FEET FROM THE North LINE AND 1650 FEET FROM									
THE West LINE OF SEC. 8 TWP. 14N RGE. 7W NMPM									
15. Date Spudded		16. Date T.D. Reached		17. Date Compl. (Ready to Prod.)		18. Elevations (DF, RKB, RT, GR, etc.)		19. Elev. Casinghead	
7-3-72		7-7-72		7-10-72		6823' G. L.		6825'	
20. Total Depth		21. Plug Back T.D.		22. If Multiple Compl., How Many		23. Intervals Drilled By		Rotary Tools	
1655'		-		-		All		Cable Tools	
24. Producing Interval(s), of this completion - Top, Bottom, Name									25. Was Directional Survey Made
									No
26. Type Electric and Other Logs Run									27. Was Well Cored
Spontaneous Potential, Resistivity, Gamma Ray									No
28. CASING RECORD (Report all strings set in well)									
CASING SIZE	WEIGHT LB./FT.	DEPTH SET	HOLE SIZE	CEMENTING RECORD			AMOUNT PULLED		
7"	20	22'	9"	Cement Circulated			None		
29. LINER RECORD									
SIZE	TOP	BOTTOM	SACKS CEMENT	SCREEN	30. TUBING RECORD				
					SIZE	DEPTH SET	PACKER SET		
31. Perforation Record (Interval, size and number)					32. ACID, SHOT, FRACTURE, CEMENT, GUN SIZE, ETC.				
					DEPTH INTERVAL				
					AMOUNT AND KIND OF MATERIAL USED				
33. PRODUCTION									
Date First Production		Production Method (Flowing, gas lift, pumping - Size and type pump)							
		Well Status (Prod. or Shut-in)							
Date of Test		Hours Tested	Choke Size	Prod'n. For Test Period	Oil - Bbl.	Gas - MCF	Water - Bbl.	Gas - Oil Ratio	
Flow Tubing Press.		Casing Pressure	Calculated 24-Hour Rate	Oil - Bbl.	Gas - MCF	Water - Bbl.	Oil Gravity - API (Corr.)		
34. Disposition of Gas (Sold, used for fuel, vented, etc.)							Test Witnessed By		
35. List of Attachments									
36. I hereby certify that the information shown on both sides of this form is true and complete to the best of my knowledge and belief.									
SIGNED <u>Lloyd Davidson</u> TITLE <u>President</u> DATE <u>7-20-72</u>									

Lloyd Davidson

INSTRUCTIONS

This form is to be filed with the appropriate District Office of the Commission not later than 20 days after the completion of any newly-drilled or deepened well. It shall be accompanied by one copy of all electrical and radio-activity logs run on the well and a summary of all special tests conducted, including drill stem tests. All depths reported shall be measured depths. In the case of directionally drilled wells, true vertical depths shall also be reported. For multiple completions, Items 30 through 34 shall be reported for each zone. The form is to be filed in quintuplicate except on state land, where six copies are required. See Rule 1105.

INDICATE FORMATION TOPS IN CONFORMANCE WITH GEOGRAPHICAL SECTION OF STATE

Southeastern New Mexico

Northwestern New Mexico

T. Anhy _____	T. Canyon _____	T. Ojo Alamo _____	T. Penn. "B" _____
T. Salt _____	T. Strawn _____	T. Kirtland-Fruitland _____	T. Penn. "C" _____
B. Salt _____	T. Atoka _____	T. Pictured Cliffs _____	T. Penn. "D" _____
T. Yates _____	T. Miss _____	T. Cliff House _____	T. Leadville _____
T. 7 Rivers _____	T. Devonian _____	T. Menefee _____	T. Madison _____
T. Queen _____	T. Silurian _____	T. Point Lookout _____	T. Elbert _____
T. Grayburg _____	T. Montoya _____	T. Mancos _____	T. McCracken _____
T. San Andres _____	T. Simpson _____	T. Gallup _____	T. Ignacio Qtzte _____
T. Glorieta _____	T. McKee _____	Base Greenhorn _____	T. Granite _____
T. Paddock _____	T. Ellenburger _____	T. Dakota _____	T. _____
T. Blinebry _____	T. Gr. Wash _____	T. Morrison _____	T. _____
T. Tubb _____	T. Granite _____	T. Todilto _____	T. _____
T. Drinkard _____	T. Delaware Sand _____	T. Entrada _____	T. _____
T. Abo _____	T. Bone Springs _____	T. Wingate _____	T. _____
T. Wolfcamp _____	T. _____	T. Chinle _____	T. _____
T. Penn. _____	T. _____	T. Permian _____	T. _____
T. Cisco (Bough C) _____	T. _____	T. Penn. "A" _____	T. _____

FORMATION RECORD (Attach additional sheets if necessary)

From	To	Thickness in Feet	Formation	From	To	Thickness in Feet	Formation
0	280	280	Menefee				
280	648	368	Point Lookout				
648	1462	814	Crevasse Canyon				
1462	1564	102	Hospah Gallup				
1564	1648	84	Massive Gallup				
1648	1655	7	Lower Mancos				
1655	Total	Depth					

NO. OF COPIES RECEIVED	5
DISTRIBUTION	
SANTA FE	1
FILE	1
U.S.G.S.	
LAND OFFICE	
OPERATOR	3

NEW MEXICO OIL CONSERVATION COMMISSION

Form C-103
Supersedes Old
C-102 and C-103
Effective 1-1-65

5a. Indicate Type of Lease	
State <input type="checkbox"/>	Fee <input checked="" type="checkbox"/>
5. State Oil & Gas Lease No.	

SUNDRY NOTICES AND REPORTS ON WELLS (DO NOT USE THIS FORM FOR PROPOSALS TO DRILL OR TO DEEPEN OR PLUG BACK TO A DIFFERENT RESERVOIR. USE "APPLICATION FOR PERMIT -" (FORM C-101) FOR SUCH PROPOSALS.)

1. OIL WELL <input type="checkbox"/> GAS WELL <input type="checkbox"/> OTHER- P&A		7. Unit Agreement Name
2. Name of Operator Northern Minerals, Inc.		8. Farm or Lease Name Fernandez Co.
3. Address of Operator 220 Otero Street, Santa Fe, New Mexico 87501		9. Well No. 6
4. Location of Well UNIT LETTER <u>F</u> , <u>1650</u> FEET FROM THE <u>North</u> LINE AND <u>1650</u> FEET FROM THE <u>West</u> LINE, SECTION <u>8</u> TOWNSHIP <u>14 N.</u> RANGE <u>7 W.</u> NMPM.		10. Field and Pool, or Wildcat Wildcat
15. Elevation (Show whether SF, RT, GR, etc.) 6823' G. L.		12. County McKinley

16. Check Appropriate Box To Indicate Nature of Notice, Report or Other Data
NOTICE OF INTENTION TO: SUBSEQUENT REPORT OF:

PERFORM REMEDIAL WORK <input type="checkbox"/>	PLUG AND ABANDON <input checked="" type="checkbox"/>	REMEDIAL WORK <input type="checkbox"/>	ALTERING CASING <input type="checkbox"/>
TEMPORARILY ABANDON <input type="checkbox"/>	CHANGE PLANS <input type="checkbox"/>	COMMENCE DRILLING OPNS. <input type="checkbox"/>	PLUG AND ABANDONMENT <input type="checkbox"/>
PULL OR ALTER CASING <input type="checkbox"/>	OTHER <input type="checkbox"/>	CASING TEST AND CEMENT JOBS <input type="checkbox"/>	

17. Describe Proposed or Completed Operations (Clearly state all pertinent details, and give pertinent dates, including estimated date of starting any proposed work) SEE RULE 11C3.

It is intended to plug and abandon this well with plugs set at the following depths:

1. Cement plug 105' - from 1550' to 1655' (Total Depth)
2. Cement Plug 100' - 350' to 450'
3. 5 sacks cement at surface.



18. I hereby certify that the information above is true and complete to the best of my knowledge and belief.

SIGNED Lloyd Davidson TITLE President DATE 7-8-72

APPROVED BY A.R. Kendrick PETROLEUM ENGINEER DIST. NO. 3 DATE JUL 24 1972
CONDITIONS OF APPROVAL, IF ANY: