

NO. OF COPIES RECEIVED	5
DISTRIBUTION	
SANTA FE	1
FILE	1
U.S.G.S.	2
LAND OFFICE	
OPERATOR	1

# NEW MEXICO OIL CONSERVATION COMMISSION

Form O-191  
Revised 1-1-65

30-031-20265

1. Indicate Type of Lease	
STATE <input type="checkbox"/>	FEE <input checked="" type="checkbox"/>
2. State Oil & Gas Lease No.	

## APPLICATION FOR PERMIT TO DRILL, DEEPEN, OR PLUG BACK

1a. Type of Work			7. Unit Agreement Name		
by Type of Well DRILL <input checked="" type="checkbox"/> DEEPEN <input type="checkbox"/> PLUG BACK <input type="checkbox"/>			8. Farm or Lease Name		
OIL WELL <input checked="" type="checkbox"/> GAS WELL <input type="checkbox"/> OTHER <input type="checkbox"/>			Chop Up		
2. Name of Operator			9. Well No.		
Eastern Petroleum Company			1		
3. Address of Operator			10. Field and Pool, or Wildcat		
P. O. Box 226, Farmington, New Mexico 87401			Wildcat - Dakota		
4. Location of Well			12. County		
UNIT LETTER <u>N</u> LOCATED <u>660</u> FEET FROM THE <u>south</u> LINE			McKinley		
AND <u>1980</u> FEET FROM THE <u>west</u> LINE OF SEC. <u>30</u> TWP. <u>19N</u> RGE. <u>6W</u> NMPM					
19. Proposed Depth			19A. Formation		20. Rotary or C.T.
4600			Dakota		Rotary
21. Elevations (Show whether DF, RT, etc.)	21A. Kind & Status Plug. Bond	21B. Drilling Contractor	22. Approx. Date Work will start		
7092' GL	Blanket	Young Drillong	7-11-72		

## PROPOSED CASING AND CEMENT PROGRAM

SIZE OF HOLE	SIZE OF CASING	WEIGHT PER FOOT	SETTING DEPTH	SACKS OF CEMENT	EST. TOP
12"	9 5/8	34#	62	40	+7090

Propose to drill and test Dakota Sandstone. If productive, will set and cement 4 1/2" csg.

APPROVAL VALID  
FOR 90 DAYS UNLESS  
DRILLING COMMENCED,

EXPIRES 10-9-72

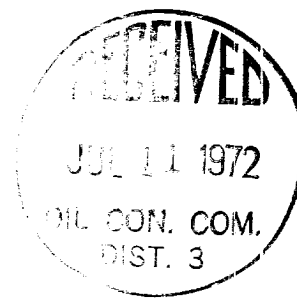

IN ABOVE SPACE DESCRIBE PROPOSED PROGRAM; IF PROPOSAL IS TO DEEPEN OR PLUG BACK, GIVE DATA ON PRESENT PRODUCTIVE ZONE AND PROPOSED NEW PRODUCTIVE ZONE, GIVE BLOWOUT PREVENTER PROGRAM, IF ANY.

I hereby certify that the information above is true and complete to the best of my knowledge and belief.

Signed Rahmet C. Trullinger Title Vice President Date 7-06-72

(This space for State Use)

APPROVED BY Ernest Chavez TITLE SUPERVISOR DIST. #3 DATE JUL 11 1972

CONDITIONS OF APPROVAL, IF ANY:

NEW MEXICO OIL CONSERVATION COMMISSION  
WELL LOCATION AND ACREAGE DEDICATION PLAT

Form O-112  
Supersedes O-128  
Effective 1-1-61

All distances must be from the outer boundaries of the Section.

Operator <b>Eastern Petroleum Company</b>			Lease <b>Chop Up</b>		Well No. <b>No. 1</b>
Unit Letter	Section <b>30</b>	Township <b>19 North</b>	Range <b>6 West</b>	County <b>McKinley County, N. M.</b>	
Actual Footage Location of Well: <b>660</b> feet from the <b>South</b> line and <b>1980</b> feet from the <b>West</b> line					
Ground Level Elev. <b>7092</b>	Producing Formation		Pool <b>WC</b>	Estimated Acreage <b>40</b>	

1. Outline the acreage dedicated to the subject well by colored pencil or hachure marks on the plat below.
2. If more than one lease is dedicated to the well, outline each and identify the ownership thereof (both as to working interest and royalty).
3. If more than one lease of different ownership is dedicated to the well, have the interests of all owners been consolidated by communitization, unitization, force-pooling, etc?

☐ Yes ☐ No If answer is "yes," type of consolidation \_\_\_\_\_

If answer is "no," list the owners and tract descriptions which have actually been consolidated. (Use reverse side of this form if necessary.) \_\_\_\_\_

No allowable will be assigned to the well until all interests have been consolidated (by communitization, unitization, forced-pooling, or otherwise) or until a non-standard unit, eliminating such interests, has been approved by the Commission.

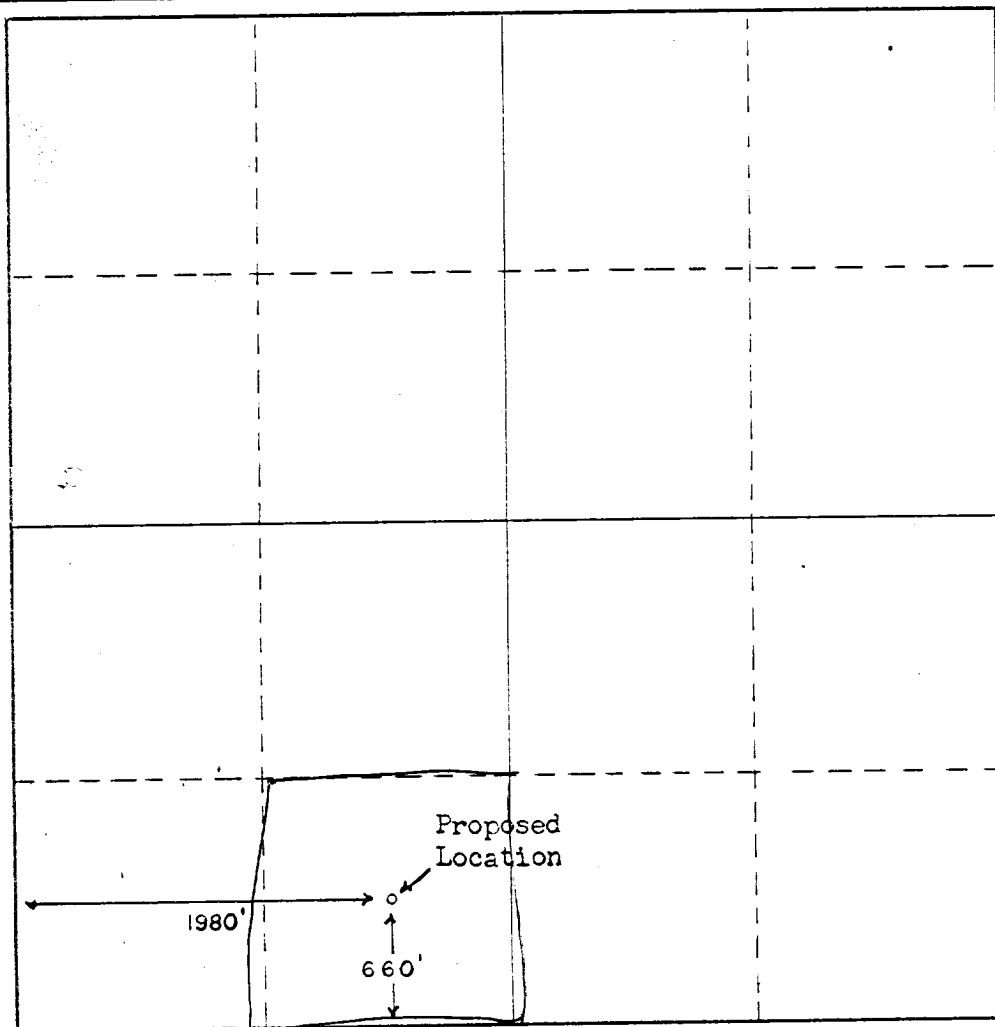
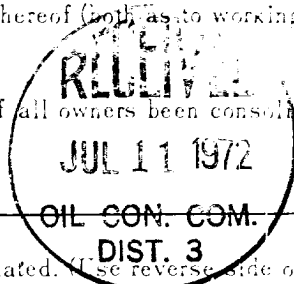

**CERTIFICATION**

I hereby certify that the information contained herein is true and complete to the best of my knowledge and belief.

*Robert A. Fullop*  
Name

**Robert A. Fullop**  
Position

**Vice President**  
Company

**Eastern Petroleum Co.**  
Date

**7p06-72**

I hereby certify that the well location shown on this plat was plotted from field notes of actual surveys made by me or under my supervision, and that the same is true and correct to the best of my knowledge and belief.

**June 15, 1972**  
Date Surveyed

**Frederick H. Reed**  
Registered Professional Engineer  
and/or Land Surveyor

*Frederick H. Reed*

Certificate No.

**3795**

0 330 660 990 1320 1650 1980 2310 2640 2000 1500 1000 500 0