

NO. OF COPIES RECEIVED	5
DISTRIBUTION	
SANTA FE	1
FILE	1
U.S.G.S.	2
LAND OFFICE	
OPERATOR	1

NEW MEXICO OIL CONSERVATION COMMISSION

30-031-20280

Form C-101
Revised 1-1-65

5A. Indicate Type of Lease	
STATE <input type="checkbox"/>	FEE <input checked="" type="checkbox"/>
5. State Oil & Gas Lease No.	

APPLICATION FOR PERMIT TO DRILL, DEEPEN, OR PLUG BACK

1a. Type of Work		7. Unit Agreement Name	
b. Type of Well OIL WELL <input type="checkbox"/> GAS WELL <input type="checkbox"/> OTHER <input checked="" type="checkbox"/> strat test		8. Farm or Lease Name Ignacio Chavez Grant	
2. Name of Operator Roy Aidal		9. Well No. 5x	
3. Address of Operator c/o H E Snillander, 414 1/2 Central SE Albuquerque N M		10. Field and Pool, or Wildcat Wildcat	
4. Location of Well UNIT LETTER <u>K</u> LOCATED <u>2512</u> FEET FROM THE <u>West</u> LINE AND <u>2067'</u> FEET FROM THE <u>South</u> LINE OF SEC. <u>16 4</u> TWP. <u>16 15N</u> RGE. <u>6W</u> NMPM		12. County McKinley	
19. Proposed Depth 750		19A. Formation Hospah	
20. Rotary or C.T. Rotary		21. Elevations (Show whether DF, RT, etc.) Richfield #1 plus 16.86 ft	
21A. Kind & Status Plug. Bond Statewide Blanket		21B. Drilling Contractor Stewart Bros Grants NM	
22. Approx. Date Work will start Aug 15 1969		23. 6620 + 17 = 6637	

PROPOSED CASING AND CEMENT PROGRAM

SIZE OF HOLE	SIZE OF CASING	WEIGHT PER FOOT	SETTING DEPTH	SACKS OF CEMENT	EST. TOP
8 5/8	7"	23	30	Circ	
6 1/2	4 1/2"	9.50	TD	75 sx	150'

Plan to drill 6 1/2" hole from under surface casing to top of Hospah estimated at 708; then core 30'. Deepen to determine top of massive Gallup.

THIS WELL IS BEING DRILLED AS A STRATIGRAPHIC TEST-HOLE FOR GEOLOGICAL INFORMATION ONLY AND UNDER NO CIRCUMSTANCES WILL IT BE PRODUCED.

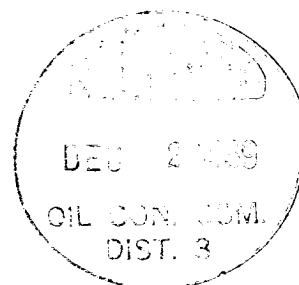

IN ABOVE SPACE DESCRIBE PROPOSED PROGRAM; IF PROPOSAL IS TO DEEPEN OR PLUG BACK, GIVE DATA ON PRESENT PRODUCTIVE ZONE AND PROPOSED NEW PRODUCTIVE ZONE. GIVE BLOWOUT PREVENTER PROGRAM, IF ANY.

I hereby certify that the information above is true and complete to the best of my knowledge and belief.

Signed W. E. Snillander Title Agent, for Roy Aidal Date Nov 27 1969

(This space for State Use)

APPROVED BY Ernest Chavez TITLE Sup. Dist. III DATE 12-2-69

CONDITIONS OF APPROVAL, IF ANY:

NEW MEXICO OIL CONSERVATION COMMISSION
WELL LOCATION AND ACREAGE DEDICATION PLAT

Form C-102
Supersedes C-128
Effective 1-1-65

All distances must be from the outer boundaries of the Section.

Operator Roy Eidal			Lease Ignacio Chavez Grant 100/Lease		Well No. 1K4-5X
Unit Letter K	Section 4	Township 15N	Range 6W	County McKinley	
Actual Footage Location of Well: 2067 feet from the South line and 2512 feet from the West line					
Ground Level Elev: Richfield plus 16.86 ft		Producing Formation Strat test		Dedicated Acreage: 40 NE of SW Acres	

1. Outline the acreage dedicated to the subject well by colored pencil or hachure marks on the plat below.
2. If more than one lease is dedicated to the well, outline each and identify the ownership thereof (both as to working interest and royalty).
3. If more than one lease of different ownership is dedicated to the well, have the interests of all owners been consolidated by communitization, unitization, force-pooling, etc?

☐ Yes ☐ No If answer is "yes," type of consolidation _____

If answer is "no," list the owners and tract descriptions which have actually been consolidated. (Use reverse side of this form if necessary.) _____

No allowable will be assigned to the well until all interests have been consolidated (by communitization, unitization, forced-pooling, or otherwise) or until a non-standard unit, eliminating such interests, has been approved by the Commission.

RECEIVED
DEC 2 1969
OIL CON. COM.
DIST. 3

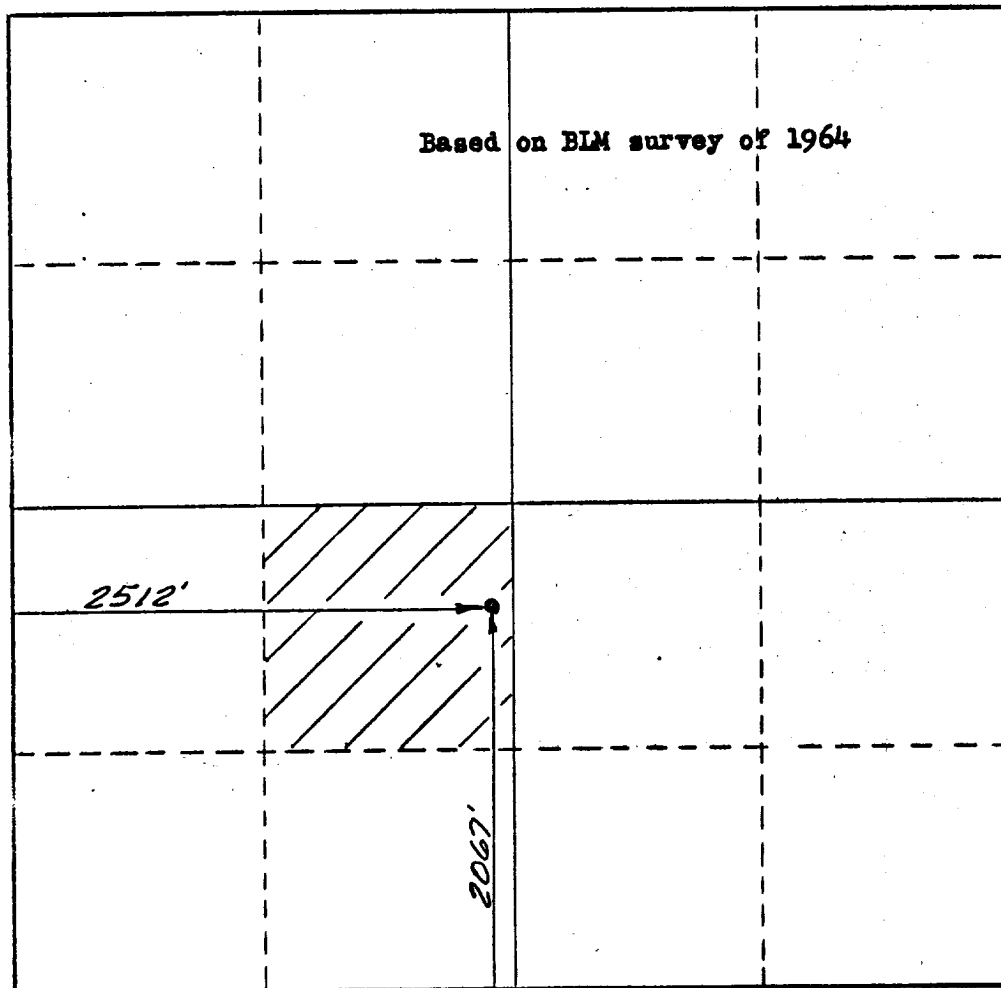

CERTIFICATION

I hereby certify that the information contained herein is true and complete to the best of my knowledge and belief.

H E Shillander

Name

Position

Agent

Company

Roy Eidal

Date

Oct 22 1969

I hereby certify that the well location shown on this plat was plotted from field notes of actual surveys made by me or under my supervision, and that the same is true and correct to the best of my knowledge and belief.

Date Surveyed

October 22, 1969

Registered Professional Engineer and/or Land Surveyor

R. D. Shillander

Certificate No.

1457

0 330 660 990 1320 1650 1980 2310 2640 2000 1500 1000 500 0