

NO. OF COPIES RECEIVED	5
DISTRIBUTION	
SANTA FE	1
FILE	1 ✓
U.S.G.S.	2
LAND OFFICE	
OPERATOR	1

NEW MEXICO OIL CONSERVATION COMMISSION

30-031-29283

Form O-101  
Revised 1-1-65

5A. Indicate Type of Lease	
STATE <input type="checkbox"/>	FEE <input checked="" type="checkbox"/>
5. State Oil & Gas Lease No.	

APPLICATION FOR PERMIT TO DRILL, DEEPEN, OR PLUG BACK

1a. Type of Work DRILL <input checked="" type="checkbox"/> DEEPEN <input type="checkbox"/> PLUG BACK <input type="checkbox"/>		7. Unit Agreement Name	
b. Type of Well OIL <input type="checkbox"/> GAS <input type="checkbox"/> OTHER <input checked="" type="checkbox"/> strat test		8. Farm or Lease Name Ignacio Chavez Grant	
c. Name of Operator Roy Mical		9. Well No. 6	
d. Location of Well UNIT LETTER <u>K</u> LOCATED <u>2500</u> FEET FROM THE <u>West</u> LINE AND <u>1575</u> FEET FROM THE <u>South</u> LINE OF SEC. <u>4</u> TWP. <u>15N</u> RGE. <u>6W</u> SMPM		10. Field and Pool, or Wildcat Wildcat	
11. Elevations (Show whether D.E., RT, etc.) Richfield DB#1 plus 24.95 ft		12. County McKinley	
21A. Kind & Status Plug. Bond Statewide Plnkt		19. Proposed Depth 740/ 765	
21B. Drilling Contractor Stewart Bros Drilling		19A. Formation Mospah	
22. Approx. Date Work will start Sept 10 1969		20. Rotary or C.T. Rotary	

PROPOSED CASING AND CEMENT PROGRAM

SIZE OF HOLE	SIZE OF CASING	WEIGHT PER FOOT	SETTING DEPTH	SACKS OF CEMENT	EST. TOP
8 5/8	7"	23 1/2	15'	Circ	
6 1/2	4 1/2"	9.5	25'	75	150

Plan to drill 6 1/2" hole to 735 then core 30'.

THIS WELL IS BEING DRILLED FOR STRATIGRAPHIC TEST-HOLE FOR GEOLOGICAL INFORMATION ONLY AND UNDER NO CIRCUMSTANCES WILL IT BE PRODUCED.

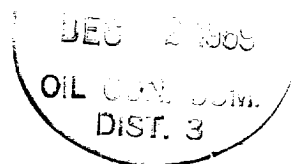

IN ABOVE SPACE DESCRIBE PROPOSED PROGRAM; IF PROPOSAL IS TO DEEPEN OR PLUG BACK, GIVE DATA ON PRESENT PRODUCTIVE ZONE AND PROPOSED NEW PRODUCTIVE ZONE; GIVE BLOWOUT PREVENTER PROGRAM, IF ANY.

I hereby certify that the information above is true and complete to the best of my knowledge and belief.

Signed H. E. Shillander Title H. E. Shillander, Agent Date Nov 27 1969

(This space for State Use)

APPROVED BY Ernest Cloud TITLE Sgt. B. J. M. DATE 12-2-69

CONDITIONS OF APPROVAL, IF ANY.

**NEW MEXICO OIL CONSERVATION COMMISSION  
WELL LOCATION AND ACREAGE DEDICATION PLAT**

Form C-102  
Supersedes C-128  
Effective 1-1-65

All distances must be from the outer boundaries of the Section.

Operator <b>Roy Eidal</b>			Lease <b>Ignacio Chavez Grant</b> <del>11/11/1964</del>		Well No. <b>1141-6</b>
Unit Letter <b>K</b>	Section <b>4</b>	Township <b>15N</b>	Range <b>6W</b>	County <b>McKinley</b>	
Actual Footage Location of Well: <b>1575</b> feet from the <b>South</b> line and <b>2500</b> feet from the <b>West</b> line					
Ground Level Elev. <b>Richfield plus 24.95 ft</b>		Producing Formation <b>strat test</b>		Dedicated Acreage: <b>NE of SW 40</b> Acres	

1. Outline the acreage dedicated to the subject well by colored pencil or hachure marks on the plat below.
2. If more than one lease is dedicated to the well, outline each and identify the ownership thereof (both as to working interest and royalty).
3. If more than one lease of different ownership is dedicated to the well, have the interests of all owners been consolidated by communitization, unitization, force-pooling, etc?

☐ Yes ☐ No If answer is "yes," type of consolidation \_\_\_\_\_

If answer is "no," list the owners and tract descriptions which have actually been consolidated. (Use reverse side of this form if necessary.) \_\_\_\_\_

No allowable will be assigned to the well until all interests have been consolidated (by communitization, unitization, forced-pooling, or otherwise) or until a non-standard unit, eliminating such interests, has been approved by the Commission.

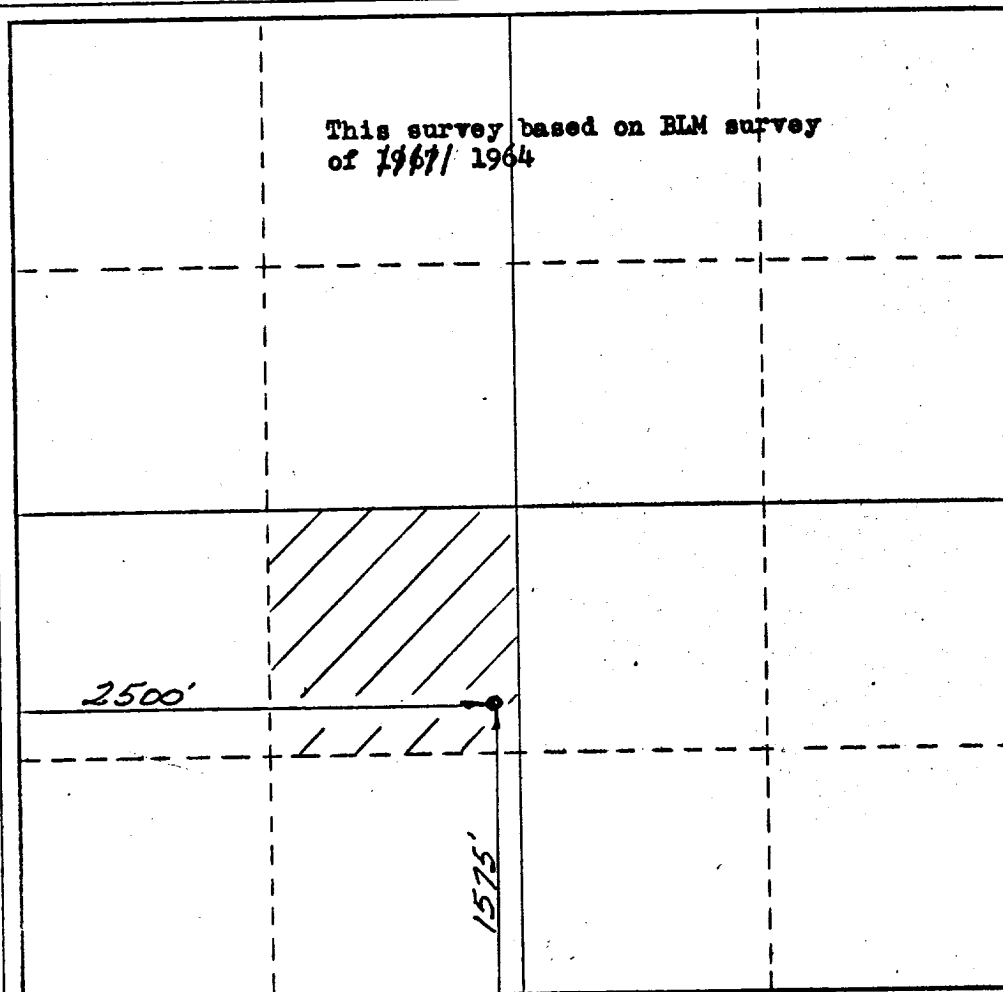
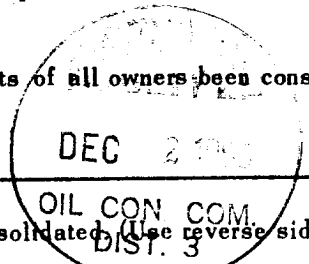

**CERTIFICATION**

I hereby certify that the information contained herein is true and complete to the best of my knowledge and belief.

Name **H E Shillander**

**Agent**

Position

**Roy Eidal**

Company

Date **Oct 22 1969**

I hereby certify that the well location shown on this plat was plotted from field notes of actual surveys made by me or under my supervision, and that the same is true and correct to the best of my knowledge and belief.

Date Surveyed

**October 22, 1969**

Registered Professional Engineer  
and/or Land Surveyor

*R. J. Scanlon*

Certificate No.

**I457**

