

NO. OF COPIES RECEIVED	6
DISTRIBUTION	
SANTA FE	1
FILE	1
U.S.G.S.	2
LAND OFFICE	1
OPERATOR	1

NEW MEXICO OIL CONSERVATION COMMISSION

30-031-20287
Form C-101
Revised 1-1-65

5A. Indicate Type of Lease	STATE <input checked="" type="checkbox"/>	FEE <input type="checkbox"/>
----------------------------	---	------------------------------

5. State Oil & Gas Lease No.

APPLICATION FOR PERMIT TO DRILL, DEEPEN, OR PLUG BACK

1a. Type of Work		7. Unit Agreement Name	
b. Type of Well DRILL <input checked="" type="checkbox"/> DEEPEN <input type="checkbox"/> PLUG BACK <input type="checkbox"/> OIL WELL <input checked="" type="checkbox"/> GAS WELL <input type="checkbox"/> OTHER <input type="checkbox"/> SINGLE ZONE <input checked="" type="checkbox"/> MULTIPLE ZONE <input type="checkbox"/>		8. Farm or Lease Name	
2. Name of Operator		9. Well No.	
3. Address of Operator		10. Field and Pool, or Wildcat	
4. Location of Well		12. County	
UNIT LETTER <u>C</u> LOCATED <u>660</u> FEET FROM THE <u>North</u> LINE AND <u>1900</u> FEET FROM THE <u>West</u> LINE OF SEC. <u>16</u> TWP. <u>20-N</u> RGE. <u>6-W</u> NMPM		<u>McKinley</u>	
21. Elevations (Show whether DF, RT, etc.)		22. Approx. Date Work will start	
21A. Kind & Status Plug. Bond		21B. Drilling Contractor	
21C. Proposed Depth		21D. Formation	
21E. Rotary or C.T.		21F. Approx. Date Work will start	
23. <u>GR 6836.0</u>		<u>Blanket</u>	
<u>Loffland Bros. Co.</u>		<u>11-13-72</u>	

PROPOSED CASING AND CEMENT PROGRAM

SIZE OF HOLE	SIZE OF CASING	WEIGHT PER FOOT	SETTING DEPTH	SACKS OF CEMENT	EST. TOP
17-1/2"	13-3/8"	48#	350'	325 sx	Surf
12-1/4"	8-5/8"	24 & 32#	5200'	650 sx	3600 TOC
7-7/8"	5-1/2"	15.5 & 17#	11,500' or TD	350 sx	8900'

1. Set surf. csg. & cmt. to surf. w/C1. C & 2% CC w/1/2# sx Flocele. Use 4 bow centralizers. WOC 18 hrs Tst csg. to 600# for 30 min.
2. Set Inter. csg. using C1. C Poz mix A (50-50) 4% gel & 1/2# sx Flocele. Use 10 bow centralizers. WOC 18 hrs. Tst csg. to 1000# for 30 min.
3. Set Prod. string w/cmt. additives, centralizers, & scratchers as needed. WOC 36 hrs. Tst csg. to 1000# for 30 min. Temp. Sur. to be run on 8-5/8" & 5-1/2" csg. jobs.

Mud Program

350-5200 Use 9.0# 30-34 Vis. Dextrid
5200-TD Use 9.0# 38-40 Vis. Dextrid

BOP Program

350-5200 Use 12" Ser. 900 #3 w/Hydrill tstd 1000#
5200-11,500 Use 10" Ser. 1000 #3 w/Hydrill tstd 1500#

DRILLING COMMENCED,

EXPIRES 2-12-73

IN ABOVE SPACE DESCRIBE PROPOSED PROGRAM; IF PROPOSAL IS TO DEEPEN OR PLUG BACK, GIVE DATA ON PRESENT PRODUCTION AND PROPOSED NEW PRODUCTION ZONE. GIVE BLOWOUT PREVENTER PROGRAM, IF ANY.

I hereby certify that the information above is true and complete to the best of my knowledge and belief.

Signed Charles Gray Title Proration Clerk Date 11-10-72

(This space for State Use)

APPROVED BY Emmy M. M... TITLE SUPERVISOR DIST. #3 DATE NOV 13 1972

CONDITIONS OF APPROVAL, IF ANY:

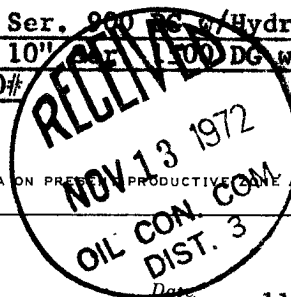

**NEW MEXICO OIL CONSERVATION COMMISSION
WELL LOCATION AND ACERAGE DEDICATION PLAT**

All distances must be from the outer boundaries of the Section

Operator SUN OIL COMPANY OF DELAWARE			Lease NEW MEXICO "W" STATE		Well No. 1
Unit Letter C	Section 16	Township 20 NORTH	Range 6 WEST	County Mc KINLEY	
Actual Footage Location of Well: 660 feet from the North line and 1900 feet from the WEST line					
Ground Level Elev. 6836.0	Producing Formation Pennsylvanian	Pool Wildcat	Dedicated Acreage 40 Acres		

1. Outline the acreage dedicated to the subject well by colored pencil or hatchure marks on the plat below.
2. If more than one lease is dedicated to the well, outline each and identify the ownership thereof (both as to working interest and royalty).
3. If more than one lease of different ownership is dedicated to the well, have the interests of all owners been consolidated by communization, unitization, force-pooling, etc?

(☒) Yes () No If answer is "yes," type of consolidation **Unitization**

If answer is "no," list the owners and tract descriptions which have actually consolidated. (Use reverse side of this form if necessary.)

No allowable will be assigned to the well until all interests have been consolidated (by communization, unitization, forced-pooling, or otherwise) or until a non standard unit, eliminating such interests, has been approved by the Commission.

CERTIFICATION

I hereby certify that the information contained herein is true and complete to the best of my knowledge and belief.

Name *Charles Gray*
 Position **Charles Gray**
Proration Clerk
 Company **Sun Oil Co. of Delaware**
 Date **November 10, 1972**

I hereby certify that the well location shown on this plat was plotted from field notes of actual surveys made by me or under my supervision, and that the same is true and correct to the best of my knowledge and belief.

Date **21 Oct 1972**
 Date Surveyed **10/21/72**
 Registered Professional Engineer and Land Surveyor
JAMES P. LEESE
 No. **1463**
 State of **NEW MEXICO**
 Certificate No. **1463**

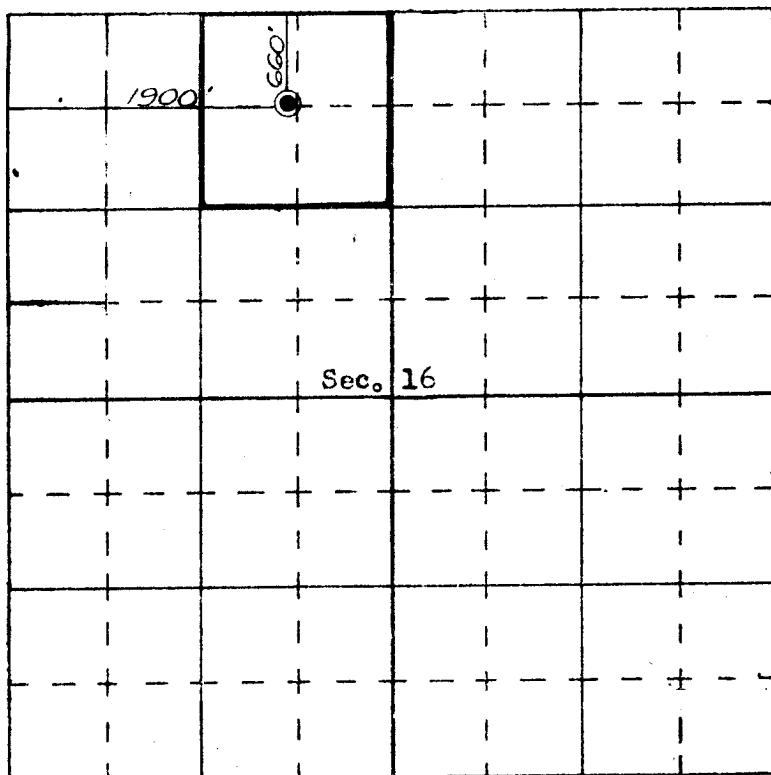

SCALE—4 INCHES EQUALS 1 MILE

SAN JUAN ENGINEERING COMPANY, FARMINGTON, N. M.