

NO. OF COPIES RECEIVED	
DISTRIBUTION	
SANTA FE	/
FILE	
U.S.G.S.	
LAND OFFICE	
OPERATOR	/

# NEW MEXICO OIL CONSERVATION COMMISSION

30-031-20307

Form C-101  
Rev. 12-14-65

5A. Indicate Type of Lease	
STATE <input type="checkbox"/>	FEE <input checked="" type="checkbox"/>
5. State Oil & Gas Lease No.	

## APPLICATION FOR PERMIT TO DRILL, DEEPEN, OR PLUG BACK

1a. Type of Work		7. Unit Agreement Name	
b. Type of Well OIL WELL <input checked="" type="checkbox"/> GAS WELL <input type="checkbox"/> OTHER <input type="checkbox"/>		8. Farm or Lease Name Fernandez Ranch	
2. Name of Operator Northern Minerals, Inc.,		9. Well No. 7	
3. Address of Operator P. O. Box 2182, Santa Fe, New Mexico 87501		10. Field and Pool, or Wildcat Wildcat	
4. Location of Well UNIT LETTER <u>M</u> LOCATED <u>660'</u> FEET FROM THE <u>South</u> LINE AND <u>660</u> FEET FROM THE <u>West</u> LINE OF SEC. <u>11</u> TWP. <u>15N</u> RGE. <u>8W</u> NMPM		12. County McKinley	
19. Proposed Depth 2,800		19A. Formation Morrison	
20. Rotary or C.T. Rotary		21. Elevations (Show whether DF, RT, etc.) 6762' G. L.	
21A. Kind & Status Plug. Bond Statewide		21B. Drilling Contractor Stewart Brothers	
22. Approx. Date Work will start Upon Approval			

23.

### PROPOSED CASING AND CEMENT PROGRAM

SIZE OF HOLE	SIZE OF CASING	WEIGHT PER FOOT	SETTING DEPTH	SACKS OF CEMENT	EST. TOP
8-7/8"	7"	20 lb.	60'	Suff. to circulate	
6 1/2"	4 1/2"	9 bl.	2,800	Suff. to cover 500' above Upper Hoshah	

This well will be a 2800' Morrison wildcat well. 5" hole will be drilled to total depth, logged and, if commercial production of oil or gas is indicated, hole will be reamed out to 6 1/2", casing will be run to total depth, perforated and treated as necessary to establish commercial production.

APPROVAL VALID  
FOR 90 DAYS UNLESS  
DRILLING COMMENCED,

EXPIRES 8-20-73



IN ABOVE SPACE DESCRIBE PROPOSED PROGRAM: IF PROPOSAL IS TO DEEPEN OR PLUG BACK, GIVE DATA ON PRESENT PRODUCTIVE ZONE AND PROPOSED NEW PRODUCTIVE ZONE. GIVE BLOWOUT PREVENTER PROGRAM, IF ANY.

I hereby certify that the information above is true and complete to the best of my knowledge and belief.

Signed Lloyd Davidson Title President Date 5-19-73

(This space for State Use)

APPROVED BY [Signature] TITLE SUPERVISOR DIST. #3 DATE MAY 21 1973

CONDITIONS OF APPROVAL, IF ANY:

NEW MEXICO OIL CONSERVATION COMMISSION  
WELL LOCATION AND ACREAGE DEDICATION PLAT

Form C-102  
Supersedes C-128  
Effective 1-1-65

All distances must be from the outer boundaries of the Section.

Operator <b>Northern Minerals, Inc.</b>		Lease <b>Fernandez Ranch</b>		Well No. <b>7</b>
Unit Letter <b>11</b>	Section <b>11</b>	Township <b>15 North</b>	Range <b>8 West</b>	County <b>McKinley</b>
Actual Footage Location of Well: <div style="display: flex; justify-content: space-between;"> <span>660 feet from the</span> <span>South line and</span> <span>660 feet from the</span> <span>West line</span> </div>				
Ground Level Elev. <b>6762</b>	Producing Formation <b>Wildcat</b>	Pool	Dedicated Acreage: <b>40</b> Acres	

1. Outline the acreage dedicated to the subject well by colored pencil or hachure marks on the plat below.
2. If more than one lease is dedicated to the well, outline each and identify the ownership thereof (both as to working interest and royalty).
3. If more than one lease of different ownership is dedicated to the well, have the interests of all owners been consolidated by communitization, unitization, force-pooling, etc?

☐ Yes    ☐ No    If answer is "yes," type of consolidation \_\_\_\_\_

If answer is "no," list the owners and tract descriptions which have actually been consolidated (Use reverse side of this form if necessary.) \_\_\_\_\_

No allowable will be assigned to the well until all interests have been consolidated (by communitization, unitization, forced-pooling, or otherwise) or until a non-standard unit, eliminating such interests, has been approved by the Commission.

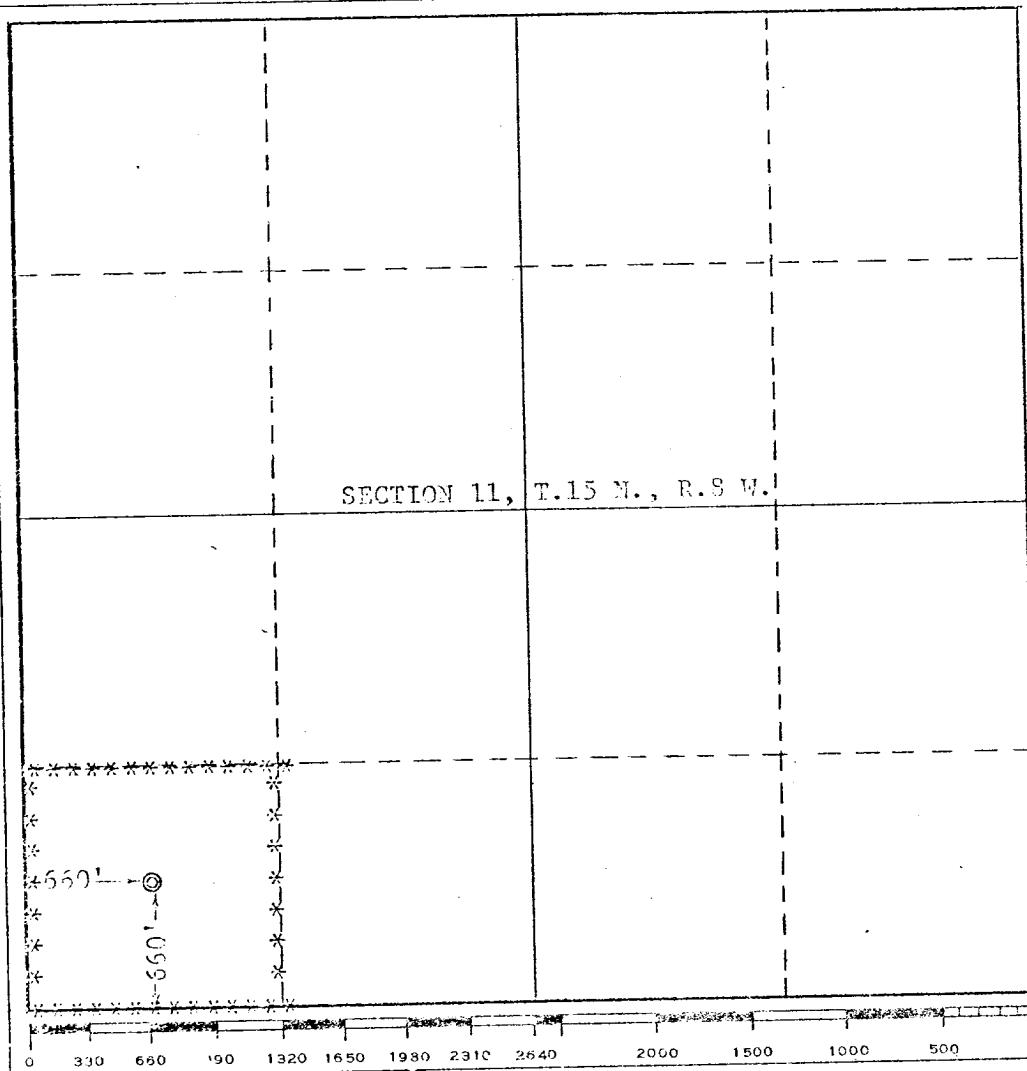
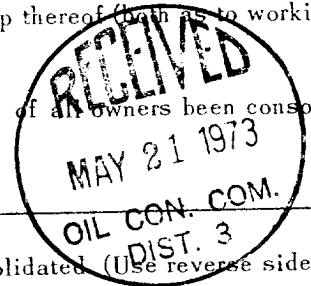

**CERTIFICATION**

I hereby certify that the information contained herein is true and complete to the best of my knowledge and belief.

*Lloyd Davidson*  
Name **Lloyd Davidson**

Position  
**President**

Company  
**Northern Minerals, Inc.**

Date  
**10-19-73**

I hereby certify that the well location shown on this plat was plotted from field notes of actual surveys made by me or under my supervision, and that the same is true and correct to the best of my knowledge and belief.

Date Surveyed  
**May 16, 1973**

Registered Professional Engineer and/or Land Surveyor

*Fred D. Harrison*

Certificate No. **2031**