

NO. OF COPIES RECEIVED	5
DISTRIBUTION	
SANTA FE	1
FILE	1
U.S.G.S.	2
LAND OFFICE	
OPERATOR	1

# NEW MEXICO OIL CONSERVATION COMMISSION

Form C-101  
Revised 1-1-65 30-031-20319

5A. Indicate Type of Lease  
STATE ☐ FEE ☒

5. State Oil & Gas Lease No.

## APPLICATION FOR PERMIT TO DRILL, DEEPEN, OR PLUG BACK

1a. Type of Work b. Type of Well DRILL <input checked="" type="checkbox"/> DEEPEN <input type="checkbox"/> PLUG BACK <input type="checkbox"/> OIL WELL <input type="checkbox"/> GAS WELL <input type="checkbox"/> OTHER <input type="checkbox"/> SINGLE ZONE <input type="checkbox"/> MULTIPLE ZONE <input type="checkbox"/>				7. Unit Agreement Name	
2. Name of Operator DAVIS OIL COMPANY				8. Farm or Lease Name STONEY BUTTE	
3. Address of Operator 1230 Denver Club Building - Denver, Colorado 80202				9. Well No. #1	
4. Location of Well UNIT LETTER D LOCATED 660 FEET FROM THE North LINE AND 660' FEET FROM THE West LINE OF SEC. 9 TWP. 20N RGE. 13W NMPM				10. Field and Pool, or Wildcat Wildcat	
				12. County McKinley	
		19. Proposed Depth 3400'		19A. Formation Morrison	
		20. Rotary or C.T. Rotary			
21. Elevations (show whether DE, RT, etc.) 6172 GR - 6182 KB		21A. Kind & Status Plug. Bond Blanket		21B. Drilling Contractor Lewmont Drilling Assoc.	
		22. Approx. Date Work will start 5-7-71			

## PROPOSED CASING AND CEMENT PROGRAM

SIZE OF HOLE	SIZE OF CASING	WEIGHT PER FOOT	SETTING DEPTH	SACKS OF CEMENT	EST. TOP
12 1/2"	8 5/8"	24#	60'	cmtd. to surf.	
If producing string is run, it will be 5 1/2" thru producing zone cemented to displace 600'					

**LOGGING:** Induction Electrical Survey and BHC Formation Density log with Gamma Ray from base of surface casing to total depth. BHC Sonic log with Caliper over the Dakota formation and other zones of interest to a maximum of 1500' of interval logged.

**MUD PROGRAM:** Fresh water native mud which will be converted to a 10 cc water loss or less chemical base mud for drilling the Dakota.

Good oil field practice will be used in determining the necessity of coring and/or drill stem testing any shows of oil or gas encountered.

APPROVAL VALID  
FOR 90 DAYS UNLESS  
DRILLING COMMENCED,

EXPIRES

July 28, 1971

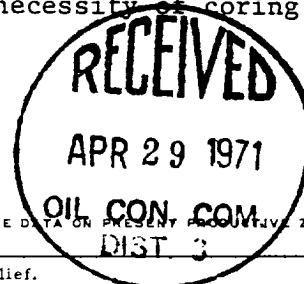

IN ABOVE SPACE DESCRIBE PROPOSED PROGRAM: IF PROPOSAL IS TO DEEPEN OR PLUG BACK, GIVE DATA ON PRESENT PRODUCTION ZONE AND PROPOSED NEW PRODUCTION ZONE. GIVE BLOWOUT PREVENTER PROGRAM, IF ANY.

I hereby certify that the information above is true and complete to the best of my knowledge and belief.

Signed W. L. B. B. B. Title Geological Assistant Date 4-27-71

(This space for State Use)

APPROVED BY Curry Chumel TITLE Sup Dist III DATE 4-29-71

CONDITIONS OF APPROVAL, IF ANY:

# NEW MEXICO OIL CONSERVATION COMMISSION

## WELL LOCATION AND ACERAGE DEDICATION PLAT

All distances must be from the outer boundaries of the Section

Operator <b>DAVIS OIL COMPANY</b>		Lease <b>STONEY BUTTE</b>		Well No <b>1</b>
Unit Letter <b>D</b>	Section <b>9</b>	Township <b>20 NORTH</b>	Range <b>13 WEST</b>	County <b>MCKINLEY</b>
Actual Footage Location of Well: <b>660</b> feet from the <b>North</b> line on <b>660'</b> feet from the <b>West</b> line Producing Formation: <b>Cretaceous</b> Pool: <b>Wildcat</b> Dedicated Acreage: <b>40</b> Acres Ground Level Elev.: <b>6172</b>				

1. Outline the acreage dedicated to the subject well by colored pencil or hatchure marks on the plat below.
2. If more than one lease is dedicated to the well, outline each and identify the ownership thereof (that is, working interest and royalty).
3. If more than one lease of different ownership is dedicated to the well, have the interests of all owners been consolidated by communitization, unitization, force-pooling, etc?

( ) Yes ( ) No If answer is "yes," type of consolidation \_\_\_\_\_

If answer is "no," list the owners and tract descriptions which have actually consolidated. (Use reverse of this form if necessary.) \_\_\_\_\_

No allowable will be assigned to the well until all interests have been consolidated (by communitization, unitization, forced-pooling, or otherwise) or until a non standard unit, eliminating such interests, has been approved by the Commission.

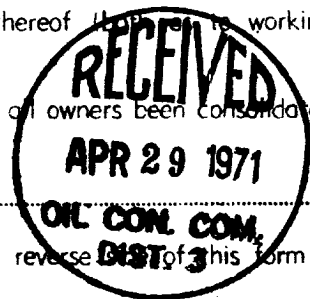

### CERTIFICATION

I hereby certify that the information contained herein is true and complete to the best of my knowledge and belief.

**Shelia Bergano**

Name

**Geological Assistant**

Position

**Davis Oil Company**

Company

**4-27-71**

Date

*Shelia Bergano*

I hereby certify that the well location shown on this plat was plotted from field notes of actual surveys made by me or under my supervision, and that the same is true and correct to the best of my knowledge and belief.

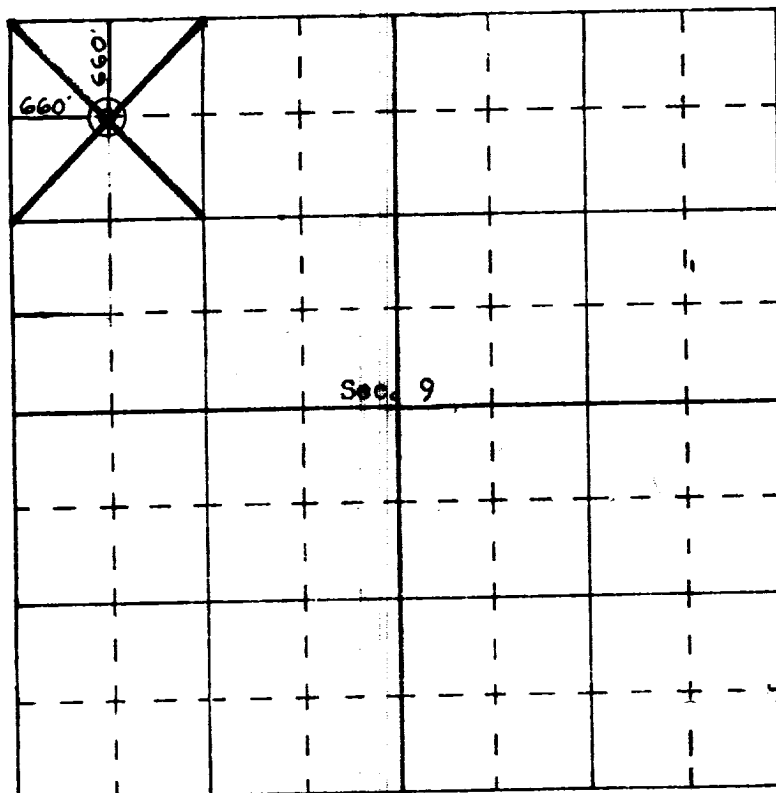
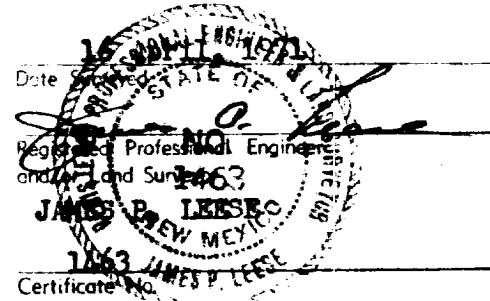

SCALE—4 INCHES EQUALS 1 MILE

SAN JUAN ENGINEERING COMPANY, FARMINGTON, N. M.