

NO. OF COPIES RECEIVED	5
DISTRIBUTION	
SANTA FE	1
FILE	1
U.S.G.S.	2
LAND OFFICE	
OPERATOR	1

# NEW MEXICO OIL CONSERVATION COMMISSION

Form C-101  
Revised 1-1-65 30-031-20320

5A. Indicate Type of Lease	
STATE <input type="checkbox"/>	FEE <input checked="" type="checkbox"/>
5. State Oil & Gas Lease No.	

## APPLICATION FOR PERMIT TO DRILL, DEEPEN, OR PLUG BACK

1a. Type of Work		7. Unit Agreement Name	
b. Type of Well DRILL <input checked="" type="checkbox"/> DEEPEN <input type="checkbox"/> PLUG BACK <input type="checkbox"/> OIL WELL <input checked="" type="checkbox"/> GAS WELL <input type="checkbox"/> OTHER <input type="checkbox"/> SINGLE ZONE <input checked="" type="checkbox"/> MULTIPLE ZONE <input type="checkbox"/>		8. Farm or Lease Name Santa Fe R.R.	
2. Name of Operator Tesoro Petroleum Corporation		9. Well No. 29	
3. Address of Operator 8520 Crownhill Boulevard, San Antonio, Texas 78209		10. Field and Pool, or Wildcat Lone Pine-Dakota "D"	
4. Location of Well UNIT LETTER G LOCATED 2200 FEET FROM THE North LINE AND 1650 FEET FROM THE East LINE OF SEC. 7 TWP. 17N RGE. 8W NMPM		12. County McKinley	
19. Proposed Depth 3000'		19A. Formation Dakota	
20. Rotary or C.T. Rotary		21. Elevations (Show whether DF, RT, etc.) 6928' GL	
21A. Kind & Status Plug. Bond Blanket		21B. Drilling Contractor Will advise later	
22. Approx. Date Work will start May 15, 1971			

## PROPOSED CASING AND CEMENT PROGRAM

SIZE OF HOLE	SIZE OF CASING	WEIGHT PER FOOT	SETTING DEPTH	SACKS OF CEMENT	EST. TOP
12-1/4"	8-5/8"	28#	130' KB	100 sx	Surface
7-7/8"	5-1/2"	15.5#	3000' KB	100 sx	2200'

Propose to drill to an approximately total depth of 3000'. 8-5/8" surface pipe is to be set at approximately 130' KB, and 5-1/2" production casing is to be set and cemented at total depth. Proposed completion is to be in the Dakota with interval for perforating to be selected upon evaluation of an IES Log.

APPROVAL VALID  
FOR 90 DAYS UNLESS  
DULY CHALLENGED  
July 29, 1971



IN ABOVE SPACE DESCRIBE PROPOSED PROGRAM: IF PROPOSAL IS TO DEEPEN OR PLUG BACK, GIVE DATA ON PRESENT PRODUCTIVE ZONE AND PROPOSED NEW PRODUCTIVE ZONE. GIVE BLOWOUT PREVENTER PROGRAM, IF ANY.

I hereby certify that the information above is true and complete to the best of my knowledge and belief.

Signed R. H. Newman Title Manager of Prod. Engineering Date April 28, 1971

(This space for State Use)

APPROVED BY Ernest C. Howard TITLE Sup Dist III DATE 4.30-71

CONDITIONS OF APPROVAL, IF ANY:

NEW MEXICO OIL CONSERVATION COMMISSION  
WELL LOCATION AND ACREAGE DEDICATION PLAT

Form C-102  
Supersedes C-122  
Effective 1-1-65

All distances must be from the outer boundaries of the Section

Operator <b>TESORO PETROLEUM CORPORATION</b>		Lease <b>Santa Fe Railroad</b>		Well No. <b>29</b>
Unit Lower <b>6</b>	Section <b>7</b>	Township <b>17 North</b>	Range <b>8 West</b>	County <b>McKinley</b>
Actual Footage Location of Well: <b>2200</b> feet from the <b>North</b> line and <b>1650</b> feet from the <b>East</b> line				
Ground Level Elev. <b>6928</b>	Producing Formation <b>Dakota</b>	Pool <b>Lone Pine - Dakota "D"</b>	Dedicated Acreage: <b>80</b> Acres	

1. Outline the acreage dedicated to the subject well by colored pencil or hatchure marks on the plat below.
2. If more than one lease is dedicated to the well, outline each and identify the ownership (as to working interest and royalty).
3. If more than one lease of different ownership is dedicated to the well, have the interests of all owners been consolidated by communization, unitization, force-pooling, etc?

☐ Yes ☐ No If answer is "yes," type of consolidation \_\_\_\_\_

If answer is "no," list the owners and tract descriptions which have actually been consolidated. (Use reverse side of this form if necessary.) \_\_\_\_\_

No allowable will be assigned to the well until all interests have been consolidated (by communization, unitization, forced-pooling, or otherwise) or until a non-standard unit, eliminating such interests, has been approved by the Commission.

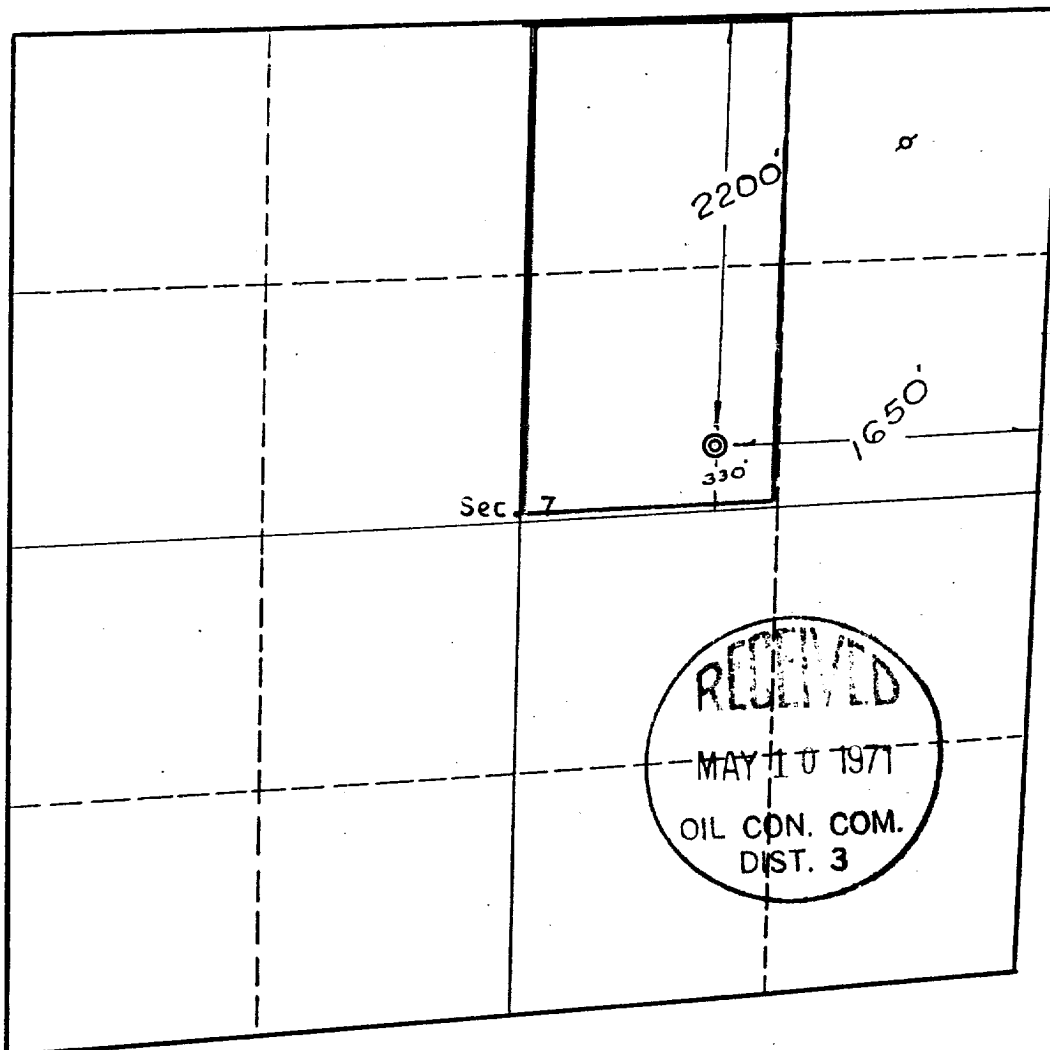
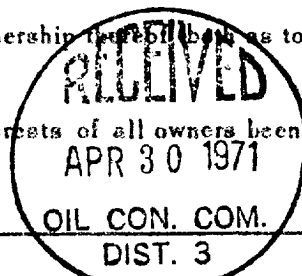

CERTIFICATION

I hereby certify that the information contained herein is true and complete to the best of my knowledge and belief.

*R. H. Denman*

Name  
**R. H. Denman**  
Position  
**Mgr. of Prod. Engineering**  
Company  
**TESORO PETROLEUM CORPORATION**

Date  
**April 28, 1971**

STATE OF NEW MEXICO  
I hereby certify that the well location shown on this plat was plotted from field notes of actual surveys made by me or under my supervision, and that the same is true and correct to the best of my knowledge and belief.  
REGISTERED LAND SURVEYOR

Date Surveyed  
**April 24, 1971**  
Registered Professional Engineer and/or Land Surveyor

*E. V. Echshaw*  
Certificate No. **3602**  
**E. V. Echshaw, L.S.**