

NO. OF COPIES RECEIVED	5
DISTRIBUTION	
SANTA FE	1
FILE	1
U.S.G.S.	2
LAND OFFICE	
OPERATOR	1

NEW MEXICO OIL CONSERVATION COMMISSION

Form C-101

Revised 1-1-65 30-031-20321

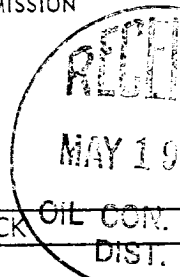

5A. Indicate Type of Lease	
STATE <input type="checkbox"/>	FEE <input checked="" type="checkbox"/>
5. State Oil & Gas Lease No.	
7. Unit Agreement Name	
8. Farm or Lease Name	
CHOPUP	
9. Well No.	
#1	
10. Field and Pool, or Wildcat	
Wildcat	
12. County	
McKinley	
18. Proposed Depth	19A. Formation
4400'	Morrison
20. Rotary or C.T.	
Rotary	
21. Elevations (Show whether DF, RT, etc.)	21A. Kind & Status Plug, Bond
7272 GR	Blanket
21B. Drilling Contractor	22. Approx. Date Work will start
Lewmont Drilling	5-26-71

1a. Type of Work	
DRILL <input checked="" type="checkbox"/> DEEPEN <input type="checkbox"/> PLUG BACK <input type="checkbox"/>	
b. Type of Well	
OIL WELL <input type="checkbox"/>	GAS WELL <input type="checkbox"/> OTHER <input type="checkbox"/>
2. Name of Operator	
DAVIS OIL COMPANY	
3. Address of Operator	
1230 Denver Club Building - Denver, Colorado 80202	
4. Location of Well	
UNIT LETTER M	LOCATED 660 FEET FROM THE South LINE
AND 660 FEET FROM THE West	LINE OF SEC. 31 TWP. 19N RGE. 6W NMPM
23. PROPOSED CASING AND CEMENT PROGRAM	
SIZE OF HOLE	SIZE OF CASING
12 1/4"	8 5/8"
WEIGHT PER FOOT	SETTING DEPTH
24#	60'
SACKS OF CEMENT	
cmtd. to surf	
EST. TOP	
If oil string is run, it will be 5 1/2" thru producing zone cemented to displace 600'	

LOGGING: Induction Electrical Survey and BHC Formation Density log with Gamma Ray from base of surface casing to total depth. BHC Sonic log with Caliper over the Dakota formation and other zones of interest to a maximum of 1500' of interval logged.

MUD PROGRAM: Fresh water native mud which will be converted to a 10 cc water loss or less chemical base mud for drilling the Dakota.

Good oil field practice will be used in determining the necessity of coring and/or drill stem testing any shows of oil or gas encountered.

APPROVAL VALID FOR 90 DAYS UNLESS DRILLING COMMENCED,

IN ABOVE SPACE DESCRIBE PROPOSED PROGRAM: IF PROPOSAL IS TO DEEPEN OR PLUG BACK, GIVE DATA ON PRESENT PRODUCTIVE ZONE AND PROPOSED NEW PRODUCTIVE ZONE. GIVE BLOWOUT PREVENTER PROGRAM, IF ANY.

I hereby certify that the information above is true and complete to the best of my knowledge and belief.

EXPIRES Aug 17, 1971

Signed Ellie Bergman Title Geological Assistant Date 5-18-71

(This space for State Use)

APPROVED BY Ernest C. Arnold TITLE Sup Dir III DATE 5-19-71

CONDITIONS OF APPROVAL, IF ANY:

NEW MEXICO OIL CONSERVATION COMMISSION

WELL LOCATION AND ACERAGE DEDICATION PLAT

All distances must be from the outer boundaries of the Section

Operator DAVIS OIL COMPANY Well No. 1
 Unit Letter M Section 31 Township 19 NORTH Range 6 WEST County MCKINLEY
 Actual Footage Location of Well: 660 feet from SOUTH 660 feet from the WEST line
 Ground Level Elev. 7272.0 CRETACEOUS WILDEAT 40 Acres

1. Outline the acreage dedicated to the subject well by color, pencil or machine marks on the plat below.
2. If more than one lease is dedicated to the well, outline each and identify the ownership thereof (by name, working interest and royalty).
3. If more than one lease of different ownership is dedicated to the well, have the interests of all owners been consolidated by communitization, unitization, force-pooling, etc?
 () Yes () No If answer is "yes," type of consolidation _____
 If answer is "no," list the owners and tract descriptions which have actually consolidated (Use reverse of this form if necessary) _____

No allowable will be assigned to the well until all interests have been consolidated (by communitization, unitization, force-pooling, or otherwise) or until a non standard unit, eliminating such interests, has been approved by the Commission.

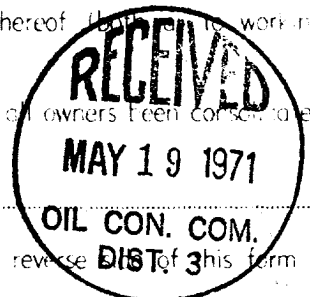

CERTIFICATION

I hereby certify that the information contained herein is true and complete to the best of my knowledge and belief.

Shelia Bergamo
 Name
Geological Assistant
 Position
Davis Oil Company
 Company
5-18-71
 Date
Shelia Bergamo

I hereby certify that the well location shown on this plat was plotted from field notes of actual surveys made by me or under my supervision, and that the same is true and correct to the best of my knowledge.

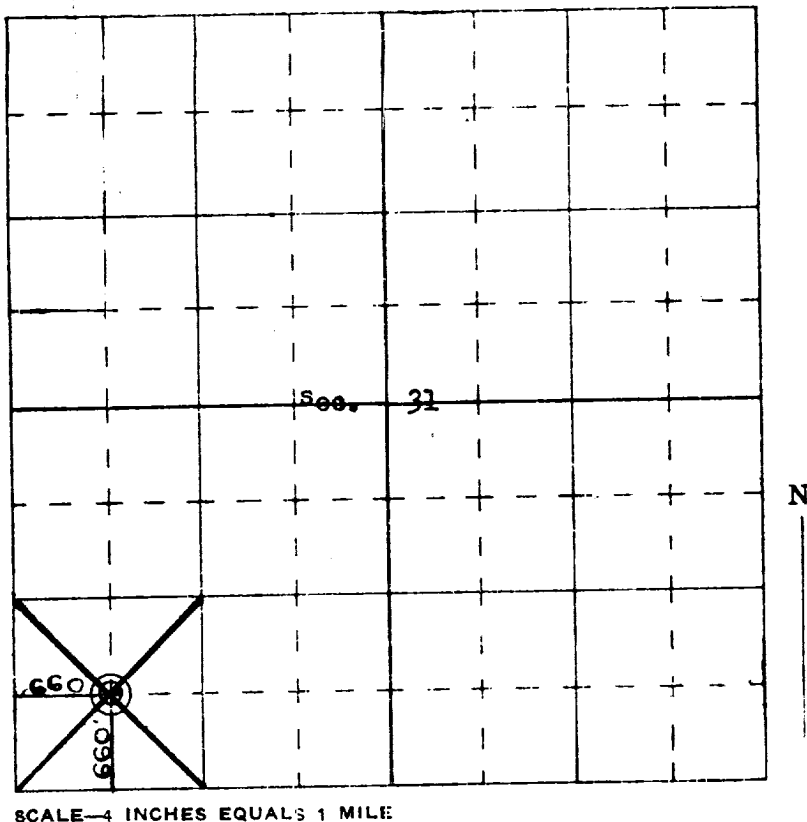
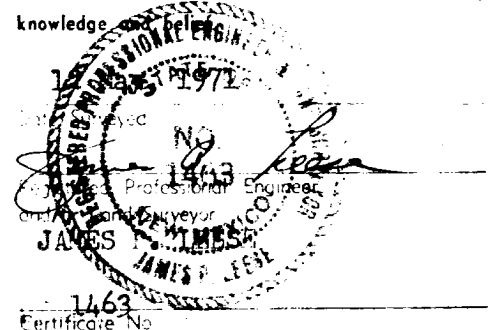

SCALE - 4 INCHES EQUALS 1 MILE