

NO. OF COPIES RECEIVED	5
DISTRIBUTION	
SANTA FE	1
FILE	1
U.S.G.S.	2
LAND OFFICE	
OPERATOR	1

NEW MEXICO OIL CONSERVATION COMMISSION

Form O-101  
Revised 1-1-65 *30 631-20324*

5A. Indicate Type of Lease  
STATE  FEE

5. State Oil & Gas Lease No.

APPLICATION FOR PERMIT TO DRILL, DEEPEN, OR PLUG BACK

1a. Type of Work  
DRILL  DEEPEN  PLUG BACK

b. Type of Well  
OIL WELL  GAS WELL  OTHER  SINGLE ZONE  MULTIPLE ZONE

2. Name of Operator  
**DAVIS OIL COMPANY**

3. Address of Operator  
**1230 Denver Club Bldg. - Denver, Colorado 80202**

4. Location of Well  
UNIT LETTER **M** LOCATED **660** FEET FROM THE **South** LINE  
AND **660** FEET FROM THE **West** LINE OF SEC. **15** TWP. **18N** RGE. **9W** NMPM

7. Unit Agreement Name

8. Farm or Lease Name  
**WHITE HORSE**

9. Well No.  
**#1**

10. Field and Pool, or Wildcat  
**Wildcat**

12. County  
**McKinley**

19. Proposed Depth  
**3300'**

19A. Formation  
**Morrison**

20. Rotary or C.T.  
**Rotary**

21. Elevations (Show whether DP, RT, etc.)  
**6805 GR - 6815 KB**

21A. Kind & Status Plug, Bond  
**Blanket**

21B. Drilling Contractor  
**Lewmont Drilling**

22. Approx. Date Work will start  
**7-1-71**

PROPOSED CASING AND CEMENT PROGRAM

SIZE OF HOLE	SIZE OF CASING	WEIGHT PER FOOT	SETTING DEPTH	SACKS OF CEMENT	EST. TOP
12 1/4"	8 5/8"	24#	60' approx. cmtd. to surf.		
If oil string is run, it will be 5 1/2" thru producing zone cemented to displace 600'					

LOGGING: Induction Electrical Survey and BHC Formation Density log with Gamma Ray from base of surface casing to total depth. BHC Sonic log with Caliper over the Dakota formation.

MUD PROGRAM: Fresh water native mud which will be converted to a 10 cc water loss or less chemical base mud for drilling the Dakota.

Good oil field practice will be used in determining the necessity of coring and/or drill stem testing any shows of oil or gas encountered.

APPROVAL VALID FOR 90 DAYS UNLESS DRILLING COMMENCED, EXPIRES Sept 13, 1971

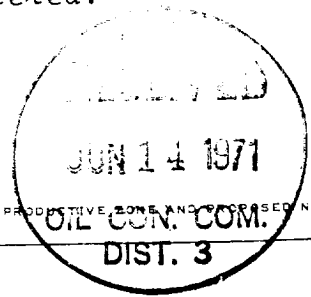

IN ABOVE SPACE DESCRIBE PROPOSED PROGRAM; IF PROPOSAL IS TO DEEPEN OR PLUG BACK, GIVE DATA ON PRESENT PRODUCTIVE ZONE AND PROPOSED NEW PRODUCTIVE ZONE. GIVE BLOWOUT PREVENTER PROGRAM, IF ANY.

I hereby certify that the information above is true and complete to the best of my knowledge and belief.

Signed [Signature] Title Geological Assistant Date 6-10-71

(This space for State Use)

APPROVED BY [Signature] TITLE Sup. Pnt III DATE 6-14-71

CONDITIONS OF APPROVAL, IF ANY:

**NEW MEXICO OIL CONSERVATION COMMISSION  
WELL LOCATION AND ACERAGE DEDICATION PLAT**

All distances must be from the outer boundaries of the Section

Operator	DAVIS OIL COMPANY			Lease	WHITE HORSE	Well No.	1
Unit Letter	Section	Township	Range	County			
M	15	18 NORTH	9 WEST	MCKINLEY			
Actual Footage Location of Well:							
660	feet from the	SOUTH	660	feet from the	WEST	line	
Ground Level Elev.	Forming	Post	Dedicated		Acreage		
6805.0	Cretaceous	Wildcat	40		Acre		

- Outline the acreage dedicated to the subject well by colored pencil or hachure marks on the plat below.
- If more than one lease is dedicated to the well, outline each and identify the ownership thereof (both as to working interest and royalty).
- If more than one lease of different ownership is dedicated to the well, have the interests of all owners been consolidated by communitization, unitization, force-pooling, etc?
  - Yes  No If answer is "yes," type of consolidation: \_\_\_\_\_

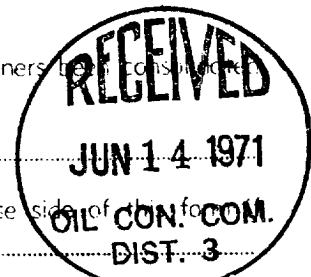

If answer is "no," list the owners and tract descriptions which have actually consolidated. (Use reverse side of plat if necessary) \_\_\_\_\_

No allowable will be assigned to the well until all interests have been consolidated (by communitization, unitization, forced-pooling, or otherwise) or until a non standard unit, eliminating such interests, has been approved by the Commission.

**CERTIFICATION**

I hereby certify that the information contained herein is true and complete to the best of my knowledge and belief.

*Shelia Bergamo*  
Name  
*Geological Assistant*  
Position  
*Davis Oil Company*  
Company  
*6-10-71*  
Date

I hereby certify that the well location shown on this plat was plotted from field notes of actual surveys made by me or under my supervision, and that the same is true and correct to the best of my knowledge and belief.

*14 April, 1971*  
Date Surveyed  
*James P. Ise*  
Registered Professional Engineer  
and/or Land Surveyor  
**JAMES P. ISE**

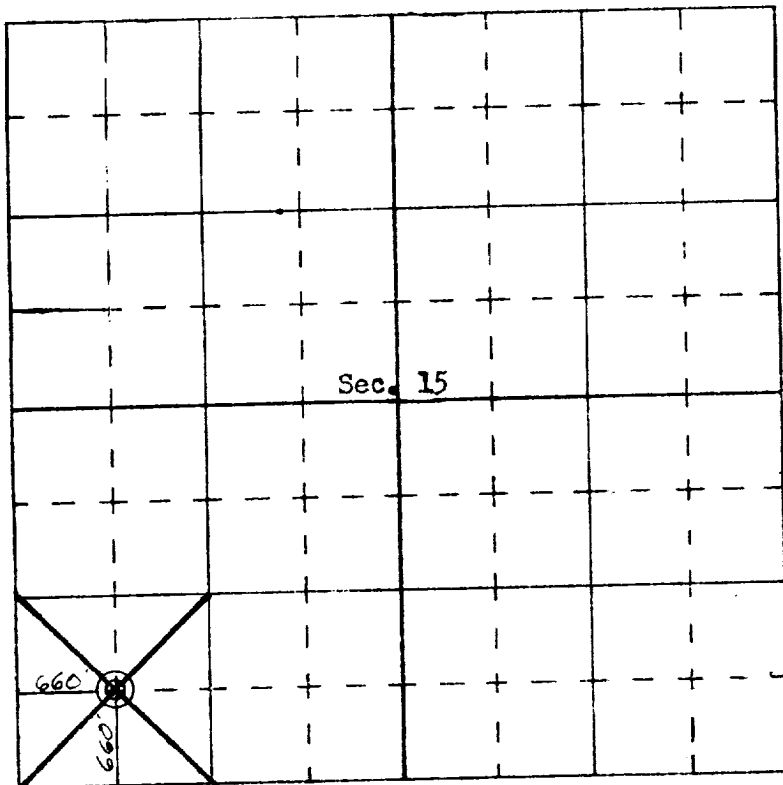

N  
|  
|  
|

SCALE—4 INCHES EQUALS 1 MILE