

NO. OF COPIES RECEIVED	5
DISTRIBUTION	
SANTA FE	1
FILE	1
U.S.G.S.	1
LAND OFFICE	1
OPERATOR	1

NEW MEXICO OIL CONSERVATION COMMISSION

Form C-101
Revised 1-1-65 30-031-20327

5A. Indicate Type of Lease	STATE <input type="checkbox"/>	FEE <input checked="" type="checkbox"/>
----------------------------	--------------------------------	---

5. State Oil & Gas Lease No.

APPLICATION FOR PERMIT TO DRILL, DEEPEN, OR PLUG BACK

1a. Type of Work		7. Unit Agreement Name	
b. Type of Well DRILL <input checked="" type="checkbox"/> DEEPEN <input type="checkbox"/> PLUG BACK <input type="checkbox"/> OIL WELL <input type="checkbox"/> GAS WELL <input type="checkbox"/> OTHER <input type="checkbox"/> SINGLE ZONE <input type="checkbox"/> MULTIPLE ZONE <input type="checkbox"/>		8. Farm or Lease Name HOSPAH WEST	
2. Name of Operator DAVIS OIL COMPANY		9. Well No. #1	
3. Address of Operator 1230 Denver Club Building - Denver, Colorado 80202		10. Field and Pool, or Wildcat Wildcat	
4. Location of Well UNIT LETTER A LOCATED 660 FEET FROM THE North LINE AND 660 FEET FROM THE East LINE OF SEC. 18 TWP. 17N RGE. 9W NMPM		12. County McKinley	
13. Proposed Depth 2900'		19A. Formation Morrison	20. Rotary or C.T. Rotary
21. Elevations (Show whether DE, RT, etc.) 6918 GR - 6928 KB	21A. Kind & Status Plug. Bond Blanket	21B. Drilling Contractor Lewmont Drilling	22. Approx. Date Work will start 7-18-71

PROPOSED CASING AND CEMENT PROGRAM

SIZE OF HOLE	SIZE OF CASING	WEIGHT PER FOOT	SETTING DEPTH	SACKS OF CEMENT	EST. TOP
12 1/4"	8 5/8"	24#	60'	cmdt. to surf.	
If oil string is run, it will be 5 1/2" thru producing zone cemented to displace 600'					

LOGGING: Induction Electrical Survey and BHC Formation Density log with Gamma Ray from base of surface casing to total depth. BHC Sonic log with Caliper over the Dakota formation and other zones of interest to a maximum of 1500' of interval logged.

MUD PROGRAM: Fresh water native mud which will be converted to a 10 cc water loss or less chemical base mud for drilling the Dakota

Good oil field practice will be used in determining the necessity of coring and/or drill stem testing any shows of oil or gas encountered.

APPROVAL VALID
FOR 90 DAYS UNLESS
DRILLING COMMENCED,

IN ABOVE SPACE DESCRIBE PROPOSED PROGRAM: 10-7-71 TO DEEPEN OR PLUG BACK, GIVE DATA ON PRESENT PRODUCTIVE ZONE AND PROPOSED NEW PRODUCTIVE ZONE. GIVE BLOWOUT PREVENTER EXPIRES IF ANY

I hereby certify that the information above is true and complete to the best of my knowledge and belief.

Signed *William Bergano* Title Geological Assistant Date 7-7-71

(This space for State Use)

APPROVED BY *Albert K. Kirk* TITLE PETROLEUM ENGINEER DIST. NO. 3 DATE JUL 9 1971

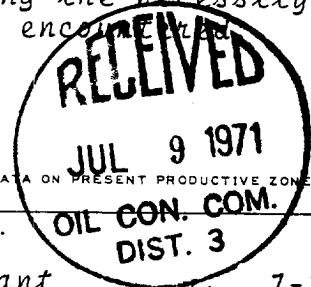

NEW MEXICO OIL CONSERVATION COMMISSION

WELL LOCATION AND ACERAGE DEDICATION PLAT

All distances must be from the outer boundaries of the Section

Operator DAVIS OIL COMPANY		HOSPAN WEST		Well No. 1
Unit Letter A	Section 18	Township 17 NORTH	Range 9 WEST	County McKINLEY
Actual Footage Location of Well:				
660	feet from the NORTH	660	feet from the EAST	line
Ground Level Elev 6918.0	Producing Formation Cretaceous	Wildcat	Dedicated Acreage 40	Acres

1. Outline the acreage dedicated to the subject well by colored pencil or machine marks on the plot below.
2. If more than one lease is dedicated to the well, outline each and identify the ownership thereof (both as to working interest and royalty).
3. If more than one lease of different ownership is dedicated to the well, have the interests of all owners been consolidated by communitization, unitization, force-pooling, etc?

() Yes () No If answer is "yes," type of consolidation

If answer is "no," list the owners and tract descriptions which have actually consolidated. (Use reverse side of this form if necessary.)

No allowable will be assigned to the well until all interests have been consolidated (by communitization, unitization, forced-pooling, or otherwise) or until a non standard unit, eliminating such interests, has been approved by the Commission.



CERTIFICATION

I hereby certify that the information contained herein is true and complete to the best of my knowledge and belief.

Shelia Bergamo
Name

Geological Assistant
Position

Davis Oil Company
Company

7-7-71
Date

Shelia Bergamo

I hereby certify that the well location shown on this plat was plotted from field notes of actual surveys made by me or under my supervision, and that the same is true and correct to the best of my knowledge and belief.

14 April, 1971
Date Surveyed

[Signature]
Registered Professional Engineer
and/or Land Surveyor

JAMES P. LEASE

1463
Certificate No.

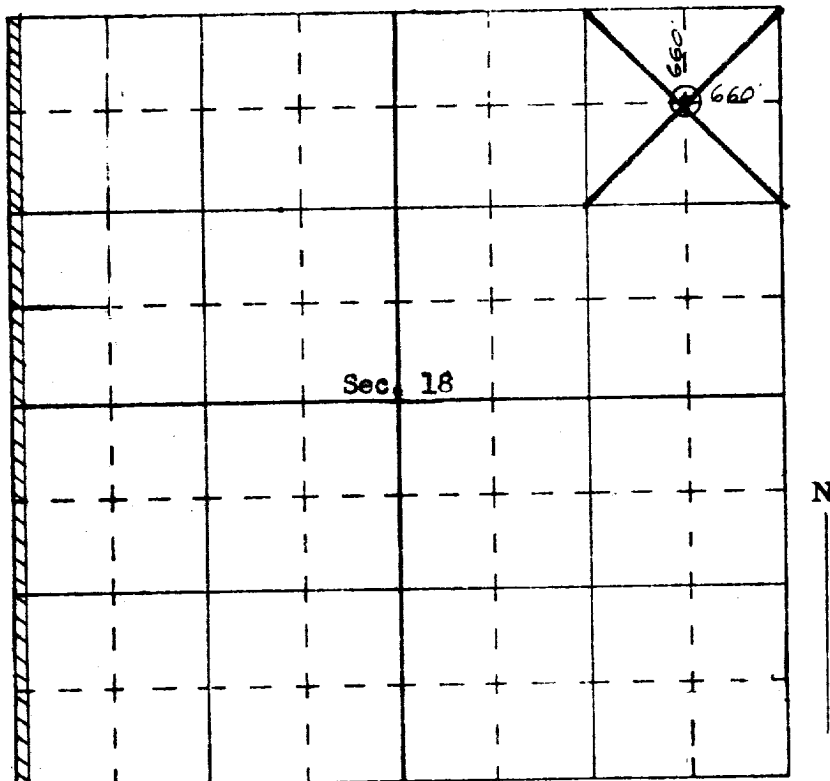

SCALE—4 INCHES EQUALS 1 MILE

SAN JUAN ENGINEERING COMPANY, FARMINGTON, N. M.