

NO. OF COPIES RECEIVED	5
DISTRIBUTION	
SANTA FE	/
FILE	/
U.S.G.S.	/
LAND OFFICE	/
OPERATOR	/

NEW MEXICO OIL CONSERVATION COMMISSION

Form C-101
Revised 1-1-65 30-031-20329

5A. Indicate Type of Lease
STATE <input type="checkbox"/> FEE <input checked="" type="checkbox"/>

5. State Oil & Gas Lease No.

APPLICATION FOR PERMIT TO DRILL, DEEPEN, OR PLUG BACK

1a. Type of Work		7. Unit Agreement Name	
b. Type of Well OIL WELL <input type="checkbox"/> GAS WELL <input type="checkbox"/> OTHER <input type="checkbox"/>		8. Farm or Lease Name BULLSEYE	
2. Name of Operator DAVIS OIL COMPANY		9. Well No. #1	
3. Address of Operator 1230 Denver Club Bldg. - Denver, Colorado 80202		10. Field and Pool, or Wildcat Wildcat	
4. Location of Well UNIT LETTER H LOCATED 1980 FEET FROM THE North LINE AND 660 FEET FROM THE East LINE OF SEC. 17 TWP. 16N RGE. 9W NMPM		12. County McKinley	
19. Proposed Depth 2500'		19A. Formation Morrison	20. Rotary or C.T. Rotary
21. Elevations (Show whether DF, RT, etc.) 7028 GR - 7038 KB	21A. Kind & Status Plug. Bond Blanket	21B. Drilling Contractor Lewmont Drilling	22. Approx. Date Work will start 7-30-71

PROPOSED CASING AND CEMENT PROGRAM

SIZE OF HOLE	SIZE OF CASING	WEIGHT PER FOOT	SETTING DEPTH	SACKS OF CEMENT	EST. TOP
12 1/4"	8 5/8"	24#	60' approx.	cmtd. to surf.	
If production string is run, it will be 5 1/2" thru producing zone cemented to displace 600'.					

LOGGING: Induction Electrical Survey and BHC Formation Density log with Gamma Ray from base of surface casing to total depth. BHC Sonic log with Caliper over the Dakota formation and other zones of interest.

Good oil field practice will be used in determining the necessity of coring and/or drill stem testing any shows of oil or gas encountered.

APPROVAL VALID
FOR 90 DAYS UNLESS
DRILLING COMMENCED,

EXPIRES 10-20-71

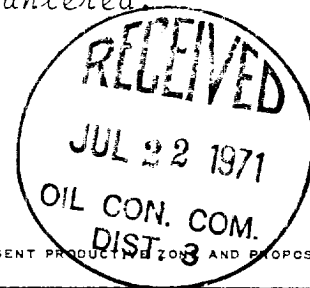

IN ABOVE SPACE DESCRIBE PROPOSED PROGRAM: IF PROPOSAL IS TO DEEPEN OR PLUG BACK, GIVE DATA ON PRESENT PRODUCTION ZONE AND PROPOSED NEW PRODUCTION ZONE. GIVE BLOWOUT PREVENTER PROGRAM, IF ANY.

I hereby certify that the information above is true and complete to the best of my knowledge and belief.

Signed [Signature] Title Geological Assistant Date 7-19-71

(This space for State Use)

APPROVED BY [Signature] TITLE Sup Dist III DATE 7-22-71
CONDITIONS OF APPROVAL, IF ANY:

NEW MEXICO OIL CONSERVATION COMMISSION WELL LOCATION AND ACERAGE DEDICATION PLAT

All distances must be from the outer boundaries of the Section

Owner: **DAVIS OIL COMPANY** **BULLSEYE** Well No. **1**
 Section: **H 17 16 NORTH 9 WEST MCKINLEY**
 Acreage: **1980** **NORTH** **660** **EAST**
 Oil: **CRETACEOUS** **WILDCAT** **40**

- Outline the acreage dedicated to the subject well by section, corner or boundary marks on the plat below
 - If more than one lease is related to the well, outline each and identify the ownership thereof (that is to say, interest and royalty).
 - If more than one lease of different ownership is related to the well, have the interests of all owners been consolidated by communitization, unitization, pooling, etc.?
 - Yes ☐ No ☐ If answer is yes, type of consolidation: _____
- If answer is "No" list the owners and tract descriptions which have actually consolidated. (Use reverse side of this form if necessary)
- If answer is "Yes" to the well until all interests have been consolidated (by communitization, unitization, forced pooling or otherwise) or until a non-forward unit, eliminating such interests, has been approved by the Commission.

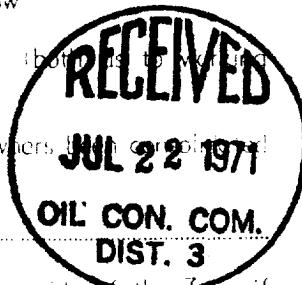

CERTIFICATION

I hereby certify that the information contained herein is true and complete to the best of my knowledge and belief.

Shelia Bergamo
 Name
Geological Assistant
 Position
Davis Oil Company
 Company
7-19-71
 Date

I hereby certify that the well location shown on this plat was plotted from field notes of actual surveys made by me or under my supervision, and that the same is true and correct to the best of my knowledge and belief.

21 April, 1971
 Date Surveyed
James P. Leese
 Registered Professional Engineer
 and/or Land Surveyor
JAMES P. LEESE

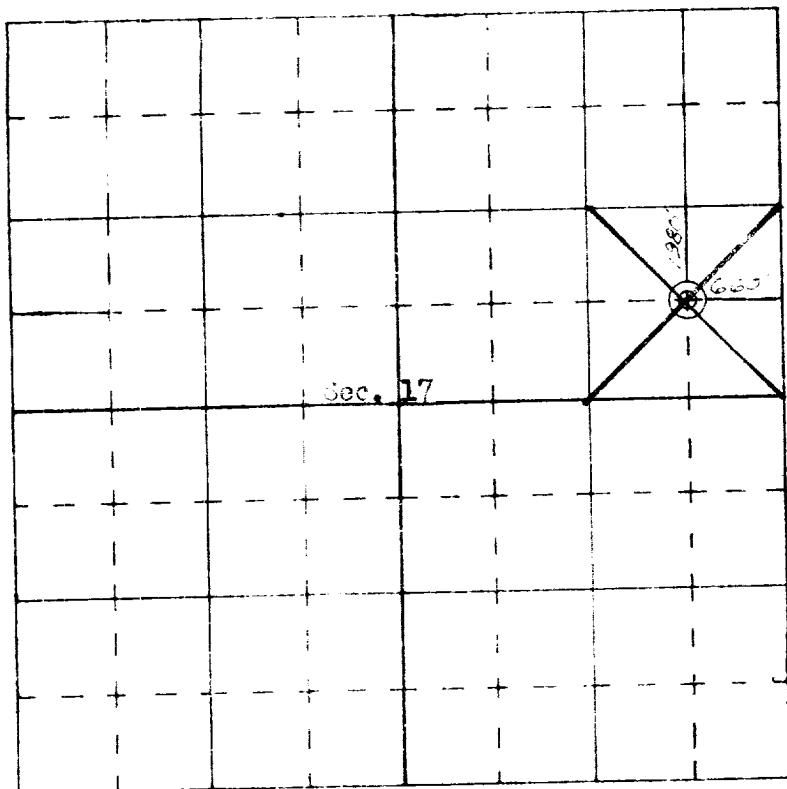

SCALE—4 INCHES EQUALS 1 MILE