

**UNITED STATES  
DEPARTMENT OF THE INTERIOR  
GEOLOGICAL SURVEY**

SUBMIT IN TRIPPLICATE\*  
(Other instructions on  
reverse side)

Form approved,  
Budget Bureau No. 42-R1123.

30-031-20342

**APPLICATION FOR PERMIT TO DRILL, DEEPEN, OR PLUG BACK**

1a. TYPE OF WORK <b>DRILL</b> <input checked="" type="checkbox"/> <b>DEEPEN</b> <input type="checkbox"/> <b>PLUG BACK</b> <input type="checkbox"/>			5. LEASE DESIGNATION AND SERIAL NO. 14-20-0603-9535	
b. TYPE OF WELL OIL WELL <input checked="" type="checkbox"/> GAS WELL <input type="checkbox"/> OTHER <input type="checkbox"/>			6. IF INDIAN, ALLOTTEE OR TRIBAL NAME Navajo-Allotted	
2. NAME OF OPERATOR BEARD OIL COMPANY			7. UNIT AGREEMENT NAME None	
3. ADDRESS OF OPERATOR 2000 Classen Center, 200 So., Okla. City, Okla. 73106			8. FARM OR LEASE NAME Dosh e pi Henio	
4. LOCATION OF WELL (Report location clearly and in accordance with any State requirements.)* At surface 1650' FNL & 330' FWL of Sec. 17-17N-8W McKinley County, New Mexico* At proposed prod. zone Same			9. WELL NO. 2-X	
14. DISTANCE IN MILES AND DIRECTION FROM NEAREST TOWN OR POST OFFICE*			10. FIELD AND POOL, OR WILDCAT Lone Pine Dakota "D"	
15. DISTANCE FROM PROPOSED* LOCATION TO NEAREST PROPERTY OR LEASE LINE, FT. (Also to nearest drlg. line, if any) 330'			11. SEC., T., R., M., OR BLK. AND SURVEY OR AREA 17-17N-8W	
16. NO. OF ACRES IN LEASE 160			12. COUNTY OR PARISH McKinley	
17. NO. OF ACRES ASSIGNED TO THIS WELL 80			13. STATE New Mexico	
18. DISTANCE FROM PROPOSED LOCATION* TO NEAREST WELL, DRILLING, COMPLETED, OR APPLIED FOR, ON THIS LEASE, FT. 1320			20. ROTARY OR CABLE TOOLS Rotary	
21. ELEVATIONS (Show whether DF, RT, GK, etc.) 7006 GL			22. APPROX. DATE WORK WILL START Sept 1, 1971	

**PROPOSED CASING AND CEMENTING PROGRAM**

SIZE OF HOLE	SIZE OF CASING	WEIGHT PER FOOT	SETTING DEPTH	QUANTITY OF CEMENT
12-1/4"	8-5/8	24	75	50 SX
7-7/8"	4-1/2	9.5	3000	300 SX

1. Set 8-5/8" surface pipe w/Rathole Rig
2. Move in Rotary Tools and drill to approximate total depth 3000'
3. Run 4-1/2" casing, if commercial
5. Perforate Dakota "D" selectively
6. Acidize with 500 gallons 15% acid, if needed.
7. Run 2" tubing and test for production

\*This well will be replacement well for Dosh e pi Henio #2 which was non-commercial at location in same drilling unit, 1800' FNL and 330' FWL, and is now temporarily abandoned.

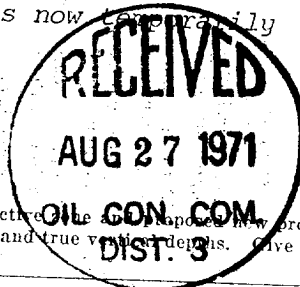

IN ABOVE SPACE DESCRIBE PROPOSED PROGRAM: If proposal is to deepen or plug back, give data on present production and proposed new productive zone. If proposal is to drill or deepen directionally, give pertinent data on subsurface locations and measured and true vertical depths. Give blowout preventer program, if any.

24. SIGNED Ivan D. Allred, Jr. TITLE Petroleum Engineer DATE 8-19-71  
(This space for Federal or State office use)

PERMIT NO. \_\_\_\_\_ APPROVAL DATE \_\_\_\_\_

APPROVED BY \_\_\_\_\_ TITLE \_\_\_\_\_ DATE \_\_\_\_\_  
CONDITIONS OF APPROVAL, IF ANY:

\*See Instructions On Reverse Side

RECEIVED

AUG 26 1971

U. S. GEOLOGICAL SURVEY

## Instructions

General: This form is designed for submitting proposals to perform certain well operations, as indicated, on all types of lands and leases for appropriate action by either a Federal or a State agency, or both, pursuant to applicable Federal and/or State laws and regulations. Any necessary special instructions concerning the use of this form and the number of copies to be submitted, particularly with regard to local, area, or regional procedures and practices, either are shown below or will be issued by, or may be obtained from, the local Federal and/or State office.

Item 1: If the proposal is to redrill to the same reservoir at a different subsurface location or to a new reservoir, use this form with appropriate notations. Consult applicable State or Federal regulations concerning subsequent work proposals or reports on the well.

Item 4: If there are no applicable State requirements, locations on Federal or Indian land should be described in accordance with Federal requirements. Consult local State or Federal office for specific instructions.

Item 14: Needed only when location of well cannot readily be found by road from the land or lease description. A plat, or plats, separate or on this reverse side, showing the roads to, and the surveyed location of, the well, and any other required information, should be furnished when required by Federal or State agency offices.

Items 15 and 18: If well is to be, or has been directionally drilled, give distances for subsurface location of hole in any present or objective production zone.

Item 22: Consult applicable Federal or State regulations, or appropriate officials, concerning approval of the proposal before operations are started.

# NEW MEXICO OIL CONSERVATION COMMISSION

## WELL LOCATION AND ACERAGE DEDICATION PLAT

All distances must be from the outer boundaries of the Section

Operator: **BEARD OIL COMPANY** Well No: **2-X**  
 Unit Letter: **E** Section: **17** Township: **17 NORTH** Range: **8 WEST** County: **MCKINLEY**  
 Actual Surface Location of Well: **1650** feet from the **NORTH** boundary of Section **330** feet from the **WEST** boundary of Section **80**  
 Ground Level: **7006.0** Formation: **DAKOTA "D"** **LOVE PINE DAKOTA "D"**

- Outline the acreage dedicated to the subject well by colored pencil or hatchure marks on the plat below.
  - If more than one lease is dedicated to the well, outline each and identify the owners (interest and royalty).
  - If more than one lease of different ownership is dedicated to the well, have the interests of all owners been consolidated by communitization, unitization, force-pooling, etc?
    - ☐ Yes ☐ No If answer is "yes," type of consolidation \_\_\_\_\_
    - If answer is "no," list the owners and tract descriptions which have actually consolidated. (Use reverse side of this form if necessary) \_\_\_\_\_
- No allowance will be assigned to the well until all interests have been consolidated (by communitization, unitization, force-pooling, or otherwise) or until a non-standard unit, eliminating such interests, has been approved by the Commission.



### CERTIFICATION

I hereby certify that the information contained herein is true and complete to the best of my knowledge and belief.

*Joan D. Allshut*  
 Name  
*Petroleum Engineer*  
 For Title  
*Beard Oil Co*  
 Company  
*August 25, 1971*  
 Date

I hereby certify that the well location shown on this plat was plotted from field notes of actual surveys made by me or under my supervision, and that the same is true and correct to the best of my knowledge and belief.

*James P. Lesse*  
 Date Surveyed: *23 August 1971*  
 Registered Professional Engineer and of Land Surveyor  
**JAMES P. LESSE**  
**1463**  
 Certificate No.

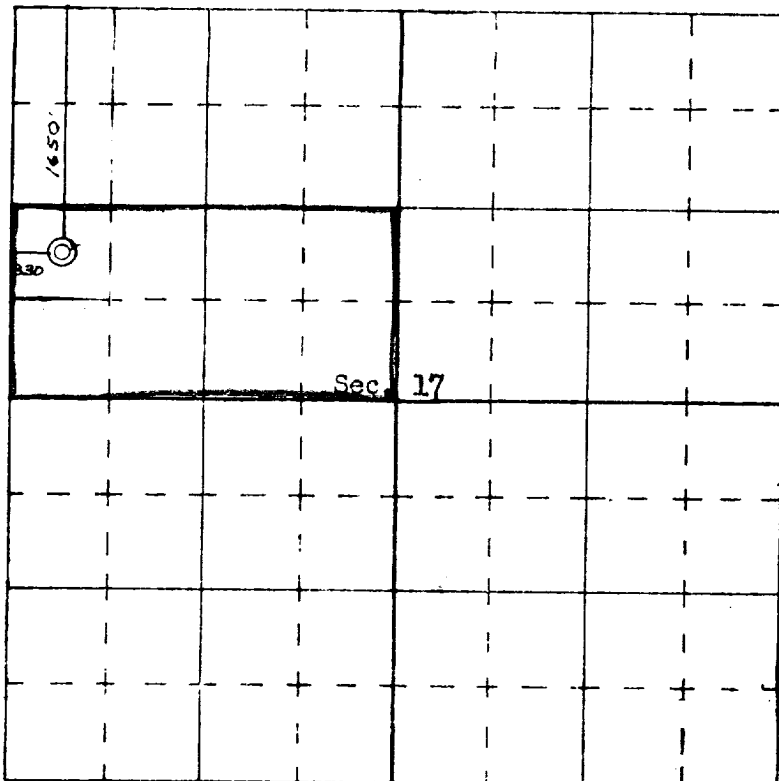

SCALE—4 INCHES EQUALS 1 MILE