

NO. OF COPIES RECEIVED	5
DISTRIBUTION	
SANTA FE	1
FILE	1 ✓
U.S.G.S.	2
LAND OFFICE	
OPERATOR	1

NEW MEXICO OIL CONSERVATION COMMISSION

Form C-101
Revised 1-1-65 30-031-20346

5A. Indicate Type of Lease	
STATE <input type="checkbox"/>	FEE <input checked="" type="checkbox"/>
5. State Oil & Gas Lease No.	
211826	

APPLICATION FOR PERMIT TO DRILL, DEEPEN, OR PLUG BACK

1a. Type of Work		7. Unit Agreement Name	
b. Type of Well DRILL <input checked="" type="checkbox"/> DEEPEN <input type="checkbox"/> PLUG BACK <input type="checkbox"/> OIL WELL <input checked="" type="checkbox"/> GAS WELL <input type="checkbox"/> OTHER <input type="checkbox"/> SINGLE ZONE <input type="checkbox"/> MULTIPLE ZONE <input type="checkbox"/>		8. Farm or Lease Name	
2. Name of Operator		9. Well No.	
R. A. Crane, Jr.		1	
3. Address of Operator		10. Field and Pool, or Wildcat	
101-2 Petroleum Plaza Bldg., Farmington, N.M. 87401		Wildcat	
4. Location of Well		12. County	
UNIT LETTER I LOCATED 2310 FEET FROM THE South LINE		McKinley	
AND 330 FEET FROM THE East LINE OF SEC. 15 TWP. 14N RGE. 8W NMPM			
19. Proposed Depth		19A. Formation	20. Rotary or C.T.
1500		Dakota	Rotary
21. Elevations (Show whether DF, RT, etc.)	21A. Kind & Status Plug. Bond	21B. Drilling Contractor	22. Approx. Date Work will start
7154 GL	State - Blanket	Stewart Bros.	9-9-1971

PROPOSED CASING AND CEMENT PROGRAM

SIZE OF HOLE	SIZE OF CASING	WEIGHT PER FOOT	SETTING DEPTH	SACKS OF CEMENT	EST. TOP
8 5/8"	7"	#26	30'	20	Surface

We propose to drill 5 5/8" hole under surface casing through the Dakota Formation and run casing and cement with 75 sacks, or if production is encountered on Dakota top casing might be run at this point.

Electrical survey will be run to total depth.



IN ABOVE SPACE DESCRIBE PROPOSED PROGRAM: IF PROPOSAL IS TO DEEPEN OR PLUG BACK, GIVE DATA ON PRESENT PRODUCTIVE ZONE AND PROPOSED NEW PRODUCTIVE ZONE. GIVE BLOWOUT PREVENTER PROGRAM, IF ANY.

I hereby certify that the information above is true and complete to the best of my knowledge and belief.

Signed R. A. Crane, Jr. Title Operator Date 9-8-1971
(This space for State Use)

APPROVED BY Curry TITLE SUPERVISOR DIST. #3 DATE 9-8-71
CONDITIONS OF APPROVAL, IF ANY:

NEW MEXICO OIL CONSERVATION COMMISSION

WELL LOCATION AND ACERAGE DEDICATION PLAT

All distances must be from the outer boundaries of the Section

Operator ROBERT A. CRANE JR.		Lease HORACEK		Well No. 1
Unit Letter I	Section 15	Township 14 NORTH	Range 8 WEST	County MC KINLEY
Actual Footage Location of Well: 2310 feet from the SOUTH line and 330 feet from the EAST line				
Ground Level Elev. 7154.0	Producing Formation Wildcat	Pool	Dedicated Acreage 40	Acres

1. Outline the acreage dedicated to the subject well by colored pencil or hatchure marks on the plat below.
2. If more than one lease is dedicated to the well, outline each and identify the ownership thereof (both as to working interest and royalty).
3. If more than one lease of different ownership is dedicated to the well, have the interests of all owners been consolidated by communitization, unitization, force-pooling, etc?
☐ Yes ☐ No If answer is "yes," type of consolidation

If answer is "no," list the owners and tract descriptions which have actually consolidated (Use reverse side of this form if necessary.)

No allowable will be assigned to the well until all interests have been consolidated (by communitization, unitization, forced-pooling, or otherwise) or until a non standard unit, eliminating such interests, has been approved by the Commission.

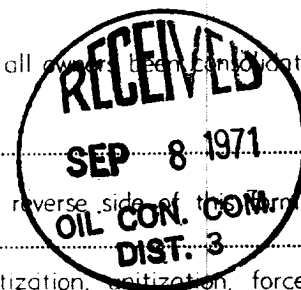

CERTIFICATION

I hereby certify that the information contained herein is true and complete to the best of my knowledge and belief.

W. M. Gallaway
 Name
Agent
 Position
R. A. Crane Jr
 Company

Date
9-8-1971

I hereby certify that the well location shown on this plat was plotted from field notes of actual surveys made by me or under my supervision, and that the same is true and correct to the best of my knowledge and belief.

James P. Leese
 Date
 Registered Professional Engineer
 and Land Surveyor
JAMES P. LEESE
1463
 Certificate No.

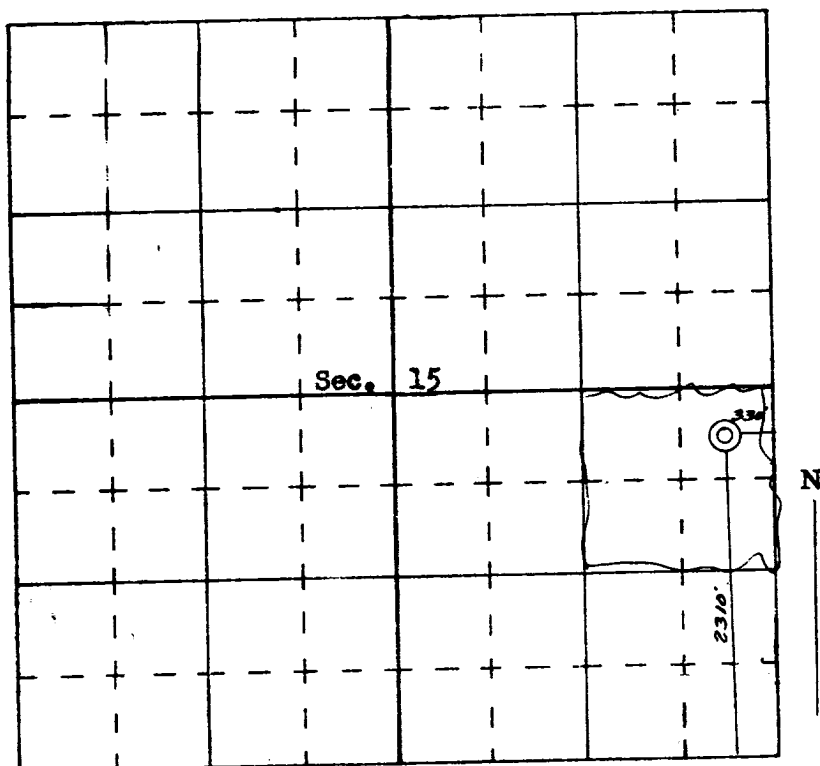

SCALE—4 INCHES EQUALS 1 MILE

SAN JUAN ENGINEERING COMPANY, FARMINGTON, N. M.