

NO. OF COPIES RECEIVED	5
DISTRIBUTION	
SANTA FE	1
FILE	1
U.S.G.S.	2
LAND OFFICE	
OPERATOR	1

RECEIVED
 NEW MEXICO OIL CONSERVATION COMMISSION
 OCT 21 1971
 OIL CONSERVATION COMM.
 SANTA FE

Form C-101
 Revised 1-1-65 30-031-20352

5A. Indicate Type of Lease	
STATE <input type="checkbox"/>	FEE <input type="checkbox"/>
5. State Oil & Gas Lease No.	

APPLICATION FOR PERMIT TO DRILL, DEEPEN, OR PLUG BACK

1a. Type of Work		7. Unit Agreement Name	
b. Type of Well DRILL <input checked="" type="checkbox"/> DEEPEN <input type="checkbox"/> PLUG BACK <input type="checkbox"/> OIL WELL <input type="checkbox"/> GAS WELL <input type="checkbox"/> OTHER <input type="checkbox"/> SINGLE ZONE <input type="checkbox"/> MULTIPLE ZONE <input type="checkbox"/>		8. Farm or Lease Name	
2. Name of Operator		9. Well No.	
3. Address of Operator		10. Field and Pool, or Wildcat	
4. Location of Well		12. County	
UNIT LETTER <u>T</u> LOCATED <u>150</u> FEET FROM THE <u>East</u> LINE		<u>McKinley</u>	
AND <u>150</u> FEET FROM THE <u>South</u> LINE OF SEC. <u>5</u> TWP. <u>1N</u> RGE. <u>4E</u> NMPM			
19. Proposed Depth		19A. Formation	20. Rotary or C.T.
21. Elevations (Show whether DF, RT, etc.)		21B. Drilling Contractor	22. Approx. Date Work will start
6500 ft.		Drilling Contractor	10/21/71

23. PROPOSED CASING AND CEMENT PROGRAM

SIZE OF HOLE	SIZE OF CASING	WEIGHT PER FOOT	SETTING DEPTH	SACKS OF CEMENT	EST. TOP
8 3/4"	7"	171	50'	30	

Proposed to drill 8 1/4" hole from surface casing to a depth sufficient to test the reservoir, run L.P. casing line to be followed by DST. In the event the well is cased 6" casing will be used.

Corrected Location



IN ABOVE SPACE DESCRIBE PROPOSED PROGRAM: IF PROPOSAL IS TO DEEPEN OR PLUG BACK, GIVE DATA ON PRESENT PRODUCTIVE ZONE AND PROPOSED NEW PRODUCTIVE ZONE, GIVE BLOWOUT PREVENTER PROGRAM, IF ANY.

I hereby certify that the information above is true and complete to the best of my knowledge and belief.

Signed [Signature] Title Supervisor Date Nov 1 1971

(This space for State Use)

APPROVED BY [Signature] TITLE SUPERVISOR DIST. #3 DATE NOV 1 1971

CONDITIONS OF APPROVAL, IF ANY:

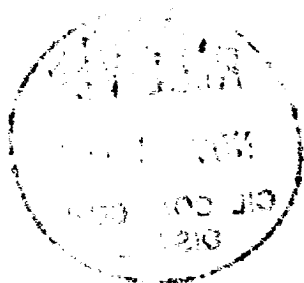

NEW MEXICO OIL CONSERVATION COMMISSION
WELL LOCATION AND ACREAGE DEDICATION PLAT

Form C-102
Supersedes C-128
Effective 1-1-65

RECEIVED

All distances must be from the outer boundaries of the Section

OCT 23 1971

Operator Shar-Alan Oil Corporation		Lease Fernandez		Oil Conservation Comm. SANTA FE		Well No. TWO
Unit Letter J	Section FIVE	Township 15 North	Range 6 West	County McKinley		
Actual Footage Location of Well: 1980 feet from the South line and 1980 feet from the East line						
Ground Level Elev. 6521	Producing Formation Dakota		Pool Wildcat		Dedicated Acreage: Acres	

1. Outline the acreage dedicated to the subject well by colored pencil or hatchure marks on the plat below.
2. If more than one lease is dedicated to the well, outline each and identify the ownership thereof (both as to working interest and royalty).
3. If more than one lease of different ownership is dedicated to the well, have the interests of all owners been consolidated by communitization, unitization, force-pooling, etc?

☐ Yes ☐ No If answer is "yes," type of consolidation _____

If answer is "no," list the owners and tract descriptions which have actually been consolidated. (Use reverse side of this form if necessary.) _____

No allowable will be assigned to the well until all interests have been consolidated (by communitization, unitization, forced-pooling, or otherwise) or until a non-standard unit, eliminating such interests, has been approved by the Commission.

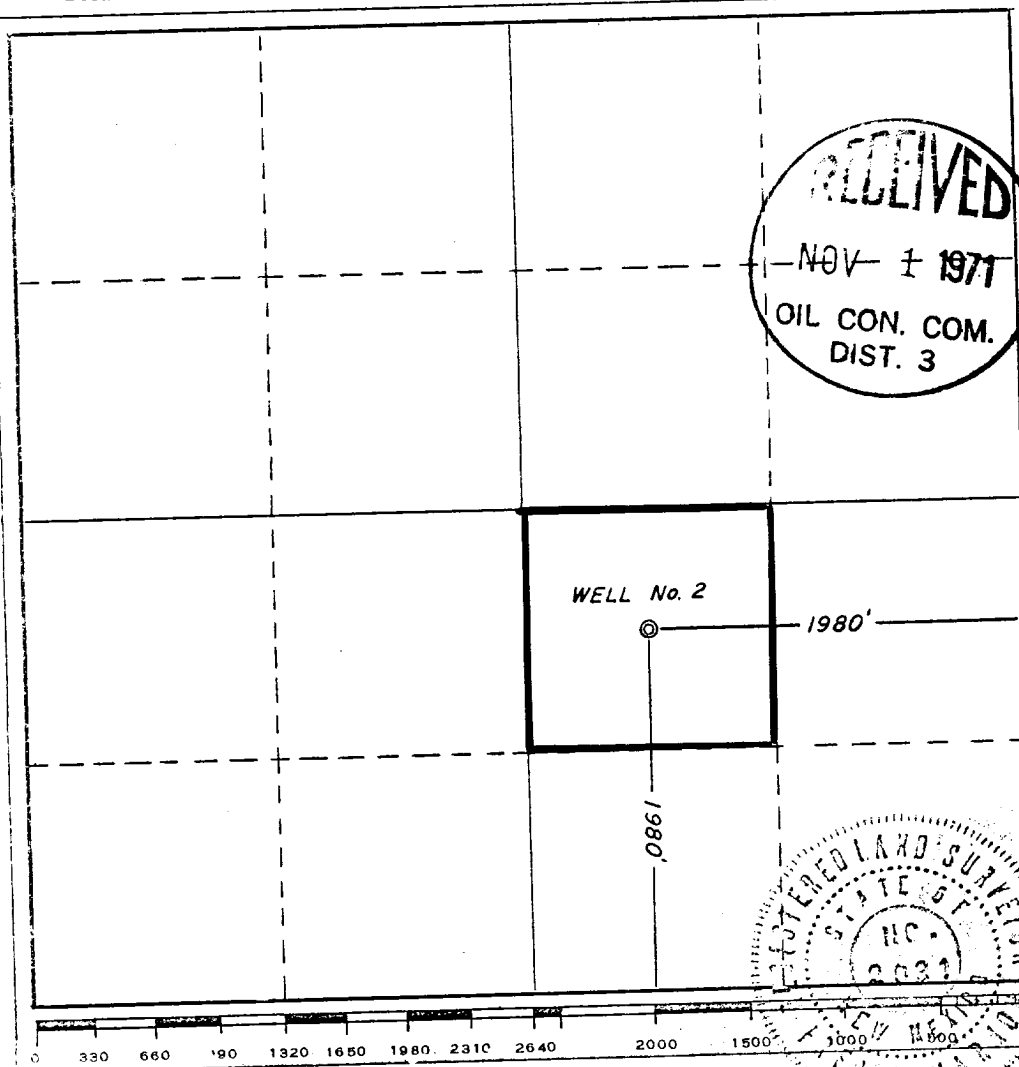

CERTIFICATION

I hereby certify that the information contained herein is true and complete to the best of my knowledge and belief.

Name

Land Manager

Position

Shar-Alan Oil Corporation
Company

Date

October 26, 1971

I hereby certify that the well location shown on this plat was plotted from field notes of actual surveys made by me or under my supervision, and that the same is true and correct to the best of my knowledge and belief.

Date Surveyed

October 21, 1971

Registered Professional Engineer
and/or Land Surveyor

Certificate No.

2031