

NO. OF COPIES RECEIVED	5
DISTRIBUTION	
SANTA FE	1
FILE	✓
U.S.G.S.	
LAND OFFICE	
OPERATOR	

# NEW MEXICO OIL CONSERVATION COMMISSION

Form C-101  
Revised 1-1-65 BC 031-20357

5A. Indicate Type of Lease
STATE <input type="checkbox"/> FEE <input checked="" type="checkbox"/>

5. State Oil & Gas Lease No.
------------------------------

## APPLICATION FOR PERMIT TO DRILL, DEEPEN, OR PLUG BACK

1a. Type of Work		7. Unit Agreement Name	
b. Type of Well OIL WELL <input type="checkbox"/> GAS WELL <input type="checkbox"/> OTHER <input type="checkbox"/> DRILL <input checked="" type="checkbox"/> DEEPEN <input type="checkbox"/> PLUG BACK <input type="checkbox"/>		8. Form or Lease Name BONITA	
2. Name of Operator Anderson Oil Company		9. Well No. 2	
3. Address of Operator 635 Majestic Building - Denver, Colorado 80202		10. Field and Pool, or Wildcat Wildcat	
4. Location of Well UNIT LETTER O LOCATED 660 FEET FROM THE South LINE AND 1980 FEET FROM THE East LINE OF SEC. 25 TWP. 20N RGE. 11W NMPM		12. County McKinley	
19. Proposed Depth 3700'		19A. Formation Morrison	20. Rotary or C.T. Rotary
21. Elevations (Show whether DP, RT, etc.) 6491.0 Ground	21A. Kind & Status Plug. Bond Blanket	21B. Drilling Contractor Young Drilling	22. Approx. Date Work will start Rig Availability

23. PROPOSED CASING AND CEMENT PROGRAM					
SIZE OF HOLE	SIZE OF CASING	WEIGHT PER FOOT	SETTING DEPTH	SACKS OF CEMENT	EST. TOP
12 1/4"	8 5/8"	24#	60"	cmtd. to sur.	
If production string is run, it will be 5 1/2" thru producing zone cemented to displace 600'.					

LOGGING: Induction Electrical Survey and BHC Formation Density log with Gamma Ray from base of surface casing to total depth. BHC Sonic log with Caliper over the Dakota formation and other zones of interest to a maximum of 1500' of interval logged.

MUD PROGRAM: Fresh water native mud which will be converted to a 10 cc water loss or less chemical base mud for drilling the Dakota.

Good oil field practice will be used in determining the necessity of coring and/or drill stem testing any shows of oil or gas encountered.

APPROVAL VALID  
FOR 90 DAYS UNLESS  
DRILLING COMMENCED,

EXPIRES 1-17-72

IN ABOVE SPACE DESCRIBE PROPOSED PROGRAM: IF PROPOSAL IS TO DEEPEN OR PLUG BACK, GIVE DATA ON PRESENT PRODUCTIVE ZONE AND PROPOSED NEW PRODUCTIVE ZONE. GIVE BLOWOUT PREVENTER PROGRAM, IF ANY.

I hereby certify that the information above is true and complete to the best of my knowledge and belief.

Signed Alvin R. Ramey Title Chief Clerk Date 10-14-71

(This space for State Use)

APPROVED BY Ernest C. Clavel TITLE Sup. Dist. III DATE 10-18-71

CONDITIONS OF APPROVAL, IF ANY:

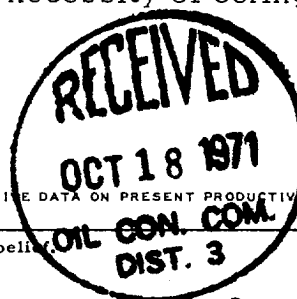

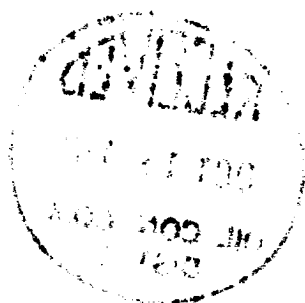

NEW YORK  
OCT 13 1900

# NEW MEXICO OIL CONSERVATION COMMISSION

## WELL LOCATION AND ACERAGE DEDICATION PLAT

All distances must be from the outer boundaries of the Section

Operator <b>ANDERSON OIL COMPANY</b>			Lease <b>BONITA</b>		Well No. <b>2</b>
Unit Letter <b>0</b>	Section <b>25</b>	Township <b>20 NORTH</b>	Range <b>11 WEST</b>	County <b>Mc KINLEY</b>	
Actual Footage Location of Well: <b>660</b> feet from the <b>SOUTH</b> line and <b>1980</b> feet from the <b>EAST</b> line					
Ground Level Elev. <b>6491.0</b>	Producing Formation	Pool <b>WC</b>		Dedicated Acreage: <b>40</b> Acres	

1. Outline the acreage dedicated to the subject well by colored pencil or hachure marks on the plat below.
2. If more than one lease is dedicated to the well, outline each and identify the ownership thereof (both as to working interest and royalty).
3. If more than one lease of different ownership is dedicated to the well, have the interests of all owners been consolidated by communization, unitization, force-pooling, etc?

( ) Yes ( ) No If answer is "yes," type of consolidation .....

If answer is "no," list the owners and tract descriptions which have actually consolidated. Use reverse side of this form if necessary.) .....

No allowable will be assigned to the well until all interests have been consolidated (by communization, unitization, forced-pooling, or otherwise) or until a non standard unit, eliminating such interests, has been approved by the Commission.



### CERTIFICATION

I hereby certify that the information contained herein is true and complete to the best of my knowledge and belief.

Name \_\_\_\_\_  
 Position \_\_\_\_\_  
 Company \_\_\_\_\_  
 Date \_\_\_\_\_

I hereby certify that the well location shown on this plat was plotted from field notes of actual surveys made by me or under my supervision, and that the same is true and correct to the best of my knowledge and belief.

12 October 1971  
 Date Surveyed  
 NO. P.  
 Registered Professional Engineer  
 and Land Surveyor  
 STATE OF NEW MEXICO  
 JAMES P. LEESE  
 11-89  
 Certificate No. \_\_\_\_\_

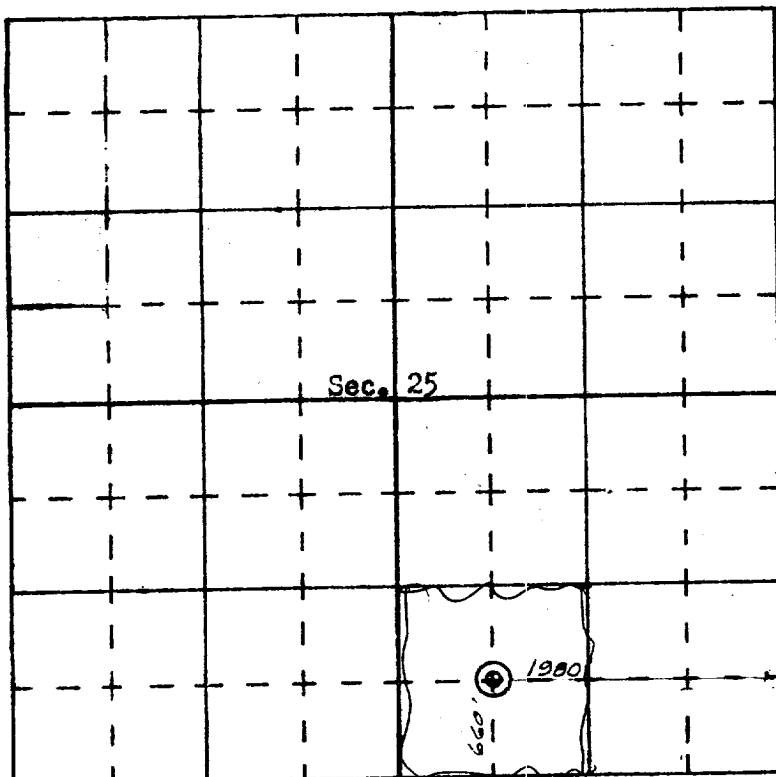

SCALE—4 INCHES EQUALS 1 MILE

SAN JUAN ENGINEERING COMPANY, FARMINGTON, N. M.