

UNITED STATES
DEPARTMENT OF THE INTERIOR
GEOLOGICAL SURVEY

30-031-20370

APPLICATION FOR PERMIT TO DRILL, DEEPEN, OR PLUG BACK

1a. TYPE OF WORK
 DRILL DEEPEN PLUG BACK

b. TYPE OF WELL
 OIL WELL GAS WELL OTHER
 SINGLE ZONE MULTIPLE ZONE

2. NAME OF OPERATOR
Tesoro Petroleum Corporation

3. ADDRESS OF OPERATOR
Suite 1012 Denver Center Building, Denver, Colo. 80203

4. LOCATION OF WELL (Report location clearly and in accordance with any State requirements.)
 At surface
1600' FSL, 330 FEL Section 6, T6N, R8W
 At proposed prod. zone
Same

14. DISTANCE IN MILES AND DIRECTION FROM NEAREST TOWN OR POST OFFICE*
1 mile east Hospah N. M.

15. DISTANCE FROM PROPOSED* LOCATION TO NEAREST PROPERTY OR LEASE LINE, FT. (Also to nearest drlg. unit line, if any)
330'

16. NO. OF ACRES IN LEASE
551.94 ac. ±

17. NO. OF ACRES ASSIGNED TO THIS WELL
40

18. DISTANCE FROM PROPOSED LOCATION* TO NEAREST WELL, DRILLING, COMPLETED, OR APPLIED FOR, ON THIS LEASE, FT.

19. PROPOSED DEPTH
2660'

20. ROTARY OR CABLE TOOLS
Rotary

21. ELEVATIONS (Show whether DF, RT, GR, etc.)
6860' GR.

22. APPROX. DATE WORK WILL START*
August 1, 1973

23. PROPOSED CASING AND CEMENTING PROGRAM

SIZE OF HOLE	SIZE OF CASING	WEIGHT PER FOOT	SETTING DEPTH	QUANTITY OF CEMENT
13-3/4	8-5/8	24	100' +	160 sacks
7-7/8	5-1/2	14.0	2645 ±	250 sacks
4-3/4	Open hole		15' into Dakota "D"	

We propose to drill a 13-3/4" hole to 100'; run 8-5/8" casing and cement to surface. We will then drill a 7-7/8" hole to 2645'; run 5-1/2" casing and cement with 250 sacks 50/50 Poz "G" 5% NaCl. We will then move in a completion rig, circulate the hole with Hospah crude and drill 10'-15' open 4-3/4" hole. The well will be placed on pump for a short P.L. test; then, we will frac the well with "YFO" gelled Dakota crude and sand. The well will then be potentialled and placed on production. a BOP will be installed on the 8-5/8" casing and used throughout the drilling and completion operation.

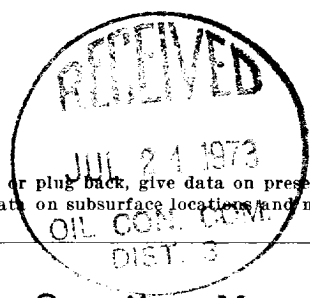

IN ABOVE SPACE DESCRIBE PROPOSED PROGRAM: If proposal is to deepen or plug back, give data on present productive zone and proposed new productive zone. If proposal is to drill or deepen directionally, give pertinent data on subsurface locations and measured and true vertical depths. Give blowout preventer program, if any.

24. SIGNED J. Harvey Ashford, Jr. TITLE Operations Manager DATE 7/19/73

(This space for Federal or State office use)

PERMIT NO. _____ APPROVAL DATE _____

APPROVED BY [Signature] TITLE _____
 CONDITIONS OF APPROVAL, IF ANY:



JUL 21 1973

U. S. GEOLOGICAL SURVEY

Instructions

General: This form is designed for submitting proposals to perform certain well operations, as indicated, on all types of lands and leases for appropriate action by either a Federal or a State agency, or both, pursuant to applicable Federal and/or State laws and regulations. Any necessary special instructions concerning the use of this form and the number of copies to be submitted, particularly with regard to local, area, or regional procedures and practices, either are shown below or will be issued by, or may be obtained from, the local Federal and/or State office.

Item 1: If the proposal is to redrill to the same reservoir at a different subsurface location or to a new reservoir, use this form with appropriate notations. Consult applicable State or Federal regulations concerning subsequent work proposals or reports on the well. Consult local

Item 4: If there are no applicable State requirements, locations of Federal or Indian land should be described in accordance with Federal requirements. Consult local State or Federal office for specific instructions.

Item 14: Needed only when location of well cannot readily be found by road from the land or lease description. A plat, or plats, separate or on this reverse side, showing the roads to, and the surveyed location of, the well, and any other required information, should be furnished when required by Federal or State agency offices.

Items 15 and 18: If well is to be, or has been directionally drilled, give distances for subsurface location of hole in any present or objective production zone.

Item 22: Consult applicable Federal or State regulations, or appropriate officials, concerning approval of the proposal before operations are started.

**NEW MEXICO OIL CONSERVATION COMMISSION
WELL LOCATION AND ACERAGE DEDICATION PLAT**

All distances must be from the outer boundaries of the Section

Operator TESORO PETROLEUM CORPORATION		Lease HANSON		Well No 24	
Unit Letter I	Section 6	Township 17 North	Range 8 West	County McKinley	
Actual Footage Location of Well: 1600 feet from the South line and 330 feet from the East line					
Ground Level Elev. 6860	Producing Formation Dakota "D"	Pool Hospah Dakota Extension	Dedicated Acreage 40		Acres

1. Outline the acreage dedicated to the subject well by colored pencil or hachure marks on the plat below.
2. If more than one lease is dedicated to the well, outline each and identify the ownership thereof (both as to working interest and royalty).
3. If more than one lease of different ownership is dedicated to the well, have the interests of all owners been consolidated by communitization, unitization, force-pooling, etc?

Yes No If answer is "yes," type of consolidation
 If answer is "no," list the owners and tract descriptions which have actually consolidated. (Use reverse side of this form if necessary)

No allowable will be assigned to the well until all interests have been consolidated (by communitization, unitization, forced-pooling, or otherwise) or until a non standard unit, eliminating such interests, has been approved by the Commission.



CERTIFICATION

I hereby certify that the information contained herein is true and complete to the best of my knowledge and belief.

J. Harvey Ashford, Jr.
 Name
J. Harvey Ashford, Jr.
 Position

Operations Manager
 Company
Tesoro Petroleum Corporation
 Date
7/17/73

I hereby certify that the well location shown on this plat was plotted from field notes of actual surveys made by me or under my supervision, and that the same is true and correct to the best of my knowledge and belief.

13 July 1973
 Date Signed
Robert H. Ernst
 Registered Professional Engineer
 and/or Land Surveyor
Robert H. Ernst
New Mexico PE & LS 2463

Certificate No. _____

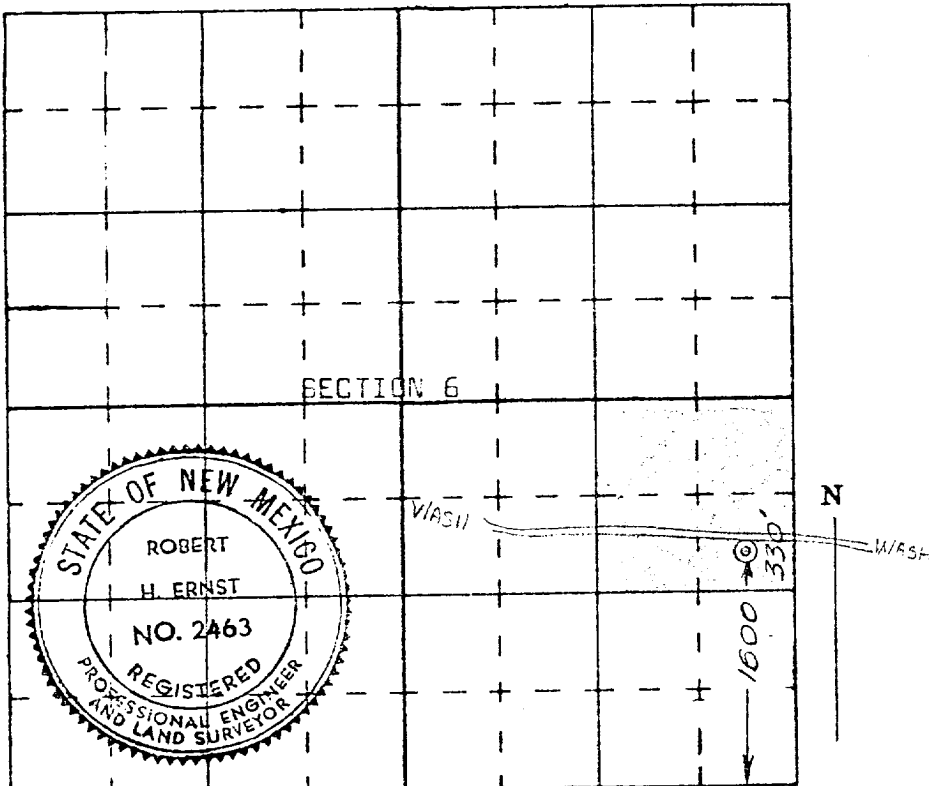

**ERNST ENGINEERING COMPANY
DURANGO, COLORADO**