

NO. OF COPIES RECEIVED	5
DISTRIBUTION	
SANTA FE	1
FILE	1
U.S.G.S.	2
LAND OFFICE	
OPERATOR	1

NEW MEXICO OIL CONSERVATION COMMISSION

30-031-20377
Form C-101
Revised 1-1-65

5A. Indicate Type of Lease	
STATE <input type="checkbox"/>	FEE <input checked="" type="checkbox"/>

5. State Oil & Gas Lease No.

APPLICATION FOR PERMIT TO DRILL, DEEPEN, OR PLUG BACK

1a. Type of Work		7. Unit Agreement Name	
b. Type of Well DRILL <input checked="" type="checkbox"/> DEEPEN <input type="checkbox"/> PLUG BACK <input type="checkbox"/> OIL WELL <input checked="" type="checkbox"/> GAS WELL <input type="checkbox"/> OTHER <input type="checkbox"/> SINGLE ZONE <input type="checkbox"/> MULTIPLE ZONE <input type="checkbox"/>		8. Farm or Lease Name SFPRR	
2. Name of Operator Northern Minerals, Inc.		9. Well No. 8	
3. Address of Operator P. O. Box 2182, Santa Fe, New Mexico 87501		10. Field and Pool, or Wildcat Wildcat	
4. Location of Well UNIT LETTER <u>G</u> LOCATED <u>2310'</u> FEET FROM THE <u>North</u> LINE AND <u>2310</u> FEET FROM THE <u>East</u> LINE OF SEC. <u>29</u> TWP. <u>16N</u> RGE. <u>6W</u> NMPM		12. County McKinley	
19. Proposed Depth 760'		19A. Formation Hospah	20. Rotary or C.T. Rotary
21. Elevations (Show whether DE, RT, etc.) 6424	21A. Kind & Status Plug Bond Statewide	21B. Drilling Contractor Stewart Brothers	22. Approx. Date Work will start Upon Approval

23.

PROPOSED CASING AND CEMENT PROGRAM

SIZE OF HOLE	SIZE OF CASING	WEIGHT PER FOOT	SETTING DEPTH	SACKS OF CEMENT	EST. TOP
6-1/4"	4-1/2"	9 lb.	750'	Sufficient to Circulate	

This well will be a 760' Hospah sand test. Hospah will be cored and if deemed advisable, casing will be run and completion attempt made.

APPROVAL VALID
FOR 90 DAYS UNLESS
DRILLING COMMENCED
EXPIRES 12-10-73



IN ABOVE SPACE DESCRIBE PROPOSED PROGRAM: IF PROPOSAL IS TO DEEPEN OR PLUG BACK, GIVE DATA ON PRESENT PRODUCTIVE ZONE AND PROPOSED NEW PRODUCTIVE ZONE. GIVE BLOWOUT PREVENTER PROGRAM, IF ANY.

I hereby certify that the information above is true and complete to the best of my knowledge and belief.

Signed Leopold D. Anderson Title President Date 9-5-73

(This space for State Use)

APPROVED BY [Signature] TITLE SUPERVISOR DIST. #3 DATE SEP 11 1973

CONDITIONS OF APPROVAL, IF ANY:

NEW MEXICO OIL CONSERVATION COMMISSION
WELL LOCATION AND ACREAGE DEDICATION PLAT

Form C-102
Supersedes C-128
Effective 1-1-65

All distances must be from the outer boundaries of the Section.

Operator Northern Minerals, Inc.		Lease SFPRR		Well No. 8	
Unit Letter	Section 29	Township 16 NORTH	Range 6 WEST	County McKINLEY	
Actual Footage Location of Well: 2310 feet from the NORTH line and 2310 feet from the EAST line					
Ground Level Elev. 6424	Producing Formation Hospah		Pool	Dedicated Acreage: 40 Acres	

1. Outline the acreage dedicated to the subject well by colored pencil or hatchure marks on the plat below.
2. If more than one lease is dedicated to the well, outline each and identify the ownership thereof (both as to working interest and royalty).
3. If more than one lease of different ownership is dedicated to the well, have the interests of all owners been consolidated by communitization, unitization, force-pooling, etc?

☐ Yes ☐ No If answer is "yes," type of consolidation _____

If answer is "no," list the owners and tract descriptions which have actually been consolidated. (Use reverse side of this form if necessary.) _____

No allowable will be assigned to the well until all interests have been consolidated (by communitization, unitization, forced-pooling, or otherwise) or until a non-standard unit, eliminating such interests, has been approved by the Commission.

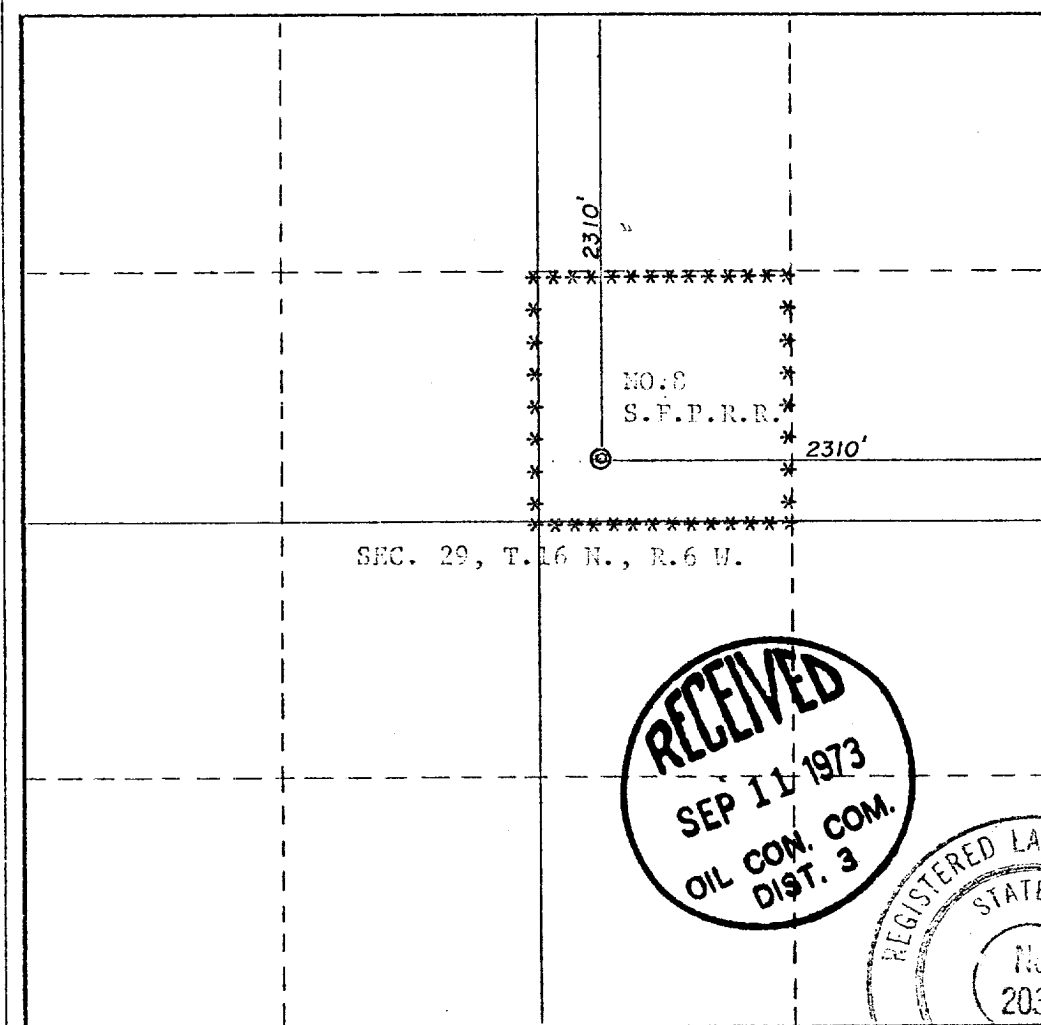

CERTIFICATION

I hereby certify that the information contained herein is true and complete to the best of my knowledge and belief.

Lloyd Davidson
Name

Lloyd Davidson

Position
President

Company
Northern Minerals, Inc.

Date
9-5-73

I hereby certify that the well location shown on this plat was plotted from field notes of actual surveys made by me or under my supervision, and that the same is true and correct to the best of my knowledge and belief.

Date Surveyed
SEPT. 1, 1973

Registered Professional Engineer and/or Land Surveyor

W. D. Marmion

Certificate No. 2031

0 330 660 990 1320 1650 1980 2310 2640 2000 1500 1000 500