

NO. OF COPIES RECEIVED	6
DISTRIBUTION	
SANTA FE	1
FILE	1
U.S.G.S.	2
LAND OFFICE	1
OPERATOR	1

# NEW MEXICO OIL CONSERVATION COMMISSION

30 631-20378

Form C-101  
Revised 1-1-65

5A. Indicate Type of Lease	
STATE <input checked="" type="checkbox"/>	FEE <input type="checkbox"/>
5. State Oil & Gas Lease No. <b>K 2462</b>	

## APPLICATION FOR PERMIT TO DRILL, DEEPEN, OR PLUG BACK

1a. Type of Work		7. Unit Agreement Name	
b. Type of Well DRILL <input checked="" type="checkbox"/> DEEPEN <input type="checkbox"/> PLUG BACK <input type="checkbox"/> OIL WELL <input type="checkbox"/> GAS WELL <input type="checkbox"/> OTHER <input type="checkbox"/> SINGLE ZONE <input type="checkbox"/> MULTIPLE ZONE <input type="checkbox"/>		8. Farm or Lease Name <b>Jaco</b>	
2. Name of Operator <b>K &amp; W Oil Co.</b>		9. Well No. <b>115</b>	
3. Address of Operator <b>Box 2022 Farmington, New Mexico</b>		10. Field and Pool, or Wildcat <b>Undesignated</b>	
4. Location of Well UNIT LETTER <b>H</b> LOCATED <b>1650</b> FEET FROM THE <b>North</b> LINE <b>836</b> FEET FROM THE <b>East</b> LINE OF SEC. <b>32</b> TWP. <b>20N</b> RGE. <b>9W</b> NMPM		12. County <b>McKinley</b>	
19. Proposed Depth <b>1100</b>		19A. Formation <b>Manefee</b>	
20. Rotary or C.T. <b>Rotary</b>		21. Elevations (Show whether DF, RT, etc.) <b>6481</b>	
21A. Kind & Status Plug. Bond <b>one Well</b>		21B. Drilling Contractor <b>Company Tools</b>	
22. Approx. Date Work will start <b>Oct. 3, 1973</b>			

23.

## PROPOSED CASING AND CEMENT PROGRAM

SIZE OF HOLE	SIZE OF CASING	WEIGHT PER FOOT	SETTING DEPTH	SACKS OF CEMENT	EST. TOP
12 1/4	8 5/8	20	30	15 sks.	
6 3/4	4 1/2	9.5	1070	75 sks	

Test for Manefee at 1080 - 1100 if no production will plug back to 400' and try for production.

APPROVAL VALID  
FOR 90 DAYS UNLESS  
DRILLING COMMENCED,  
EXPIRES 12-30-73



IN ABOVE SPACE DESCRIBE PROPOSED PROGRAM: IF PROPOSAL IS TO DEEPEN OR PLUG BACK, GIVE DATA ON PRESENT PRODUCTIVE ZONE AND PROPOSED NEW PRODUCTIVE ZONE. GIVE BLOWOUT PREVENTER PROGRAM, IF ANY.

I hereby certify that the information above is true and complete to the best of my knowledge and belief.

Signed Louis M. Wyman Title Pres. Date Oct 1-1973

(This space for State Use)

APPROVED BY AK Kendrick TITLE \_\_\_\_\_ DATE \_\_\_\_\_

CONDITIONS OF APPROVAL, IF ANY:

**NEW MEXICO OIL CONSERVATION COMMISSION  
WELL LOCATION AND ACERAGE DEDICATION PLAT**

All distances must be from the outer boundaries of the Section

Operator <b>LOUIS M. WYMAN</b>			Lease <b>Zero</b>		Well No. <b>115</b>
Unit Letter <b>A</b>	Section <b>32</b>	Township <b>20 NORTH</b>	Range <b>9 WEST</b>	County <b>McKINLEY</b>	
Actual Footage Location of Well: <b>1650</b> feet from the <b>NORTH</b> line and <b>836</b> feet from the <b>EAST</b> line					
Ground Level Elev. <b>6481.0</b>	Producing Formation <b>Mesaero</b>	Pool <b>Undesignated</b>	Dedicated Acreage: <b>40</b> Acres		

- Outline the acreage dedicated to the subject well by colored pencil or hatchure marks on the plat below.
- If more than one lease is dedicated to the well, outline each and identify the ownership thereof (both as to working interest and royalty).
- If more than one lease of different ownership is dedicated to the well, have the interests of all owners been consolidated by communitization, unitization, force-pooling, etc?

( ) Yes ( ) No If answer is "yes," type of consolidation .....

If answer is "no," list the owners and tract descriptions which have actually consolidated. (Use reverse side of this form if necessary.) .....

No allowable will be assigned to the well until all interests have been consolidated (by communitization, unitization, forced-pooling, or otherwise) or until a non standard unit, eliminating such interests, has been approved by the Commission.

**CERTIFICATION**

I hereby certify that the information contained herein is true and complete to the best of my knowledge and belief.

Name Louis M. Wyman  
Position President  
Company F & V Oil Co.  
Date Oct. 1 1973

I hereby certify that the well location shown on this plat was plotted from field notes of actual surveys made by me or under my supervision, and that the same is true and correct to the best of my knowledge and belief.

Date Surveyed 3 August 1973  
Registered Professional Engineer  
and/or Land Surveyor James P. Leese

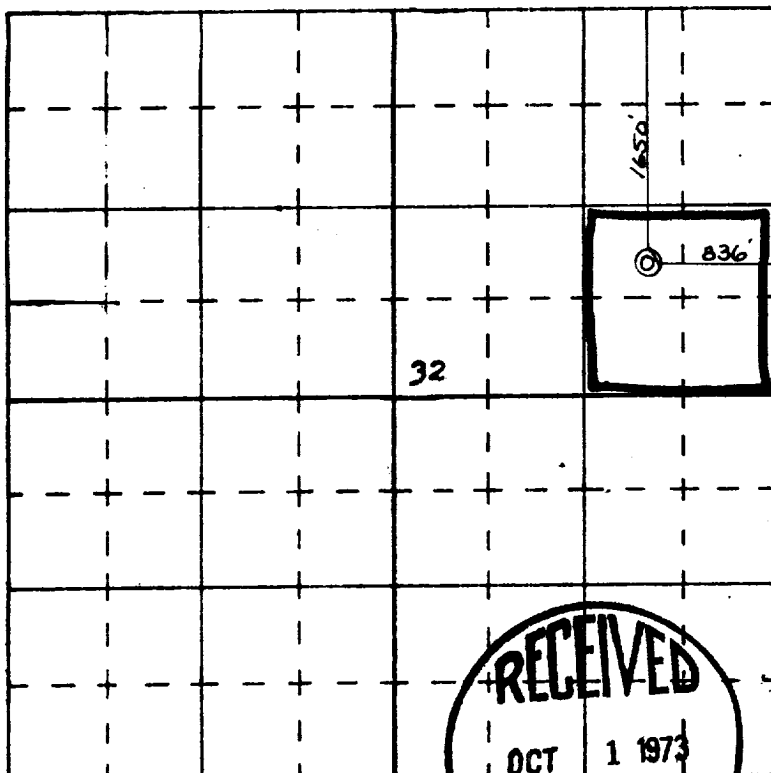

SCALE—4 INCHES EQUALS 1 MILE

SAN JUAN ENGINEERING COMPANY,

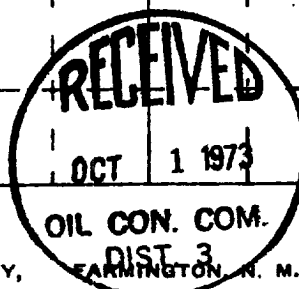

Certificate No. 1463