

CONDITIONS OF APPROVAL, IF ANY:

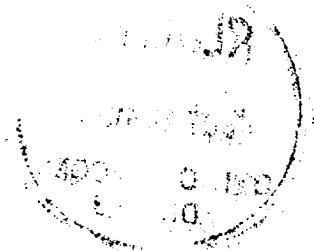
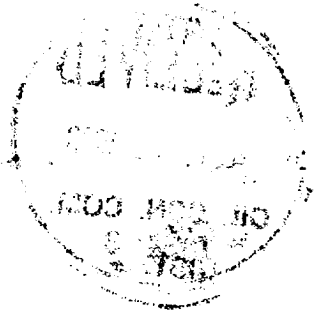

NEW MEXICO OIL CONSERVATION COMMISSION

WELL LOCATION AND ACERAGE DEDICATION PLAT

All distances must be from the outer boundaries of the Section

Operator Ramsey Petroleum Co.			Lease "Continental Divide".		Well No 1.
Unit Letter B	Section 13	Township 16 North	Range 10 West	County McKinley	
Actual Footage Location of Well: 660 feet from the North line and 1980 feet from the East line					
Ground Level Elev 7255	Producing Formation		Pool Wildcat.	Dedicated Acreage 160 Acres	

- Outline the acreage dedicated to the subject well by colored pencil or hatchure marks on the plat below.
- If more than one lease is dedicated to the well, outline each and identify the ownership thereof (both as to working interest and royalty).
- If more than one lease of different ownership is dedicated to the well, have the interests of all owners been consolidated by communitization, unitization, force-pooling, etc?

() Yes () No If answer is "yes," type of consolidation

If answer is "no," list the owners and tract descriptions which have actually consolidated. (Use reverse side of this form if necessary.) All one lease and mineral ownership. Santa Fe Pacific Railroad Co.

No allowable will be assigned to the well until all interests have been consolidated (by communitization, unitization, forced-pooling, or otherwise) or until a non standard unit, eliminating such interests, has been approved by the Commission.

CERTIFICATION

I hereby certify that the information contained herein is true and complete to the best of my knowledge and belief.

Arthur B. Ramsey
Name
Owner
Position
Ramsey Petroleum Co.
Company
Date October 23, 1973.

I hereby certify that the well location shown on this plat was derived from field notes of actual survey made by me or under my supervision, and that the same is true and correct to the best of my knowledge and belief.

Date Surveyed September 24, 1973
Registered Professional Engineer
and/or Land Surveyor

E. V. Echhawk
Certificate No. 3602
E. V. Echhawk LS

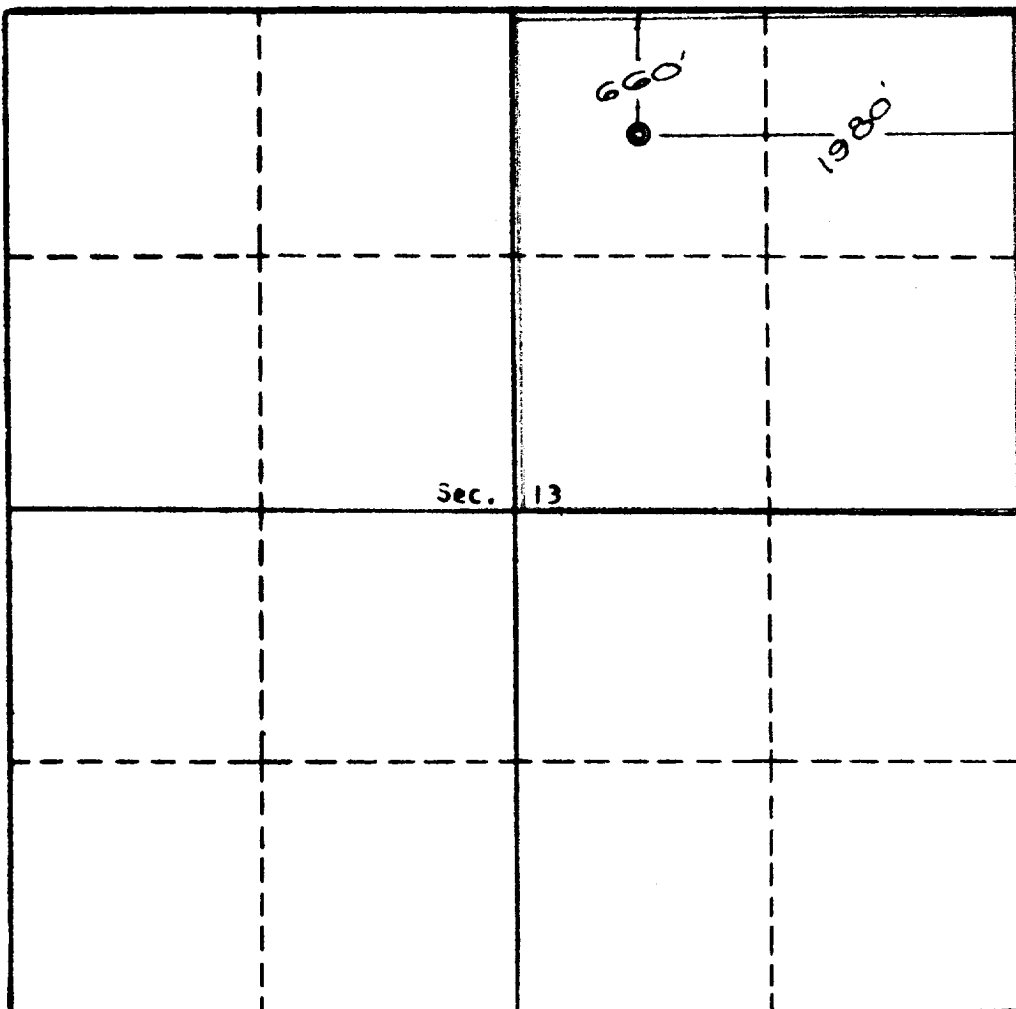

Scale, 1 inch = 1,000 feet

18



101
101 C

101 C