

|                        |   |
|------------------------|---|
| NO. OF COPIES RECEIVED | 5 |
| DISTRIBUTION           |   |
| SANTA FE               | 1 |
| FILE                   | 1 |
| U.S.G.S.               | 2 |
| LAND OFFICE            |   |
| OPERATOR               | 1 |

## NEW MEXICO OIL CONSERVATION COMMISSION

30-031-20321

Form C-101  
Revised 1-1-65

|                                    |                              |
|------------------------------------|------------------------------|
| 5A. Indicate Type of Lease         |                              |
| STATE <input type="checkbox"/>     | FEE <input type="checkbox"/> |
| 5. <del>XXXXXXXXXXXXXXXXXXXX</del> |                              |
| Santa Fe R. R. lands.              |                              |

## APPLICATION FOR PERMIT TO DRILL, DEEPEN, OR PLUG BACK

|   |  |   |  |  |  |
|---|--|---|--|--|--|
| 1a. Type of Work  |  |   |  | 7. Unit Agreement Name                                 |  |
| b. Type of Well<br>DRILL <input checked="" type="checkbox"/> DEEPEN <input type="checkbox"/> PLUG BACK <input type="checkbox"/><br>OIL WELL <input type="checkbox"/> GAS WELL <input type="checkbox"/> OTHER <input type="checkbox"/> SINGLE ZONE <input type="checkbox"/> MULTIPLE ZONE <input type="checkbox"/> |  |   |  | none.  |  |
| 2. Name of Operator<br>Ramsey Petroleum Co.   |  |   |  | 8. Farm or Lease Name<br>"Cactus Flower"               |  |
| 3. Address of Operator<br>P. O. Box 11446. Albuquerque, N. M. 87112.  |  |   |  | 9. Well No.<br>1.                                      |  |
| 4. Location of Well<br>UNIT LETTER <u>E</u> LOCATED <u>1500'</u> FEET FROM THE <u>North</u> LINE<br>AND <u>860'</u> FEET FROM THE <u>West</u> LINE OF SEC. <u>20</u> TWP. <u>17-N</u> , RGE. <u>7-W</u> . NMPM  |  |   |  | 10. Field and Pool, or Wildcat<br>Wildcat.             |  |
|   |  |   |  | 12. County<br>McKinley                                 |  |
| 19. Proposed Depth<br>4,150 feet  |  | 19A. Formation<br>Entrada                           |  | 20. Rotary or C.T.<br>Rotary                           |  |
| 21. Elevations (Show whether DF, RT, etc.)<br>6807' Ground.   |  | 21A. Kind & Status Plug. Bond<br>\$10,000. Blanket. |  | 21B. Drilling Contractor<br>Signal Oilfield Serv. Co.  |  |
|   |  |   |  | 22. Approx. Date Work will start<br>November 14, 1973. |  |

## PROPOSED CASING AND CEMENT PROGRAM

| SIZE OF HOLE                 | SIZE OF CASING | WEIGHT PER FOOT | SETTING DEPTH | SACKS OF CEMENT | EST. TOP |
|------------------------------|----------------|-----------------|---------------|-----------------|----------|
| 12-1/4"                      | 8-5/8"         | 24#             | 100 feet.     | Circulate       | Surface  |
| If productive of oil or gas: |                |                 |               |                 |          |
| 7-7/8"                       | 5-1/2"         | 15.50#          |               |                 |          |

Blowout preventer will be used throughout drilling operations:

BOP Size: 10". API Series: 900 No. &amp; Style: Shaffer. Tested: Daily.

APPROVAL VALID  
FOR 90 DAYS UNLESS  
DRILLING COMMENCED,

EXPIRES 2-7-74



IN ABOVE SPACE DESCRIBE PROPOSED PROGRAM; IF PROPOSAL IS TO DEEPEN OR PLUG BACK, GIVE DATA ON PRESENT PRODUCTIVE ZONE AND PROPOSED NEW PRODUCTIVE ZONE. GIVE BLOWOUT PREVENTER PROGRAM, IF ANY.

I hereby certify that the information above is true and complete to the best of my knowledge and belief.

Signed Arthur B. Ramsey Title Operator Date November 3, 1973

(This space for State Use)

APPROVED BY Ernest Clever TITLE \_\_\_\_\_ DATE \_\_\_\_\_

CONDITIONS OF APPROVAL, IF ANY:

# NEW MEXICO OIL CONSERVATION COMMISSION

## WELL LOCATION AND ACERAGE DEDICATION PLAT

All distances must be from the outer boundaries of the Section

|   |                      |                             |                                  |  |                       |
|---|----------------------|-----------------------------|----------------------------------|--|-----------------------|
| Operator<br><b>Ramsey Petroleum Co.</b>   |                      |                             | Lease<br><b>"Cactus Flower".</b> |  | Well No.<br><b>1.</b> |
| Unit Letter<br><b>E</b>   | Section<br><b>20</b> | Township<br><b>17 North</b> | Range<br><b>7 West</b>           | County<br><b>McKinley</b>              |                       |
| Actual Footage Location of Well:<br><b>1500</b> feet from the <b>North</b> line and <b>860</b> feet from the <b>West</b> line |                      |                             |                                  |  |                       |
| Ground Level Elev.<br><b>6807</b>   | Producing Formation  |                             | Pool<br><b>Wildcat</b>           | Dedicated Acreage:<br><b>160</b> Acres |                       |

- Outline the acreage dedicated to the subject well by colored pencil or hachure marks on the plat below.
- If more than one lease is dedicated to the well, outline each and identify the ownership thereof (both as to working interest and royalty).
- If more than one lease of different ownership is dedicated to the well, have the interests of all owners been consolidated by communitization, unitization, force-pooling, etc?  
( ) Yes ( ) No If answer is "yes," type of consolidation .....

If answer is "no," list the owners and tract descriptions which have actually consolidated. (Use reverse side of this form if necessary.) All one lease, all minerals owned by Santa Fe Pacific Railroad Company.

No allowable will be assigned to the well until all interests have been consolidated (by communitization, unitization, forced-pooling, or otherwise) or until a non standard unit, eliminating such interests, has been approved by the Commission.

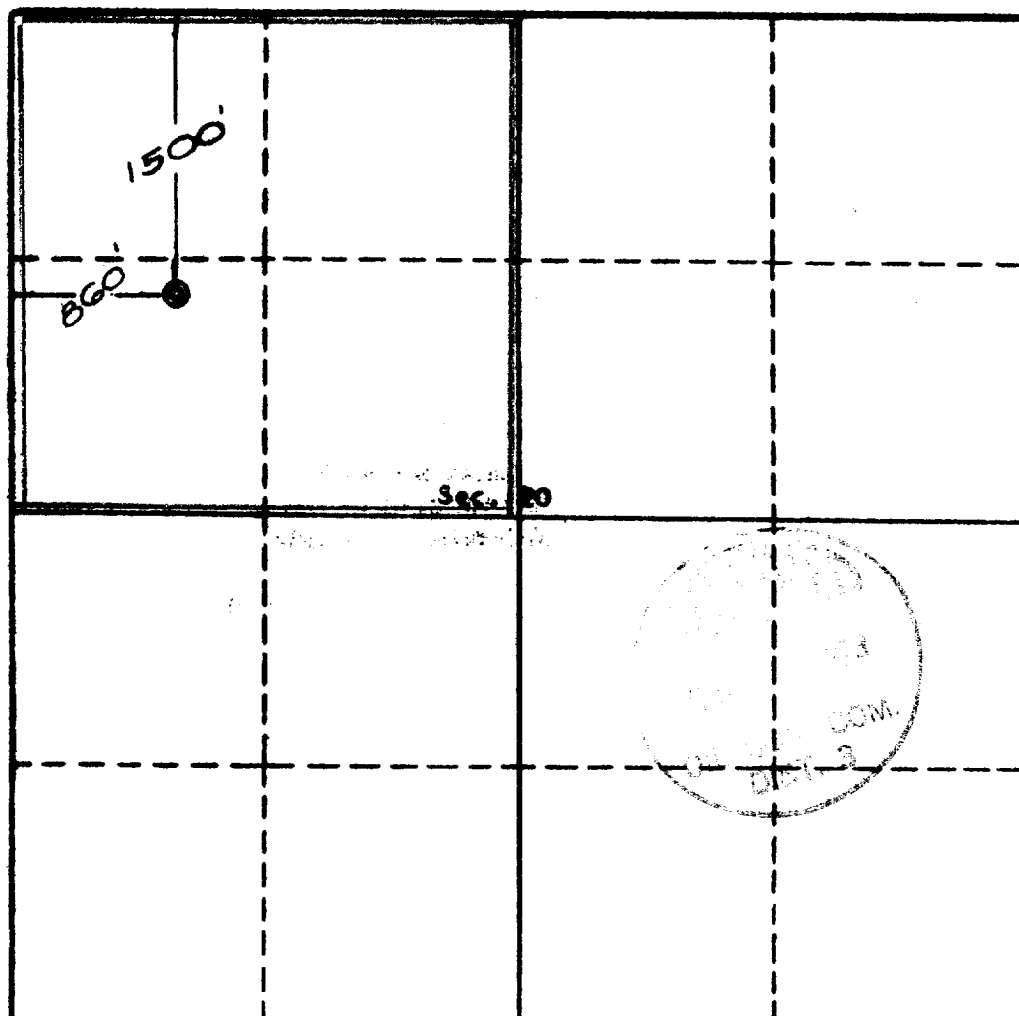

Scale, 1 inch = 1,000 feet

### CERTIFICATION

I hereby certify that the information contained herein is true and complete to the best of my knowledge and belief.

Arthur B. Ramsey,  
Name  
Owner.  
Position  
Ramsey Petroleum Co.  
Company  
Date November 3, 1973

I hereby certify that the well location shown on this plat is correct from the survey of actual survey, or as shown on the map, and that the same is correct to the best of my knowledge and belief.

Date Surveyed September 24, 1973  
Registered Professional Engineer  
and/or Land Surveyor

E. V. Echoshawk  
Certificate No. 3602  
E. V. Echoshawk LS

PRINTING COMPLETED  
FOR 30 DAYS UNLESS  
OTHERWISE NOTED

EXPIRES