

UNITED STATES
DEPARTMENT OF THE INTERIOR
GEOLOGICAL SURVEY

30-031-20409

APPLICATION FOR PERMIT TO DRILL, DEEPEN, OR PLUG BACK

1a. TYPE OF WORK DRILL <input checked="" type="checkbox"/> DEEPEN <input type="checkbox"/> PLUG BACK <input type="checkbox"/>		5. LEASE DESIGNATION AND SERIAL NO. NM-081208
b. TYPE OF WELL OIL WELL <input type="checkbox"/> GAS WELL <input type="checkbox"/> OTHER Gas/Water Inj. <input checked="" type="checkbox"/> SINGLE ZONE <input checked="" type="checkbox"/> MULTIPLE ZONE <input type="checkbox"/>		6. IF INDIAN, ALLOTTEE OR TRIBE NAME
2. NAME OF OPERATOR Tenneco Oil Company		7. UNIT AGREEMENT NAME
3. ADDRESS OF OPERATOR Suite 1200 Lincoln Tower Bldg., Denver, Colorado 80203		8. FARM OR LEASE NAME Lower Hospah
4. LOCATION OF WELL (Report location clearly and in accordance with any State requirements.)* At surface 2580' FNL and 1640' FWL At proposed prod. zone		9. WELL NO. 58
14. DISTANCE IN MILES AND DIRECTION FROM NEAREST TOWN OR POST OFFICE*		10. FIELD AND POOL, OR WILDCAT South Hospah Lower Sand
15. DISTANCE FROM PROPOSED* LOCATION TO NEAREST PROPERTY OR LEASE LINE, FT. (Also to nearest drlg. unit line, if any)	16. NO. OF ACRES IN LEASE	17. NO. OF ACRES ASSIGNED TO THIS WELL N/A (Injection Well)
18. DISTANCE FROM PROPOSED LOCATION* TO NEAREST WELL, DRILLING, COMPLETED, OR APPLIED FOR, ON THIS LEASE, FT.	19. PROPOSED DEPTH + 1650'	20. ROTARY OR CABLE TOOLS Rotary
21. ELEVATIONS (Show whether DF, RT, GR, etc.) 7026' GR		22. APPROX. DATE WORK WILL START* Upon Approval

23. PROPOSED CASING AND CEMENTING PROGRAM				
SIZE OF HOLE	SIZE OF CASING	WEIGHT PER FOOT	SETTING DEPTH	QUANTITY OF CEMENT
12-1/4"	8-5/8"	24#	100'	Sufficient to Circulate.
7-7/8"	5-1/2"	15.5#	+ 1650'	Sufficient to bring cement 900' from surface.

Drill 12 $\frac{1}{4}$ " surface hole, run 8-5/8", 24#, K-55 casing and cement to surface. Drill out with 7-7/8" hole to approximate T. D. of 1650' KIB, log, and run 5 $\frac{1}{2}$ ", 15.5#, K-55 casing to T. D. and cement as required. Perforate casing and treat formation if necessary to establish injection service. B. O. P. to be tested each 24 hours.

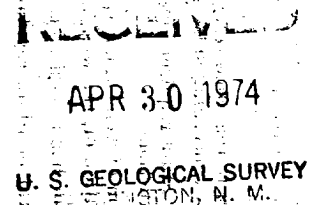

IN ABOVE SPACE DESCRIBE PROPOSED PROGRAM: If proposal is to deepen or plug back, give data on present productive zone and proposed new productive zone. If proposal is to drill or deepen directionally, give pertinent data on subsurface locations and measured and true vertical depths. Give blowout preventer program, if any.

24. SIGNED Paul L. Rogers TITLE Sr. Production Clerk DATE 4/22/74
(This space for Federal or State office use)

PERMIT NO. _____ APPROVAL DATE _____

APPROVED BY AKA TITLE _____ DATE _____
CONDITIONS OF APPROVAL, IF ANY:

See letter 5-2-74
PAIX-56

*See Instructions On Reverse Side

**NEW MEXICO OIL CONSERVATION COMMISSION
WELL LOCATION AND ACREAGE DEDICATION PLAT**

Form O-112
Supersedes C-128
Effective 1-1-65

All distances must be from the outer boundaries of the Section.

Operator TENNECO OIL COMPANY			Lease HOSPAH		Section 58
Unit Letter F	Section 12	Township 17 NORTH	Range 9 WEST	County McKINLEY	
Actual Footage Location of Well: 2580 feet from the NORTH line and 1640 feet from the WEST line. Ground Level Elev. 7026 Producing Formation Lower Hospah Seal South Hospah Lower Sand Cement and Annular Seal N/A (Injection Well)					

- Outline the acreage dedicated to the subject well by colored pencil or hatchure marks on the plat below.
- If more than one lease is dedicated to the well, outline each and identify the ownership thereof (both as to working interest and royalty).
- If more than one lease of different ownership is dedicated to the well, have the interests of all owners been consolidated by communitization, unitization, force-pooling, etc?

☐ Yes ☐ No If answer is "yes," type of consolidation _____

If answer is "no," list the owners and tract descriptions which have actually been consolidated. (Use reverse side of this form if necessary.) _____

No allowable will be assigned to the well until all interests have been consolidated (by communitization, unitization, forced-pooling, or otherwise) or until a non-standard unit, eliminating such interests, has been approved by the Commission.
589°59'W 86.00 ch. 5681.94'

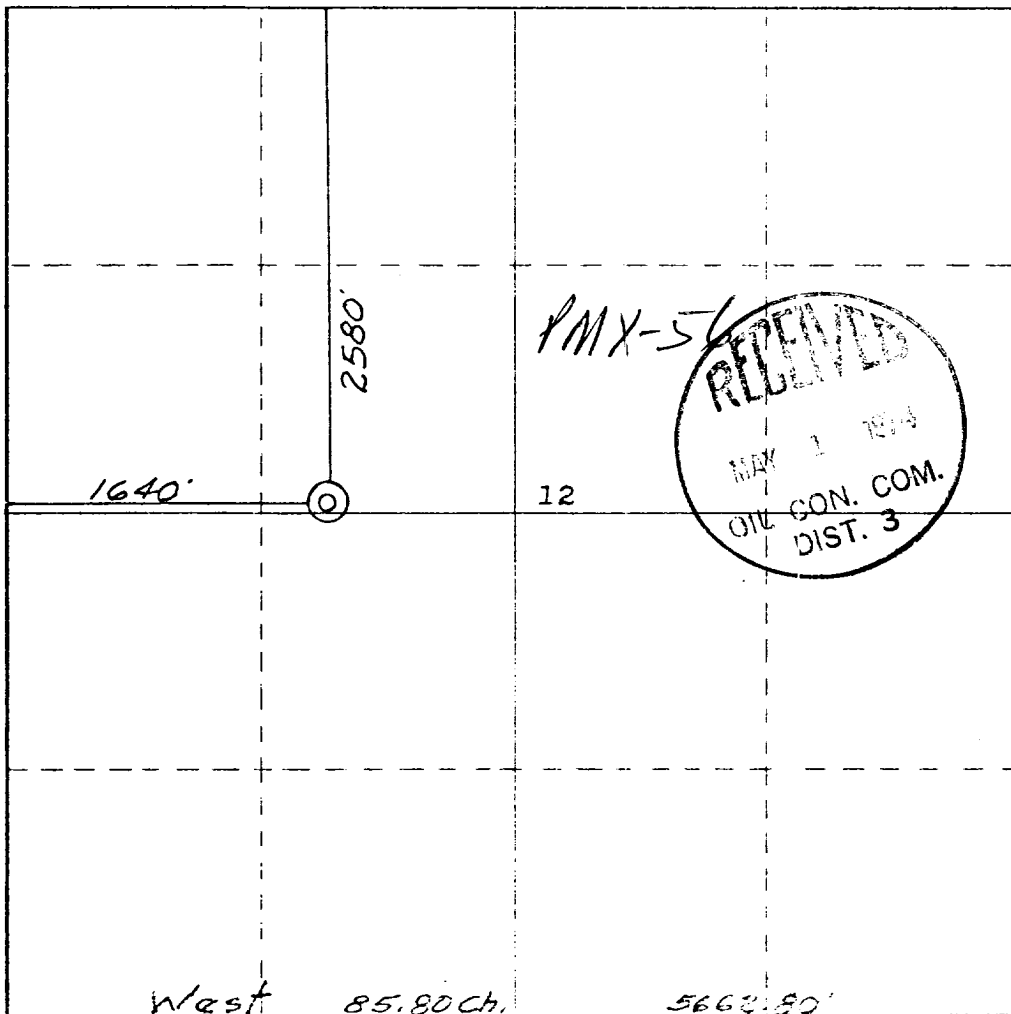
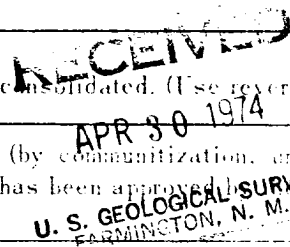

CERTIFICATION

I hereby certify that the information contained herein is true and complete to the best of my knowledge and belief.

Date _____
 Signature *Paul J. Rogers*

Position **Sr. Production Clerk**

Company **Tenneco Oil Company**

Date **4/22/74**

I hereby certify that the well location shown on this plat was plotted from field notes of actual surveys made by me or under my supervision, and that the same is true and correct to the best of my knowledge and belief.

Date Surveyed **17 Apr 1974**

Signature *James P. Loese*
 Name **James P. Loese**

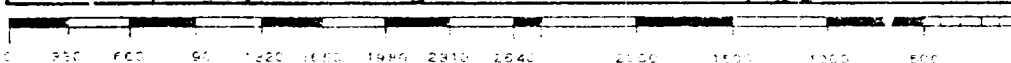
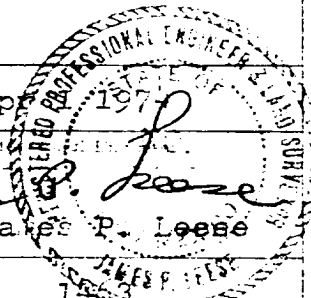

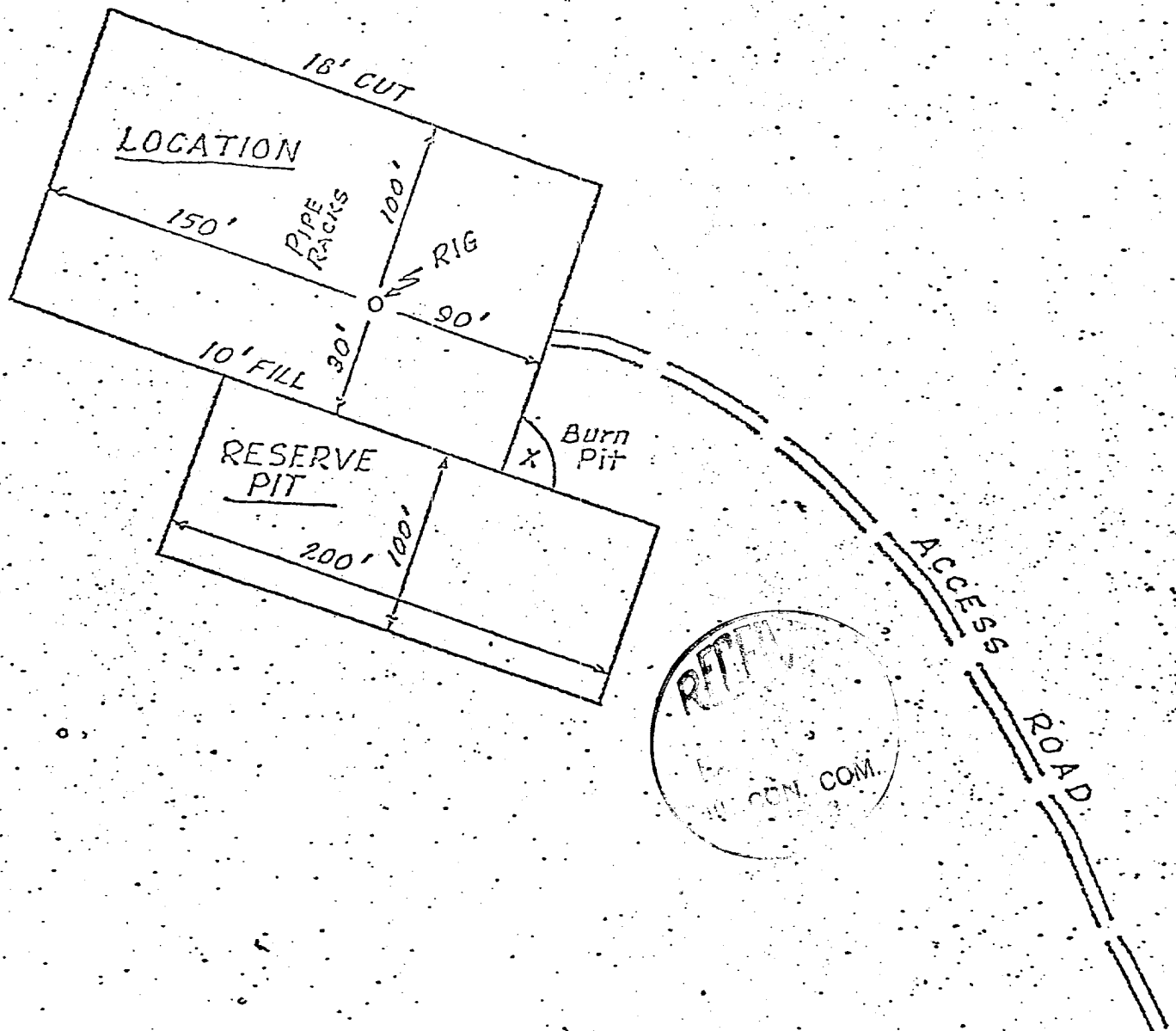

LEGEND

- Location - Drig. Testing, or TA
- Oil Well - Dakota "D" Zone
- Gas Well - Dakota "D" Zone
- Oil Well - Upper Hospah Zone
- Water Injection Well - Hospah Zone
- Oil Well - Lower Hospah Zone
- Dual Oil Well - Upper & Lower Hospah Zones
- Dual Oil Well - Lower Hospah Oil & Dakota Gas
- Oil Well - Dakota "A" Zone
- Gas Well - Dakota "A" Zone
- Oil Well - Dakota "B" Zone
- (Kdb)
- Dry Hole
- Injection Well - Lower Hospah Zone
- Proposed Location - Lower Hospah Zone

T 17 N

Whigham

Tenneco

Tenneco

Tenneco

Tenneco

Tenneco

Tenneco

Tenneco

Tenneco

Tenneco

Tenneco

Tenneco

Tenneco

Tenneco

Tenneco

US NM 8270

Hospah "A"

Tenneco

Tenneco

Tenneco

Tenneco

Tenneco

Tenneco

Tenneco

Tenneco

Tenneco

Tenneco

Tenneco

Tenneco

Tenneco

Tenneco

Tenneco

Tenneco

Tenneco

Tenneco

Tenneco

Tenneco

Tenneco

Tenneco

Tenneco

R 9 W

40.00

40.00

40.00

40.00

40.00

40.00

40.00

40.00

40.00

40.00

40.00

40.00

40.00

40.00

40.00

40.00

40.00

40.00

40.00

40.00

40.00

40.00

40.00

40.00

40.00

40.00

40.00

40.00

40.00

40.00

40.00

40.00

40.00

40.00

40.00

40.00

40.00

40.00

40.00

40.00

40.00

40.00

40.00

40.00

11.66

11.66

11.66

11.66

11.66

11.66

11.66

11.66

11.66

11.66

11.66

11.66

11.66

11.66

11.66

11.66

11.66

11.66

11.66

11.66

11.66

11.66

11.66

11.66

11.66

11.66

11.66

11.66

11.66

11.66

11.66

11.66

11.66

11.66

11.66

11.66

11.66

11.66

11.66

11.66

11.66

11.66

11.66

11.66

39.73

39.73

39.73

39.73

39.73

39.73

39.73

39.73

39.73

39.73

39.73

39.73

39.73

39.73

39.73

39.73

39.73

39.73

39.73

39.73

39.73

39.73

39.73

39.73

39.73

39.73

39.73

39.73

39.73

39.73

39.73

39.73

39.73

39.73

39.73

39.73

39.73

39.73

39.73

39.73

39.73

39.73

39.73

39.73

11.82

11.82

11.82

11.82

11.82

11.82

11.82

11.82

11.82

11.82

11.82

11.82

11.82

11.82

11.82

11.82

11.82

11.82

11.82

11.82

11.82

11.82

11.82

11.82

11.82

11.82

11.82

11.82

11.82

11.82

11.82

11.82

11.82

11.82

11.82

11.82

11.82

11.82

11.82

11.82

11.82

11.82

11.82

11.82

39.20

39.20

39.20

39.20

39.20

39.20

39.20

39.20

39.20

39.20

39.20

39.20

39.20

39.20

39.20

39.20

39.20

39.20

39.20

39.20

39.20

39.20

39.20

39.20

39.20

39.20

39.20

39.20

39.20

39.20

39.20

39.20

39.20

39.20

39.20

39.20

39.20

39.20

39.20

39.20

39.20

39.20

39.20

39.20

11.5F

11.5F

11.5F

11.5F

11.5F

11.5F

11.5F

11.5F

11.5F

11.5F

11.5F

11.5F

11.5F

11.5F

11.5F

11.5F

11.5F

11.5F

11.5F

11.5F

11.5F

11.5F

11.5F

11.5F

11.5F

11.5F

11.5F

11.5F

11.5F

Tenneco Oil
A Tenneco Company

Suite 1200
Lincoln Tower Building
Denver, Colorado 80203
(303) 292-9920



April 22, 1974

U. S. Geological Survey
P. O. Box 959
Farmington, New Mexico 87401

Re: Application for Permit to Drill
Gas/Water Injection Well
Lower Hospah Well No. 58
NW/4 Sec. 12, T 17N, R 9W
Mc Kinley County, New Mexico

Gentlemen:

Attached are eight copies each of the Notice of Intention to Drill, Well Location and Acreage Dedication Plat and Vicinity Map relative to, the above captioned well. The Vicinity Map does not show existing roads, pipelines or flow lines, however, roads and flow lines are interlaced throughout this South Hospah Area which already has 54 wells located in this section to date.

The water we will use for drilling will come from our injection facilities on the lease. Waste disposal will be buried in the burn pit or reserve pit. There will be no camp or airstrip associated with the drilling of the well. Upon completion or abandonment of this well, the location will be cleaned and levelled and a dry hole marker placed, if applicable.

Very truly yours,

TENNECO OIL COMPANY

D. D. Myers

D. D. Myers
Assistant Division
Production Manager

PLR/ka

Attachments:

RECEIVED

APR 30 1974

U. S. GEOLOGICAL SURVEY
FARMINGTON, N. M.

