

UNITED STATES
DEPARTMENT OF THE INTERIOR
GEOLOGICAL SURVEY

30-031-20411

APPLICATION FOR PERMIT TO DRILL, DEEPEN, OR PLUG BACK

| | | |
|---|--|--|
| 1a. TYPE OF WORK DRILL <input checked="" type="checkbox"/> DEEPEN <input type="checkbox"/> PLUG BACK <input type="checkbox"/> | | 5. LEASE DESIGNATION AND SERIAL NO. NM-081208 |
| b. TYPE OF WELL OIL WELL <input type="checkbox"/> GAS WELL <input type="checkbox"/> OTHER Gas/Water Inj. Well <input checked="" type="checkbox"/> SINGLE ZONE <input checked="" type="checkbox"/> MULTIPLE ZONE <input type="checkbox"/> | | 6. IF INDIAN, ALLOTTEE OR TRIBE NAME |
| 2. NAME OF OPERATOR Tenneco Oil Company | | 7. UNIT AGREEMENT NAME |
| 3. ADDRESS OF OPERATOR Suite 1200 Lincoln Tower Bldg., Denver, Colorado 80203 | | 8. FARM OR LEASE NAME Lower Hospah |
| 4. LOCATION OF WELL (Report location clearly and in accordance with any State requirements.)* At surface 2210' FNL and 1300' FEL At proposed prod. zone | | 9. WELL NO. 60 |
| 14. DISTANCE IN MILES AND DIRECTION FROM NEAREST TOWN OR POST OFFICE* | | 10. FIELD AND POOL, OR WILDCAT South Hospah Lower Sand |
| 15. DISTANCE FROM PROPOSED* LOCATION TO NEAREST PROPERTY OR LEASE LINE, FT. (Also to nearest drlg. unit line, if any) | 16. NO. OF ACRES IN LEASE | 11. SEC., T., R., M., OR BLK. AND SURVEY OR AREA Sec. 12, T17N, R9W |
| 18. DISTANCE FROM PROPOSED LOCATION* TO NEAREST WELL, DRILLING, COMPLETED, OR APPLIED FOR, ON THIS LEASE, FT. | 19. PROPOSED DEPTH + 1650' | 12. COUNTY OR PARISH McKinley |
| 21. ELEVATIONS (Show whether DF, RT, GR, etc.) 6976' GR | 17. NO. OF ACRES ASSIGNED TO THIS WELL N/A (Injection Well) | 13. STATE New Mexico |
| 20. ROTARY OR CABLE TOOLS Rotary | | 22. APPROX. DATE WORK WILL START* Upon Approval |

23 PROPOSED CASING AND CEMENTING PROGRAM

| SIZE OF HOLE | SIZE OF CASING | WEIGHT PER FOOT | SETTING DEPTH | QUANTITY OF CEMENT |
|--------------|----------------|-----------------|---------------|---|
| 12-1/4" | 8-5/8" | 24# | 100' | Sufficient to Circulate. |
| 7-7/8" | 5-1/2" | 15.5# | ± 1650' | Sufficient to bring cement 900' from surface. |

Drill 12 1/4" surface hole, run 8-5/8", 24#, K-55 casing and cement to surface. Drill out with 7-7/8" hole to approximate T. D. of 1650' KDB, log, and run 5 1/2", 15.5#, K-55 casing to T. D. and cement as required. Perforate casing and treat formation if necessary to establish injection service. B. O. P. to be tested each 24 hours.

APR 30 1974

U. S. GEOLOGICAL SURVEY

1. ABOVE SPACE DESCRIBE PROPOSED PROGRAM: If proposal is to deepen or plug back, give data on present productive zone and proposed new productive zone. If proposal is to drill or deepen directionally, give pertinent data on subsurface locations and measured and true vertical depths. Give blowout preventer program, if any.

2.

SIGNED

Paul F. Rogers

TITLE

Sr. Production Clerk

DATE

4/22/74

(This space for Federal or State office use)

PERMIT NO.

APPROVAL DATE

APPROVED BY

OK

TITLE

DATE

CONDITIONS OF APPROVAL, IF ANY:

*See Instructions On Reverse Side

Form C-128
Supersedes C-128
Effective 1-1-65

| | | | | |
|--|--|---|------------------------|--|
| Operator TENNECO OIL COMPANY | | Lessee HOSPAH | | Well No. 60 |
| Unit Letter H | Section 12 | Township 17 NORTH | Range 9 WEST | County McKINLEY |
| Actual Footage Location of Well: 2210 feet from the NORTH line and 1300 feet from the EAST line | | | | |
| Ground Lev. Elev. 6976 | Producing Formation Lower Hospah | Perfor. South Hospah Lower Sand | | Defect or Abandon N/A (Injection Well) |

- ☐ Yes ☐ No If answer is "yes," type of consolidation

If answer is "no," list the owners and tract descriptions which have actually been sold. (Use reverse side of this form if necessary.)

No allowable will be assigned to the well until all interests have been consolidated (by communitization, unitization, for-ed-pooling, or otherwise) or until a non-standard unit, eliminating such interests, has been approved by the Commission.

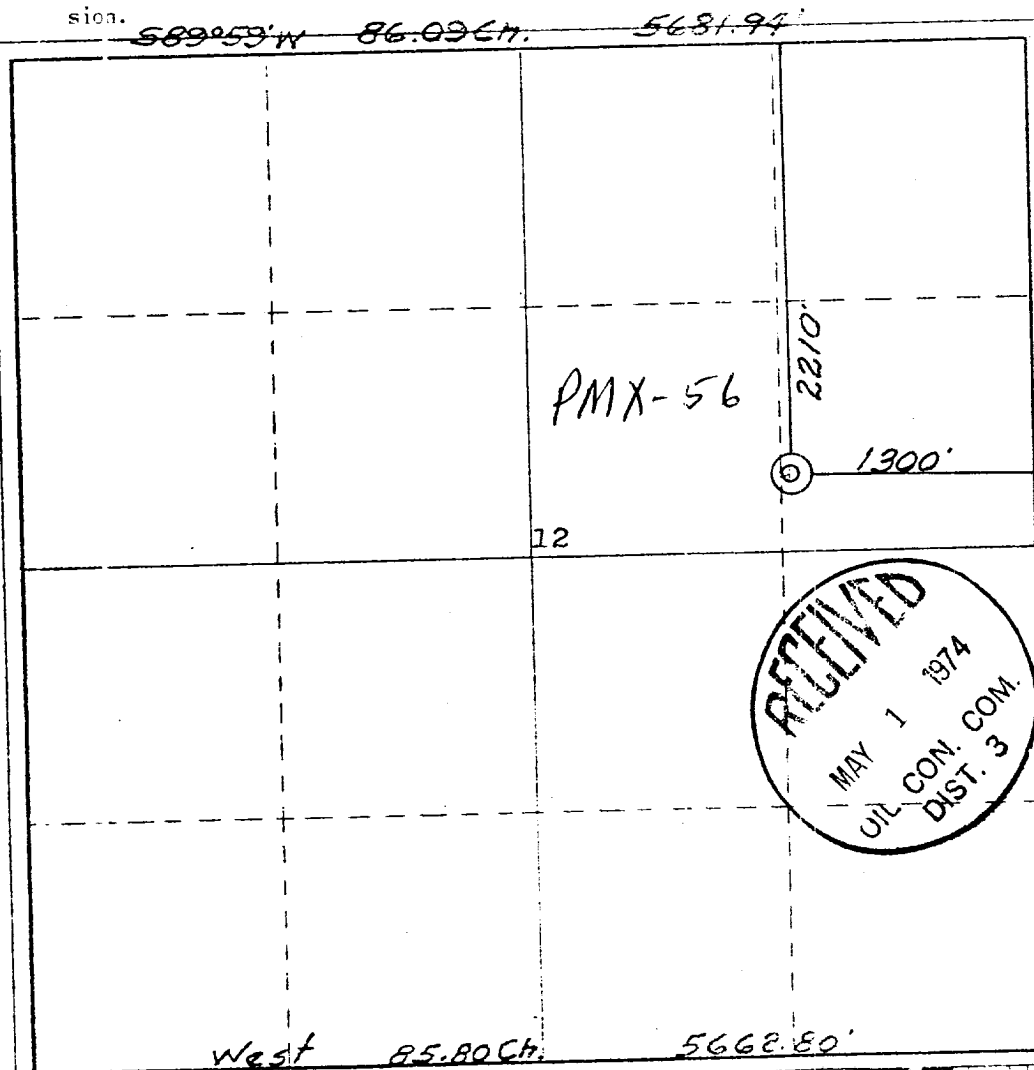

I hereby certify that the information contained herein is true and complete to the best of my knowledge and belief.

1176

Saul L. Rogers
Position **Sr. Production Clerk**

Company

Tenneco Oil Company

Date _____

4/22/74

I hereby certify that the well location shown on this plot was plotted from field notes of actual surveys made by me or under my supervision, and that the same is true and correct to the best of my knowledge and belief.

100

18 April 1974

Registered: Prototyping and Forming
and ... and ...

James P. Leese

1463

LEGEND

- Location - Drilling, Testing, or T/A
- Oil Well - Dakota "D" Zone
- Gas Well - Dakota "D" Zone
- Oil Well - Upper Hoshpah Zone
- Water Injection Well - Hoshpah Zone
- Oil Well - Lower Hoshpah Zone
- Dual Oil Well - Upper & Lower Hoshpah Zones
- Dual Well - Lower Hoshpah Oil & Dakota Gas
- Oil Well - Dakota "A" Zone
- Gas Well - Dakota "A" Zone
- Oil Well - Dakota "B" Zone
- Dry Hole
- Injection Well - Lower Hoshpah Zone
- Proposed Location - Lower Hoshpah Zone

T 17 N

Whigham

Tenneco

Tenneco

Tesoro

Tenneco

Hoshpah "A"

US NM 8270

R 9 W



TENNECO OIL COMPANY
SUBSIDIARY OF TENNECO INC.
SOUTH HOSPAH AREA
MC KINLEY COUNTY, NEW MEXICO

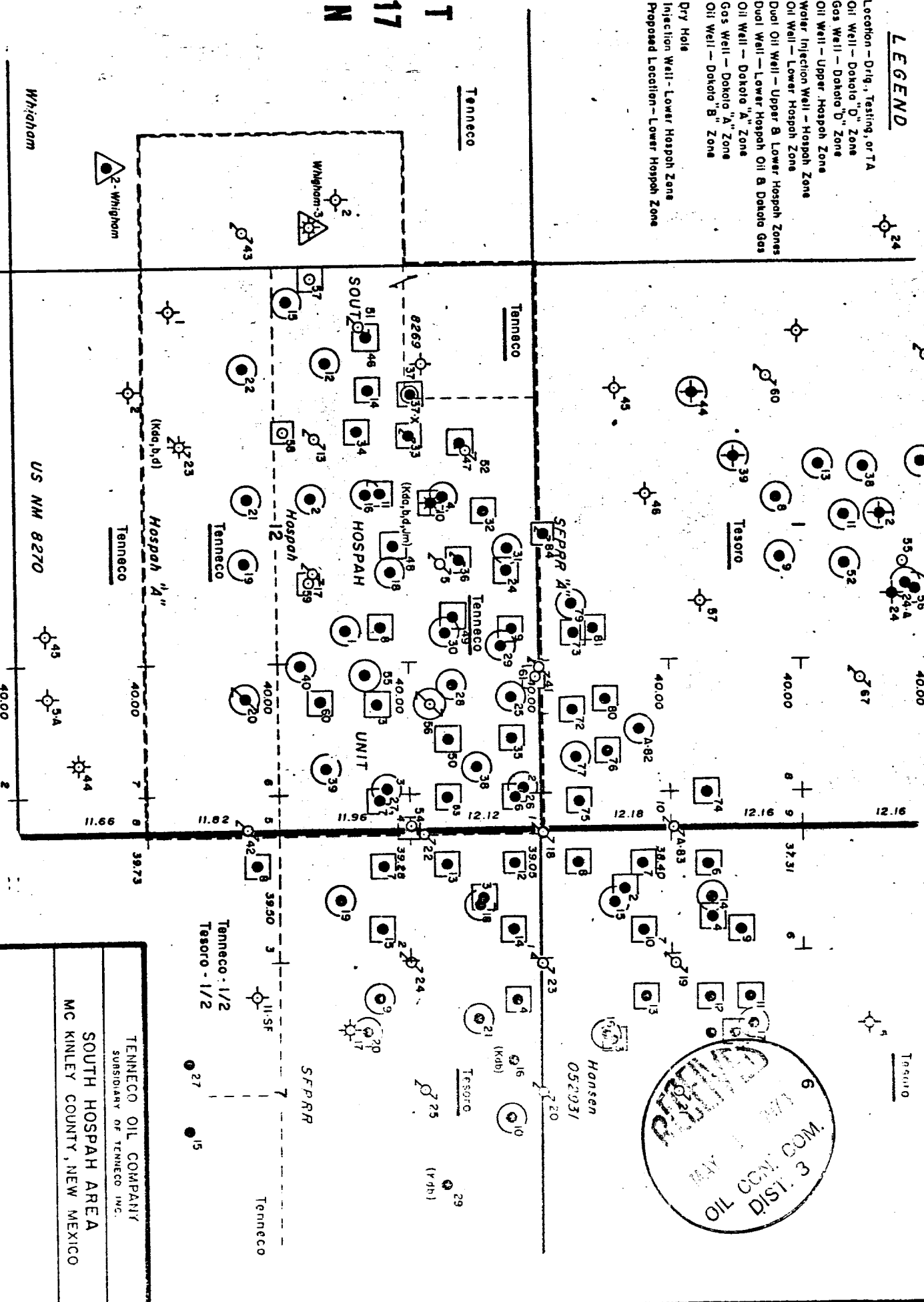
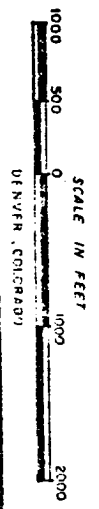

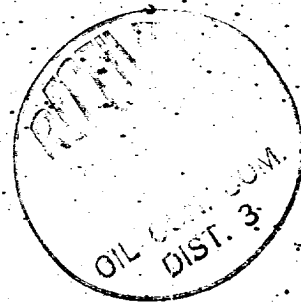
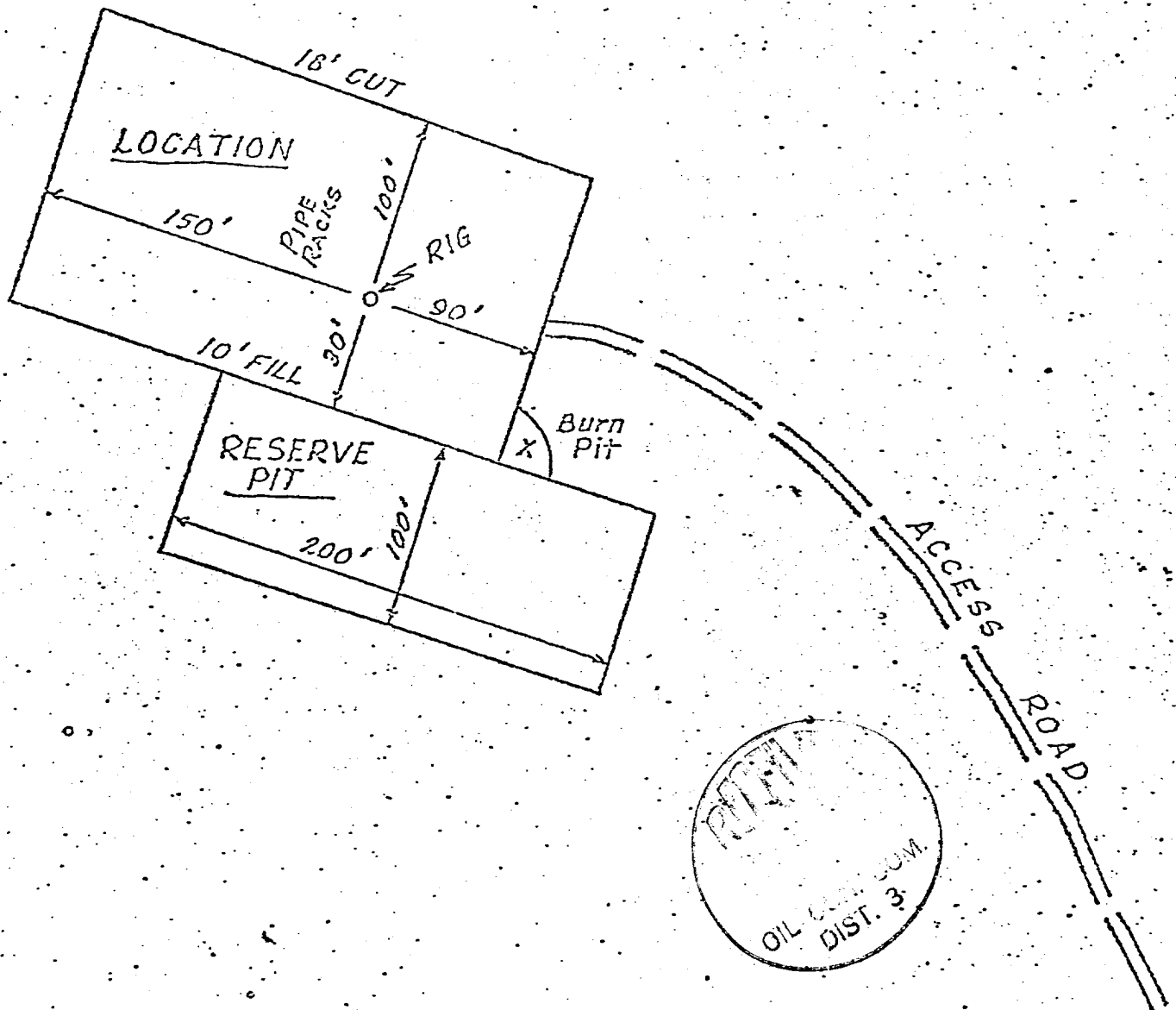

Tenneco Oil
A Tenneco Company

Suite 1200
Lincoln Tower Building
Denver, Colorado 80203
(303) 292-9920



April 22, 1974

U. S. Geological Survey
P. O. Box 959
Farmington, New Mexico 87401

Re: Application for Permit to Drill
Gas/Water Injection Well
Lower Hospah Well No. 60
NE/4 Sec. 12, T 17N, R 9W
Mc Kinley County, New Mexico

Gentlemen:

Attached are eight copies each of the Notice of Intention to Drill, Well Location and Acreage Dedication Plat and Vicinity Map relative to the above captioned well. The Vicinity Map does not show existing roads, pipelines or flow lines, however, roads and flow lines are interlaced throughout this South Hospah Area which already has 54 wells located in this section to date.

The water we will use for drilling will come from our injection facilities on the lease. Waste disposal will be buried in the burn pit or reserve pit. There will be no camp or airstrip associated with the drilling of the well. Upon completion or abandonment of this well, the location will be cleaned and levelled and a dry hole marker placed, if applicable.

Very truly yours,

TENNECO OIL COMPANY

A handwritten signature in cursive script that reads "D. D. Myers".

D. D. Myers
Assistant Division
Production Manager



PLR/ka

Attachments:

APR 30 1974

U. S. GEOLOGICAL SURVEY
FARMINGTON, N. M.