

NO. OF COPIES RECEIVED	
DISTRIBUTION	
SANTA FE	1
FILE	1
U.S.G.S.	
LAND OFFICE	
OPERATOR	1

# NEW MEXICO OIL CONSERVATION COMMISSION

Form C-101  
Revised 1-1-65 30-031-24416

5A. Indicate Type of Lease
STATE <input type="checkbox"/> FEE <input checked="" type="checkbox"/>
5. State Oil & Gas Lease No.

## APPLICATION FOR PERMIT TO DRILL, DEEPEN, OR PLUG BACK

1a. Type of Work		7. Unit Agreement Name	
b. Type of Well OIL WELL <input checked="" type="checkbox"/> GAS WELL <input type="checkbox"/> OTHER <input type="checkbox"/>		8. Farm or Lease Name Santa Fe RR "B"	
2. Name of Operator Tesoro Petroleum Corporation		9. Well No. 36	
3. Address of Operator 1776 Lincoln St. Suite 1012, Denver, Colo. 80203		10. Field and Pool, or Wildcat Upper Hospah, So.	
4. Location of Well UNIT LETTER L LOCATED 1650 FEET FROM THE South LINE AND 330 FEET FROM THE West LINE OF SEC. 5 TWP. 17N RGE. 8W NMPM		12. County McKinley	
19. Proposed Depth 1620'		19A. Formation Upper Hospah	
20. Rotary or C.T. Rotary		21. Elevations (Show whether DF, RT, etc.) GR 6857	
21A. Kind & Status Plug. Bond Statewide		21B. Drilling Contractor As Available	
22. Approx. Date Work will start 7/25/74			

23.

### PROPOSED CASING AND CEMENT PROGRAM

SIZE OF HOLE	SIZE OF CASING	WEIGHT PER FOOT	SETTING DEPTH	SACKS OF CEMENT	EST. TOP
12 1/4"	8 5/8"	24#	100'±	100	Circ.
7 7/8"	5 1/2"	14#	1620'±	100	1100'

Tesoro proposes to drill a 12 1/4" OD hole to 100'; run 8 5/8" OD casing and cement to surface. A 7 7/8" OD hole will then be drilled through the 8 5/8" casing to a TD of approx. 1620'. An oil string of 5 1/2" OD casing will be set and cemented with 100 sacks. The 5 1/2" casing will be tested to 800 psi for 30 minutes. Completion will consist of logging and perforating the porous Upper Hospah interval then swab testing. If the well proves commercially oil productive pumping equipment will be installed and the well placed on production.

APPROVED  
FOR 90 DAY PERMIT  
DEVELOPMENT  
10-21-74

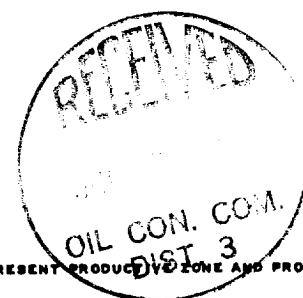

IN ABOVE SPACE DESCRIBE PROPOSED PROGRAM; IF PROPOSAL IS TO DEEPEN OR PLUG BACK, GIVE DATA ON PRESENT PRODUCTION ZONE AND PROPOSED NEW PRODUCTION ZONE. GIVE BLOWOUT PREVENTER PROGRAM, IF ANY.

I hereby certify that the information above is true and complete to the best of my knowledge and belief.

Signed L. C. Marguier Title District Engineer Date 7/17/74

(This space for State Use)

APPROVED BY Gerry Clure TITLE SUPERVISOR DIST. #3 DATE JUL 22 1974  
CONDITIONS OF APPROVAL, IF ANY:

**NEW MEXICO OIL CONSERVATION COMMISSION  
WELL LOCATION AND ACREAGE DEDICATION PLAT**

Form C-102  
Supersedes C-128  
Effective 1-1-65

All distances must be from the outer boundaries of the Section.

Operator <b>Tesoro Petroleum Corporation</b>			Lease <b>Santa Fe B</b>		Well No. <b>36</b>
Unit Letter <b>L</b>	Section <b>5</b>	Township <b>17N</b>	Range <b>8W</b>	County <b>McKinley</b>	
Actual Footage Location of Well: <b>1650</b> feet from the <b>South</b> line and <b>330</b> feet from the <b>West</b> line					
Ground Level Elev. <b>6857</b>	Producing Formation <b>Upper Hospah</b>		Pool <b>Upper Hospah South EXT</b>		Dedicated Acreage: <b>40</b> Acres

1. Outline the acreage dedicated to the subject well by colored pencil or hachure marks on the plat below.
2. If more than one lease is dedicated to the well, outline each and identify the ownership thereof (both as to working interest and royalty).
3. If more than one lease of different ownership is dedicated to the well, have the interests of all owners been consolidated by communitization, unitization, force-pooling, etc?

☐ Yes    ☐ No    If answer is "yes," type of consolidation \_\_\_\_\_

If answer is "no," list the owners and tract descriptions which have actually been consolidated. (Use reverse side of this form if necessary.) \_\_\_\_\_

No allowable will be assigned to the well until all interests have been consolidated (by communitization, unitization, forced-pooling, or otherwise) or until a non-standard unit, eliminating such interests, has been approved by the Commission.

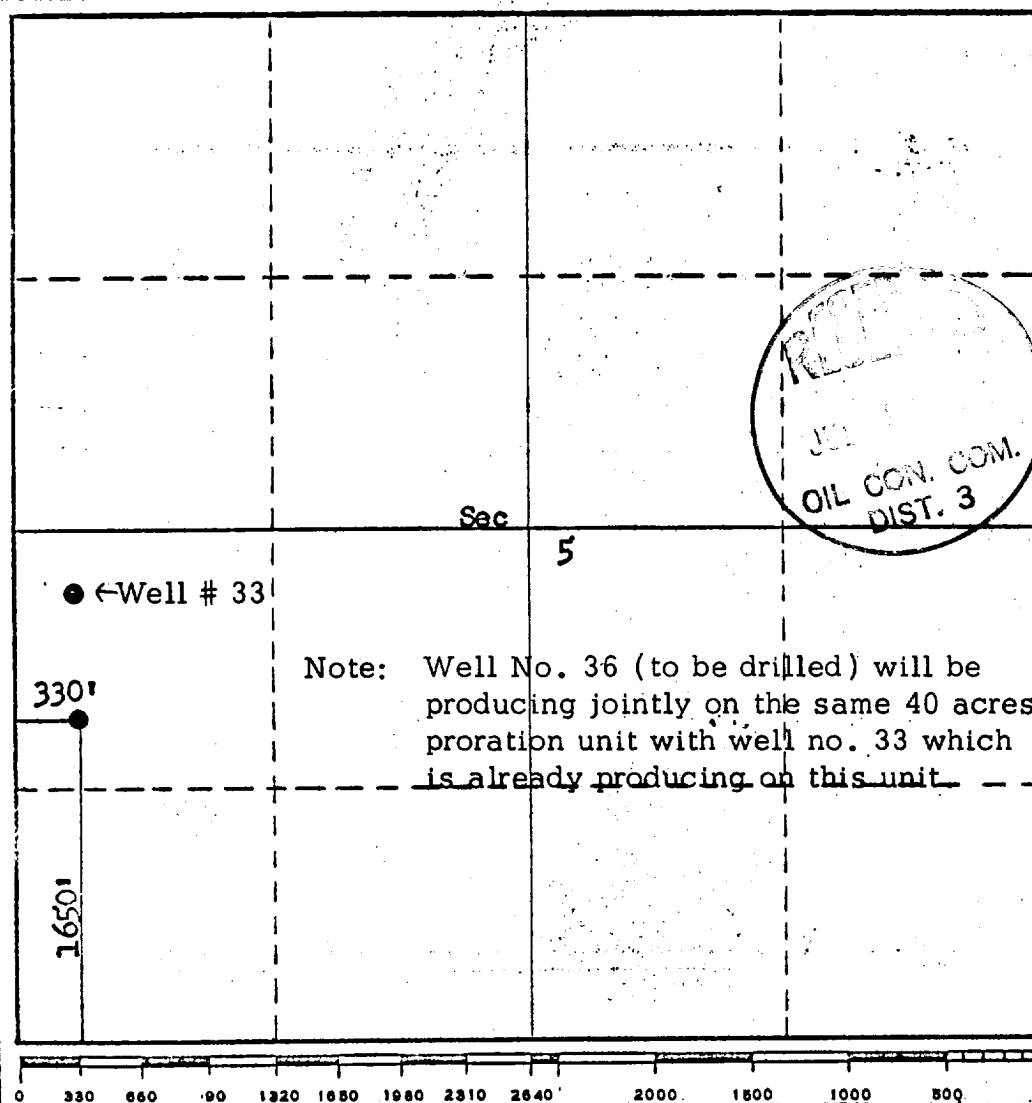

**CERTIFICATION**

I hereby certify that the information contained herein is true and complete to the best of my knowledge and belief.

Name L. C. Marguerit  
 Position Dist. Engr  
 Company Tesoro Petr. Corp  
 Date 7/18/74

I hereby certify that the well location shown on this plat was plotted from field notes of actual surveys made by me or under my supervision, and that the same is true and correct to the best of my knowledge and belief.

Date Surveyed July 14, 1974  
 Registered Professional Engineer and/or Land Surveyor  
Fred B. Kerr Jr.  
 Certificate No. 3950