

NO. OF COPIES RECEIVED	5
DISTRIBUTION	
SANTA FE	1
FILE	1
U.S.G.S.	1
LAND OFFICE	1
OPERATOR	1

NEW MEXICO OIL CONSERVATION COMMISSION

30-031-20420

Form C-101
Revised 1-1-65

5A. Indicate Type of Lease	
STATE <input type="checkbox"/>	FEE <input checked="" type="checkbox"/>
5. State Oil & Gas Lease No.	

APPLICATION FOR PERMIT TO DRILL, DEEPEN, OR PLUG BACK

1a. Type of Work		7. Unit Agreement Name	
b. Type of Well DRILL <input checked="" type="checkbox"/> DEEPEN <input type="checkbox"/> PLUG BACK <input type="checkbox"/>		8. Farm or Lease Name	
OIL WELL <input checked="" type="checkbox"/> GAS WELL <input type="checkbox"/> OTHER <input type="checkbox"/> SINGLE ZONE <input checked="" type="checkbox"/> MULTIPLE ZONE <input type="checkbox"/>		SFP - Jackson	
2. Name of Operator		9. Well No.	
Colorado Plateau Geological Services, Inc.		#2	
3. Address of Operator		10. Field and Pool, or Wildcat	
P. O. Box 537, Farmington, New Mexico 87401		Blackeye Mesaverde	
4. Location of Well UNIT LETTER M LOCATED 330' FEET FROM THE South LINE AND 990' FEET FROM THE West LINE OF SEC. 29 TWP. 20N RGE. 9W NMPM		12. County	
		McKinley	
19. Proposed Depth		19A. Formation	20. Rotary or C.T.
1150'		Menefee	Rotary
21. Elevations (Show whether DE, RT, etc.)	21A. Kind & Status Plug. Bond	21B. Drilling Contractor	22. Approx. Date Work will start -
6529 GR	Individual	own	August 1, 1974

PROPOSED CASING AND CEMENT PROGRAM

SIZE OF HOLE	SIZE OF CASING	WEIGHT PER FOOT	SETTING DEPTH	SACKS OF CEMENT	EST. TOP surface
6 1/2"	4 1/2"	9.5#	1,100'	90	

We propose to drill a 1,150' Menefee (Mesaverde) test as a north offset to Menefee production in NE NW NW Section 32, T.20N., R. 9W. If commercial production is indicated, 4 1/2 casing will be run to top of oil sand and open hole completion made.

APPROVAL AND
FOR 90 DAYS AFTER
DRILLING COMMENCED,
EXPIRES 11-11-74



IN ABOVE SPACE DESCRIBE PROPOSED PROGRAM; IF PROPOSAL IS TO DEEPEN OR PLUG BACK, GIVE DATA ON PRESENT PRODUCTIVE ZONE, GIVE BLOWOUT PREVENTER PROGRAM, IF ANY.

I hereby certify that the information above is true and complete to the best of my knowledge and belief.

Signed Mark E. Wirth Title Vice President Date 7/23/74

(This space for State Use)

APPROVED BY [Signature] TITLE SUPERVISOR DIST. #3 DATE AUG 12 1974

CONDITIONS OF APPROVAL, IF ANY:

**NEW MEXICO OIL CONSERVATION COMMISSION
WELL LOCATION AND ACREAGE DEDICATION PLAT**

Form C-102
Supersedes C-128
Effective 1-1-65

All distances must be from the outer boundaries of the Section.

Operator Colorado Plateau Geological Services, Inc			Lease SFP - Jackson		Well No. #2
Unit Letter M	Section 29	Township 20N	Range 9W	County McKinley	
Actual Footage Location of Well: 330 feet from the South line and 990 feet from the West line					
Ground Level Elev. 6529	Producing Formation Menefee (Mesaverde)		Pool Blackeye Mesaverde		Dedicated Acreage: 40 Acres

1. Outline the acreage dedicated to the subject well by colored pencil or hachure marks on the plat below.
2. If more than one lease is dedicated to the well, outline each and identify the ownership thereof (both as to working interest and royalty).
3. If more than one lease of different ownership is dedicated to the well, have the interests of all owners been consolidated by communitization, unitization, force-pooling, etc?

☐ Yes ☐ No If answer is "yes," type of consolidation _____

If answer is "no," list the owners and tract descriptions which have actually been consolidated. (Use reverse side of this form if necessary.) _____

No allowable will be assigned to the well until all interests have been consolidated (by communitization, unitization, forced-pooling, or otherwise) or until a non-standard unit, eliminating such interests, has been approved by the Commission.

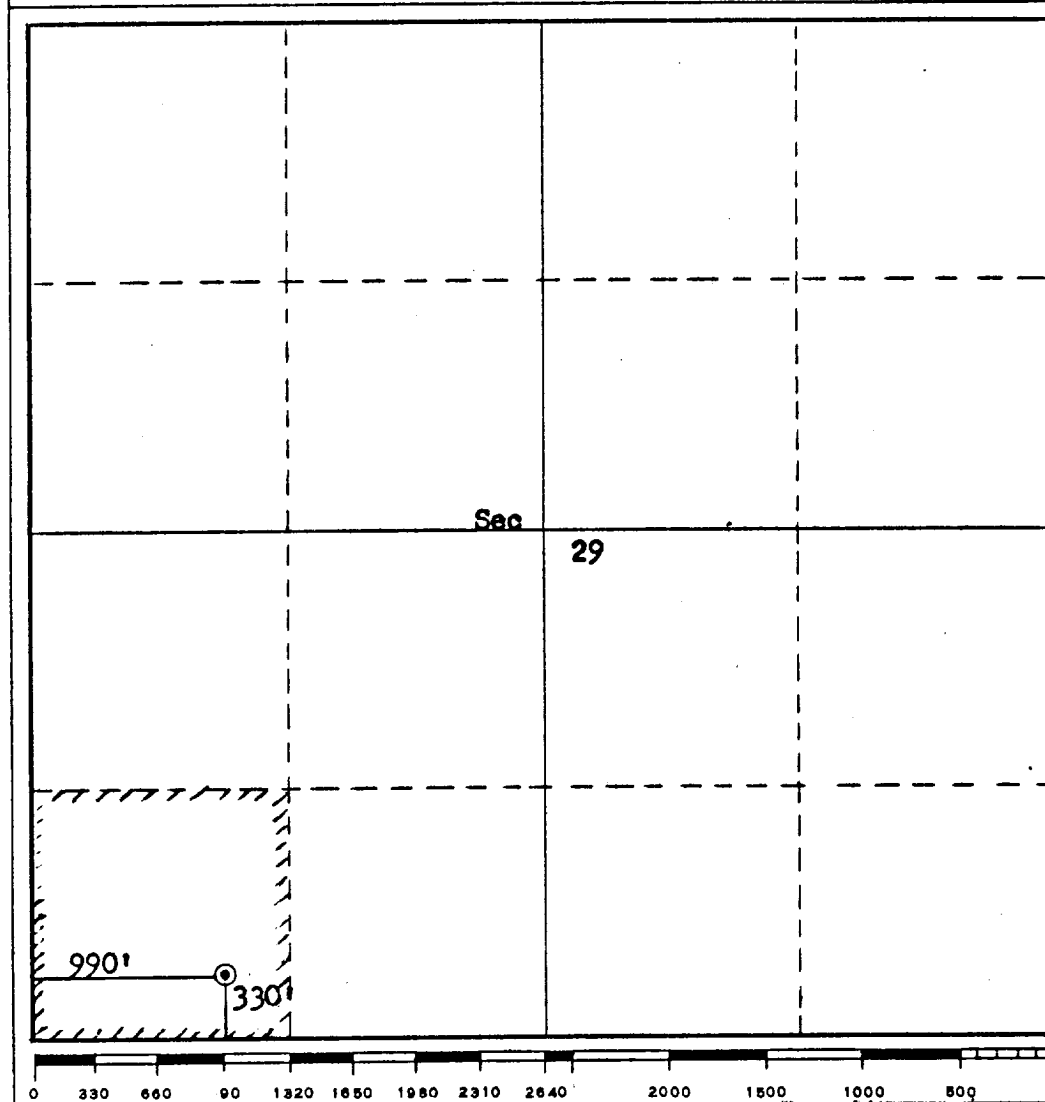

CERTIFICATION

I hereby certify that the information contained herein is true and complete to the best of my knowledge and belief.

Name **Mark E. Weidler**
Mark E. Weidler
 Position **Vice President**
 Company **Colorado Plateau Geological Services**
 Date **7/23/74**

I hereby certify that the well location shown on this plat was plotted from field notes, actual surveys made by me or under my supervision, and that the same are true and correct to the best of my knowledge and belief.

Date Surveyed **July 22, 1974**
 Registered Professional Engineer and/or Land Surveyor
Fred B. Kerr Jr.
 Certificate No. **3950**