

30-031-20422

NO. OF COPIES RECEIVED	7
DISTRIBUTION	
SANTA FE	1
FILE	1 ✓
U.S.G.S.	2
LAND OFFICE	1
OPERATOR	2

## NEW MEXICO OIL CONSERVATION COMMISSION

Form C-101  
Revised 1-1-65

5A. Indicate Type of Lease	
STATE <input checked="" type="checkbox"/>	FEE <input type="checkbox"/>
5. State Oil & Gas Lease No.	
44637	

## APPLICATION FOR PERMIT TO DRILL, DEEPEN, OR PLUG BACK

1a. Type of Work		7. Unit Agreement Name	
b. Type of Well DRILL <input checked="" type="checkbox"/> DEEPEN <input type="checkbox"/> PLUG BACK <input type="checkbox"/>		8. Farm or Lease Name	
OIL WELL <input type="checkbox"/> GAS WELL <input type="checkbox"/> OTHER <input type="checkbox"/>		Jaco	
2. Name of Operator		9. Well No.	
KFW Oil Co.		178	
3. Address of Operator		10. Field and Pool, or Wildcat	
Box 2022 Farmington, N. Mex.		Blackeye - Mesaverde	
4. Location of Well		12. County	
UNIT LETTER 4 LOCATED 660 FEET FROM THE West LINE		McKinley	
AND 2310 FEET FROM THE South LINE OF SEC. 32 TWP. 20N RGE. 9W NMPM			
19. Proposed Depth		19A. Formation	
1060		Mesaverde	
20. Rotary or C.T.		Rotary	
21. Elevations (Show whether DF, RT, etc.)		22. Approx. Date Work will start	
6455.		9-10-74	
21A. Kind & Status Plug. Bond		21B. Drilling Contractor	
One Well		EO Tools	

## PROPOSED CASING AND CEMENT PROGRAM

SIZE OF HOLE	SIZE OF CASING	WEIGHT PER FOOT	SETTING DEPTH	SACKS OF CEMENT	EST. TOP
9	7	20	30'	10	Surface
6 1/8	4 1/2	9.5	1000	20	750

Intend to Drill To Pay Sand est Dept 9 990' TO 1020'  
If Test shows oil. Will case hole + Set Cement. Complete  
open hole as oil well

APPROVAL VALID  
FOR 90 DAYS UNLESS  
DRILLING COMMENCED,  
EXPIRES 12-2-74

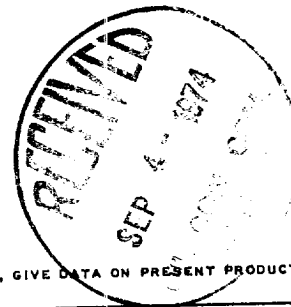

IN ABOVE SPACE DESCRIBE PROPOSED PROGRAM; IF PROPOSAL IS TO DEEPEN OR PLUG BACK, GIVE DATA ON PRESENT PRODUCTIVE ZONE AND PROPOSED NEW PRODUCTIVE ZONE. GIVE BLOWOUT PREVENTER PROGRAM, IF ANY.

I hereby certify that the information above is true and complete to the best of my knowledge and belief.

Signed Alfred A. Klein Title President Date 9-4-74

(This space for State Use)

SUPERVISOR DIST. #3

APPROVED BY Ernest Chavez TITLE

DATE SEP 4 1974

CONDITIONS OF APPROVAL, IF ANY:

**NEW MEXICO OIL CONSERVATION COMMISSION  
WELL LOCATION AND ACREAGE DEDICATION PLAT**

Form C-102  
Supersedes C-128  
Effective 1-1-65

All distances must be from the outer boundaries of the Section.

Operator <b>K &amp; W OIL COMPANY</b>			Lease <b>J2c3</b>		Well No. <b>179</b>
Unit Letter <b>L</b>	Section <b>32</b>	Township <b>20 NORTH</b>	Range <b>9 WEST</b>	County <b>McKINLEY</b>	
Actual Footage Location of Well: <b>2310</b> feet from the <b>SOUTH</b> line and <b>660</b> feet from the <b>WEST</b> line					
Ground Level Elev. <b>6455.0</b>	Producing Formation <b>Mesaverde -</b>		Pool <b>Blackeye - Mesaverde</b>	Dedicated Acreage: <b>90</b> Acres	

1. Outline the acreage dedicated to the subject well by colored pencil or hatchure marks on the plat below.
2. If more than one lease is dedicated to the well, outline each and identify the ownership thereof (both as to working interest and royalty).
3. If more than one lease of different ownership is dedicated to the well, have the interests of all owners been consolidated by communitization, unitization, force-pooling, etc?

☐ Yes    ☐ No    If answer is "yes," type of consolidation \_\_\_\_\_

If answer is "no," list the owners and tract descriptions which have actually been consolidated. (Use reverse side of this form if necessary.) \_\_\_\_\_

No allowable will be assigned to the well until all interests have been consolidated (by communitization, unitization, forced-pooling, or otherwise) or until a non-standard unit, eliminating such interests, has been approved by the Commission.

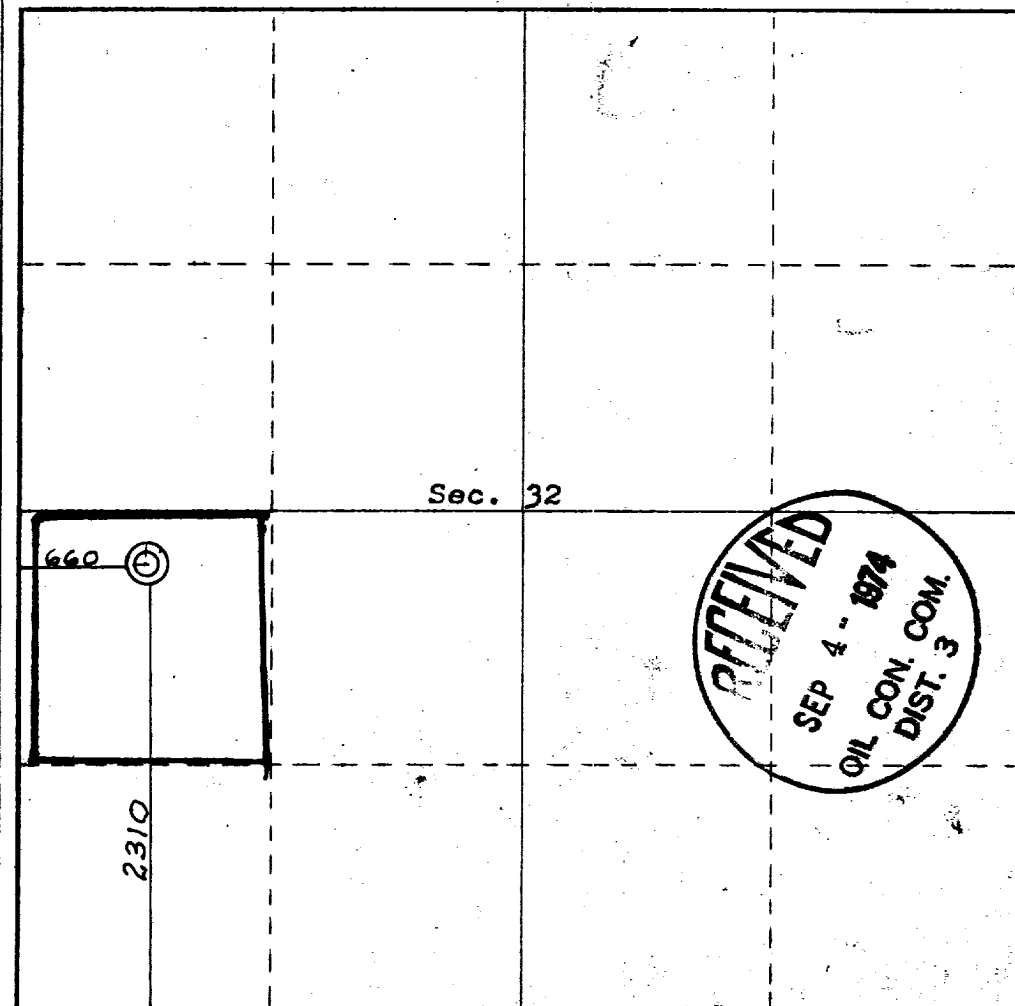

**CERTIFICATION**

I hereby certify that the information contained herein is true and complete to the best of my knowledge and belief.

Name **James H. Liles**  
President

Position **K & W Oil Co**

Company **9-3-74**

Date

I hereby certify that the well location shown on this plat was plotted from field notes of actual surveys made by me or under my supervision, and that the same is true and correct to the best of my knowledge and belief.

**1974**

Surveyed by **JAMES H. LILES**  
Registered Professional Engineer  
No. **1463**  
State of New Mexico  
Professional Seal

Certificate No. \_\_\_\_\_

0 330 660 90 1320 1650 1980 2310 2640 2000 1500 1000 500