

NO. OF COPIES RECEIVED	5
DISTRIBUTION	
SANTA FE	/
FILE	/
U.S.G.S.	/
LAND OFFICE	/
OPERATOR	/

NEW MEXICO OIL CONSERVATION COMMISSION

Form C-101
Revised 1-1-65

API - 30-031 - 20472

5A. Indicate Type of Lease	
STATE <input type="checkbox"/>	FEE <input checked="" type="checkbox"/>
5. State Oil & Gas Lease No.	

APPLICATION FOR PERMIT TO DRILL, DEEPEN, OR PLUG BACK

1a. Type of Work		7. Unit Agreement Name	
b. Type of Well DRILL <input checked="" type="checkbox"/> DEEPEN <input type="checkbox"/> PLUG BACK <input type="checkbox"/> OIL WELL <input checked="" type="checkbox"/> GAS WELL <input type="checkbox"/> OTHER <input type="checkbox"/> SINGLE ZONE <input checked="" type="checkbox"/> MULTIPLE ZONE <input type="checkbox"/>		8. Farm or Lease Name Santa Fe Pacific RR	
2. Name of Operator Northern Minerals, Inc.		9. Well No. #1 Moore	
3. Address of Operator P. O. Box 2182, Santa Fe, New Mexico 87501		10. Field and Pool, or Wildcat Wildcat Dakota	
4. Location of Well UNIT LETTER <u>K</u> LOCATED <u>2100'</u> FEET FROM THE <u>South</u> LINE AND <u>1650</u> FEET FROM THE <u>West</u> LINE OF SEC. <u>3</u> TWP. <u>17N</u> RGE. <u>8W</u> NMPM		12. County McKinley	
21. Elevations (Show whether DF, RT, etc.) 6847		19. Proposed Depth 2,900	19A. Formation Dakota "D"
21A. Kind & Status Plug. Bond Statewide	21B. Drilling Contractor Chesney Drilling	20. Rotary or C.T. Rotary	
22. Approx. Date Work will start Upon Approval			

PROPOSED CASING AND CEMENT PROGRAM

SIZE OF HOLE	SIZE OF CASING	WEIGHT PER FOOT	SETTING DEPTH	SACKS OF CEMENT	EST. TOP
8-5/8"	7"	20 lb.	60'	Suff. to Circulate	
6-1/4"	4-1/2"	10.5 lb.	2,900	Suff. to cover 500 feet above Hoshan	

APPROVED
FOR SO & GAS DIST
DRILLING OPERATIONS

EXPIRES 4-5-76

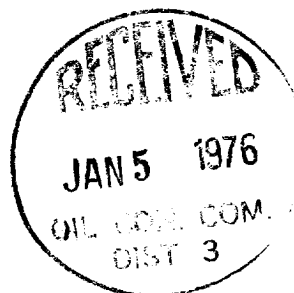

IN ABOVE SPACE DESCRIBE PROPOSED PROGRAM: IF PROPOSAL IS TO DEEPEN OR PLUG BACK, GIVE DATA ON PRESENT PRODUCTIVE ZONE AND PROPOSED NEW PRODUCTIVE ZONE. GIVE BLOWOUT PREVENTER PROGRAM, IF ANY.

I hereby certify that the information above is true and complete to the best of my knowledge and belief.

Signed Leopoldo Hernandez Title President Date 12-16-75

(This space for State Use)

APPROVED BY AR Hendrick TITLE SUPERVISOR DIST. #3 DATE JAN 6 1976

CONDITIONS OF APPROVAL, IF ANY:

Valid for 1000 ft. in Pool

NEW MEXICO OIL CONSERVATION COMMISSION
WELL LOCATION AND ACREAGE DEDICATION PLAT

Form C-102
Supersedes C-128
Effective 1-1-65

All distances must be from the outer boundaries of the Section.

Operator NORTHERN MINERALS			Lease santa Fe Pacific Railroad		Well No. # 1 Moore
Unit Letter K	Section 3	Township 17North	Range 8 West	County McKinley	
Actual Footage Location of Well: 2100 feet from the South line and 1650 feet from the West line					
Ground Level Elev. 6847	Producing Formation Wildcat Dakota		Pool Wildcat	Dedicated Acreage 40 Acres	

1. Outline the acreage dedicated to the subject well by colored pencil or hatchure marks on the plat below.
2. If more than one lease is dedicated to the well, outline each and identify the ownership thereof (both as to working interest and royalty).
3. If more than one lease of different ownership is dedicated to the well, have the interests of all owners been consolidated by communitization, unitization, force-pooling, etc?

☐ Yes ☐ No If answer is "yes," type of consolidation _____

If answer is "no," list the owners and tract descriptions which have actually been consolidated. (Use reverse side of this form if necessary.) _____

No allowable will be assigned to the well until all interests have been consolidated (by communitization, unitization, forced-pooling, or otherwise) or until a non-standard unit, eliminating such interests, has been approved by the Commission.

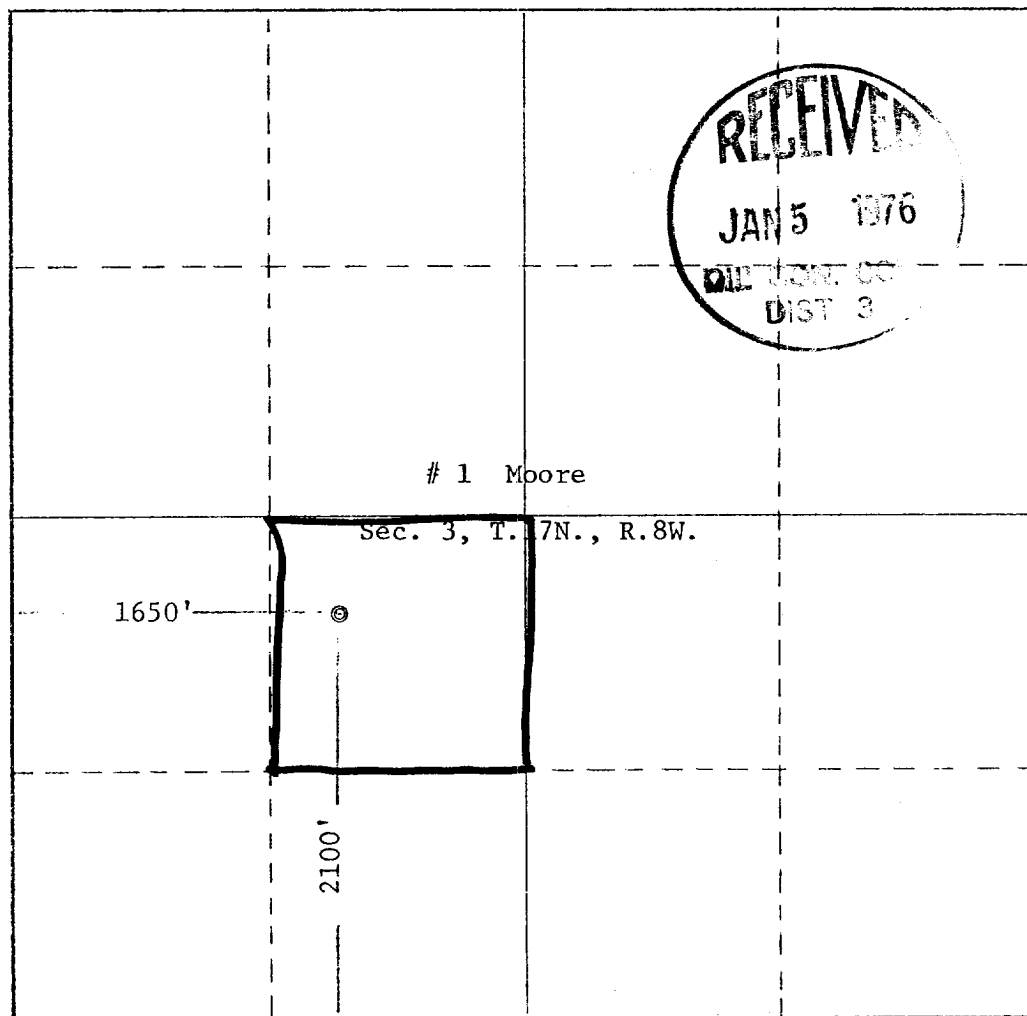

CERTIFICATION

I hereby certify that the information contained herein is true and complete to the best of my knowledge and belief.

Lloyd Davidson
Name

Lloyd Davidson

Position
President

Company
Northern Minerals, Inc

Date
12-16-75

I hereby certify that the well location shown on this plat was plotted from field notes of actual surveys made by me or under my supervision, and that the same is true and correct to the best of my knowledge and belief.

Date Surveyed
Dec. 13, 1975

Registered Professional Engineer and/or Land Surveyor

F. D. Davidson

Certificate No.
2031

0 330 660 990 1320 1650 1980 2310 2540 2000 1500 1000 500 0