

NO. OF COPIES RECEIVED	5
DISTRIBUTION	
SANTA FE	1
FILE	1 ✓
U.S.G.S.	1
LAND OFFICE	1
OPERATOR	1

NEW MEXICO OIL CONSERVATION COMMISSION

Form C-101
Revised 1-1-65

API 30-031-20473

5A. Indicate Type of Lease
STATE ☐ FEE ☒

5. State Oil & Gas Lease No.

APPLICATION FOR PERMIT TO DRILL, DEEPEN, OR PLUG BACK

1a. Type of Work DRILL <input checked="" type="checkbox"/> DEEPEN <input type="checkbox"/> PLUG BACK <input type="checkbox"/>		7. Unit Agreement Name
b. Type of Well OIL WELL <input checked="" type="checkbox"/> GAS WELL <input type="checkbox"/> OTHER <input type="checkbox"/> SINGLE ZONE <input type="checkbox"/> MULTIPLE ZONE <input type="checkbox"/>		8. Farm or Lease Name Santa Fe Pacific RR
2. Name of Operator Northern Minerals, Inc.		9. Well No. #1 Carrica
3. Address of Operator P. O. Box 2182, Santa Fe, New Mexico 87501		10. Field and Pool, or Wildcat Wildcat Dakota
4. Location of Well UNIT LETTER B LOCATED 1650 FEET FROM THE East LINE AND 330 FEET FROM THE North LINE OF SEC. 26 TWP. 18N RGE. 8W NMPM		12. County McKinley
19. Proposed Depth 3200'		19A. Formation Dakota
20. Rotary or C.T. Rotary		
21. Elevations (Show whether DI, RT, etc.) 6818'	21A. Kind & Status Plug. Bond Statewide	21B. Drilling Contractor Chesney Drilling
22. Approx. Date Work will start Upon Approval		

PROPOSED CASING AND CEMENT PROGRAM

SIZE OF HOLE	SIZE OF CASING	WEIGHT PER FOOT	SETTING DEPTH	SACKS OF CEMENT	EST. TOP
8-5/8"	7"	20 lb.	60'	Suff. To Circ.	
6-1/4"	4-1/2"	10.5 lb.	3,200'	Suffic. to cover 500'	
				above Hosphat	

APPROVAL VALID
FOR 90 DAYS UNLESS
DRILLING COMMENCED,

EXPIRES 4-6-76

IN ABOVE SPACE DESCRIBE PROPOSED PROGRAM: IF PROPOSAL IS TO DEEPEN OR PLUG BACK, GIVE DATA ON PRESENT PRODUCTIVE ZONE AND PROPOSED NEW PRODUCTIVE ZONE. GIVE BLOWOUT PREVENTER PROGRAM, IF ANY.

I hereby certify that the information above is true and complete to the best of my knowledge and belief.

Signed Leopold Davidson Title President Date 12-16-75

(This space for State Use)

APPROVED BY AK Hendrick TITLE SUPERVISOR DEPT. OF DATE JAN 7 1976

CONDITIONS OF APPROVAL, IF ANY:

Handwritten notes and signatures at the bottom of the page.

NEW MEXICO OIL CONSERVATION COMMISSION
WELL LOCATION AND ACREAGE DEDICATION PLAT

Form O-102
Supersedes O-128
Effective 1-1-65

All distances must be from the outer boundaries of the Section.

Operator NORTHERN MINERALS			Lease Santa Fe Pacific Railroad		Well No. #1 Carrica
Unit Letter	Section 26	Township 18 North	Range 8 West	County McKinley	
Actual Footage Location of Well: <div style="display: flex; justify-content: space-between;"> 330 feet from the North line and 1650 feet from the East line </div>					
Ground Level Elev. 6818	Producing Formation Wildcat Dakota	Pool Wildcat		Dedicated Acreage: 40 Acres	

1. Outline the acreage dedicated to the subject well by colored pencil or hatchure marks on the plat below.
2. If more than one lease is dedicated to the well, outline each and identify the ownership thereof (both as to working interest and royalty).
3. If more than one lease of different ownership is dedicated to the well, have the interests of all owners been consolidated by communitization, unitization, force-pooling, etc?

☐ Yes ☐ No If answer is "yes," type of consolidation _____

If answer is "no," list the owners and tract descriptions which have actually been consolidated. (Use reverse side of this form if necessary.) _____

No allowable will be assigned to the well until all interests have been consolidated (by communitization, unitization, forced-pooling, or otherwise) or until a non-standard unit, eliminating such interests, has been approved by the Commission.

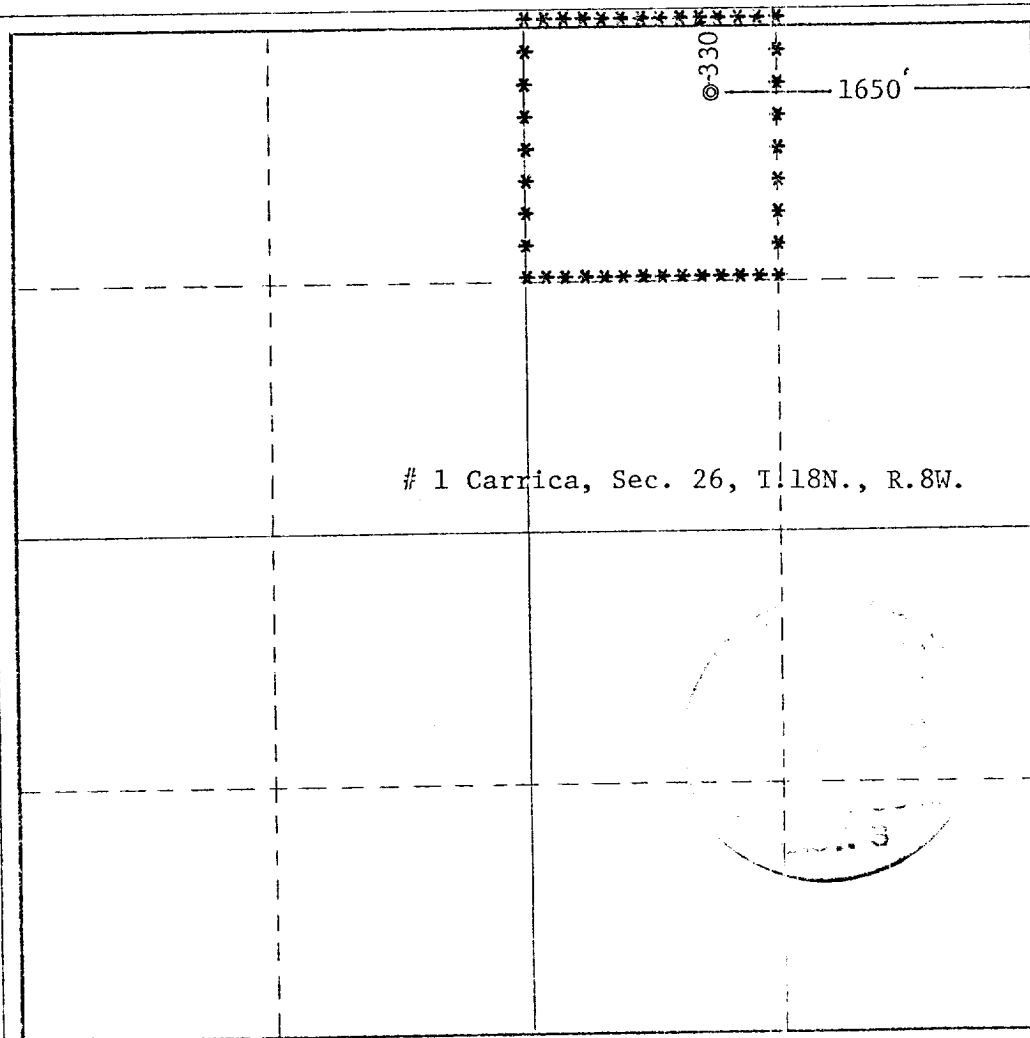

CERTIFICATION

I hereby certify that the information contained herein is true and complete to the best of my knowledge and belief.

Lloyd Davidson
Name

Lloyd Davidson
Position

President
Company

Northern Minerals, Inc.
Date

12-16-75

I hereby certify that the well location shown on this plat was plotted from field notes of actual surveys made by me or under my supervision, and that the same is true and correct to the best of my knowledge and belief.

Date Surveyed
Dec. 13, 1975

Registered Professional Engineer
an/or Land Surveyor

W. J. M...

Certificate No.
2031

