

UNITED STATES  
DEPARTMENT OF THE INTERIOR  
GEOLOGICAL SURVEY

## APPLICATION FOR PERMIT TO DRILL, DEEPEN, OR PLUG BACK

## 1a. TYPE OF WORK

DRILL ☒DEEPEN ☐PLUG BACK ☐

## b. TYPE OF WELL

OIL  
WELL ☒GAS  
WELL ☐OTHER ☐SINGLE  
ZONE ☒MULTIPLE  
ZONE ☐

## 2. NAME OF OPERATOR

Filon Exploration Corporation

## 3. ADDRESS OF OPERATOR

c/o Minerals Management Inc.

501 Airport Dr., Suite 105, Farmington, N.M. 87401

## 4. LOCATION OF WELL (Report location clearly and in accordance with any State requirements.)\*

At surface

1900' FEL, 660' FSL, SEC. 25, T20N, R5W

At proposed prod. zone

## 14. DISTANCE IN MILES AND DIRECTION FROM NEAREST TOWN OR POST OFFICE\*

28 miles SW of Cuba, New Mexico

## 15. DISTANCE FROM PROPOSED\*

LOCATION TO NEAREST

PROPERTY OR LEASE LINE, FT.

(Also to nearest drlg. unit line, if any) 660' FSL

## 16. NO. OF ACRES IN LEASE

160

## 18. DISTANCE FROM PROPOSED LOCATION\*

TO NEAREST WELL, DRILLING, COMPLETED,  
OR APPLIED FOR, ON THIS LEASE, FT.

## 19. PROPOSED DEPTH

3800'

17. NO. OF ACRES ASSIGNED  
TO THIS WELL

40

## 20. ROTARY OR CABLE TOOLS

Rotary

## 21. ELEVATIONS (Show whether DF, RT, GR, etc.)

## 22. APPROX. DATE WORK WILL START\*

February 20, 1976

## 23.

## PROPOSED CASING AND CEMENTING PROGRAM

SIZE OF HOLE	SIZE OF CASING	WEIGHT PER FOOT	SETTING DEPTH	QUANTITY OF CEMENT
12 1/4"	8 5/8"	24.00#	200'	160 sx
7 7/8"	4 1/2"	10.50#	3800'	200 sx/600 2 stage

Operator proposes to drill a Gallup test to 3800'. Completion will be determined from open hole logs. A Series 900 (3000 psi) blowout preventer will be used.



IN ABOVE SPACE DESCRIBE PROPOSED PROGRAM: If proposal is to deepen or plug back, give data on present productive zone and proposed new productive zone. If proposal is to drill or deepen directionally, give pertinent data on subsurface locations and measured and true vertical depths. Give blowout preventer program, if any.

24. J. Arnold Self SIGNED Area Manager TITLE Minerals Management Inc. DATE February 18, 1976

(This space for Federal or State office use)

PERMIT NO. \_\_\_\_\_

APPROVAL DATE \_\_\_\_\_

APPROVED BY \_\_\_\_\_

TITLE \_\_\_\_\_

DATE \_\_\_\_\_

CONDITIONS OF APPROVAL, IF ANY:

\*See Instructions On Reverse Side

**NEW MEXICO OIL CONSERVATION COMMISSION  
WELL LOCATION AND ACREAGE DEDICATION PLAT**

Form C-102  
Supersedes C-128  
Effective 1-1-65

All distances must be from the outer boundaries of the Section.

Operator <b>Filon Exploration</b>			Lease <b>Navajo Allotted 25</b>		Well No. <b>1</b>
Unit Letter <b>0</b>	Section <b>25</b>	Township <b>20N</b>	Range <b>5W</b>	County <b>McKinley</b>	
Actual Footage Location of Well:					
<b>660</b>	feet from the <b>South</b>	line and	<b>1900</b>	feet from the <b>East</b>	line
Ground Level Elev. <b>6633</b>	Producing Formation <b>Gallup</b>	Pool <b>Wildcat</b>	Dedicated Acreage: <b>40</b> Acres		

1. Outline the acreage dedicated to the subject well by colored pencil or hachure marks on the plat below.
2. If more than one lease is dedicated to the well, outline each and identify the ownership thereof (both as to working interest and royalty).
3. If more than one lease of different ownership is dedicated to the well, have the interests of all owners been consolidated by communitization, unitization, force-pooling, etc?

☐ Yes    ☐ No    If answer is "yes," type of consolidation \_\_\_\_\_

If answer is "no," list the owners and tract descriptions which have actually been consolidated. (Use reverse side of this form if necessary.) \_\_\_\_\_

No allowable will be assigned to the well until all interests have been consolidated (by communitization, unitization, forced-pooling, or otherwise) or until a non-standard unit, eliminating such interests, has been approved by the Commission.

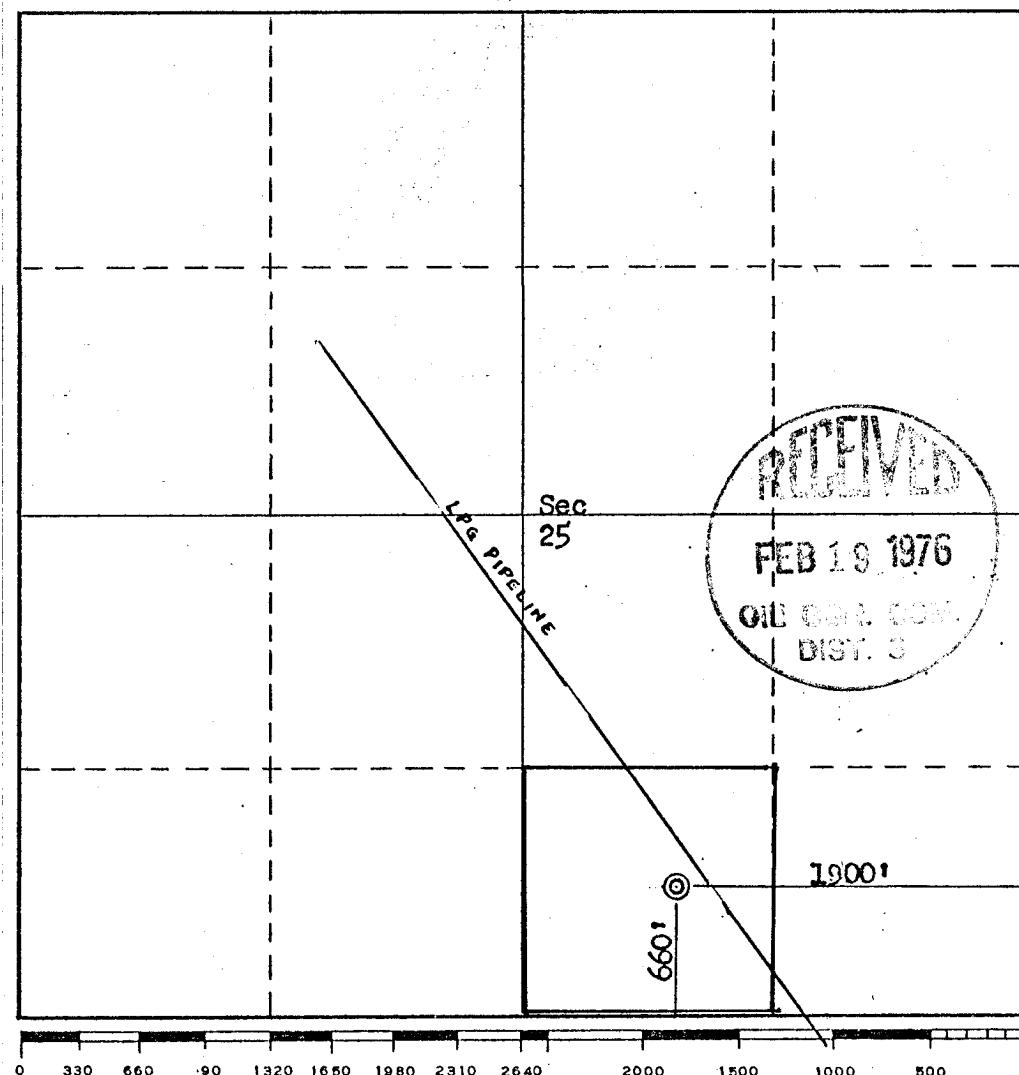

**CERTIFICATION**

*I hereby certify that the information contained herein is true and complete to the best of my knowledge and belief.*

Name **J. Amos Bell**  
 Position \_\_\_\_\_  
 Area Manager  
 Company \_\_\_\_\_  
**Minerals Management Inc.**  
 Date \_\_\_\_\_  
**February 18, 1976**

*I hereby certify that the well location shown on this plat was plotted from field notes of actual surveys made by me or under my supervision, and that the same is true and correct to the best of my knowledge and belief.*

Date Surveyed \_\_\_\_\_  
**February 12, 1976**  
 Registered Professional Engineer and/or Land Surveyor  
**Fred B. Kern Jr.**  
 Certificate No. \_\_\_\_\_  
**3950**

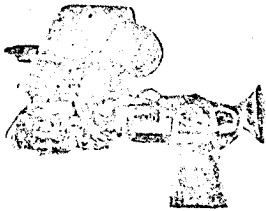

MINERALS MANAGEMENT INCORPORATED  
A Division of SCIENTIFIC SOFTWARE CORPORATION

February 13, 1976

DEVELOPMENT PLAN FOR SURFACE USE

FILON EXPLORATION CORPORATION

NAVAJO ALLOTTED 25 WELL NO. 1

1900' FEL, 660' FSL, SEC. 25, T20N, R5W

MCKINLEY COUNTY, NEW MEXICO



1. Existing Roads

The main road in the area will be the road from Ojo Encino School to Torreon Highway at Penistja Trading Post intersection.

2. Planned Access Road

The access road will be the existing road previously used for Filon State 36A Well No. 2 in NW NE Section 36, T20N, R5W.

3. Location of Existing Wells

The only nearby well is abandoned well State 36A Well No. 2, located 660' FNL, 1650' FEL, SEC. 36, T20N, R5W, McKinley County, New Mexico.

4. Lateral Roads

Show on topographic map.

5. Location of Tank Batteries and Flowlines

Will be initially located on the drill pad approximately 150' from the well if production is encountered.

6. Water Supply

Water to be hauled to well site. BLM Encino water well to be utilized.

7. Method of Handling Waste Disposal

Waste will be buried in the reserve pit on completion of the well. The reserve pit will be backfilled. Toilet facilities will be provided.

8. Location of Camp

No camp will be used.

9. Location of Airstrip

None

10. Diagram of Well Location

Well will be located 230' west of the pipeline as shown on attached diagram.

11. Plans for Restoration of Surface

The surface will be restored and reseeded as directed by Bureau of Indian Affairs.

12. Impact on the Environment

Impact on the Environment will be minimal. The area is sparsely vegetated and no trees will be disturbed.



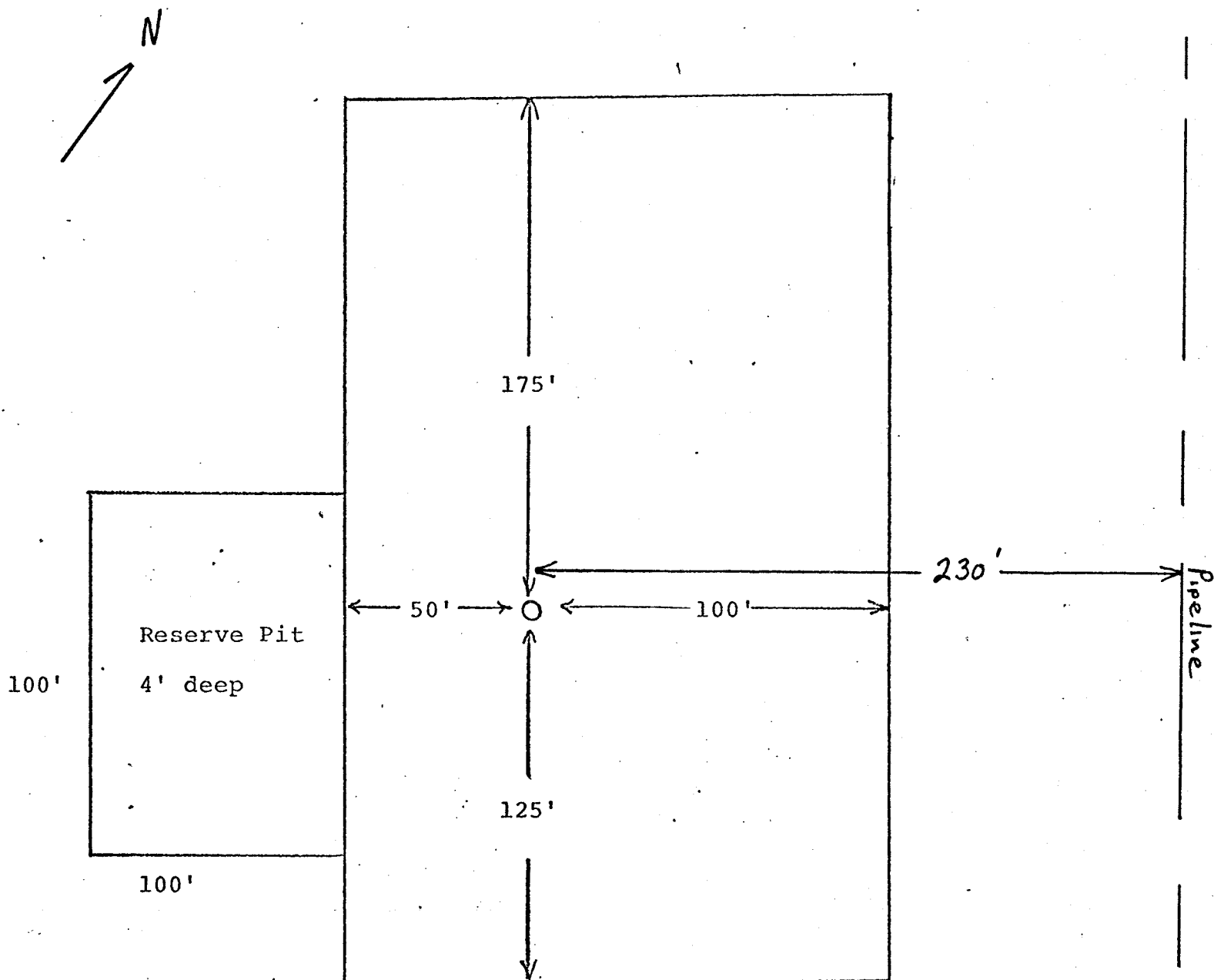

DIAGRAM OF WELL LOCATION



