

UNITED STATES
DEPARTMENT OF THE INTERIOR
GEOLOGICAL SURVEY

API 30-031-20476

5. LEASE DESIGNATION AND SERIAL NO.

NM-5980

6. IF INDIAN, ALLOTTEE OR TRIBE NAME

7. UNIT AGREEMENT NAME

8. FARM OR LEASE NAME

Federal 21

9. WELL NO.

1

10. FIELD AND POOL, OR WILDCAT

Wildcat Entrada

11. SEC., T., R., M., OR BLK.
AND SURVEY OR AREA

N

SEC. 21, T20N, R5W

12. COUNTY OR PARISH 13. STATE

McKinley New Mexico

1a. TYPE OF WORK

DRILL ☒DEEPEN ☐PLUG BACK ☐

b. TYPE OF WELL

OIL
WELL ☒GAS
WELL ☐

OTHER

SINGLE
ZONE ☒MULTIPLE
ZONE ☐

2. NAME OF OPERATOR

Filon Exploration Corporation

3. ADDRESS OF OPERATOR c/o Minerals Management Inc.

501 Airport Dr., Suite 105, Farmington, New Mexico 87401

4. LOCATION OF WELL (Report location clearly and in accordance with any State requirements.*)

At surface

850' FSL, 2250' FWL, SEC. 21, T20N, R5W

At proposed prod. zone

14. DISTANCE IN MILES AND DIRECTION FROM NEAREST TOWN OR POST OFFICE*

23 miles South-Southwest Counslers Trading Post, New Mexico

15. DISTANCE FROM PROPOSED*

LOCATION TO NEAREST

PROPERTY OR LEASE LINE, FT.

(Also to nearest drlg. unit line, if any)

850 FSL

16. NO. OF ACRES IN LEASE

480

17. NO. OF ACRES ASSIGNED
TO THIS WELL

40

18. DISTANCE FROM PROPOSED LOCATION*

TO NEAREST WELL, DRILLING, COMPLETED,
OR APPLIED FOR, ON THIS LEASE, FT.

19. PROPOSED DEPTH

6200'

20. ROTARY OR CABLE TOOLS

Rotary

21. ELEVATIONS (Show whether DF, RT, GR, etc.)

6765 GR

22. APPROX. DATE WORK WILL START*

23.

PROPOSED CASING AND CEMENTING PROGRAM

SIZE OF HOLE	SIZE OF CASING	WEIGHT PER FOOT	SETTING DEPTH	QUANTITY OF CEMENT
15"	10 3/4"	40.50#	200	200 sx
8 3/4"	7"	23-26#	6200	300-500 sx 2 stage

6200' Filon Exploration Corporation (Operator) proposes to drill a Jurassic test to
-5200'. Completion will be determined from logs. A Series 900 (3000 psi) WP.
Blowout preventer will be used.

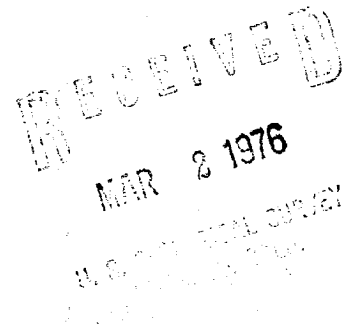

IN ABOVE SPACE DESCRIBE PROPOSED PROGRAM: If proposal is to deepen or plug back, give data on present productive zone and proposed new productive zone. If proposal is to drill or deepen directionally, give pertinent data on subsurface locations and measured and true vertical depths. Give blowout preventer program, if any.

24.

SIGNED

TITLE

Drilling Manager

Minerals Management Inc.

DATE

3-1-76

(This space for Federal or State office use)

PERMIT NO.

APPROVAL DATE

APPROVED BY

TITLE

DATE

CONDITIONS OF APPROVAL, IF ANY:

*See Instructions On Reverse Side

NEW MEXICO OIL CONSERVATION COMMISSION
WELL LOCATION AND ACREAGE DEDICATION PLAT

Form C-102
Supersedes C-128
Effective 1-1-65

All distances must be from the outer boundaries of the Section.

Operator Filon Exploration			Lease Filon-Federal 21		Well No. 1
Unit Letter N	Section 21	Township 20N	Range 5W	County McKinley	
Actual Footage Location of Well: 850 feet from the South line and 2250 feet from the West line					
Ground Level Elev. 6765	Producing Formation Entrada	Pool Wildcat		Dedicated Acreage: 40 Acres	

1. Outline the acreage dedicated to the subject well by colored pencil or hachure marks on the plat below.
2. If more than one lease is dedicated to the well, outline each and identify the ownership thereof (both as to working interest and royalty).
3. If more than one lease of different ownership is dedicated to the well, have the interests of all owners been consolidated by communitization, unitization, force-pooling, etc?

☐ Yes ☐ No If answer is "yes," type of consolidation _____

If answer is "no," list the owners and tract descriptions which have actually been consolidated. (Use reverse side of this form if necessary.) _____

No allowable will be assigned to the well until all interests have been consolidated (by communitization, unitization, forced-pooling, or otherwise) or until a non-standard unit, eliminating such interests, has been approved by the Commission.

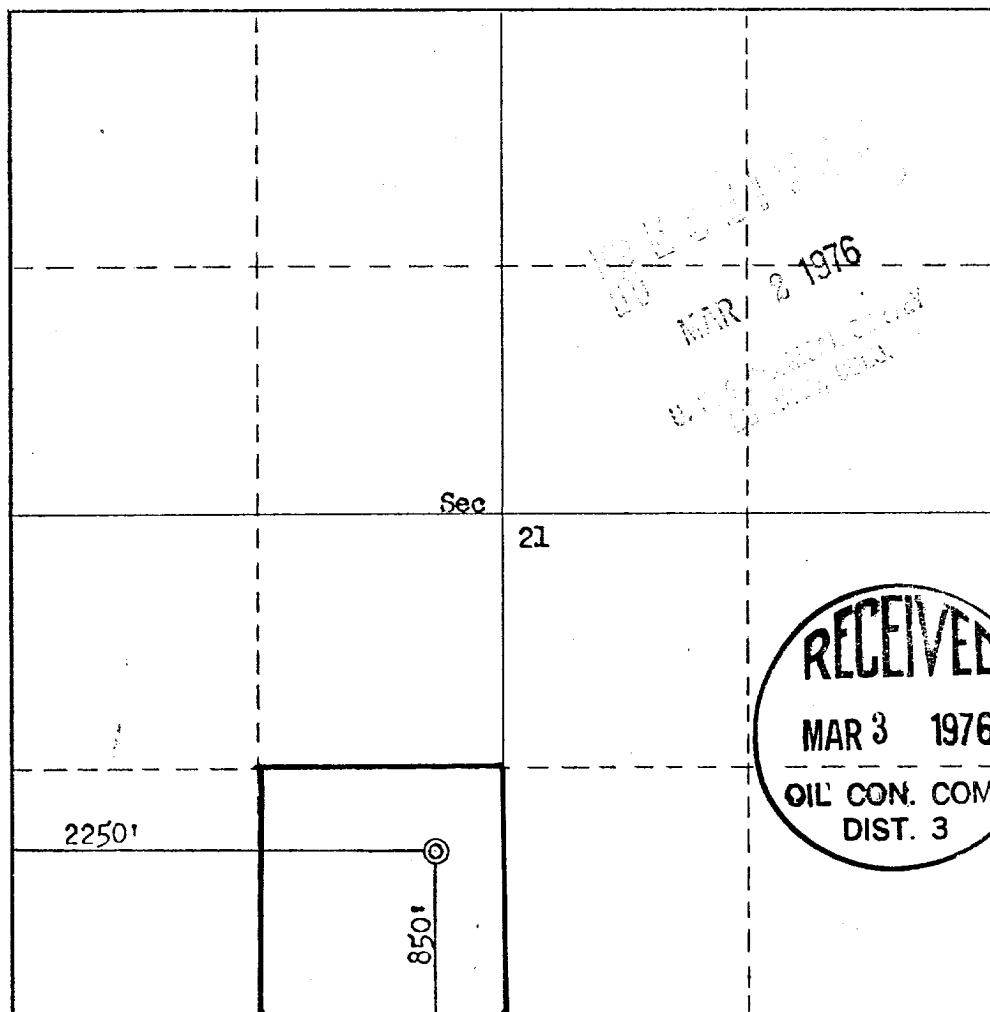

CERTIFICATION

I hereby certify that the information contained herein is true and complete to the best of my knowledge and belief.

Name Barnes
Position Drilling Manager
Company Minerals Management Inc.
Date March 1, 1976

I hereby certify that the well location shown on this plat was plotted from field notes of actual surveys made by me or under my supervision, and that the same is true and correct to the best of my knowledge and belief.

Date Surveyed February 27, 1976
Registered Professional Engineer and/or Land Surveyor Fred B. Kerr Jr.
Certificate No. 3950



MINERALS MANAGEMENT INCORPORATED
A Division of SCIENTIFIC SOFTWARE CORPORATION

March 1, 1976

DEVELOPMENT PLAN FOR SURFACE USE

FILON EXPLORATION CORPORATION

FEDERAL 21 WELL NO. 1

850' FSL, 2250' FWL, SEC. 21, T20N, R5W

MCKINLEY COUNTY, NEW MEXICO

1. Existing Roads

The existing road from Counslers Trading Post to Ojo Encino School, from the school to Star Lake Compressor Station will be used.

2. Planned Access Road

As per topographic map, approximately 800' of new road will be built.

3. Location of Existing Wells

None

4. Lateral Roads

As per topographic map.

5. Location of Tank Batteries and Flowlines

Will be initially located on location pad approximately 150' from well if production is encountered.

6. Water Supply

Water will be hauled to location from BLM Encino water well.

RECEIVED
MAR 2 1976
U.S. DEPT. OF THE INTERIOR
BUREAU OF LAND MANAGEMENT



7. Method of Handling Waste Disposal

Waste will be buried in the reserve pit on completion of the well. The reserve pit will be backfilled. Toilet facilities will be provided.

8. Location of Camp

No camp will be used.

9. Location of Airstrip

None.

10. Diagram of Well Location

See attachment.

11. Plans for Restoration to Surface

The surface will be restored and reseeded as directed by the Bureau of Land Management.

12. Impact on the Environment

Impact on the environment will be minimal. The access road and well location is sparsely vegetated and minimal trees and sage will be disturbed.



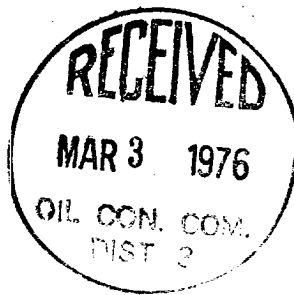
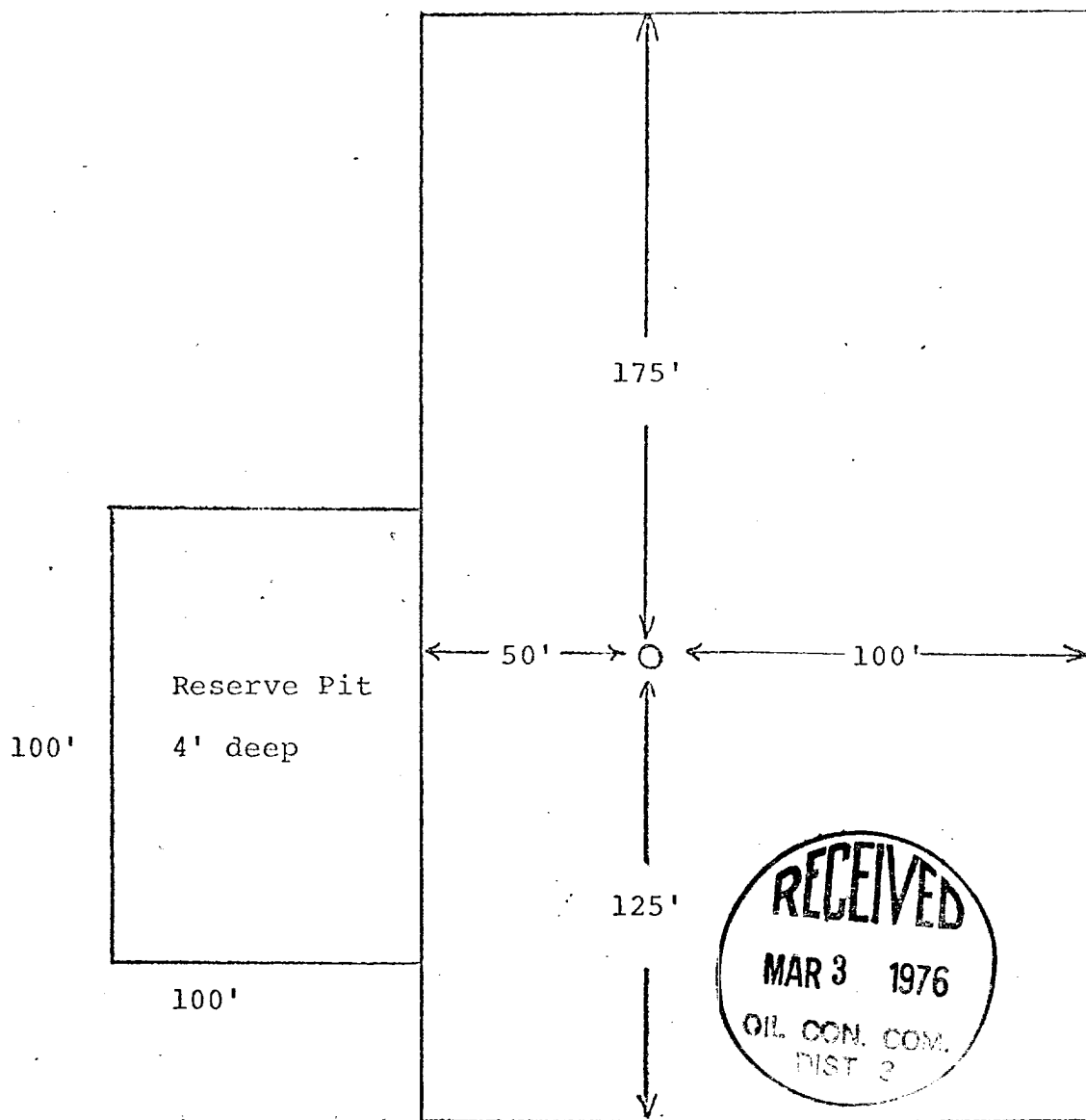

RECEIVED
MAR 2 1976
U. S. GEOLOGICAL SURVEY
DENVER, COLO.

DIAGRAM OF WELL LOCATION

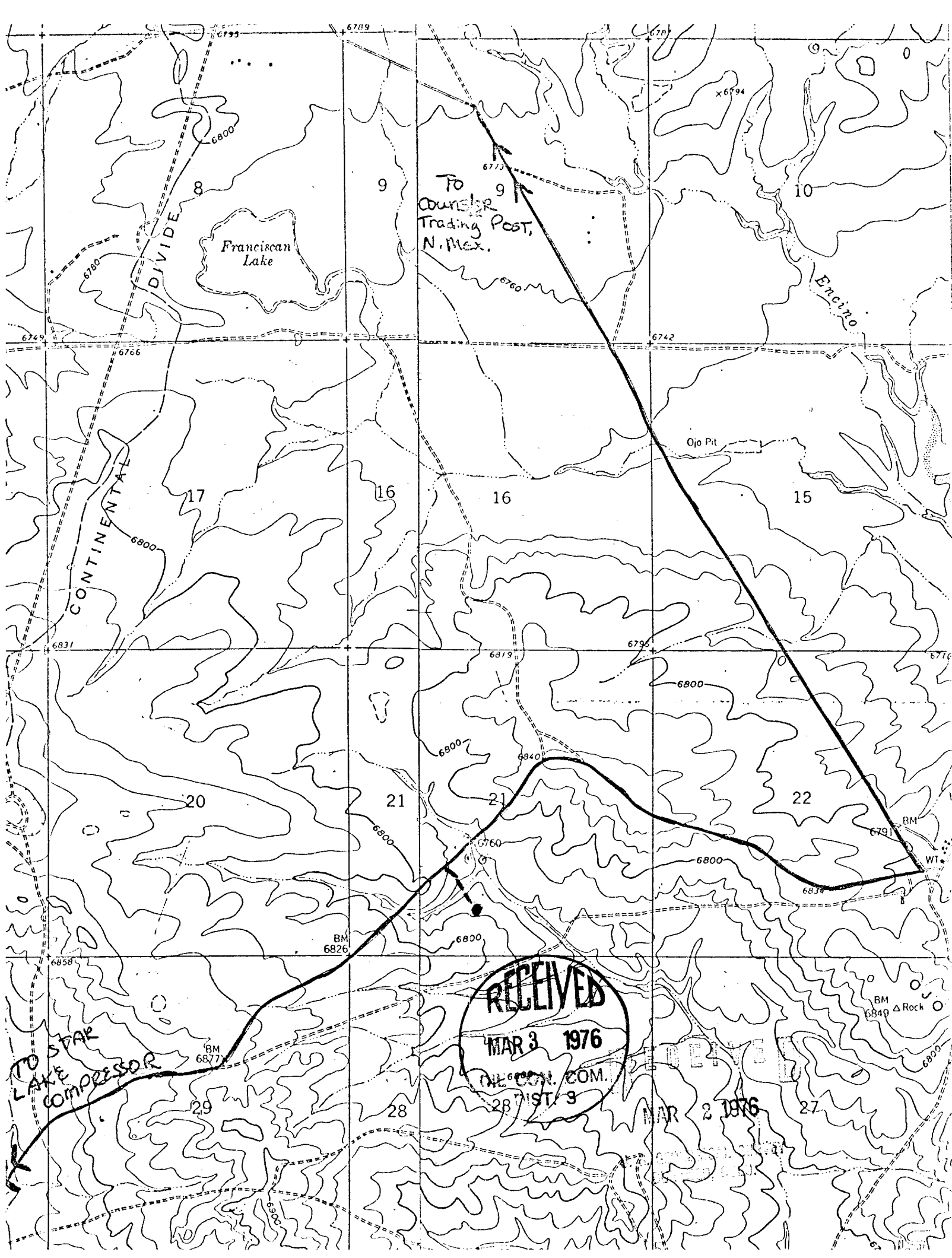

To Counselor
Trading Post,
N. Mex.

CONTINENTAL
DIVIDE

Franciscan
Lake

Encino

Ojo Pit

TO STAR
LAKE
COMPRESSOR

RECEIVED
MAR 3 1976
OIL CO. COM.
287 ST 3

MAR 2 1976