

UNITED STATES
DEPARTMENT OF THE INTERIOR
GEOLOGICAL SURVEY

API 30-031-20478

APPLICATION FOR PERMIT TO DRILL, DEEPEN, OR PLUG BACK

1a. TYPE OF WORK

DRILL ☒DEEPEN ☐PLUG BACK ☐

b. TYPE OF WELL

OIL
WELL ☒GAS
WELL ☐

OTHER

SINGLE
ZONE ☒MULTIPLE
ZONE ☐

2. NAME OF OPERATOR

Basin Fuels, Incorporated

3. ADDRESS OF OPERATOR

152 Petroleum Center Building, Farmington, New Mexico 87401

4. LOCATION OF WELL (Report location clearly and in accordance with any State requirements.)*

At surface

2310' FNL, 2260' FEL

At proposed prod. zone

Same

14. DISTANCE IN MILES AND DIRECTION FROM NEAREST TOWN OR POST OFFICE*

22 Miles SE Counselor, N.M., 5 miles southwest Ojo Encino School

15. DISTANCE FROM PROPOSED*

LOCATION TO NEAREST
PROPERTY OR LEASE LINE, FT.
(Also to nearest drlg. unit line, if any)

2260'

16. NO. OF ACRES IN LEASE

960

18. DISTANCE FROM PROPOSED LOCATION*

TO NEAREST WELL, DRILLING, COMPLETED,
OR APPLIED FOR, ON THIS LEASE, FT.

1040'

19. PROPOSED DEPTH

3000'

17. NO. OF ACRES ASSIGNED
TO THIS WELL

40 if oil, 160 if gas

20. ROTARY OR CABLE TOOLS

Rotary

21. ELEVATIONS (Show whether DF, RT, GR, etc.)

6757' GR

22. APPROX. DATE WORK WILL START*

June 7, 1976

23. PROPOSED CASING AND CEMENTING PROGRAM

SIZE OF HOLE	SIZE OF CASING	WEIGHT PER FOOT	SETTING DEPTH	QUANTITY OF CEMENT
11 1/2	8-5/8	24#	100	100 sx.
7-7/8	4-1/2	9.50#	3000	150 sx.

Set 8-5/8 surface casing at 100' and circulate cement. Drill to 3000', run logs, if production is indicated, set and cement 4-1/2" production casing with 150 sacks cement. Gun perforate, fracture treat in a completion attempt. If non-commercial, will plug and abandon in accordance with U.S.G.S. abandonment instructions and restore surface.

A 10" Shaffer 3000 Series blow-out preventer will be used at all times material to the drilling of the well in question.

IN ABOVE SPACE DESCRIBE PROPOSED PROGRAM: If proposal is to deepen or plug back, give data on present productive zone and proposed new productive zone. If proposal is to drill or deepen directionally, give pertinent data on surface locations and measured and true vertical depths. Give blowout preventer program, if any.

24.

SIGNED

TITLE President

DATE 4/16/76

(This space for Federal or State office use)

PERMIT NO.

APPROVAL DATE

APPROVED BY

TITLE

DATE

CONDITIONS OF APPROVAL, IF ANY:

*See Instructions On Reverse Side

**NEW MEXICO OIL CONSERVATION COMMISSION
WELL LOCATION AND ACERAGE DEDICATION PLAT**

APR 19 1976

U. S. GEOLOGICAL SURVEY
DURATION, COLO.
Well No. 2

All distances must be from the outer boundaries of the Section

Operator BASIN FUELS INCORPORATED		Lease SLICK	
Unit Letter G	Section 7	Township 20 NORTH	Range 5 WEST
		County McKINLEY	
Actual Footage Location of Well: 2310 feet from the NORTH line and 2260 feet from the EAST line			
Ground Level Elev. 6757	Producing Formation Point Lookout	Pool Undesignated-Wildcat	Dedicated Acreage: 40 Acres

1. Outline the acreage dedicated to the subject well by colored pencil or hachure marks on the plat below.
2. If more than one lease is dedicated to the well, outline each and identify the ownership thereof (both as to working interest and royalty).
3. If more than one lease of different ownership is dedicated to the well, have the interests of all owners been consolidated by communitization, unitization, force-pooling, etc?
() Yes () No If answer is "yes," type of consolidation

If answer is "no," list the owners and tract descriptions which have actually consolidated. (Use reverse side of this form if necessary.)

No allowable will be assigned to the well until all interests have been consolidated (by communitization, unitization, forced-pooling, or otherwise) or until a non standard unit, eliminating such interests, has been approved by the Commission.

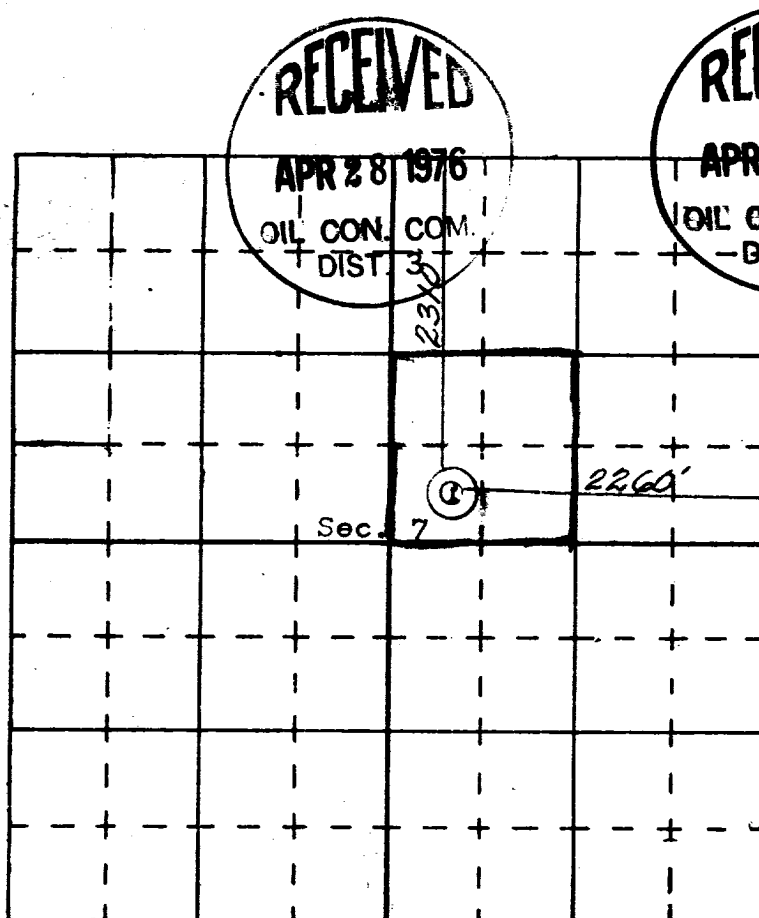

CERTIFICATION

I hereby certify that the information contained herein is true and complete to the best of my knowledge and belief.

Joel B. Burr, Jr.
Name: **Joel B. Burr, Jr.**
Position: **President**

Basin Fuels, Incorporated
Company

April 27, 1976
Date

I hereby certify that the well location shown on this plat was plotted from field notes of actual surveys made by me or under my supervision, and that the same is true and correct to the best of my knowledge and belief.

April 8, 1976
Date Surveyed

James P. Leese
Registered Professional Engineer
and/or Land Surveyor

James P. Leese

1463
Certificate No.

UNITED STATES
DEPARTMENT OF THE INTERIOR
GEOLOGICAL SURVEY

SUBMIT IN TRIPLICATE*
(Other instructions on reverse side)

Form approved.
Budget Bureau No. 42-R1424.

SUNDRY NOTICES AND REPORTS ON WELLS

(Do not use this form for proposals to drill or to deepen or plug back to a different reservoir.
Use "APPLICATION FOR PERMIT" for such proposals.)

1. OIL WELL <input checked="" type="checkbox"/> GAS WELL <input type="checkbox"/> OTHER <input type="checkbox"/>		5. LEASE DESIGNATION AND SERIAL NO. NM 0555841
2. NAME OF OPERATOR Basin Fuels, Inc.		6. IF INDIAN, ALLOTTEE OR TRIBE NAME N/A
3. ADDRESS OF OPERATOR 152 Petroleum Center Bldg., Farmington, N.M. 87401		7. UNIT AGREEMENT NAME N/A
4. LOCATION OF WELL (Report location clearly and in accordance with any State requirements.* See also space 17 below.) At surface 2310' FNL and 2260' FEL		8. FARM OR LEASE NAME Slick
14. PERMIT NO.		9. WELL NO. 2
15. ELEVATIONS (Show whether DF, RT, GR, etc.) 6769 GR		10. FIELD AND POOL, OR WILDCAT Wildcat
		11. SEC., T., R., M., OR BLK. AND SURVEY OR AREA Sec 7, T20N, R5W
		12. COUNTY OR PARISH McKinley
		13. STATE New Mexico

16. Check Appropriate Box To Indicate Nature of Notice, Report, or Other Data

NOTICE OF INTENTION TO:

TEST WATER SHUT-OFF <input type="checkbox"/>	PULL OR ALTER CASING <input type="checkbox"/>
FRACTURE TREAT <input type="checkbox"/>	MULTIPLE COMPLETE <input type="checkbox"/>
SHOOT OR ACIDIZE <input type="checkbox"/>	ABANDON* <input type="checkbox"/>
REPAIR WELL <input type="checkbox"/>	CHANGE PLANS <input type="checkbox"/>
(Other) <input type="checkbox"/>	

SUBSEQUENT REPORT OF:

WATER SHUT-OFF <input checked="" type="checkbox"/>	REPAIRING WELL <input type="checkbox"/>
FRACTURE TREATMENT <input type="checkbox"/>	ALTERING CASING <input type="checkbox"/>
SHOOTING OR ACIDIZING <input type="checkbox"/>	ABANDONMENT* <input type="checkbox"/>
(Other) <input type="checkbox"/>	

(NOTE: Report results of multiple completion on Well Completion or Recompletion Report and Log form.)

17. DESCRIBE PROPOSED OR COMPLETED OPERATIONS (Clearly state all pertinent details, and give pertinent dates, including estimated date of starting any proposed work. If well is directionally drilled, give subsurface locations and measured and true vertical depths for all markers and zones pertinent to this work.)*

6-9-76 Move in rig up - Four Corners Drilling Company. Drill 7 7/8" hole to total depth 3010 feet. Ran IES and FDC logs. Set 4 1/2" 9.5# k-55 casing at 2964 feet. Float at 2923 feet. Cement with 350 sacks Poz "A" 50-50 + 2% CaCl₂. Plug down 8:00 a.m. 6-12-76. Wait on cement and completion unit.



18. I hereby certify that the foregoing is true and correct

SIGNED

Jack D. Cook

TITLE

Agent

DATE

6-14-76

(This space for Federal or State office use)

APPROVED BY

TITLE

DATE

CONDITIONS OF APPROVAL, IF ANY:

DEVELOPMENT PLAN FOR SURFACE RESUME

COMPANY:

Basin Fuels, Incorporated
152 Petroleum Center Building
Farmington, New Mexico 87401

WELL:

Slick No. 2
2310' FNL, 2260' FEL
Sec. 7, T20N, R5W
McKinley County, N.M.

1. Location and vicinity map, San Juan Engineering Company.
Exit Highway 44: 22 miles northwest of lease. Directions to site: At Counselor, N.M. - Turn right, go 4.5 miles to cross-road, left at cross-road, on Ojo Encino road go 14.5 miles, at this point, trail off main road, go south 3 miles to site.
2. Approximately 1300 feet of new road will be required to reach location.
3. Four producing wells located in the SW SW Sec. 7, SE NW Sec. 7, and NW NW Sec. 18, Township 20 North, Range 5 West; and SE SE Sec. 12, Township 20 North, Range 6 West.
4. Roads shown on vicinity plat and location plat.
5. In the event of production, tank battery to be installed on location.
6. Water to come from pits adjoining existing wells on the lease.
7. All trash and waste material to be placed in mud pit and covered. No other surface to be used.
8. None.
9. None.
10. Rig layout shown on plat attached. Area is flat with sagebrush. Drilling pad to be compacted.
11. Upon completion of drilling or producing operation, the surface will be leveled and restored in accordance with instructions from appropriate governmental agency.
12. Area is flat, covered with sagebrush. Drill site to be compacted, and upon completion of operation will be leveled and restored.

Field representatives to contact:

In Farmington:

Joel B. Burr, Jr.
Basin Fuels, Incorporated
152 Petroleum Center Building
Farmington, New Mexico 87401

Phone: (505) 325-1701

Pumper at Location:

Charles Trueman
Star Lake
Cuba, New Mexico
Phone: (505) 655-3213

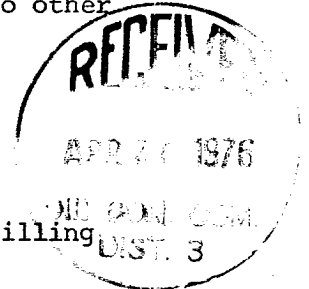

~~SANDOVAL COUNTY~~
~~MCKINLEY COUNTY~~

VICINITY MAP FOR
BASIN FUELS INC.

WELLS located in the SE 1/4 NE 1/4 of Sec. 12, T20N, R6W, and in the SW 1/4 NE 1/4 of Sec. 7, T20N, R5W, N48M, MCKINLEY COUNTY, NEW MEXICO.

SCALE: 1"=2000'

DATE: APRIL 9, 1976

**SAN JUAN ENGINEERING CO.
FARMINGTON, NEW MEXICO**

RECEIVED

APR 20 1976

OIL CON. COM
DIST 3

~~APR 13 1974~~

U. S. GOVERNMENT
PRINTING OFFICE

SCALE: 1" = 2000'

2-

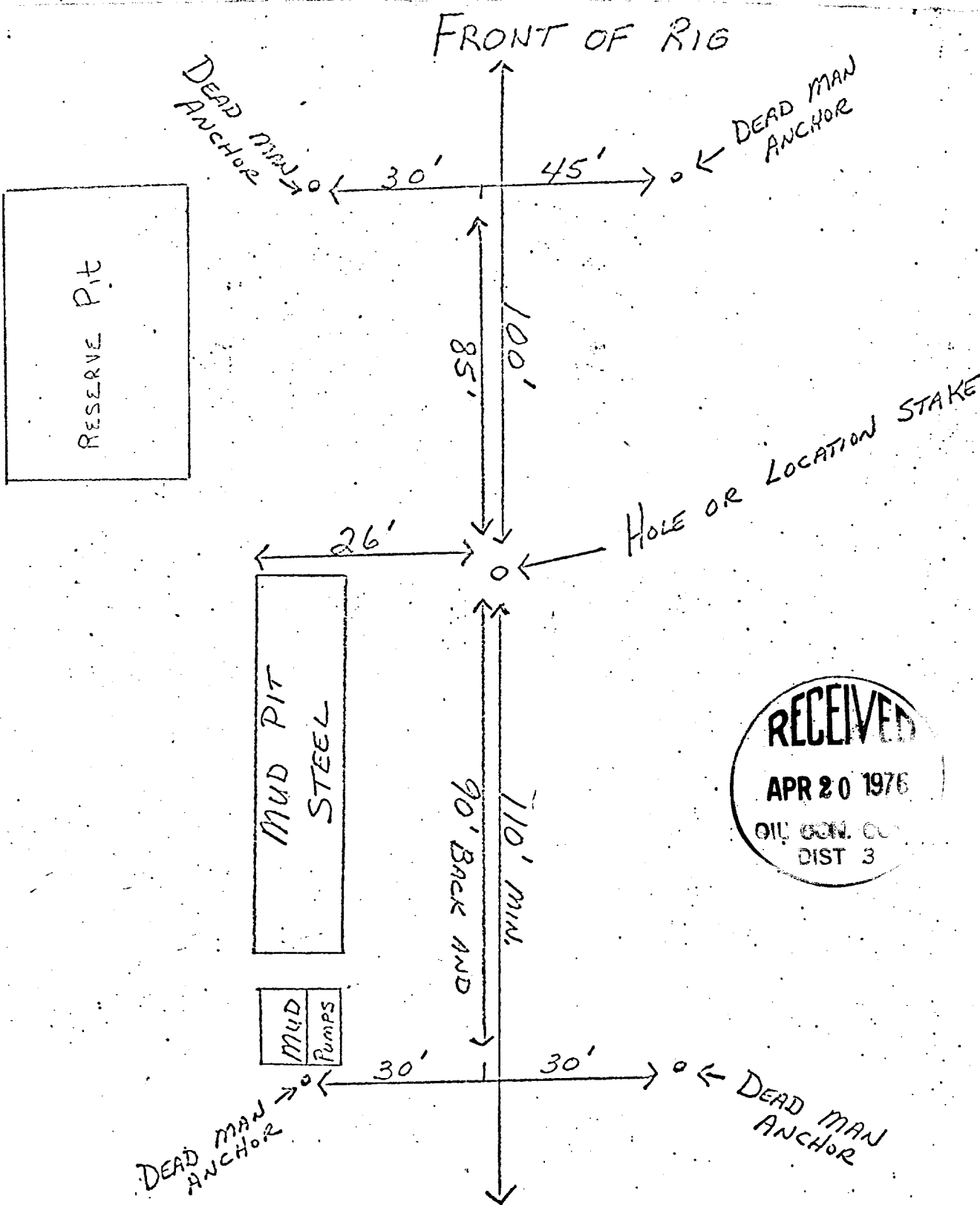

RESERVE PIT 90'X90'X5' DEEP