

UNITED STATES  
DEPARTMENT OF THE INTERIOR  
GEOLOGICAL SURVEY

API-30-031 - 20477

5. LEASE DESIGNATION AND SERIAL NO.

NM-7250

6. IF INDIAN, ALLOTTEE OR TRIBE NAME

N/A

7. UNIT AGREEMENT NAME

N/A

8. FARM OR LEASE NAME

Easter Flats

9. WELL NO.

1

10. FIELD AND POOL, OR WILDCAT

Wildcat *Mesa Verde*11. SEC., T., R., M., OR BLK.  
AND SURVEY OR AREA

H - Sec. 12, T20N, R6W

12. COUNTY OR PARISH

McKinley

13. STATE  
N.M.

## APPLICATION FOR PERMIT TO DRILL, DEEPEN, OR PLUG BACK

1a. TYPE OF WORK

DRILL ☒DEEPEN ☐PLUG BACK ☐

b. TYPE OF WELL

OIL  
WELL ☒GAS  
WELL ☐

OTHER

SINGLE  
ZONE ☒MULTIPLE  
ZONE ☐

2. NAME OF OPERATOR

Basin Fuels, Incorporated

3. ADDRESS OF OPERATOR

152 Petroleum Center Building, Farmington, New Mexico 87401

4. LOCATION OF WELL (Report location clearly and in accordance with any State requirements.)

At surface

330' FEL, 2310' FNL

At proposed prod. zone

Same

14. DISTANCE IN MILES AND DIRECTION FROM NEAREST TOWN OR POST OFFICE\*

22 miles SE Counselor, N.M., 5 miles southwest Ojo Encino School

15. DISTANCE FROM PROPOSED\*

LOCATION TO NEAREST

PROPERTY OR LEASE LINE, FT.

(Also to nearest drlg. unit line, if any)

330'

16. NO. OF ACRES IN LEASE

960

17. NO. OF ACRES ASSIGNED

TO THIS WELL

40 if oil, 160 if gas

18. DISTANCE FROM PROPOSED LOCATION\*

TO NEAREST WELL, DRILLING, COMPLETED,

OR APPLIED FOR, ON THIS LEASE, FT.

2310'

19. PROPOSED DEPTH

3000'

20. ROTARY OR CABLE TOOLS

Rotary

21. ELEVATIONS (Show whether DF, RT, GR, etc.)

6794' GR

22. APPROX. DATE WORK WILL START\*

May 28, 1976

## 23. PROPOSED CASING AND CEMENTING PROGRAM

SIZE OF HOLE	SIZE OF CASING	WEIGHT PER FOOT	SETTING DEPTH	QUANTITY OF CEMENT
11½	8-5/8	24#	100	100 sx
7-7/8	4-1/2	9.50#	3000	150 sx.

Set 8-5/8 surface casing at 100' and circulate cement. Drill to 3000', run logs, if production is indicated, set and cement 4-1/2" production casing with 150 sacks cement. Gun perforate, fracture treat in a completion attempt. If non-commercial, will plug and abandon in accordance with U.S.G.S. abandonment instructions and restore surface.

A 10" Shaffer 3000 Series blow-out preventer will be used at all times material to the drilling of the well in question.

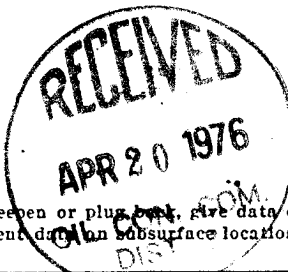

IN ABOVE SPACE DESCRIBE PROPOSED PROGRAM: If proposal is to deepen or plug back, give data on present productive zone and proposed new productive zone. If proposal is to drill or deepen directionally, give pertinent data on subsurface locations and measured and true vertical depths. Give blowout preventer program, if any.

24.

SIGNED

*Paul B. Burr, Jr.*

TITLE

President

DATE 4/16/76

(This space for Federal or State office use)

PERMIT NO.

APPROVAL DATE

APPROVED BY

TITLE

DATE

CONDITIONS OF APPROVAL, IF ANY:

*Hold C-104 for plot*

\*See Instructions On Reverse Side

NEW MEXICO OIL CONSERVATION COMMISSION  
WELL LOCATION AND ACERAGE DEDICATION PLAT

All distances must be from the outer boundaries of the Section

Operator <b>BASIN FUELS INCORPORATED</b>			Lease <b>EASTER FLATS</b>		Well No. <b>1</b>
Unit Letter <b>H</b>	Section <b>12</b>	Township <b>20 NORTH</b>	Range <b>6 WEST</b>	County <b>McKINLEY</b>	
Actual Footage Location of Well: <b>2310</b> feet from the <b>NORTH</b> line and <b>330</b> feet from the <b>EAST</b> line					
Ground Level Elev. <b>6794</b>	Producing Formation <b>Point Lookout</b>		Pool <b>Undesignated-Wildcat</b>		Dedicated Acreage: <b>40</b> Acres

1. Outline the acreage dedicated to the subject well by colored pencil or hachure marks on the plat below.
2. If more than one lease is dedicated to the well, outline each and identify the ownership thereof (both as to working interest and royalty),
3. If more than one lease of different ownership is dedicated to the well, have the interests of all owners been consolidated by communitization, unitization, force-pooling, etc?

( ) Yes ( ) No If answer is "yes," type of consolidation .....

If answer is "no," list the owners and tract descriptions which have actually consolidated. (Use reverse side of this form if necessary.) .....

No allowable will be assigned to the well until all interests have been consolidated (by communitization, unitization, forced-pooling, or otherwise) or until a non standard unit, eliminating such interests, has been approved by the Commission.

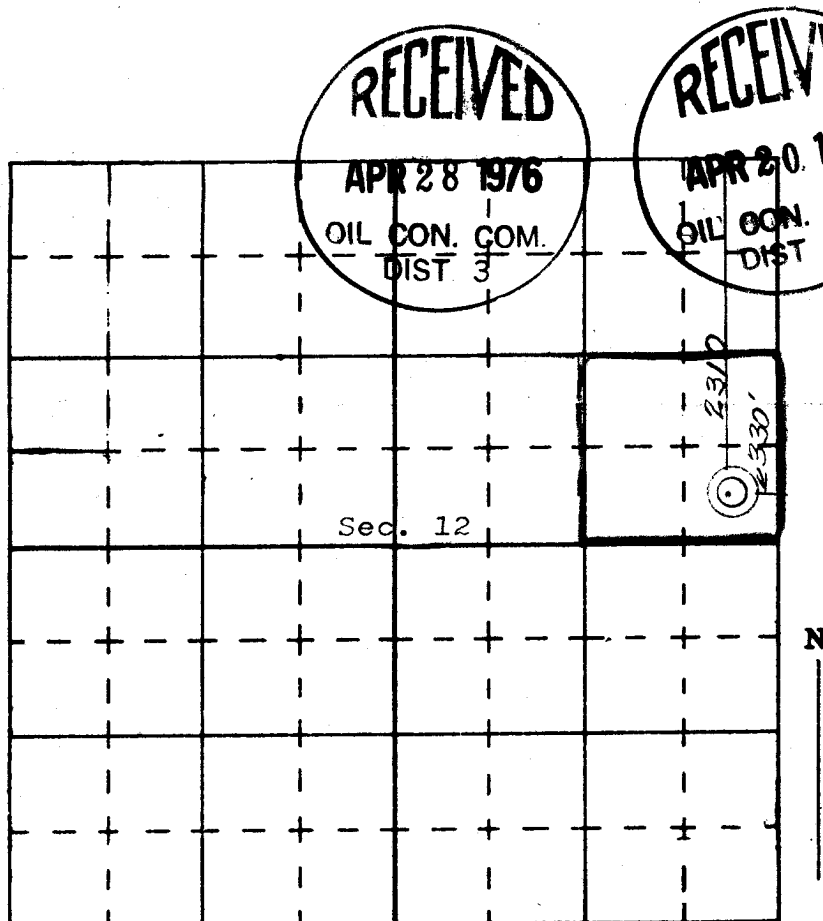

CERTIFICATION

I hereby certify that the information contained herein is true and complete to the best of my knowledge and belief.

Name

**Joel B. Burr, Jr.**

Position

**President**

Company

**Basin Fuels, Incorporated**

Date

**April 27, 1976**

I hereby certify that the well location shown on this plat was plotted from field notes of actual surveys made by me or under my supervision, and that the same are true and correct to the best of my knowledge and belief.

**8 April, 1976**

Date Surveyed

**James P. Leese**  
Registered Professional Engineer  
and/or Land Surveyor

**James P. Leese**

**1463**

Certificate No.

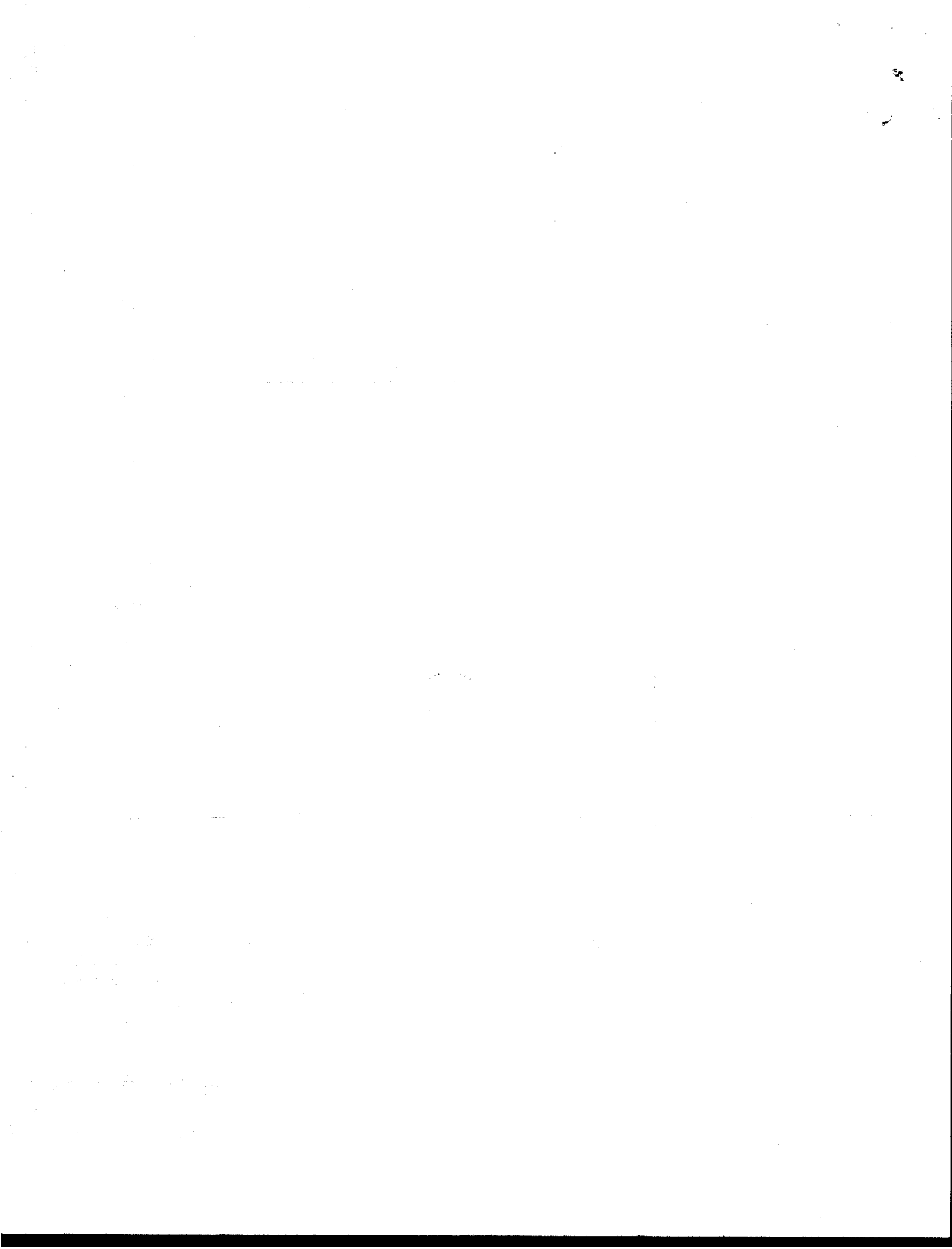

DEVELOPMENT PLAN FOR SURFACE RESUME

COMPANY:

Basin Fuels, Incorporated  
152 Petroleum Center Building  
Farmington, New Mexico 87401

WELL:

Easter Flats No. 1  
330' FEL, 2310' FNL  
Sec. 12, T20N, R6W  
McKinley County, N.M.

1. Location and vicinity map, San Juan Engineering Company.  
Exit Highway 44: 22 miles northwest of lease. Directions to site: At Counselor, N.M. - Turn right, go 4.5 miles to cross-road, left at cross-road, on Ojo Encino road go 14.5 miles, at this point, trail off main road, go south 3 miles to site.
2. No roads required; only slight improvement of existing trail will be required.
3. Four producing wells located in the SW SW Sec. 7, SE NW Sec. 7, and NW NW Sec. 18, Township 20 North, Range 5 West; and SE SE Sec. 12, Township 20 North, Range 6 West.
4. Roads shown on vicinity plat and location plat.
5. In the event of production, tank battery to be installed on location.
6. Water to come from pits adjoining existing wells on the lease.
7. All trash and waste material to be placed in mud pit and covered. No other surface to be used.
8. None.
9. None.
10. Rig layout shown on plat attached. Area is flat with sagebrush. Drilling pad to be compacted.
11. Upon completion of drilling or producing operation, the surface will be leveled and restored in accordance with instructions from appropriate governmental agency.
12. Area is flat, covered with sagebrush. Drill site to be compacted, and upon completion of operation will be leveled and restored.

Field representatives to contact:

In Farmington:

Joel B. Burr, Jr.  
Basin Fuels, Incorporated  
152 Petroleum Center Building  
Farmington, New Mexico 87401  
Phone: (505) 325-1701

Pumper at Location:

Charles Trueman  
Star Lake  
Cuba, New Mexico  
Phone: (505) 655-3213

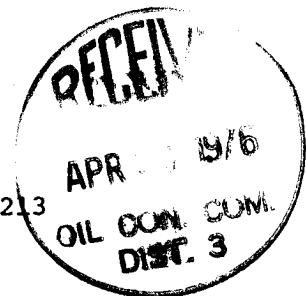

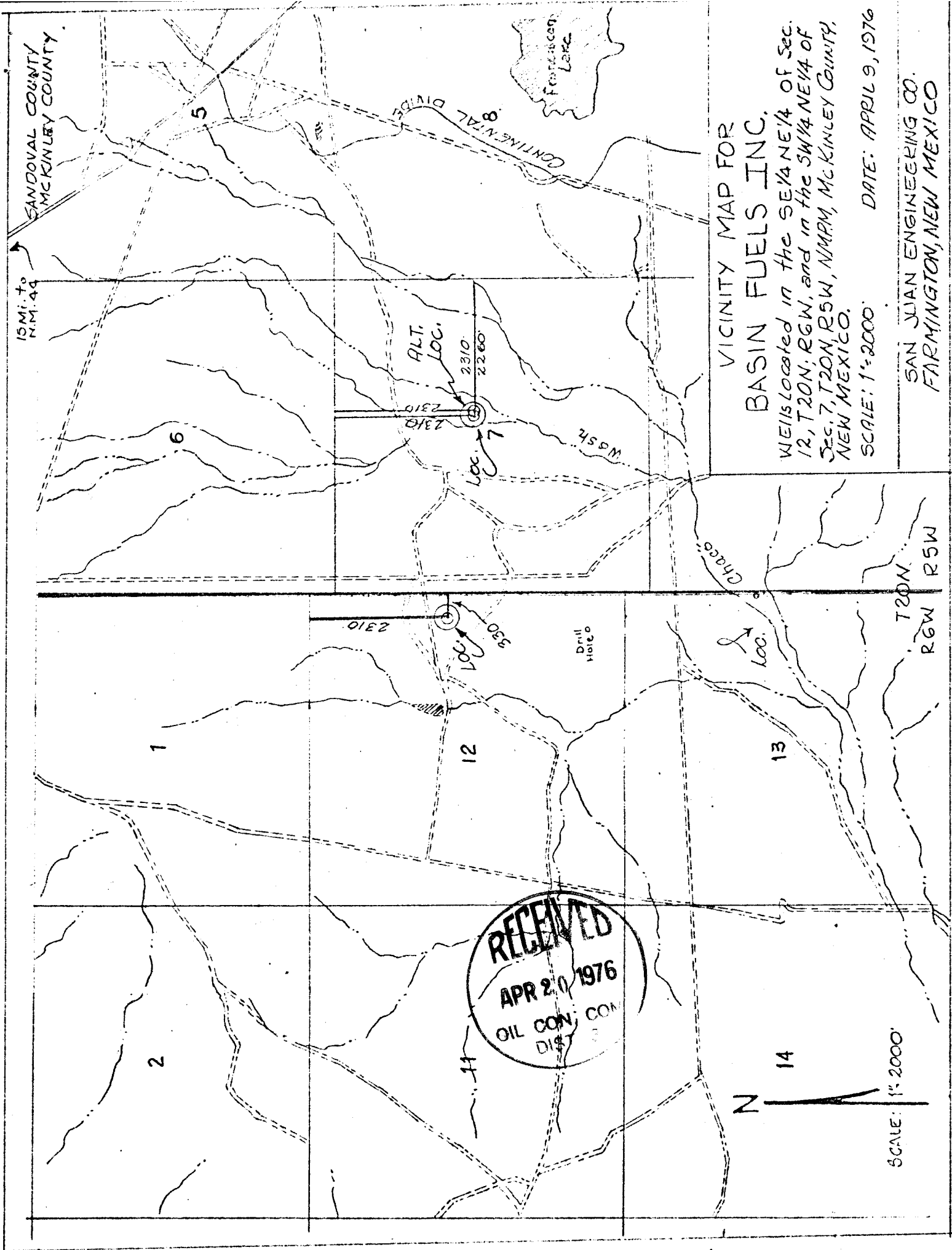

# VICINITY MAP FOR BASIN FUELS INC.

WELLS located in the SE 1/4 NE 1/4 of Sec.  
12, T20N, R6W, and in the SW 1/4 NE 1/4 of  
Sec. 7, T20N, R5W, NMPM, MCKINLEY COUNTY,  
NEW MEXICO.

SCALE: 1"=2000'

DATE: APRIL 9, 1976

SAN JUAN ENGINEERING CO.  
FARMINGTON, NEW MEXICO

RECEIVED

APR 20 1976

OIL CON. DIST. CO.

N

14

SCALE: 1"=2000'

T20N

R6W

R5W

SANDOVAL COUNTY  
MCKINLEY COUNTY

15 Mi. to  
N.M. 44

ALT.

LOC.

Loc. 7

12

13

2

11

5

6

8

Forsyth  
Lake

Wash

Chaco

Drill  
Hole

01E2

Loc.

12

Loc.

13

1

12

13

2

11

5

6

8

Forsyth  
Lake

Wash

Chaco

Drill  
Hole

01E2

Loc.

12

Loc.

13

2

11

5

6

8

Forsyth  
Lake

Wash

Chaco

Drill  
Hole

01E2

Loc.

12

Loc.

13

2

11

5

6

8

Forsyth  
Lake

Wash

Chaco

Drill  
Hole

01E2

Loc.

12

Loc.

13

2

11

5

6

8

Forsyth  
Lake

Wash

Chaco

Drill  
Hole

01E2

Loc.

12

Loc.

13

2

11

5

6

8

Forsyth  
Lake

Wash

Chaco

Drill  
Hole

01E2

Loc.

12

Loc.

13

2

11

5

6

8

Forsyth  
Lake

Wash

Chaco

Drill  
Hole

01E2

Loc.

12

Loc.

13

2

11

5

6

8

Forsyth  
Lake

Wash

Chaco

Drill  
Hole

01E2

Loc.

12

Loc.

13

2

11

5

6

8

Forsyth  
Lake

Wash

Chaco

Drill  
Hole

01E2

Loc.

12

Loc.

13

2

11

5

6

8

Forsyth  
Lake

Wash

Chaco

Drill  
Hole

01E2

Loc.

12

Loc.

13

2

11

5

6

8

Forsyth  
Lake

Wash

Chaco

Drill  
Hole

01E2

Loc.

12

Loc.

13

2

11

5

6

8

Forsyth  
Lake

Wash

Chaco

Drill  
Hole

01E2

Loc.

12

Loc.

13

2

11

5

6

8

Forsyth  
Lake

Wash

Chaco

Drill  
Hole

01E2

Loc.

12

Loc.

13

2

11

5

6

8

Forsyth  
Lake

Wash

Chaco

Drill  
Hole

01E2

Loc.

12

Loc.

13

2

11

5

6

8

Forsyth  
Lake

Wash

Chaco

Drill  
Hole

01E2

Loc.

12

Loc.

13

2

11

5

6

8

Forsyth  
Lake

Wash

Chaco

Drill  
Hole

01E2

Loc.

12

Loc.

13

2

11

5

6

8

Forsyth  
Lake

Wash

Chaco

Drill  
Hole

01E2

Loc.

12

Loc.

13

2

11

5

6

8

Forsyth  
Lake

Wash

Chaco

Drill  
Hole

01E2

Loc.

12

Loc.

13

2

11

5

6

8

Forsyth  
Lake

Wash

Chaco

Drill  
Hole

01E2

Loc.

12

Loc.

13

2

11

5

6

8

Forsyth  
Lake

Wash

Chaco

Drill  
Hole

01E2

Loc.

12

Loc.

13

2

11

5

FRONT OF RIG

DEAD MAN  
ANCHOR

DEAD MAN  
ANCHOR

30'

45'

RESERVE PIT

85'

100'

HOLE OR LOCATION STAKE

26'

MUD PIT  
STEEL

90' BACK AND

110' MIN.

MUD  
PUMPS

30'

30'

DEAD MAN  
ANCHOR

DEAD MAN  
ANCHOR

RECEIVED  
APR 20 1976  
OIL CON. COM  
DIST 3

RESERVE PIT 90' X 90' X 5' DEEP