

NO. OF COPIES RECEIVED	5
DISTRIBUTION	
SANTA FE	1
FILE	1
U.S.G.S.	2
LAND OFFICE	
OPERATOR	1

# NEW MEXICO OIL CONSERVATION COMMISSION

30-031-20489  
Form C-101  
Revised 1-1-65

5A. Indicate Type of Lease	
STATE <input type="checkbox"/>	FEE <input checked="" type="checkbox"/>
5. State Oil & Gas Lease No.	
7. Unit Agreement Name	
8. Farm or Lease Name	
Santa Fe Pacific RR	
9. Well No.	
21	
10. Field and Pool, or Wildcat	
Miguel Creek-Gallup	
12. County	
McKinley	
19. Proposed Depth	19A. Formation
800	Hospah
20. Rotary or C.T.	
Rotary	
21. Elevations (Show whether DE, RT, etc.)	22. Approx. Date Work will start
6440' G. L.	Upon Approval

APPLICATION FOR PERMIT TO DRILL, DEEPEN, OR PLUG BACK			
a. Type of Work			
DRILL <input checked="" type="checkbox"/> DEEPEN <input type="checkbox"/> PLUG BACK <input type="checkbox"/>			
b. Type of Well			
OIL WELL <input checked="" type="checkbox"/> GAS WELL <input type="checkbox"/> OTHER <input type="checkbox"/> SINGLE ZONE <input type="checkbox"/> MULTIPLE ZONE <input type="checkbox"/>			
c. Name of Operator			
Northern Minerals, Inc.			
d. Address of Operator			
Box 2182, Santa Fe, New Mexico 87501			
e. Location of Well			
UNIT LETTER H LOCATED 990' FEET FROM THE East LINE			
ND 1750 FEET FROM THE North LINE OF SEC. 29 TWP. 16N RGE. 6W NMPM			
f. Proposed Depth			
800			
g. Formation			
Hospah			
h. Rotary or C.T.			
Rotary			
i. Elevations (Show whether DE, RT, etc.)			
6440' G. L.			
j. Kind & Status Plug. Bond			
Statewide			
k. Drilling Contractor			
Chesney			
l. Approx. Date Work will start			
Upon Approval			

PROPOSED CASING AND CEMENT PROGRAM					
SIZE OF HOLE	SIZE OF CASING	WEIGHT PER FOOT	SETTING DEPTH	SACKS OF CEMENT	EST. TOP
6 1/8"	4-3/4"	16#	800'	Suff. to circulate	

This well will be drilled to top of field producing sand (Hospah) and will be cored and logged. If production is indicated, casing will be run and the well completed. Top of sand expected at about 750'.

APPROVAL VALID  
FOR 90 DAYS UNLESS  
DRILLING COMMENCED,

EXPIRES 11/29/76

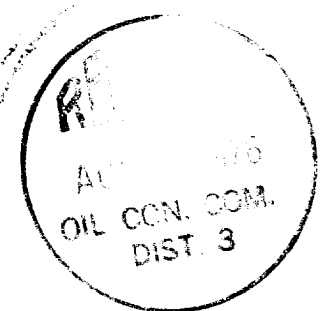

IN ABOVE SPACE DESCRIBE PROPOSED PROGRAM: IF PROPOSAL IS TO DEEPEN OR PLUG BACK, GIVE DATA ON PRESENT PRODUCTIVE ZONE AND PROPOSED NEW PRODUCTIVE ZONE. GIVE BLOWOUT PREVENTER PROGRAM, IF ANY.

I hereby certify that the information above is true and complete to the best of my knowledge and belief.

Signed Lloyd Davidson Title President Date 8-27-76  
(This space for State Use)

APPROVED BY AR Kendrick TITLE Commissioner DATE 406 30 1976  
CONDITIONS OF APPROVAL, IF ANY:

**NEW MEXICO OIL CONSERVATION COMMISSION  
WELL LOCATION AND ACREAGE DEDICATION PLAT**

Form C-102  
Supersedes C-128  
Effective 1-1-65

All distances must be from the outer boundaries of the Section

Owner <b>Northern Minerals, Inc.</b>			Lease <b>Santa Fe Pacific Railroad</b>		Well No. <b>#21</b>
Section <b>29</b>	Township <b>16 North</b>	Range <b>6 West</b>	County <b>McKinley</b>		
Actual Well Location (Well):					
<b>1750</b>	feet from the <b>North</b> line and	<b>990</b>	feet from the <b>East</b> line		
Actual Elevation <b>6440</b>	Producing Formation <b>Upper Gallup (Hospah)</b>	Pool <b>Miguel Creek-Gallup</b>	Dedicated Acreage <b>38.34</b> Acres		

1. Outline the acreage dedicated to the subject well by colored pencil or hachure marks on the plat below.
2. If more than one lease is dedicated to the well, outline each and identify the ownership thereof (both as to working interest and royalty).
3. If more than one lease of different ownership is dedicated to the well, have the interests of all owners been consolidated by communization, unitization, force-pooling, etc?

☒ Yes    ☐ No    If answer is "yes," type of consolidation 30

If answer is "no," list the owners and tract descriptions which have actually been consolidated: (Use reverse side of this form if necessary.)

No allowable will be assigned to the well until all interests have been consolidated (by communization, unitization, forced-pooling, or otherwise) or until a non-standard unit, eliminating such interests, has been approved by the Commission.

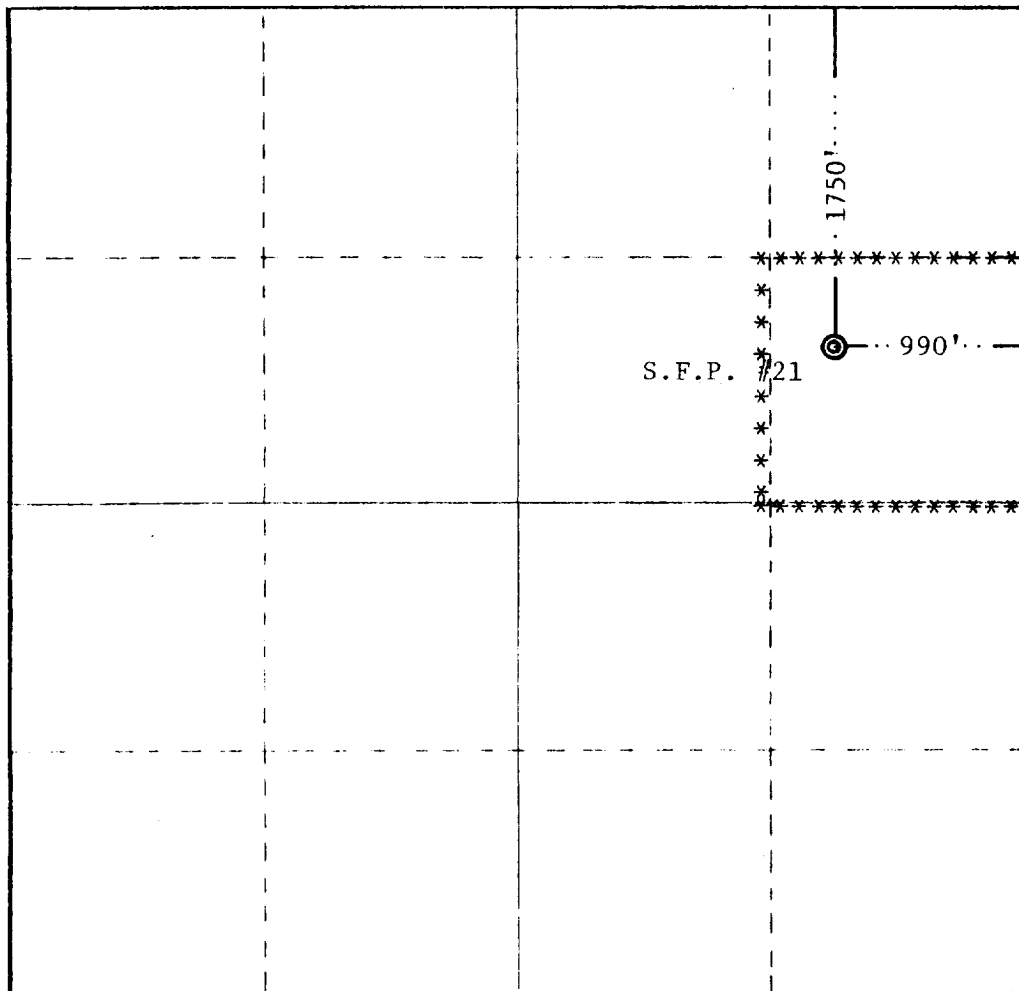

**CERTIFICATION**

I hereby certify that the information contained herein is true and complete to the best of my knowledge and belief.

*Lloyd Davidson*  
Name  
**Lloyd Davidson**  
Position  
**President**  
Company  
**Northern Minerals, Inc.**  
Date  
**8-27-76**

I hereby certify that the well location shown on this plat was plotted from field notes of actual surveys made by me or under my supervision, and that the same is true and correct to the best of my knowledge and belief.

Date Surveyed  
**August 26, 1976**

Registered Professional Engineer  
and/or Land Surveyor

*Ed. J. Harmon*

Certificate No.  
**2031**

