

NEW MEXICO OIL CONSERVATION COMMISSION

WELL LOCATION AND ACERAGE DEDICATION PLAT

All distances must be from the outer boundaries of the Section

| | | | | | |
|---|----------------------|-----------------------------|------------------------------|---------------------------|----------------------|
| Operator BASIN FUELS, INCORPORATED | | | Lease EASTER FLATS | | Well No. 2 |
| Unit Letter N | Section 12 | Township 20 NORTH | Range 6 WEST | County McKINLEY | |
| Actual Footage Location of Well: <div style="display: flex; justify-content: space-between;"> 900 feet from the SOUTH line and 1850 feet from the WEST line </div> | | | | | |
| Ground Level Elev. 6745 | Producing Formation | Pool | Dedicated Acreage: | | Acres |

Outline the acreage dedicated to the subject well by colored pencil or hachure marks on the plat below.

2. If more than one lease is dedicated to the well, outline each and identify the ownership thereof (both as to working interest and royalty),

3. If more than one lease of different ownership is dedicated to the well, have the interests of all owners been consolidated by communitization, unitization, force-pooling, etc?

() Yes () No If answer is "yes," type of consolidation

If answer is "no," list the owners and tract descriptions which have actually consolidated. (Use reverse side of this form if necessary.)

No allowable will be assigned to the well until all interests have been consolidated (by communitization, unitization, forced-pooling, or otherwise) or until a non standard unit, eliminating such interests, has been approved by the Commission.

CORRECTED COPY *Ref*

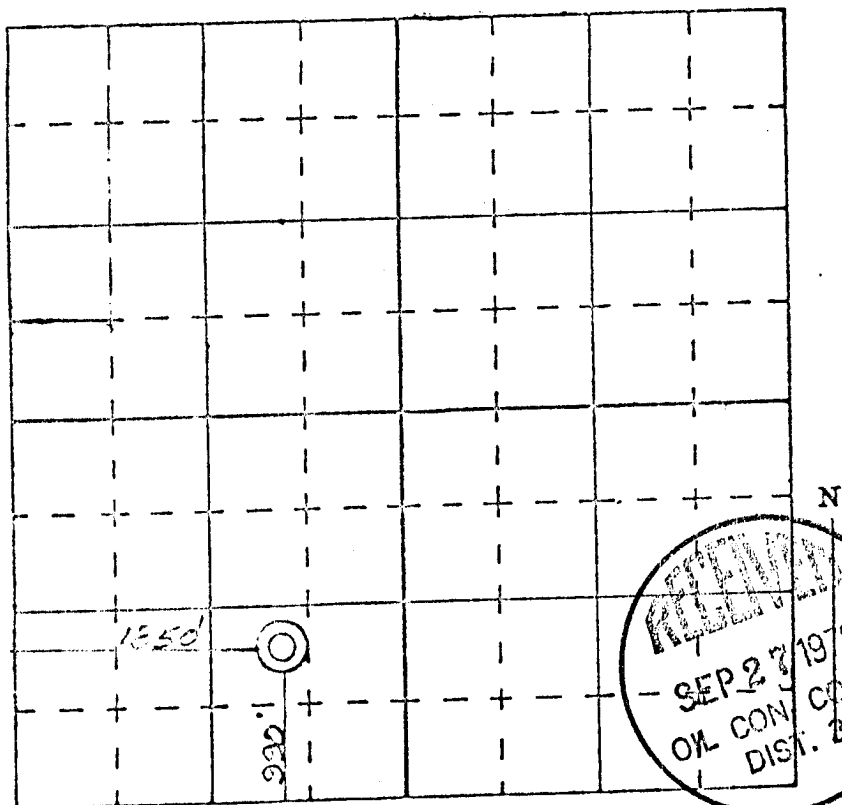

CERTIFICATION

I hereby certify that the information contained herein is true and complete to the best of my knowledge and belief.

Name _____

Position _____

Company _____

Date _____

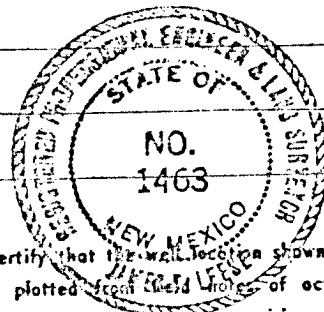

I hereby certify that the well location shown on this plat was plotted from field notes of actual surveys made by me or under my supervision, and that the same is true and correct to the best of my knowledge and belief.

23 October, 1976
Date Surveyed

James P. Leese
Registered Professional Engineer
and/or Land Surveyor

James P. Leese

1463

Certificate No.