

UNITED STATES
DEPARTMENT OF THE INTERIOR
GEOLOGICAL SURVEY

APPLICATION FOR PERMIT TO DRILL, DEEPEN, OR PLUG BACK

1a. TYPE OF WORK

DRILL ☒DEEPEN ☐PLUG BACK ☐

b. TYPE OF WELL

OIL
WELL ☒GAS
WELL ☐

OTHER

SINGLE
ZONE ☒MULTIPLE
ZONE ☐

2. NAME OF OPERATOR

Dome Petroleum Corporation

3. ADDRESS OF OPERATOR c/o Minerals Management Inc.

501 Airport Dr., Suite 105, Farmington, N.M. 87401

4. LOCATION OF WELL (Report location clearly and in accordance with any State requirements.*)

At surface

2310' FSL, 2000' FWL, SEC. 15, T19N, R5W

At proposed prod. zone

14. DISTANCE IN MILES AND DIRECTION FROM NEAREST TOWN OR POST OFFICE*

38 miles Southwest 44 Trading Post

15. DISTANCE FROM PROPOSED*

LOCATION TO NEAREST

PROPERTY OR LEASE LINE, FT.

(Also to nearest drlg. unit line, if any)

330'

18. DISTANCE FROM PROPOSED LOCATION*

TO NEAREST WELL, DRILLING, COMPLETED,
OR APPLIED FOR, ON THIS LEASE, FT.

-

16. NO. OF ACRES IN LEASE

160

19. PROPOSED DEPTH

5400'

17. NO. OF ACRES ASSIGNED
TO THIS WELL

40

20. ROTARY OR CABLE TOOLS

Rotary

21. ELEVATIONS (Show whether DF, RT, GR, etc.)

6559' GR

22. APPROX. DATE WORK WILL START*

March 1, 1977

23.

PROPOSED CASING AND CEMENTING PROGRAM

SIZE OF HOLE	SIZE OF CASING	WEIGHT PER FOOT	SETTING DEPTH	QUANTITY OF CEMENT
15"	10 3/4" new	32.75#	200'	200 sx
8 3/4"	7" new	23.00#	5400'	300-500 sx (2 stage)

Dome Petroleum Corporation (Operator) proposes to drill a Jurassic test to 5400'. Completion will be determined from logs. A Series 900 (3000 psi) WP Blowout Preventer will be used. The BOP will be pressure tested before drilling surface plug. The Geologic name of surface formation is Mesaverde. Pertinent formation tops are estimated as Point Lookout 1965', Gallup 2900', Graneros 3975', Dakota 4110', Entrada 5130'. Drill Stem Tests will be taken where necessary for evaluation. No abnormal pressures and temperatures are anticipated. Drilling should require approximately 15 days.

CONFIDENTIAL 1977

IN ABOVE SPACE DESCRIBE PROPOSED PROGRAM: If proposal is to deepen or plug back, give data on present productive zone and proposed new productive zone. If proposal is to drill or deepen directionally, give pertinent data on subsurface locations and measured and true vertical depths. Give blowout preventer program, if any.

24.

SIGNED

Area Manager

TITLE Minerals Management Inc. DATE 1-31-77

(This space for Federal or State office use)

PERMIT NO.

APPROVAL DATE

APPROVED BY

TITLE

DATE

CONDITIONS OF APPROVAL, IF ANY:

OK

**NEW MEXICO OIL CONSERVATION COMMISSION
WELL LOCATION AND ACREAGE DEDICATION PLAT**

Form C-102
Supersedes C-128
Effective 1-1-65

All distances must be from the outer boundaries of the Section.

Operator Dome Petroleum Corporation			Lease Navajo Allotted 15		Well No. 3
Unit Letter K	Section 15	Township 19N	Range 5W	County McKinley	
Actual Footage Location of Well:					
2310 feet from the South line and		2000 feet from the West line			
Ground Level Elev. 6559	Producing Formation Entrada	Pool Undesignated		Dedicated Acreage: 40 ✓	Acres

1. Outline the acreage dedicated to the subject well by colored pencil or hachure marks on the plat below.
2. If more than one lease is dedicated to the well, outline each and identify the ownership thereof (both as to working interest and royalty).
3. If more than one lease of different ownership is dedicated to the well, have the interests of all owners been consolidated by communitization, unitization, force-pooling, etc?

☐ Yes ☐ No If answer is "yes," type of consolidation _____

If answer is "no," list the owners and tract descriptions which have actually been consolidated. (Use reverse side of this form if necessary.) _____

No allowable will be assigned to the well until all interests have been consolidated (by communitization, unitization, forced-pooling, or otherwise) or until a non-standard unit, eliminating such interests, has been approved by the Commission.

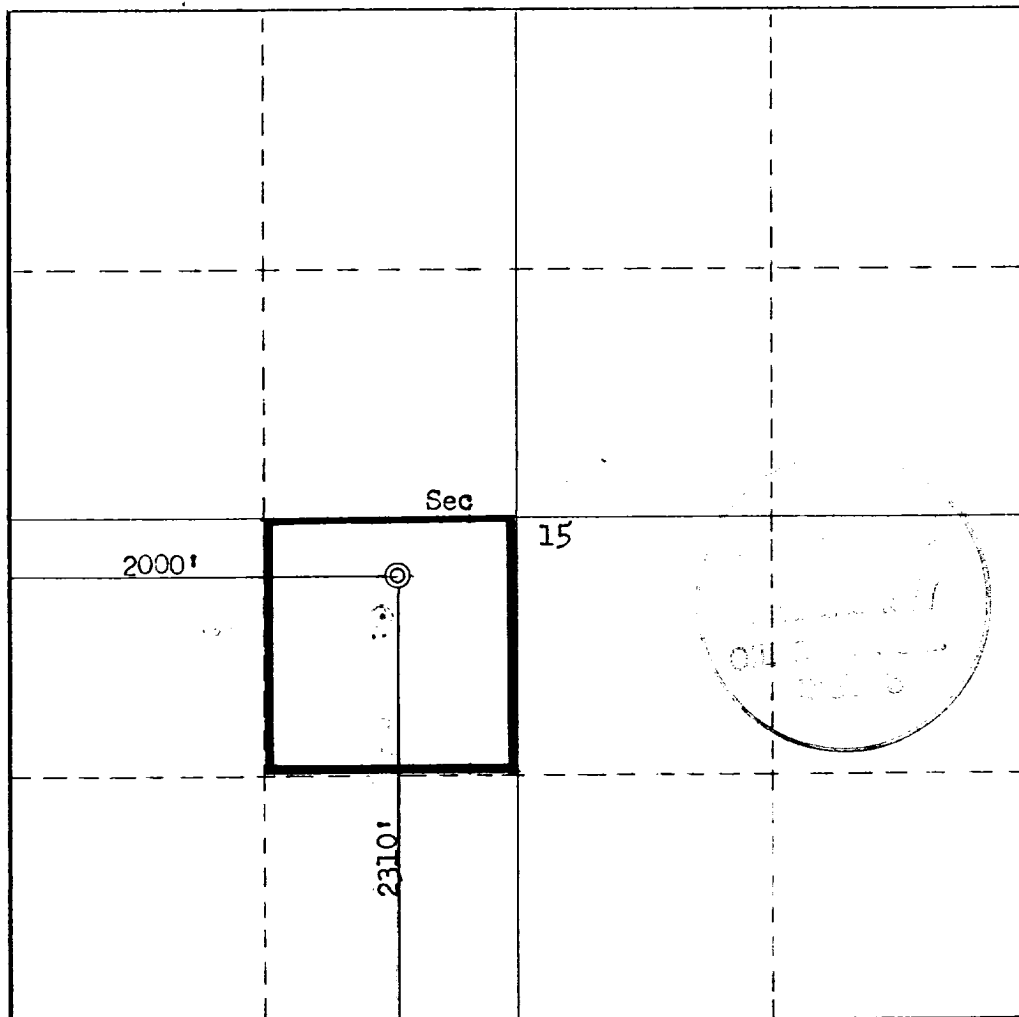

CERTIFICATION

I hereby certify that the information contained herein is true and complete to the best of my knowledge and belief.

Name: T. Arnold Smith
 Position: Area Manager
 Company: Minerals Management Inc.
 Date: 1-31-77

I hereby certify that the well location shown on this plat was plotted from field notes of actual surveys made by me or under my supervision, and that the same is true and correct to the best of my knowledge and belief.

Date Surveyed: January 19, 1977
 Registered Professional Engineer and/or Land Surveyor:
Fred B. Kerr Jr.
 Certificate No. 3950

