

NO. OF COPIES RECEIVED	5
DISTRIBUTION	
SANTA FE	1
FILE	1
U.S.G.S.	2
LAND OFFICE	
OPERATOR	1

NEW MEXICO OIL CONSERVATION COMMISSION

30-031-20512
Form C-101
Revised 1-1-65

5A. Indicate Type of Lease	
STATE <input type="checkbox"/>	FEE <input checked="" type="checkbox"/>
5. State Oil & Gas Lease No.	
7. Unit Agreement Name	
8. Farm or Lease Name Santa Fe	
9. Well No. 1	
10. Field and Pool, or Wildcat Marcelina/Dakota	
12. County McKinley	
19. Proposed Depth 1850'	19A. Formation Dakota
20. Rotary or C.T. Rotary	
21. Elevations (Show whether D.F., R.I., etc.) 7155 GR	21A. Kind & Status Plug. Bond State Blanket
21B. Drilling Contractor Ken Harlan	
22. Approx. Date Work will start Upon Approval	

1a. Type of Work	
b. Type of Well DRILL <input checked="" type="checkbox"/> DEEPEN <input type="checkbox"/> PLUG BACK <input type="checkbox"/> OIL WELL <input checked="" type="checkbox"/> GAS WELL <input type="checkbox"/> OTHER <input type="checkbox"/> SINGLE ZONE <input checked="" type="checkbox"/> MULTIPLE ZONE <input type="checkbox"/>	
2. Name of Operator William G. Gill	
3. Address of Operator 430 Wilson Building, Corpus Christi, TX 78401	
4. Location of Well UNIT LETTER A LOCATED 330 FEET FROM THE N LINE AND 330 FEET FROM THE E LINE OF SEC. 23 TWP. 16N RGE. 10W NMPM	
23. PROPOSED CASING AND CEMENT PROGRAM	
SIZE OF HOLE	SIZE OF CASING
12 1/2"	9 5/8"
7 7/8"	5 1/2"
WEIGHT PER FOOT	SETTING DEPTH
36 lb.	100'
14 lb.	1800'
SACKS OF CEMENT	EST. TOP
Suff.	Surface
Suff.	Surface

This will be an 1850' Dakota "A" sand development well. Cores will be taken of Hospah and Dakota sands. Logs to be run are IES and GRN. If commercial oil or gas production is indicated, casing will be run and the well treated as necessary to establish production.

B.O.P. program will be 10" Shaffer, 3000 lb. WP, Hydraulic or better

IN ABOVE SPACE DESCRIBE PROPOSED PROGRAM; IF PROPOSAL IS TO DEEPEN OR PLUG BACK, GIVE DATA ON PRESENT PRODUCTIVE ZONE AND PROPOSED NEW PRODUCTIVE ZONE, GIVE BLOWOUT PREVENTER PROGRAM, IF ANY.

I hereby certify that the information above is true and complete to the best of my knowledge and belief.

Signed W. G. Gill Title Geologist Date 6/15/77

(This space for State Use)

APPROVED BY AK Kendrick TITLE SUPERVISOR DIST. #3 DATE 6/15/77

CONDITIONS OF APPROVAL, IF ANY:

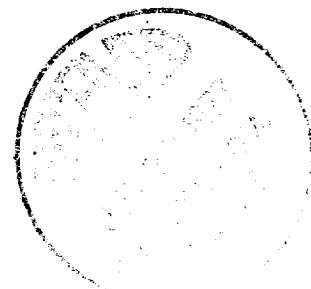

**NEW MEXICO OIL CONSERVATION COMMISSION
WELL LOCATION AND ACREAGE DEDICATION PLAT**

Form C-102
Supersedes C-128
Effective 1-1-65

All distances must be from the outer boundaries of the Section.

Operator William G. Gill			Lease Santa Fe		Well No. 1
Unit Letter A	Section 23	Township 16 North	Range 10 West	County McKinley	
Actual Footage Location of Well: 330 feet from the North line and 330 feet from the East line					
Ground Level Elev. 7155	Producing Formation Dakota "A"		Pool Unnamed Dakota		Dedicated Acreage: 40 Acres

1. Outline the acreage dedicated to the subject well by colored pencil or hachure marks on the plat below.
2. If more than one lease is dedicated to the well, outline each and identify the ownership thereof (both as to working interest and royalty).
3. If more than one lease of different ownership is dedicated to the well, have the interests of all owners been consolidated by communitization, unitization, force-pooling, etc?

☐ Yes ☐ No If answer is "yes," type of consolidation _____

If answer is "no," list the owners and tract descriptions which have actually been consolidated. (Use reverse side of this form if necessary.) _____

No allowable will be assigned to the well until all interests have been consolidated (by communitization, unitization, forced-pooling, or otherwise) or until a non-standard unit, eliminating such interests, has been approved by the Commission.

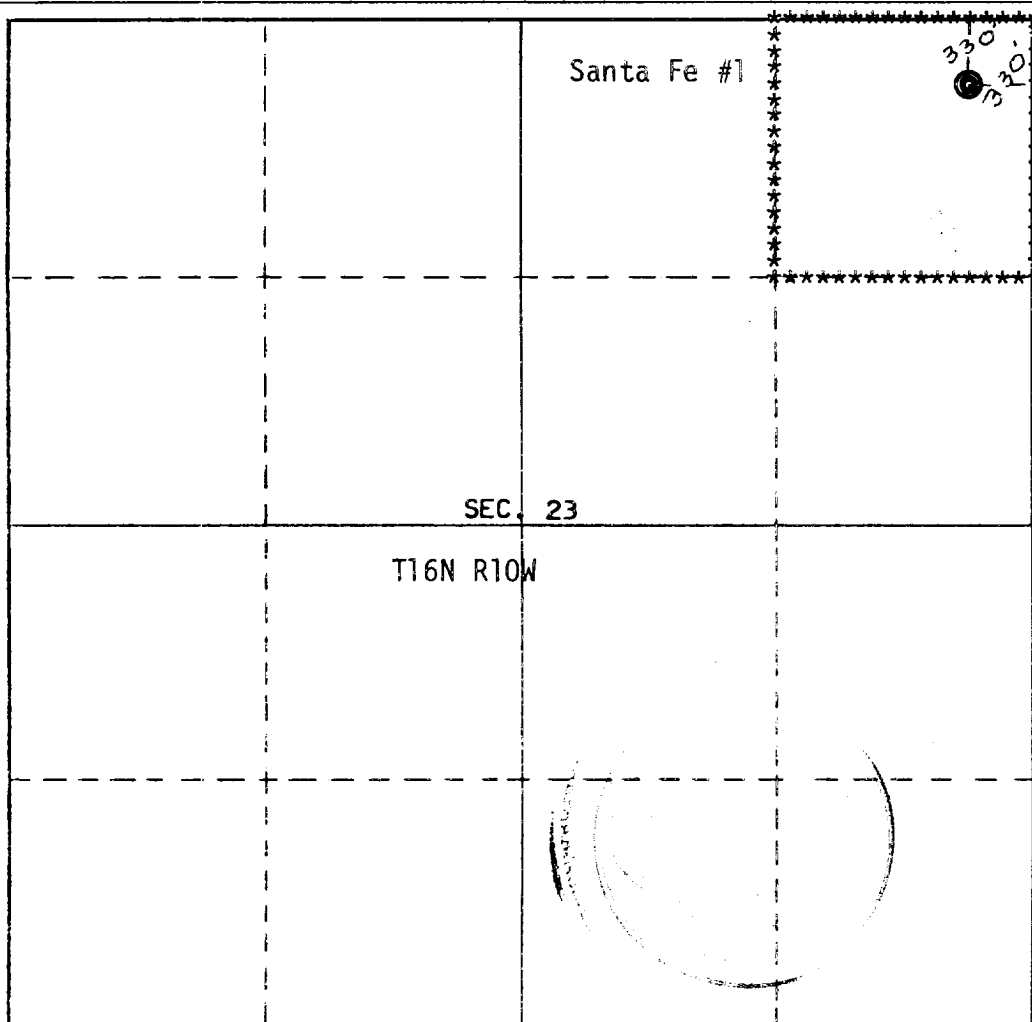

CERTIFICATION

I hereby certify that the information contained herein is true and complete to the best of my knowledge and belief.

William G. Gill, Jr.

Name
Hugh Gill, Jr.

Position
Geologist

Company
William G. Gill

Date
6-15-77

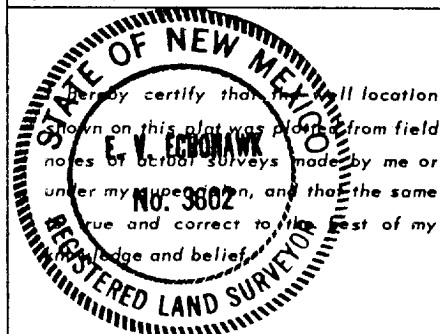

Date Surveyed
June 4, 1977

Registered Professional Engineer
and/or Land Surveyor

E. V. Echohawk

Certificate No. **3602**
E.V. Echohawk LS

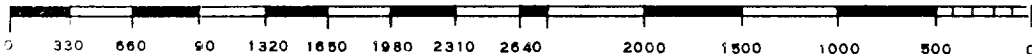

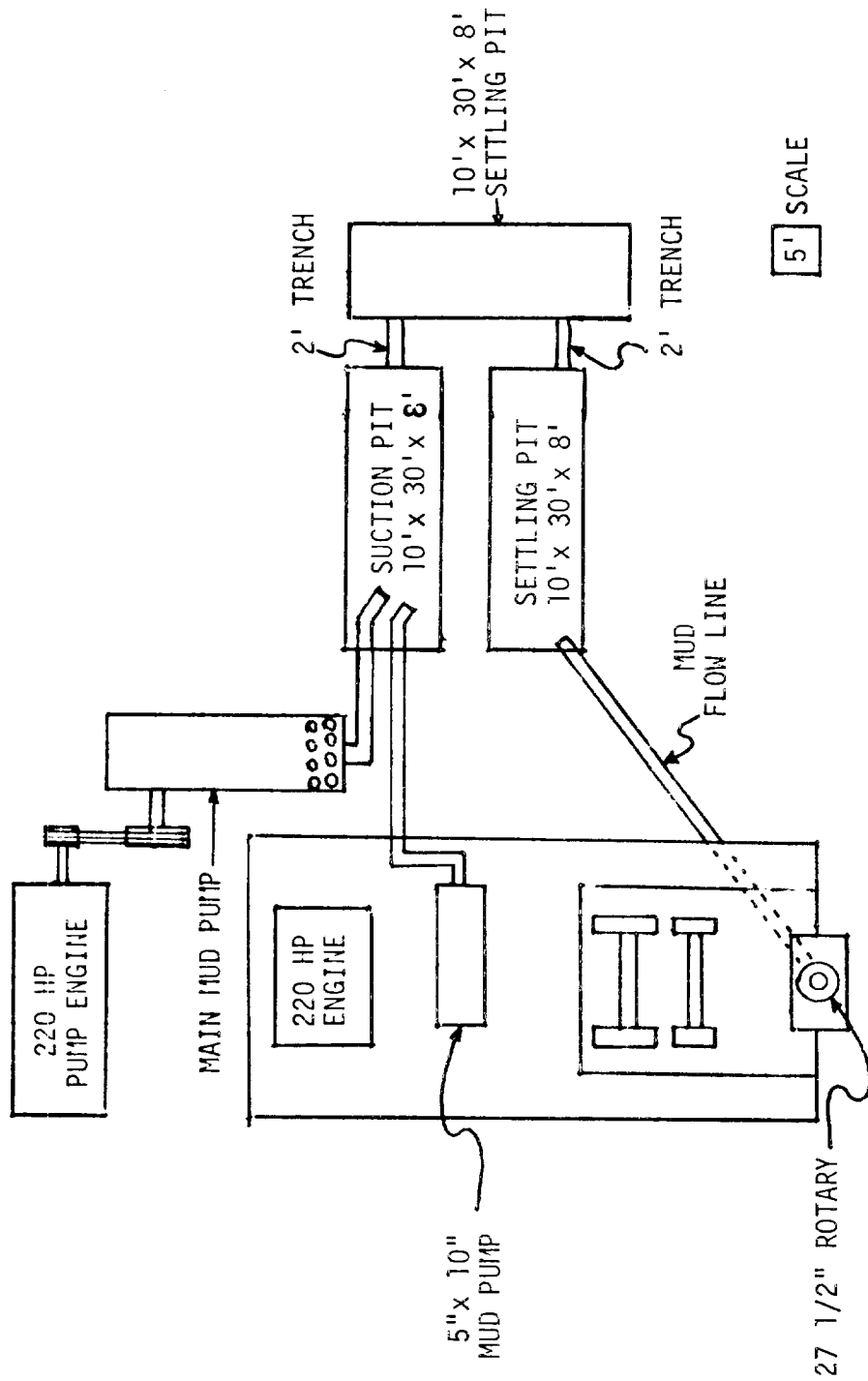

MOBILE MOUNTED RIG
WITH COOPER DOUBLE DRUM DRAWWORKS
AND 59' TELESCOPING MAST
2 7/8" DRILLPIPE, 20' JOINTS