

NO. OF COPIES RECEIVED	5
DISTRIBUTION	
SANTA FE	1
FILE	1
U.S.G.S.	2
LAND OFFICE	
OPERATOR	1

NEW MEXICO OIL CONSERVATION COMMISSION

30-031-20518
Form C-101
Revised 1-1-65

5A. Indicate Type of Lease	
STATE <input type="checkbox"/>	FEE <input checked="" type="checkbox"/>

5. State Oil & Gas Lease No.

APPLICATION FOR PERMIT TO DRILL, DEEPEN, OR PLUG BACK

1a. Type of Work		7. Unit Agreement Name	
b. Type of Well OIL WELL <input type="checkbox"/> GAS WELL <input type="checkbox"/> OTHER <input type="checkbox"/>		8. Farm or Lease Name Santa Fe Pacific	
2. Name of Operator Northern Minerals, Inc.		9. Well No. 23	
3. Address of Operator Box 2182, Santa Fe, New Mexico 87501		10. Field and Pool, or Wildcat Miguel Cr. Gallup E & T	
4. Location of Well UNIT LETTER G LOCATED 2310 FEET FROM THE North LINE AND 1650 FEET FROM THE East LINE OF SEC. 20 TWP. 16N RGE. 6W NMPM		12. County McKinley	
19. Proposed Depth 1200'		19A. Formation Hospah-Gallup	
20. Rotary or C.T. Rotary		21. Elevations (Show whether DF, RT, etc.) 6790 GR	
21A. Kind & Status Plug. Bond State Wide		21B. Drilling Contractor Own	
22. Approx. Date Work will start 8/1/77			

23.

PROPOSED CASING AND CEMENT PROGRAM

SIZE OF HOLE	SIZE OF CASING	WEIGHT PER FOOT	SETTING DEPTH	SACKS OF CEMENT	EST. TOP Surface
6 1/2	4 1/2	10.50 #	1190	100	

We will drill a 6 1/2" hole to approximately 1170'. We will core the Hospah-Gallup sand. If commercial thickness of oil sand is present, we will run 4 1/2" casing and attempt to complete as an oil well.

APPROVAL VALID
FOR 90 DAYS UNLESS
DRILLING COMMENCED,

EXPIRES 10-31-77

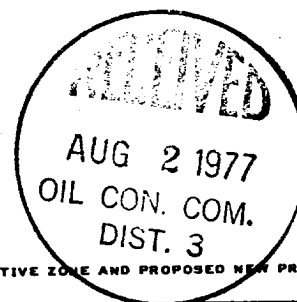

IN ABOVE SPACE DESCRIBE PROPOSED PROGRAM; IF PROPOSAL IS TO DEEPEN OR PLUG BACK, GIVE DATA ON PRESENT PRODUCTIVE ZONE AND PROPOSED NEW PRODUCTIVE ZONE. GIVE BLOWOUT PREVENTER PROGRAM, IF ANY.

I hereby certify that the information above is true and complete to the best of my knowledge and belief.

Signed Mark E. Wendley Title Consulting Geologist Date 7/28/77

(This space for State Use)

APPROVED BY Al Deudrick TITLE SUPERVISOR DIST. 3 DATE 8/1/77
CONDITIONS OF APPROVAL, IF ANY:

NEW MEXICO OIL CONSERVATION COMMISSION
WELL LOCATION AND ACREAGE DEDICATION PLAT

Form C-102
Supersedes C-128
Effective 1-1-65

All distances must be from the outer boundaries of the Section.

Operator Northern Minerals, Inc.			Lease Santa Fe Pacific		Well No. S.F.P.R.R No.23
Unit Letter G	Section 20	Township 16 N	Range 6 W	County McKinley	
Actual Footage Location of Well: 2310 feet from the North line and 1650 feet from the East line					
Ground Level Elev: 6790.5	Producing Formation Hospah-Gallup		Pool Miguel Creek Gallup		Dedicated Acreage: 40 Acres

1. Outline the acreage dedicated to the subject well by colored pencil or hachure marks on the plat below.
2. If more than one lease is dedicated to the well, outline each and identify the ownership thereof (both as to working interest and royalty).
3. If more than one lease of different ownership is dedicated to the well, have the interests of all owners been consolidated by communitization, unitization, force-pooling, etc?

☐ Yes ☐ No If answer is "yes," type of consolidation _____

If answer is "no," list the owners and tract descriptions which have actually been consolidated. (Use reverse side of this form if necessary.) _____

No allowable will be assigned to the well until all interests have been consolidated (by communitization, unitization, forced-pooling, or otherwise) or until a non-standard unit, eliminating such interests, has been approved by the Commission.

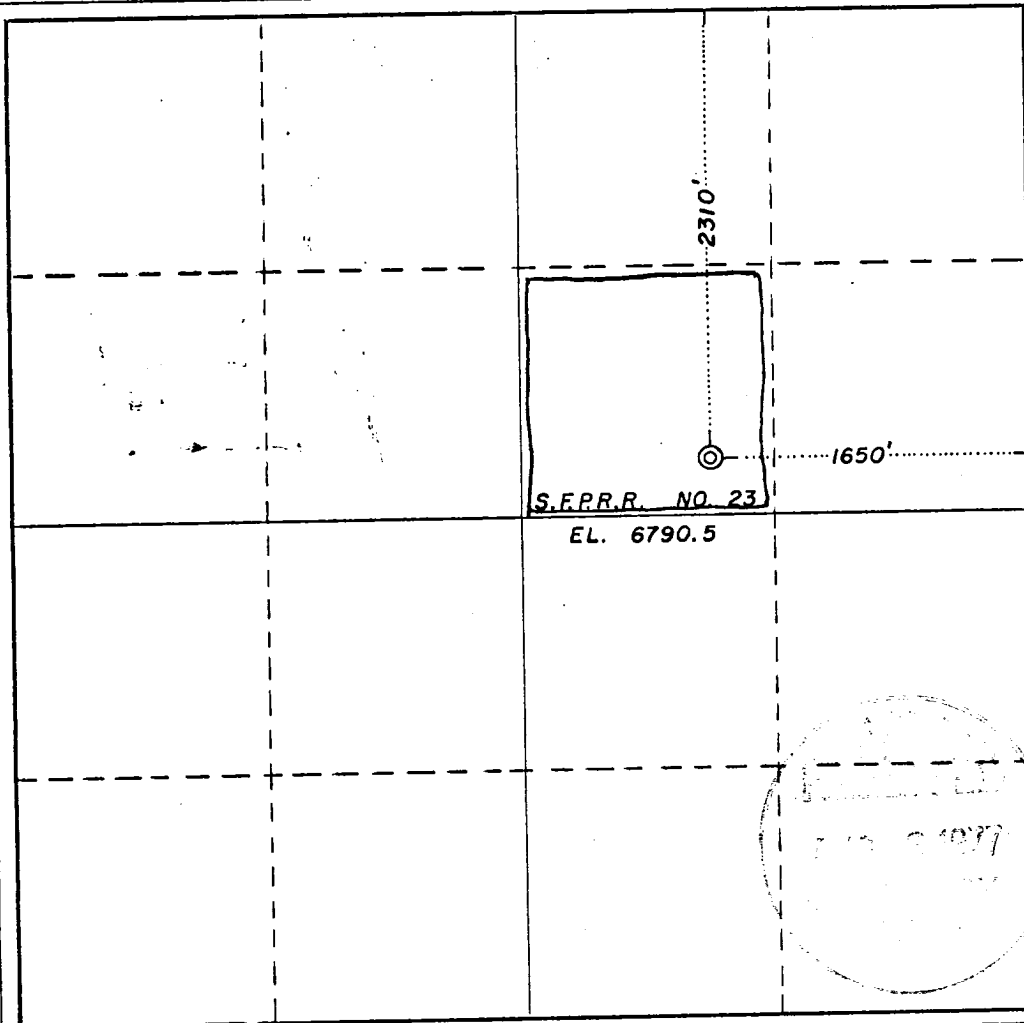

CERTIFICATION

I hereby certify that the information contained herein is true and complete to the best of my knowledge and belief.

Mark E. Weidner
Name

Consulting Geologist

Position

Northern Minerals, Inc.

Company

7/28/77

Date

I hereby certify that the well location shown on this plat was plotted from field notes of actual surveys made by me or under my supervision, and that the same is true and correct to the best of my knowledge and belief.

Date Surveyed

July 19, 1977

Registered Professional Engineer and/or Land Surveyor

Frederic J. Morrison

Certificate No.

2031