

NO. OF COPIES RECEIVED	6
DISTRIBUTION	
SANTA FE	1
FILE	2
U.S.G.S.	1
LAND OFFICE	1
OPERATOR	1

NEW MEXICO OIL CONSERVATION COMMISSION

30-031-20522
Form C-101
Revised 1-1-65

5A. Indicate Type of Lease
STATE ☒ FEE ☐

5. State Oil & Gas Lease No.

7. Unit Agreement Name

8. Farm or Lease Name

State 2-16-19-5

9. Well No.

2

10. Field and Pool, or Wildcat ☒

Papers Wash Entrada

12. County

McKinley

APPLICATION FOR PERMIT TO DRILL, DEEPEN, OR PLUG BACK

1a. Type of Work

DRILL ☒

DEEPEN ☐

PLUG BACK ☐

b. Type of Well

OIL WELL ☒

GAS WELL ☐

OTHER

SINGLE ZONE ☐

MULTIPLE ZONE ☐

c. Name of Operator

Dome Petroleum Corporation

Address of Operator Minerals Management Inc., Suite 105,

601 Airport Drive, Farmington, New Mexico 87401

d. Location of Well

UNIT LETTER H LOCATED 2310 FEET FROM THE North LINE

330 FEET FROM THE East LINE OF SEC. 16 TWP. 19N RGE. 5W NMPM

19. Proposed Depth

5400

19A. Formation

Entrada

20. Rotary or C.T.

Rotary

e. Conditions (Show whether DF, RT, etc.)

6578' GR

21A. Kind & Status Plug. Bond

Statewide

21B. Drilling Contractor

Four Corners Drilling

22. Approx. Date Work will start

September 15, 1977

PROPOSED CASING AND CEMENT PROGRAM

SIZE OF HOLE	SIZE OF CASING	WEIGHT PER FOOT	SETTING DEPTH	SACKS OF CEMENT	EST. TOP
3 1/4	9 5/8	36	200	200	Surface
8 3/4	7	20&23	5400	900	Surface

Dome Petroleum Corporation (Operator) proposes to drill a Jurassic test to 5400'. Completion will be determined from Logs. A Series 900 (3000 psi) WP Blowout Preventer will be used. The BOP will be tested before drilling surface plug. The geologic name of the surface formations is Mesa Verde. Pertinent formation tops are estimated as Point Lookout 1965', Gallup 2900', Graneros 3975', Dakota 4110', Entrada 5135'. Drill stem test will be taken where necessary for evaluation. No abnormal pressures or temperatures are anticipated. Drilling should require approximately 15 days.

CONFIDENTIAL

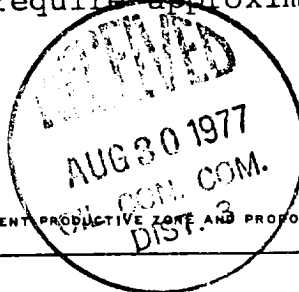

IN ABOVE SPACE DESCRIBE PROPOSED PROGRAM; IF PROPOSAL IS TO DEEPEN OR PLUG BACK, GIVE DATA ON PRESENT PRODUCTIVE ZONE AND PROPOSED NEW PRODUCTIVE ZONE. GIVE BLOWOUT PREVENTER PROGRAM, IF ANY.

I hereby certify that the information above is true and complete to the best of my knowledge and belief.

Signed [Signature] Title Area Manager Minerals Management Inc. Date 8-29-77

(This space for State Use)

APPROVAL, IF ANY:

NO. OF COPIES RECEIVED	6
DISTRIBUTION	
SANTA FE	1
FILE	1
U.S.G.S.	2
LAND OFFICE	1
OPERATOR	1

Form C-105
Revised 11-1-8

NEW MEXICO OIL CONSERVATION COMMISSION
WELL COMPLETION OR RECOMPLETION REPORT AND LOG

5a. Indicate Type of Lease State <input checked="" type="checkbox"/> Fee <input type="checkbox"/>
5. State Oil & Gas Lease No.

1a. TYPE OF WELL OIL WELL <input checked="" type="checkbox"/> GAS WELL <input type="checkbox"/> DRY <input type="checkbox"/> OTHER <input type="checkbox"/>
b. TYPE OF COMPLETION NEW WELL <input checked="" type="checkbox"/> WORK OVER <input type="checkbox"/> DEEPEN <input type="checkbox"/> PLUG BACK <input type="checkbox"/> DIFF. RESVR. <input type="checkbox"/> OTHER <input type="checkbox"/>

7. Unit Agreement Name
8. Farm or Lease Name State 2-16-19-5
9. Well No. 2
10. Field and Pool, or Wildcat Papers Wash-Entrada

2. Name of Operator
Dome Petroleum Corp.

3. Address of Operator & K&A, Inc. Minerals Management, 501 Airport Dr.
Suite 105, Farmington, New Mexico 87401

4. Location of Well
UNIT LETTER H LOCATED 2310 FEET FROM THE North LINE AND 330 FEET FROM

11. County McKinley

THE East LINE OF SEC. 16 TWP. 19N RGE. 5W NMFM

15. Date Spudded 10-3-77	16. Date T.D. Reached 10-15-77	17. Date Compl. (Ready to Prod.) TA 6-19-78	18. Elevations (DF, RKB, RT, GR, etc.) 5690 KB	19. Elev. Casinghead 5678 GR
20. Total Depth 5383'	21. Plug Back T.D. 5325'	22. If Multiple Compl., How Many --	23. Intervals Drilled By Rotary Tools 0-5383'	Cable Tools 0

24. Producing Interval(s), of this completion - Top, Bottom, Name
Entrada

25. Was Directional Survey Made
No

26. Type Electric and Other Logs Run
Dual Induction Laterolog, CNL-Density

27. Was Well Cored
Yes

28. CASING RECORD (Report all strings set in well)					
CASING SIZE	WEIGHT LB./FT.	DEPTH SET	HOLE SIZE	CEMENTING RECORD	AMOUNT PULLED
9 5/8	36	205	13 1/4	200 sx.	--
7	20 & 23	5373	8 3/4	485 & 420 (2 Stage)	--

29. LINER RECORD					30. TUBING RECORD		
SIZE	TOP	BOTTOM	SACKS CEMENT	SCREEN	SIZE	DEPTH SET	PACKER SET
					2 7/8	4500	--

31. Perforation Record (Interval, size and number) 5161-63, 5170-72, 5179-85, with 2 jet per foot. 5179-81 with 4 jets per foot.	32. ACID, SHOT, FRACTURE, CEMENT SQUEEZE, ETC.	
	DEPTH INTERVAL	AMOUNT AND KIND MATERIAL USED
	5161-63, 5170-72, & 5179-85	Cement w/75 sx. LFL Cx.
	5179-81	Acid w/200 gal. & w/1000 gal. 15% HCL

33. PRODUCTION							
Date First Production 3-15-78		Production Method (Flowing, gas lift, pumping - Size and type pump) Pumping				Well Status (Prod. or Shut-in) TA 6-19-78	
Date of Test 6-18-78	Hours Tested 24	Choke Size --	Prod'n. For Test Period --	Oil - Bbl. 0	Gas - MCF TSTM	Water - Bbl. 42	Gas - Oil Ratio --
Flow Tubing Press. --	Casing Pressure 0	Calculated 24-Hour Rate --	Oil - Bbl. 0	Gas - MCF TSTM	Water - Bbl. 42	Oil Gravity - API (Corr.) --	

34. Disposition of Gas (Sold, used for fuel, vented, etc.)

Test Witnessed By
Rusty Vigil

35. List of Attachments

36. I hereby certify that the information shown on both sides of this form is true and complete to the best of my knowledge and belief.

SIGNED [Signature] TITLE K&A, Inc. Minerals Management Area Manager DATE 6-21-78

11-1-8 Mrs. Donnell 11-1-8

INSTRUCTIONS

This form is to be filed with the appropriate District Office of the Commission not later than 30 days after the completion of any newly-drilled or deepened well. It shall be accompanied by one copy of all electrical and radio-activity logs run on the well and a summary of all special tests conducted, including drill stem tests. All depths reported shall be measured depths. In the case of directionally drilled wells, true vertical depths shall also be reported. For multiple completions, Items 30 through 34 shall be reported for each zone. The form is to be filed in quintuplicate except on state land, where six copies are required. See Rule 1105.

INDICATE FORMATION TOPS IN CONFORMANCE WITH GEOGRAPHICAL SECTION OF STATE

Southeastern New Mexico

Northwestern New Mexico

T. Anhy _____	T. Canyon _____	T. Ojo Alamo _____	T. Penn. "B" _____
T. Salt _____	T. Strawn _____	T. Kirtland-Fruitland _____	T. Penn. "C" _____
B. Salt _____	T. Atoka _____	T. Pictured Cliffs _____	T. Penn. "D" _____
T. Yates _____	T. Miss _____	T. Cliff House _____	T. Leadville _____
T. 7 Rivers _____	T. Devonian _____	T. Menefee _____	T. Madison _____
T. Queen _____	T. Silurian _____	T. Point Lookout _____	T. Elbert _____
T. Grayburg _____	T. Montoya _____	T. Mancos _____	T. McCracken _____
T. San Andres _____	T. Simpson _____	T. Gallup _____	T. Ignacio Qtzte _____
T. Glorieta _____	T. McKee _____	Base Greenhorn _____	T. Granite _____
T. Paddock _____	T. Ellenburger _____	T. Dakota _____	T. _____
T. Blinberry _____	T. Gr. Wash _____	T. Morrison _____	T. _____
T. Tubb _____	T. Granite _____	T. Todilto _____	T. _____
T. Drinkard _____	T. Delaware Sand _____	T. Entrada _____	T. _____
T. Abo _____	T. Bone Springs _____	T. Wingate _____	T. _____
T. Wolfcamp _____	T. _____	T. Chinle _____	T. _____
T. Penn. _____	T. _____	T. Permian _____	T. _____
T. Cisco (Bough C) _____	T. _____	T. Penn. "A" _____	T. _____

OIL OR GAS SANDS OR ZONES

No. 1, from _____ to _____

No. 2, from _____ to _____

No. 3, from _____ to _____

No. 4, from _____ to _____

No. 5, from _____ to _____

No. 6, from _____ to _____

IMPORTANT WATER SANDS

Include data on rate of water inflow and elevation to which water rose in hole.

No. 1, from.....to.....feet.

No. 2, from.....to.....feet.

No. 3, from.....to.....feet.

No. 4, from.....to.....feet.

FORMATION RECORD (Attach additional sheets if necessary)

From	To	Thickness in Feet	Formation	From	To	Thickness in Feet	Formation

**NEW MEXICO OIL CONSERVATION COMMISSION
WELL LOCATION AND ACREAGE DEDICATION PLAT**

Form C-102
Supersedes C-128
Effective 1-1-65

All distances must be from the outer boundaries of the Section.

Operator Dome Petroleum Corporation			Lease State 2-16-19-5		Well No. 2
Unit Letter H	Section 16	Township 19N	Range 5W	County McKinley	
Actual Footage Location of Well: 2310 feet from the North line and 330 feet from the East line					
Ground Level Elev. 6578	Producing Formation Papers Wash		Pool Entrada	Dedicated Acreage: 40 Acres <input checked="" type="checkbox"/>	

1. Outline the acreage dedicated to the subject well by colored pencil or hachure marks on the plat below.
2. If more than one lease is dedicated to the well, outline each and identify the ownership thereof (both as to working interest and royalty).
3. If more than one lease of different ownership is dedicated to the well, have the interests of all owners been consolidated by communitization, unitization, force-pooling, etc?

☐ Yes ☐ No If answer is "yes," type of consolidation _____

If answer is "no," list the owners and tract descriptions which have actually been consolidated. (Use reverse side of this form if necessary.) _____

No allowable will be assigned to the well until all interests have been consolidated (by communitization, unitization, forced-pooling, or otherwise) or until a non-standard unit, eliminating such interests, has been approved by the Commission.

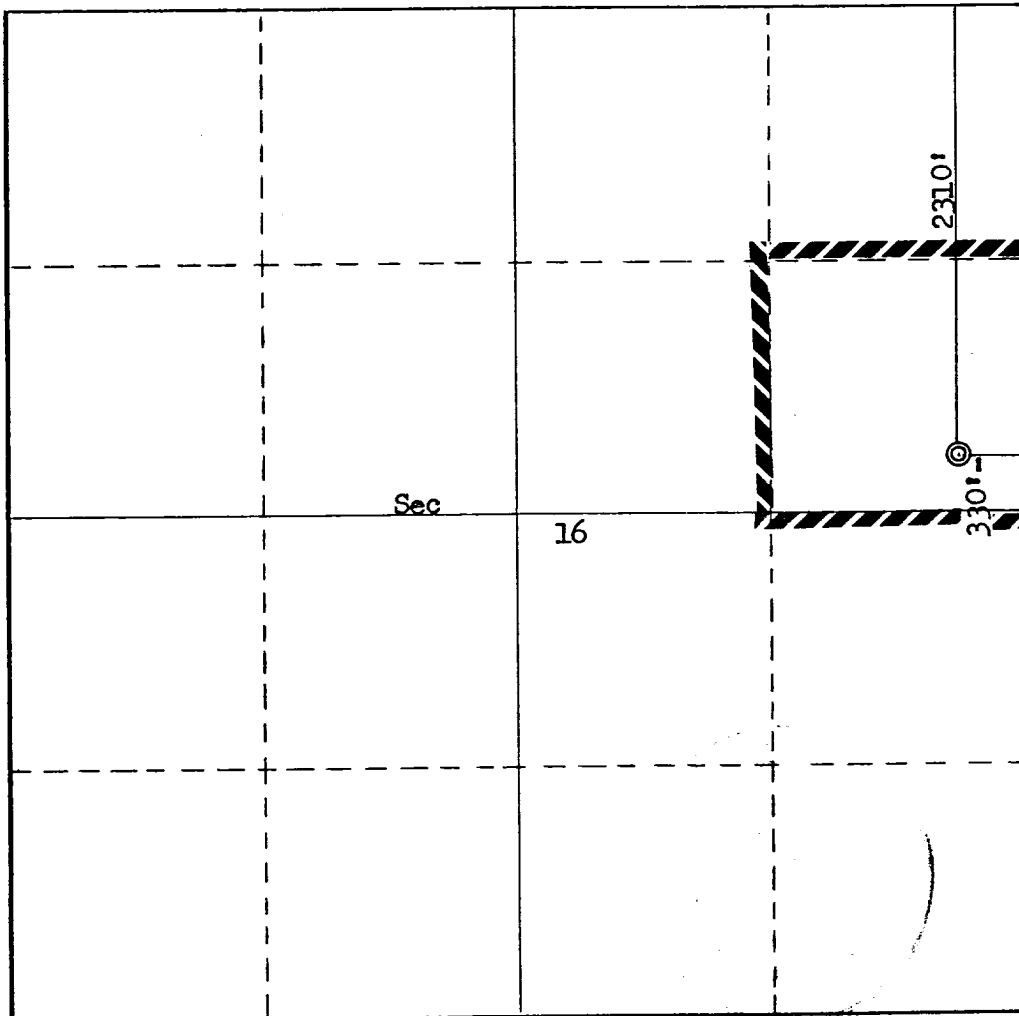

CERTIFICATION

I hereby certify that the information contained herein is true and complete to the best of my knowledge and belief.

Name
W. E. Landry
 Position
Area Manager
 Company
Minerals Management Inc.
 Date
August 29, 1977

I hereby certify that the well location shown on this plat was plotted from field notes of actual surveys made by me or under my supervision, and that the same is true and correct to the best of my knowledge and belief.

Date Surveyed
August 19, 1977
 Registered Professional Engineer and/or Land Surveyor

Fred B. Kerr Jr.
 Certificate No. **3950**



COPIES RECEIVED	3
DISTRIBUTION	
SANTA FE	1
FILE	1
U.S.G.S.	
LAND OFFICE	
OPERATOR	1

NEW MEXICO OIL CONSERVATION COMMISSION

Form C-103
Supersedes Old
C-102 and C-103
Effective 1-1-65

5a. Indicate Type of Lease
State <input checked="" type="checkbox"/> Fee <input type="checkbox"/>
5. State Oil & Gas Lease No.
30-031-20522

SUNDRY NOTICES AND REPORTS ON WELLS (DO NOT USE THIS FORM FOR PROPOSALS TO DRILL OR TO DEEPEN OR PLUG BACK TO A DIFFERENT RESERVOIR. USE "APPLICATION FOR PERMIT -" (FORM C-101) FOR SUCH PROPOSALS.)	
1. OIL WELL <input checked="" type="checkbox"/> GAS WELL <input type="checkbox"/> OTHER- <input type="checkbox"/>	7. Unit Agreement Name
2. Name of Operator Dome Petroleum Corporation	8. Farm or Lease Name State 2-16-19-5
3. Address of Operator Minerals Management Inc., Suite 105, 501 Airport Drive, Farmington, New Mexico 87401	9. Well No. 21
4. Location of Well UNIT LETTER H 2310 FEET FROM THE North LINE AND 330 FEET FROM East LINE, SECTION 16 TOWNSHIP 19N RANGE 5W NMPM.	10. Field and Pool, or Wildcat Papers Wash Entrada
15. Elevation (Show whether DF, RT, GR, etc.) 6578' GR, 6589' KB	12. County McKinley

16. Check Appropriate Box To Indicate Nature of Notice, Report or Other Data	
NOTICE OF INTENTION TO:	SUBSEQUENT REPORT OF:
PERFORM REMEDIAL WORK <input type="checkbox"/>	REMEDIAL WORK <input type="checkbox"/>
TEMPORARILY ABANDON <input type="checkbox"/>	COMMENCE DRILLING OPNS. <input checked="" type="checkbox"/>
PULL OR ALTER CASING <input type="checkbox"/>	CASING TEST AND CEMENT JOB <input checked="" type="checkbox"/>
OTHER <input type="checkbox"/>	OTHER <input type="checkbox"/>
PLUG AND ABANDON <input type="checkbox"/>	ALTERING CASING <input type="checkbox"/>
CHANGE PLANS <input type="checkbox"/>	PLUG AND ABANDONMENT <input type="checkbox"/>

17. Describe Proposed or Completed Operations (Clearly state all pertinent details, and give pertinent dates, including estimated date of starting any proposed work) SEE RULE 1103.

10-3-77 Spudded 13 1/4" hold at 10:00 p.m.

10-4-77 Ran 5 jts (191') 9 5/8", 36#, K-55, ST&C casing set at 205' KB with 200 sx Class "B" cement, 2% CaCl. Plug down at 8:00 a.m. Circulated cement. Tested casing 30 min. at 500 psi--OK.

CONFIDENTIAL

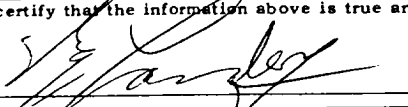
18. I hereby certify that the information above is true and complete to the best of my knowledge and belief.	
SIGNED 	TITLE Area Manager
Original Signed By A. B. Hendrick	Minerals Management Inc. DATE October 5, 1977
APPROVED BY	TITLE
CONDITIONS OF APPROVAL, IF ANY:	DATE 10 1977

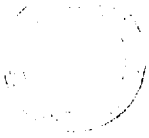

STATE OF NEW MEXICO
ENERGY AND MINERALS DEPARTMENT
OIL CONSERVATION DIVISION
AZTEC DISTRICT OFFICE

JERRY APODACA
GOVERNOR

NICK FRANKLIN
SECRETARY

1000 RIO BRAZOS ROAD
AZTEC, NEW MEXICO 87410
(505) 334-6178

June 19, 1978

Mr. W. E. Landry
Minerals Management, Inc.
501 Airport Drive, Suite 105
Farmington, New Mexico 87401

Re: Dome Petroleum Corporation
State 2-16-19-5 #2
H-16-19N-5W

Dear Bill:

Please cause form C-105 to be filed for the subject well.

Identify the well as Temporarily Abandoned. The status will
have begun on November 8, 1977.

If there are questions, please call.

Yours very truly,

A. R. Kendrick
District Supervisor

ARK:no

NO. OF COPIES RECEIVED	6
DISTRIBUTION	
SANTA FE	1
FILE	
U.S.G.S.	
LAND OFFICE	
OPERATOR	4

NEW MEXICO OIL CONSERVATION COMMISSION

Form C-103
Supersedes Old
C-102 and C-103
Effective 1-1-65

5a. Indicate Type of Lease	
State <input checked="" type="checkbox"/>	Fee <input type="checkbox"/>
5. State Oil & Gas Lease No.	

SUNDRY NOTICES AND REPORTS ON WELLS

(DO NOT USE THIS FORM FOR PROPOSALS TO DRILL OR TO DEEPEN OR PLUG BACK TO A DIFFERENT RESERVOIR.
USE "APPLICATION FOR PERMIT -" (FORM C-101) FOR SUCH PROPOSALS.)

1. OIL <input type="checkbox"/> GAS <input type="checkbox"/> OTHER- DRY HOLE		7. Unit Agreement Name
2. Name of Operator DOME PETROLEUM CORPORATION		8. Farm or Lease Name STATE 16-19-5
3. Address of Operator 501 Airport Drive, Suite 107, Farmington, New Mexico 87401		9. Well No. 2
4. Location of Well UNIT LETTER H 2310' FEET FROM THE NORTH LINE AND 330' FEET FROM THE EAST LINE, SECTION 16 TOWNSHIP 19N RANGE 5W NMPM.		10. Field and Pool, or Wildcat
15. Elevation (Show whether DF, RT, GR, etc.) 5678' GR		12. County MCKINLEY

16.

Check Appropriate Box To Indicate Nature of Notice, Report or Other Data

NOTICE OF INTENTION TO:

PERFORM REMEDIAL WORK ☐
TEMPORARILY ABANDON ☐
PULL OR ALTER CASING ☐
OTHER ☐

PLUG AND ABANDON ☐
CHANGE PLANS ☐

SUBSEQUENT REPORT OF:

REMEDIAL WORK ☐
COMMENCE DRILLING OPNS. ☐
CASING TEST AND CEMENT JOB ☐
OTHER ☐
ALTERING CASING ☐
PLUG AND ABANDONMENT ☒

17. Describe Proposed or Completed Operations (Clearly state all pertinent details, and give pertinent dates, including estimated date of starting any proposed work) SEE RULE 1103.

08/09/79 - Plugged and abandoned well as follows:

1. Pulled and layed down rods and pump. Pulled tubing.
2. Tallied in hole w/ tubing to PBTD at 5312'. Spotted plugs in 7" casing as follows:

PLUG NO.	DEPTH	SACKS CEMENT
1	5312-5050	55
2	4250-4100	35
3	3210-3110	20
4	2900-2850	10
5	1450-1400	10
6	150- surface	30

Cement plugs were class "B" cement with 2% CaCl and 1/4# Flo Seal/sack.

3. Cut off casing at ground level and erected dry hole marker.

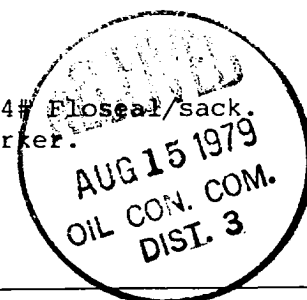

18. I hereby certify that the information above is true and complete to the best of my knowledge and belief.

SIGNED Ed. Hunsicker TITLE DRILLING FOREMAN DATE August 11, 1979

APPROVED BY Al. Hunsicker TITLE SUPERVISOR DISTRICT # 3 DATE AUG 2 1979

CONDITIONS OF APPROVAL IF ANY:

NEW MEXICO OIL CONSERVATION COMMISSION

COPIES RECEIVED	3
DISTRIBUTION	
SANTA FE	
FILE	
U.S.G.S.	
LAND OFFICE	
OPERATOR	

5a. Indicate Type of Lease	
State <input checked="" type="checkbox"/>	Fee <input type="checkbox"/>
5. State Oil & Gas Lease No.	

SUNDRY NOTICES AND REPORTS ON WELLS

(DO NOT USE THIS FORM FOR PROPOSALS TO DRILL OR TO DEEPEN OR PLUG BACK TO A DIFFERENT RESERVOIR.
USE "APPLICATION FOR PERMIT -" (FORM C-101) FOR SUCH PROPOSALS.)

1. OIL WELL <input checked="" type="checkbox"/> GAS WELL <input type="checkbox"/> OTHER <input type="checkbox"/>	7. Unit Agreement Name
2. Name of Operator Dome Petroleum Corporation	8. Farm or Lease Name State 2-16-19-5
3. Address of Operator Minerals Management Inc., Suite 105, 501 Airport Drive, Farmington, New Mexico 87401	9. Well No. 2
4. Location of Well UNIT LETTER <u>H</u> <u>2310</u> FEET FROM THE <u>north</u> LINE AND <u>330</u> FEET FROM THE <u>east</u> LINE, SECTION <u>16</u> TOWNSHIP <u>19N</u> RANGE <u>5W</u> NMMP.	10. Field and Pool, or Wildcat Papers Wash Entrada
15. Elevation (Show whether DF, RT, GR, etc.) 6578' GR	12. County McKinley

Check Appropriate Box To Indicate Nature of Notice, Report or Other Data
NOTICE OF INTENTION TO: SUBSEQUENT REPORT OF:

PERFORM REMEDIAL WORK <input type="checkbox"/>	PLUG AND ABANDON <input type="checkbox"/>	REMEDIAL WORK <input type="checkbox"/>	ALTERING CASING <input type="checkbox"/>
TEMPORARILY ABANDON <input type="checkbox"/>	CHANGE PLANS <input type="checkbox"/>	COMMENCE DRILLING OPNS. <input type="checkbox"/>	PLUG AND ABANDONMENT <input type="checkbox"/>
PULL OR ALTER CASING <input type="checkbox"/>	OTHER <input type="checkbox"/>	CASING TEST AND CEMENT JOB <input type="checkbox"/>	OTHER <u>Production Casing</u> <input checked="" type="checkbox"/>

17. Describe Proposed or Completed Operations (Clearly state all pertinent details, and give pertinent dates, including estimated date of starting any proposed work) SEE RULE 1103.

10-15-77 Ran 121 jts (5375') 7", K-55, ST&C casing (1708' - 23#, 3654' - 20#, 13' shoe, collar, etc.) set at 5373' with guide shoe, differential fillup collar, Lynes external casing packer set at 2729', with DV tool at 2687'. Cemented in two stages. First stage: 385 sx 65-35 Poz, 6% gel, 10# Gilsonite/sx tailed w/100 sx Class "B", 10% salt. Plug down at 7:45 p.m. Circulated through DV tool 4 hrs. Cemented second stage w/370 sx 65-35 Poz, 6% gel, 10# Gilsonite/sx tailed w/50 sx Class "B", 10% salt. Plug down at 12:45 a.m., 10-16-77. Cement circulated.

CONFIDENTIAL

18. I hereby certify that the information above is true and complete to the best of my knowledge and belief.

SIGNED [Signature] TITLE Area Manager DATE October 17, 1977
Minerals Management Inc.

APPROVED BY Original Signed by A. R. Kendrick TITLE [Signature] DATE 10 19 1978

CONDITIONS OF APPROVAL, IF ANY:

COPIES RECEIVED	3
DISTRIBUTION	
SANTA FE	
FILE	
U.S.G.S.	
LAND OFFICE	
OPERATOR	

NEW MEXICO OIL CONSERVATION COMMISSION

Form C-103
Supersedes Old
C-102 and C-103
Effective 1-1-65

5a. Indicate Type of Lease	
State <input checked="" type="checkbox"/>	Fee <input type="checkbox"/>
5. State Oil & Gas Lease No.	

SUNDRY NOTICES AND REPORTS ON WELLS (DO NOT USE THIS FORM FOR PROPOSALS TO DRILL OR TO DEEPEN OR PLUG BACK TO A DIFFERENT RESERVOIR. USE "APPLICATION FOR PERMIT -" (FORM C-101) FOR SUCH PROPOSALS.)

1. <input checked="" type="checkbox"/> OIL WELL <input type="checkbox"/> GAS WELL <input type="checkbox"/> OTHER-		7. Unit Agreement Name
2. Name of Operator Dome Petroleum Corporation		8. Farm or Lease Name State 2-16-19-5
3. Address of Operator Minerals Management Inc., Suite 105, 501 Airport Drive, Farmington, New Mexico 87401		9. Well No. 2
4. Location of Well UNIT LETTER <u>H</u> <u>2310</u> FEET FROM THE <u>North</u> LINE AND <u>330</u> FEET FROM <u>East</u> LINE, SECTION <u>16</u> TOWNSHIP <u>19N</u> RANGE <u>5W</u> NMPM.		10. Field and Pool, or Wildcat Papers Wash - Entrada
15. Elevation (Show whether DF, RT, GR, etc.) 5678' GR, 5690' KB		12. County McKinley

Check Appropriate Box To Indicate Nature of Notice, Report or Other Data NOTICE OF INTENTION TO: SUBSEQUENT REPORT OF:

PERFORM REMEDIAL WORK <input type="checkbox"/>	PLUG AND ABANDON <input type="checkbox"/>	REMEDIAL WORK <input type="checkbox"/>	ALTERING CASING <input type="checkbox"/>
TEMPORARILY ABANDON <input type="checkbox"/>	CHANGE PLANS <input type="checkbox"/>	COMMENCE DRILLING OPNS. <input type="checkbox"/>	PLUG AND ABANDONMENT <input type="checkbox"/>
PULL OR ALTER CASING <input type="checkbox"/>	OTHER <input type="checkbox"/>	CASING TEST AND CEMENT JOB <input type="checkbox"/>	OTHER <u>Water Shut Off</u> <input checked="" type="checkbox"/>

17. Describe Proposed or Completed Operations (Clearly state all pertinent details, and give pertinent dates, including estimated date of starting any proposed work) SEE RULE 1103.

- 10-21-77 Pressure tested casing to 2500 psi, 30 minutes--OK. Displaced water with crude oil. Swabbed fluid to 3000'. Layed down 2 7/8" tubing. Picked up 3 1/2" tubing.
- 10-24-77 Perforated intervals 5161'-5163', 5170'-5172', 5179'-5185' with 2 jet shots per foot. Ran 3 1/2" tubing and prepared to swab. Well flowed to tank.
- 10-25-77 Swabbed 23 BLO, 142 BW.
- 10-26-77 Swabbed 7 BLO, 223 BW.
- 10-27-77 Swabbed 0 BLO, 161 BW (33 BLO to recover).
- 10-28-77 Ran tracer survey.
- 11-8-77 Squeezed perforations with 75 sx LFL cement to 3500 psi. 5 BBL cement in formation.

CONFIDENTIAL

18. I hereby certify that the information above is true and complete to the best of my knowledge and belief.

SIGNED [Signature] TITLE Area Manager
Minerals Management Inc. DATE 11-10-77

Original Signed by A. R. Kendrick TITLE Area Manager DATE SEP 18 1978

CONDITIONS OF APPROVAL, IF ANY:

COPIES RECEIVED	4
DISTRIBUTION	
SANTA FE	1
FILE	
U.S.G.S.	
LAND OFFICE	
OPERATOR	2

NEW MEXICO OIL CONSERVATION COMMISSION

Form C-103
Supersedes Old
C-102 and C-103
Effective 1-1-65

SUNDRY NOTICES AND REPORTS ON WELLS <small>(DO NOT USE THIS FORM FOR PROPOSALS TO DRILL OR TO DEEPEN OR PLUG BACK TO A DIFFERENT RESERVOIR. USE "APPLICATION FOR PERMIT -" (FORM C-101) FOR SUCH PROPOSALS.)</small>		5a. Indicate Type of Lease State <input checked="" type="checkbox"/> Fee <input type="checkbox"/>
1. <input checked="" type="checkbox"/> OIL WELL <input type="checkbox"/> GAS WELL <input type="checkbox"/> OTHER-		5. State Oil & Gas Lease No.
2. Name of Operator Dome Petroleum Corp.		7. Unit Agreement Name
3. Address of Operator % K&A, Inc. Minerals Management, 501 Airport Dr. Suite 105, Farmington, New Mexico 87401		8. Farm or Lease Name State 2-16-19-5
4. Location of Well UNIT LETTER <u>H</u> <u>2310</u> FEET FROM THE <u>North</u> LINE AND <u>330</u> FEET FROM THE <u>East</u> LINE, SECTION <u>16</u> TOWNSHIP <u>19N</u> RANGE <u>5W</u> NMPM.		9. Well No. <u>2</u>
15. Elevation (Show whether DF, RT, GR, etc.) <u>5678' GR, 5690' KB</u>		10. Field and Pool, or Wildcat Papers Wash-Entrada
12. County McKinley		

16. Check Appropriate Box To Indicate Nature of Notice, Report or Other Data-- NOTICE OF INTENTION TO:		SUBSEQUENT REPORT OF:	
PERFORM REMEDIAL WORK <input type="checkbox"/> TEMPORARILY ABANDON <input type="checkbox"/> PULL OR ALTER CASING <input type="checkbox"/> OTHER <input type="checkbox"/>	PLUG AND ABANDON <input type="checkbox"/> CHANGE PLANS <input type="checkbox"/> OTHER <input type="checkbox"/>	REMEDIAL WORK <input checked="" type="checkbox"/> COMMENCE DRILLING OPNS. <input type="checkbox"/> CASING TEST AND CEMENT JOB <input type="checkbox"/> OTHER <input type="checkbox"/>	ALTERING CASING <input type="checkbox"/> PLUG AND ABANDONMENT <input type="checkbox"/> OTHER <input type="checkbox"/>

17. Describe Proposed or Completed Operations (Clearly state all pertinent details, and give pertinent dates, including estimated date of starting any proposed work) SEE RULE 1103.

11-11-77 Drilled cement to 5185'. Circulated hole clean to 5312'. Pressure tested casing to 1000 psi for 30 minutes.

11-12-77 Swabbed fluid level to 4000'. Layed down drill string.

11-13-77 S. D. Sunday.

11-14-77 Perforated 5179-81 with 4 shots per foot. Attempted to swab well. No fluid.

11-15-77 Attempted to break down perforations with bradenhead squeeze. Casing pressured to 2400 psi no breakdown. Picked up packer and set at 5074'. Perforations broke at 3250' psi. Established injection rate of 3 BPM @ 2900 psi.

11-16-77 Swabbed back 34 BLW.

11-17-77 Acidized with 200 gal. 15% HCL.

18. I hereby certify that the information above is true and complete to the best of my knowledge and belief.

SIGNED [Signature] TITLE K&A, Inc. Minerals Management Area Manager DATE 6-21-78

Original Signed by A. R. Kendrick TITLE SUPERVISOR DIST. #3 DATE SEP 18 1978

APPROVED BY: _____

CONDITIONS OF APPROVAL, IF ANY:

1 - 11-17-77 11-18-77 11-19-77 11-20-77 11-21-77 11-22-77 11-23-77 11-24-77 11-25-77 11-26-77 11-27-77 11-28-77 11-29-77 11-30-77 11-31-77 11-1-78 11-2-78 11-3-78 11-4-78 11-5-78 11-6-78 11-7-78 11-8-78 11-9-78 11-10-78 11-11-78 11-12-78 11-13-78 11-14-78 11-15-78 11-16-78 11-17-78 11-18-78 11-19-78 11-20-78 11-21-78 11-22-78 11-23-78 11-24-78 11-25-78 11-26-78 11-27-78 11-28-78 11-29-78 11-30-78 11-31-78 11-1-79 11-2-79 11-3-79 11-4-79 11-5-79 11-6-79 11-7-79 11-8-79 11-9-79 11-10-79 11-11-79 11-12-79 11-13-79 11-14-79 11-15-79 11-16-79 11-17-79 11-18-79 11-19-79 11-20-79 11-21-79 11-22-79 11-23-79 11-24-79 11-25-79 11-26-79 11-27-79 11-28-79 11-29-79 11-30-79 11-31-79 11-1-80 11-2-80 11-3-80 11-4-80 11-5-80 11-6-80 11-7-80 11-8-80 11-9-80 11-10-80 11-11-80 11-12-80 11-13-80 11-14-80 11-15-80 11-16-80 11-17-80 11-18-80 11-19-80 11-20-80 11-21-80 11-22-80 11-23-80 11-24-80 11-25-80 11-26-80 11-27-80 11-28-80 11-29-80 11-30-80 11-31-80 11-1-81 11-2-81 11-3-81 11-4-81 11-5-81 11-6-81 11-7-81 11-8-81 11-9-81 11-10-81 11-11-81 11-12-81 11-13-81 11-14-81 11-15-81 11-16-81 11-17-81 11-18-81 11-19-81 11-20-81 11-21-81 11-22-81 11-23-81 11-24-81 11-25-81 11-26-81 11-27-81 11-28-81 11-29-81 11-30-81 11-31-81 11-1-82 11-2-82 11-3-82 11-4-82 11-5-82 11-6-82 11-7-82 11-8-82 11-9-82 11-10-82 11-11-82 11-12-82 11-13-82 11-14-82 11-15-82 11-16-82 11-17-82 11-18-82 11-19-82 11-20-82 11-21-82 11-22-82 11-23-82 11-24-82 11-25-82 11-26-82 11-27-82 11-28-82 11-29-82 11-30-82 11-31-82 11-1-83 11-2-83 11-3-83 11-4-83 11-5-83 11-6-83 11-7-83 11-8-83 11-9-83 11-10-83 11-11-83 11-12-83 11-13-83 11-14-83 11-15-83 11-16-83 11-17-83 11-18-83 11-19-83 11-20-83 11-21-83 11-22-83 11-23-83 11-24-83 11-25-83 11-26-83 11-27-83 11-28-83 11-29-83 11-30-83 11-31-83 11-1-84 11-2-84 11-3-84 11-4-84 11-5-84 11-6-84 11-7-84 11-8-84 11-9-84 11-10-84 11-11-84 11-12-84 11-13-84 11-14-84 11-15-84 11-16-84 11-17-84 11-18-84 11-19-84 11-20-84 11-21-84 11-22-84 11-23-84 11-24-84 11-25-84 11-26-84 11-27-84 11-28-84 11-29-84 11-30-84 11-31-84 11-1-85 11-2-85 11-3-85 11-4-85 11-5-85 11-6-85 11-7-85 11-8-85 11-9-85 11-10-85 11-11-85 11-12-85 11-13-85 11-14-85 11-15-85 11-16-85 11-17-85 11-18-85 11-19-85 11-20-85 11-21-85 11-22-85 11-23-85 11-24-85 11-25-85 11-26-85 11-27-85 11-28-85 11-29-85 11-30-85 11-31-85 11-1-86 11-2-86 11-3-86 11-4-86 11-5-86 11-6-86 11-7-86 11-8-86 11-9-86 11-10-86 11-11-86 11-12-86 11-13-86 11-14-86 11-15-86 11-16-86 11-17-86 11-18-86 11-19-86 11-20-86 11-21-86 11-22-86 11-23-86 11-24-86 11-25-86 11-26-86 11-27-86 11-28-86 11-29-86 11-30-86 11-31-86 11-1-87 11-2-87 11-3-87 11-4-87 11-5-87 11-6-87 11-7-87 11-8-87 11-9-87 11-10-87 11-11-87 11-12-87 11-13-87 11-14-87 11-15-87 11-16-87 11-17-87 11-18-87 11-19-87 11-20-87 11-21-87 11-22-87 11-23-87 11-24-87 11-25-87 11-26-87 11-27-87 11-28-87 11-29-87 11-30-87 11-31-87 11-1-88 11-2-88 11-3-88 11-4-88 11-5-88 11-6-88 11-7-88 11-8-88 11-9-88 11-10-88 11-11-88 11-12-88 11-13-88 11-14-88 11-15-88 11-16-88 11-17-88 11-18-88 11-19-88 11-20-88 11-21-88 11-22-88 11-23-88 11-24-88 11-25-88 11-26-88 11-27-88 11-28-88 11-29-88 11-30-88 11-31-88 11-1-89 11-2-89 11-3-89 11-4-89 11-5-89 11-6-89 11-7-89 11-8-89 11-9-89 11-10-89 11-11-89 11-12-89 11-13-89 11-14-89 11-15-89 11-16-89 11-17-89 11-18-89 11-19-89 11-20-89 11-21-89 11-22-89 11-23-89 11-24-89 11-25-89 11-26-89 11-27-89 11-28-89 11-29-89 11-30-89 11-31-89 11-1-90 11-2-90 11-3-90 11-4-90 11-5-90 11-6-90 11-7-90 11-8-90 11-9-90 11-10-90 11-11-90 11-12-90 11-13-90 11-14-90 11-15-90 11-16-90 11-17-90 11-18-90 11-19-90 11-20-90 11-21-90 11-22-90 11-23-90 11-24-90 11-25-90 11-26-90 11-27-90 11-28-90 11-29-90 11-30-90 11-31-90 11-1-91 11-2-91 11-3-91 11-4-91 11-5-91 11-6-91 11-7-91 11-8-91 11-9-91 11-10-91 11-11-91 11-12-91 11-13-91 11-14-91 11-15-91 11-16-91 11-17-91 11-18-91 11-19-91 11-20-91 11-21-91 11-22-91 11-23-91 11-24-91 11-25-91 11-26-91 11-27-91 11-28-91 11-29-91 11-30-91 11-31-91 11-1-92 11-2-92 11-3-92 11-4-92 11-5-92 11-6-92 11-7-92 11-8-92 11-9-92 11-10-92 11-11-92 11-12-92 11-13-92 11-14-92 11-15-92 11-16-92 11-17-92 11-18-92 11-19-92 11-20-92 11-21-92 11-22-92 11-23-92 11-24-92 11-25-92 11-26-92 11-27-92 11-28-92 11-29-92 11-30-92 11-31-92 11-1-93 11-2-93 11-3-93 11-4-93 11-5-93 11-6-93 11-7-93 11-8-93 11-9-93 11-10-93 11-11-93 11-12-93 11-13-93 11-14-93 11-15-93 11-16-93 11-17-93 11-18-93 11-19-93 11-20-93 11-21-93 11-22-93 11-23-93 11-24-93 11-25-93 11-26-93 11-27-93 11-28-93 11-29-93 11-30-93 11-31-93 11-1-94 11-2-94 11-3-94 11-4-94 11-5-94 11-6-94 11-7-94 11-8-94 11-9-94 11-10-94 11-11-94 11-12-94 11-13-94 11-14-94 11-15-94 11-16-94 11-17-94 11-18-94 11-19-94 11-20-94 11-21-94 11-22-94 11-23-94 11-24-94 11-25-94 11-26-94 11-27-94 11-28-94 11-29-94 11-30-94 11-31-94 11-1-95 11-2-95 11-3-95 11-4-95 11-5-95 11-6-95 11-7-95 11-8-95 11-9-95 11-10-95 11-11-95 11-12-95 11-13-95 11-14-95 11-15-95 11-16-95 11-17-95 11-18-95 11-19-95 11-20-95 11-21-95 11-22-95 11-23-95 11-24-95 11-25-95 11-26-95 11-27-95 11-28-95 11-29-95 11-30-95 11-31-95 11-1-96 11-2-96 11-3-96 11-4-96 11-5-96 11-6-96 11-7-96 11-8-96 11-9-96 11-10-96 11-11-96 11-12-96 11-13-96 11-14-96 11-15-96 11-16-96 11-17-96 11-18-96 11-19-96 11-20-96 11-21-96 11-22-96 11-23-96 11-24-96 11-25-96 11-26-96 11-27-96 11-28-96 11-29-96 11-30-96 11-31-96 11-1-97 11-2-97 11-3-97 11-4-97 11-5-97 11-6-97 11-7-97 11-8-97 11-9-97 11-10-97 11-11-97 11-12-97 11-13-97 11-14-97 11-15-97 11-16-97 11-17-97 11-18-97 11-19-97 11-20-97 11-21-97 11-22-97 11-23-97 11-24-97 11-25-97 11-26-97 11-27-97 11-28-97 11-29-97 11-30-97 11-31-97 11-1-98 11-2-98 11-3-98 11-4-98 11-5-98 11-6-98 11-7-98 11-8-98 11-9-98 11-10-98 11-11-98 11-12-98 11-13-98 11-14-98 11-15-98 11-16-98 11-17-98 11-18-98 11-19-98 11-20-98 11-21-98 11-22-98 11-23-98 11-24-98 11-25-98 11-26-98 11-27-98 11-28-98 11-29-98 11-30-98 11-31-98 11-1-99 11-2-99 11-3-99 11-4-99 11-5-99 11-6-99 11-7-99 11-8-99 11-9-99 11-10-99 11-11-99 11-12-99 11-13-99 11-14-99 11-15-99 11-16-99 11-17-99 11-18-99 11-19-99 11-20-99 11-21-99 11-22-99 11-23-99 11-24-99 11-25-99 11-26-99 11-27-99 11-28-99 11-29-99 11-30-99 11-31-99 11-1-00 11-2-00 11-3-00 11-4-00 11-5-00 11-6-00 11-7-00 11-8-00 11-9-00 11-10-00 11-11-00 11-12-00 11-13-00 11-14-00 11-15-00 11-16-00 11-17-00 11-18-00 11-19-00 11-20-00 11-21-00 11-22-00 11-23-00 11-24-00 11-25-00 11-26-00 11-27-00 11-28-00 11-29-00 11-30-00 11-31-00 11-1-01 11-2-01 11-3-01 11-4-01 11-5-01 11-6-01 11-7-01 11-8-01 11-9-01 11-10-01 11-11-01 11-12-01 11-13-01 11-14-01 11-15-01 11-16-01 11-17-01 11-18-01 11-19-01 11-20-01 11-21-01 11-22-01 11-23-01 11-24-01 11-25-01 11-26-01 11-27-01 11-28-01 11-29-01 11-30-01 11-31-01 11-1-02 11-2-02 11-3-02 11-4-02 11-5-02 11-6-02 11-7-02 11-8-02 11-9-02 11-10-02 11-11-02 11-12-02 11-13-02 11-14-02 11-15-02 11-16-02 11-17-02 11-18-02 11-19-02 11-20-02 11-21-02 11-22-02 11-23-02 11-24-02 11-25-02 11-26-02 11-27-02 11-28-02 11-29-02 11-30-02 11-31-02 11-1-03 11-2-03 11-3-03 11-4-03 11-5-03 11-6-03 11-7-03 11-8-03 11-9-03 11-10-03 11-11-03 11-12-03 11-13-03 11-14-03 11-15-03 11-16-03 11-17-03 11-18-03 11-19-03 11-20-03 11-21-03 11-22-03 11-23-03 11-24-03 11-25-03 11-26-03 11-27-03 11-28-03 11-29-03 11-30-03 11-31-03 11-1-04 11-2-04 11-3-04 11-4-04 11-5-04 11-6-04 11-7-04 11-8-04 11-9-04 11-10-04 11-11-04 11-12-04 11-13-04 11-14-04 11-15-04 11-16-04 11-17-04 11-18-04 11-19-04 11-20-04 11-21-04 11-22-04 11-23-04 11-24-04 11-25-04 11-26-04 11-27-04 11-28-04 11-29-04 11-30-04 11-31-04 11-1-05 11-2-05 11-3-05 11-4-05 11-5-05 11-6-05 11-7-05 11-8-05 11-9-05 11-10-05 11-11-05 11-12-05 11-13-05 11-14-05 11-15-05 11-16-05 11-17-05 11-18-05 11-19-05 11-20-05 11-21-05 11-22-05 11-23-05 11-24-05 11-25-05 11-26-05 11-27-05 11-28-05 11-29-05 11-30-05 11-31-05 11-1-06 11-2-06 11-3-06 11-4-06 11-5-06 11-6-06 11-7-06 11-8-06 11-9-06 11-10-06 11-11-06 11-12-06 11-13-06 11-14-06 11-15-06 11-16-06 11-17-06 11-18-06 11-19-06 11-20-06 11-21-06 11-22-06 11-23-06 11-24-06 11-25-06 11-26-06 11-27-06 11-28-06 11-29-06 11-30-06 11-31-06 11-1-07 11-2-07 11-3-07 11-4-07 11-5-07 11-6-07 11-7-07 11-8-07 11-9-07 11-10-07 11-11-07 11-12-07 11-13-07 11-14-07 11-15-07 11-16-07 11-17-07 11-18-07 11-19-07 11-20-07 11-21-07 11-22-07 11-23-07 11-24-07 11-25-07 11-26-07 11-27-07 11-28-07 11-29-07 11-30-07 11-31-07 11-1-08 11-2-08 11-3-08 11-4-08 11-5-08 11-6-08 11-7-08 11-8-08 11-9-08 11-10-08 11-11-08 11-12-08 11-13-08 11-14-08 11-15-08 11-16-08 11-17-08 11-18-08 11-19-08 11-20-08 11-21-08 11-22-08 11-23-08 11-24-08 11-25-08 11-26-08 11-27-08 11-28-08 11-29-08 11-30-08 11-31-08 11-1-09 11-2-09 11-3-09 11-4-09 11-5-09 11-6-09 11-7-09 11-8-09 11-9-09 11-10-09 11-11-09 11-12-09 11-13-09 11-14-09 11-15-09 11-16-09 11-17-09 11-18-09 11-19-09 11-20-09 11-21-09 11-22-09 11-23-09 11-24-09 11-25-09 11-26-09 11-27-09 11-28-09 11-29-09 11-30-09 11-31-09 11-1-10 11-2-10 11-3-10 11-4-10 11-5-10 11-6-10 11-7-10 11-8-10 11-9-10 11-10-10 11-11-10 11-12-10 11-13-10 11-14-10 11-15-10 11-16-10 11-17-10 11-18-10 11-19-10 11-20-10 11-21-10 11-22-10 11-23-10 11-24-10 11-25-10 11-26-10 11-27-10 11-28-10 11-29-10 11-30-10 11-31-10 11-1-11 11-2-11 11-3-11 11-4-11 11-5-11 11-6-11 11-7-11 11-8-11 11-9-11 11-10-11 11-11-11 11-12-11 11-13-11 11-14-11 11-15-11 11-16-11 11-17-11 11-18-11 11-19-11 11-20-11 11-21-11 11-22-11 11-23-11 11-24-11 11-25-11 11-26-11 11-27-11 11-28-11 11-29-11 11-30-11 11-31-11 11-1-12 11-2-12 11-3-12 11-4-12 11-5-12 11-6-12 11-7-12 11-8-12 11-9-12 11-10-12 11-11-12 11-12-12 11-13-12 11-14-12 11-15-12 11-16-12 11-17-12 11-18-12 11-19-12 11-20-12 11-21-12 11-22-12 11-23-12 11-24-12 11-25-12 11-26-12 11-27-12 11-28-12 11-29-12 11-30-12 11-31-12 11-1-13 11-2-13 11-3-13 11-4-13 11-5-13 11-6-13 11-7-13 11-8-13 11-9-13 11-10-13 11-11-13 11-12-13 11-13-13 11-14-13 11-15-13 11-16-13 11-17-13 11-18-13 11-19-13 11-20-13 11-21-13 11-22-13 11-23-13 11-24-13 11-25-13 11-26-13 11-27-13 11-28-13 11-29-13 11-30-13 11-31-13 11-1-14 11-2-14 11-3-14 11-4-14 11-5-14 11-6-14 11-7-14 11-8-14 11-9-14 11-10-14 11-11-14 11-12-14 11-13-14 11-14-14 11-15-14 11-16-14 11-17-14 11-18-14 11-19-14 11-20-14 11-21-14 11-22-14 11-23-14 11-24-14 11-25-14 11-26-14 11-27-14 11-28-14 11-29-14 11-30-14 11-31-14 11-1-15 11-2-15 11-3-15 11-4-15 11-5-15 11-6-15 11-7-15 11-8-15 11-9-15 11-10-15 11-11-15 11-12-15 11-13-15 11-14-15 11-15-15 11-16-15 11-17-15 11-18-15 11-19-15 11-20-15 11-21-15 11-22-15 11-23-15 11-24-15 11-25-15 11-26-15 11-27-15 11-28-15 11-29-15 11-30-15 11-31-15 11-1-16 11-2-16 11-3-16 11-4-16 11-5-16 11-6-16 11-7-16 11-8-16 11-9-16 11-10-16 11-11-16 11-12-16 11-13-16 11-14-16 11-15-16

NO. OF COPIES RECEIVED	4
DISTRIBUTION	
SANTA FE	
FILE	
U.S.G.S.	
LAND OFFICE	
OPERATOR	2

NEW MEXICO OIL CONSERVATION COMMISSION

Form C-103
Supersedes Old
C-102 and C-103
Effective 1-1-65

SUNDRY NOTICES AND REPORTS ON WELLS (DO NOT USE THIS FORM FOR PROPOSALS TO DRILL OR TO DEEPEN OR PLUG BACK TO A DIFFERENT RESERVOIR. USE "APPLICATION FOR PERMIT -" (FORM C-101) FOR SUCH PROPOSALS.)		5a. Indicate Type of Lease State <input checked="" type="checkbox"/> Fee <input type="checkbox"/>
		5. State Oil & Gas Lease No.
		7. Unit Agreement Name
		8. Farm or Lease Name
Name of Operator Dome Petroleum Corp.		State 2-16-19-5
Address of Operator % K&A, Inc. Minerals Management, 501 Airport Dr. Suite 105, Farmington, New Mexico 87401		9. Well No. 2
Location of Well UNIT LETTER H 2310 FEET FROM THE North LINE AND 330 FEET FROM THE East LINE, SECTION 16 TOWNSHIP 19N RANGE 5W NMPM.		10. Field and Pool, or Wildcat Papers Wash-Entrada
15. Elevation (Show whether DF, RT, GR, etc.) 5678' GR, 5690' KB		12. County McKinley

Check Appropriate Box To Indicate Nature of Notice, Report or Other Data	
NOTICE OF INTENTION TO:	SUBSEQUENT REPORT OF:
PERFORM REMEDIAL WORK <input type="checkbox"/>	REMEDIAL WORK <input checked="" type="checkbox"/>
TEMPORARILY ABANDON <input type="checkbox"/>	COMMENCE DRILLING OPNS. <input type="checkbox"/>
NULL OR ALTER CASING <input type="checkbox"/>	CASING TEST AND CEMENT JOB <input type="checkbox"/>
OTHER <input type="checkbox"/>	OTHER <input type="checkbox"/>
PLUG AND ABANDON <input type="checkbox"/>	ALTERING CASING <input type="checkbox"/>
CHANGE PLANS <input type="checkbox"/>	PLUG AND ABANDONMENT <input type="checkbox"/>

7. Describe Proposed or Completed Operations (Clearly state all pertinent details, and give pertinent dates, including estimated date of starting any proposed work) SEE RULE 1103.

11-18-77 Swabbed 144 Bbl. Fluid 7% oil.
11-19-77 Swabbed 113 Bbl. Fluid 7% oil.
11-20-77 S.D. Sunday
11-21-77 Layed down 2 7/8" tubing.
Ran 3 1/2" tubing.
Shut down well for evaluation.

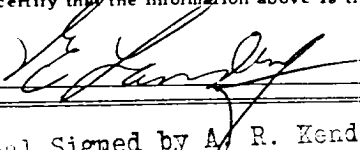
I hereby certify that the information above is true and complete to the best of my knowledge and belief.		
SIGNED 	TITLE K&A, Inc. Minerals Management Area Manager	DATE 6-21-78
Original Signed by A. R. Kendrick	TITLE	DATE
APPROVED BY	TITLE	DATE
CONDITIONS OF APPROVAL, IF ANY:		

SEP 18 1978

11-20-77 11-21-77 11-22-77 11-23-77 11-24-77 11-25-77 11-26-77 11-27-77 11-28-77 11-29-77 11-30-77 11-31-77 11-1-78 11-2-78 11-3-78 11-4-78 11-5-78 11-6-78 11-7-78 11-8-78 11-9-78 11-10-78 11-11-78 11-12-78 11-13-78 11-14-78 11-15-78 11-16-78 11-17-78 11-18-78 11-19-78 11-20-78 11-21-78 11-22-78 11-23-78 11-24-78 11-25-78 11-26-78 11-27-78 11-28-78 11-29-78 11-30-78 11-31-78 12-1-78 12-2-78 12-3-78 12-4-78 12-5-78 12-6-78 12-7-78 12-8-78 12-9-78 12-10-78 12-11-78 12-12-78 12-13-78 12-14-78 12-15-78 12-16-78 12-17-78 12-18-78 12-19-78 12-20-78 12-21-78 12-22-78 12-23-78 12-24-78 12-25-78 12-26-78 12-27-78 12-28-78 12-29-78 12-30-78 12-31-78 1-1-79 1-2-79 1-3-79 1-4-79 1-5-79 1-6-79 1-7-79 1-8-79 1-9-79 1-10-79 1-11-79 1-12-79 1-13-79 1-14-79 1-15-79 1-16-79 1-17-79 1-18-79 1-19-79 1-20-79 1-21-79 1-22-79 1-23-79 1-24-79 1-25-79 1-26-79 1-27-79 1-28-79 1-29-79 1-30-79 1-31-79 2-1-79 2-2-79 2-3-79 2-4-79 2-5-79 2-6-79 2-7-79 2-8-79 2-9-79 2-10-79 2-11-79 2-12-79 2-13-79 2-14-79 2-15-79 2-16-79 2-17-79 2-18-79 2-19-79 2-20-79 2-21-79 2-22-79 2-23-79 2-24-79 2-25-79 2-26-79 2-27-79 2-28-79 2-29-79 2-30-79 2-31-79 3-1-79 3-2-79 3-3-79 3-4-79 3-5-79 3-6-79 3-7-79 3-8-79 3-9-79 3-10-79 3-11-79 3-12-79 3-13-79 3-14-79 3-15-79 3-16-79 3-17-79 3-18-79 3-19-79 3-20-79 3-21-79 3-22-79 3-23-79 3-24-79 3-25-79 3-26-79 3-27-79 3-28-79 3-29-79 3-30-79 3-31-79 4-1-79 4-2-79 4-3-79 4-4-79 4-5-79 4-6-79 4-7-79 4-8-79 4-9-79 4-10-79 4-11-79 4-12-79 4-13-79 4-14-79 4-15-79 4-16-79 4-17-79 4-18-79 4-19-79 4-20-79 4-21-79 4-22-79 4-23-79 4-24-79 4-25-79 4-26-79 4-27-79 4-28-79 4-29-79 4-30-79 4-31-79 5-1-79 5-2-79 5-3-79 5-4-79 5-5-79 5-6-79 5-7-79 5-8-79 5-9-79 5-10-79 5-11-79 5-12-79 5-13-79 5-14-79 5-15-79 5-16-79 5-17-79 5-18-79 5-19-79 5-20-79 5-21-79 5-22-79 5-23-79 5-24-79 5-25-79 5-26-79 5-27-79 5-28-79 5-29-79 5-30-79 5-31-79 6-1-79 6-2-79 6-3-79 6-4-79 6-5-79 6-6-79 6-7-79 6-8-79 6-9-79 6-10-79 6-11-79 6-12-79 6-13-79 6-14-79 6-15-79 6-16-79 6-17-79 6-18-79 6-19-79 6-20-79 6-21-79 6-22-79 6-23-79 6-24-79 6-25-79 6-26-79 6-27-79 6-28-79 6-29-79 6-30-79 6-31-79 7-1-79 7-2-79 7-3-79 7-4-79 7-5-79 7-6-79 7-7-79 7-8-79 7-9-79 7-10-79 7-11-79 7-12-79 7-13-79 7-14-79 7-15-79 7-16-79 7-17-79 7-18-79 7-19-79 7-20-79 7-21-79 7-22-79 7-23-79 7-24-79 7-25-79 7-26-79 7-27-79 7-28-79 7-29-79 7-30-79 7-31-79 8-1-79 8-2-79 8-3-79 8-4-79 8-5-79 8-6-79 8-7-79 8-8-79 8-9-79 8-10-79 8-11-79 8-12-79 8-13-79 8-14-79 8-15-79 8-16-79 8-17-79 8-18-79 8-19-79 8-20-79 8-21-79 8-22-79 8-23-79 8-24-79 8-25-79 8-26-79 8-27-79 8-28-79 8-29-79 8-30-79 8-31-79 9-1-79 9-2-79 9-3-79 9-4-79 9-5-79 9-6-79 9-7-79 9-8-79 9-9-79 9-10-79 9-11-79 9-12-79 9-13-79 9-14-79 9-15-79 9-16-79 9-17-79 9-18-79 9-19-79 9-20-79 9-21-79 9-22-79 9-23-79 9-24-79 9-25-79 9-26-79 9-27-79 9-28-79 9-29-79 9-30-79 9-31-79 10-1-79 10-2-79 10-3-79 10-4-79 10-5-79 10-6-79 10-7-79 10-8-79 10-9-79 10-10-79 10-11-79 10-12-79 10-13-79 10-14-79 10-15-79 10-16-79 10-17-79 10-18-79 10-19-79 10-20-79 10-21-79 10-22-79 10-23-79 10-24-79 10-25-79 10-26-79 10-27-79 10-28-79 10-29-79 10-30-79 10-31-79 11-1-79 11-2-79 11-3-79 11-4-79 11-5-79 11-6-79 11-7-79 11-8-79 11-9-79 11-10-79 11-11-79 11-12-79 11-13-79 11-14-79 11-15-79 11-16-79 11-17-79 11-18-79 11-19-79 11-20-79 11-21-79 11-22-79 11-23-79 11-24-79 11-25-79 11-26-79 11-27-79 11-28-79 11-29-79 11-30-79 11-31-79 12-1-79 12-2-79 12-3-79 12-4-79 12-5-79 12-6-79 12-7-79 12-8-79 12-9-79 12-10-79 12-11-79 12-12-79 12-13-79 12-14-79 12-15-79 12-16-79 12-17-79 12-18-79 12-19-79 12-20-79 12-21-79 12-22-79 12-23-79 12-24-79 12-25-79 12-26-79 12-27-79 12-28-79 12-29-79 12-30-79 12-31-79 1-1-80 1-2-80 1-3-80 1-4-80 1-5-80 1-6-80 1-7-80 1-8-80 1-9-80 1-10-80 1-11-80 1-12-80 1-13-80 1-14-80 1-15-80 1-16-80 1-17-80 1-18-80 1-19-80 1-20-80 1-21-80 1-22-80 1-23-80 1-24-80 1-25-80 1-26-80 1-27-80 1-28-80 1-29-80 1-30-80 1-31-80 2-1-80 2-2-80 2-3-80 2-4-80 2-5-80 2-6-80 2-7-80 2-8-80 2-9-80 2-10-80 2-11-80 2-12-80 2-13-80 2-14-80 2-15-80 2-16-80 2-17-80 2-18-80 2-19-80 2-20-80 2-21-80 2-22-80 2-23-80 2-24-80 2-25-80 2-26-80 2-27-80 2-28-80 2-29-80 2-30-80 2-31-80 3-1-80 3-2-80 3-3-80 3-4-80 3-5-80 3-6-80 3-7-80 3-8-80 3-9-80 3-10-80 3-11-80 3-12-80 3-13-80 3-14-80 3-15-80 3-16-80 3-17-80 3-18-80 3-19-80 3-20-80 3-21-80 3-22-80 3-23-80 3-24-80 3-25-80 3-26-80 3-27-80 3-28-80 3-29-80 3-30-80 3-31-80 4-1-80 4-2-80 4-3-80 4-4-80 4-5-80 4-6-80 4-7-80 4-8-80 4-9-80 4-10-80 4-11-80 4-12-80 4-13-80 4-14-80 4-15-80 4-16-80 4-17-80 4-18-80 4-19-80 4-20-80 4-21-80 4-22-80 4-23-80 4-24-80 4-25-80 4-26-80 4-27-80 4-28-80 4-29-80 4-30-80 4-31-80 5-1-80 5-2-80 5-3-80 5-4-80 5-5-80 5-6-80 5-7-80 5-8-80 5-9-80 5-10-80 5-11-80 5-12-80 5-13-80 5-14-80 5-15-80 5-16-80 5-17-80 5-18-80 5-19-80 5-20-80 5-21-80 5-22-80 5-23-80 5-24-80 5-25-80 5-26-80 5-27-80 5-28-80 5-29-80 5-30-80 5-31-80 6-1-80 6-2-80 6-3-80 6-4-80 6-5-80 6-6-80 6-7-80 6-8-80 6-9-80 6-10-80 6-11-80 6-12-80 6-13-80 6-14-80 6-15-80 6-16-80 6-17-80 6-18-80 6-19-80 6-20-80 6-21-80 6-22-80 6-23-80 6-24-80 6-25-80 6-26-80 6-27-80 6-28-80 6-29-80 6-30-80 6-31-80 7-1-80 7-2-80 7-3-80 7-4-80 7-5-80 7-6-80 7-7-80 7-8-80 7-9-80 7-10-80 7-11-80 7-12-80 7-13-80 7-14-80 7-15-80 7-16-80 7-17-80 7-18-80 7-19-80 7-20-80 7-21-80 7-22-80 7-23-80 7-24-80 7-25-80 7-26-80 7-27-80 7-28-80 7-29-80 7-30-80 7-31-80 8-1-80 8-2-80 8-3-80 8-4-80 8-5-80 8-6-80 8-7-80 8-8-80 8-9-80 8-10-80 8-11-80 8-12-80 8-13-80 8-14-80 8-15-80 8-16-80 8-17-80 8-18-80 8-19-80 8-20-80 8-21-80 8-22-80 8-23-80 8-24-80 8-25-80 8-26-80 8-27-80 8-28-80 8-29-80 8-30-80 8-31-80 9-1-80 9-2-80 9-3-80 9-4-80 9-5-80 9-6-80 9-7-80 9-8-80 9-9-80 9-10-80 9-11-80 9-12-80 9-13-80 9-14-80 9-15-80 9-16-80 9-17-80 9-18-80 9-19-80 9-20-80 9-21-80 9-22-80 9-23-80 9-24-80 9-25-80 9-26-80 9-27-80 9-28-80 9-29-80 9-30-80 9-31-80 10-1-80 10-2-80 10-3-80 10-4-80 10-5-80 10-6-80 10-7-80 10-8-80 10-9-80 10-10-80 10-11-80 10-12-80 10-13-80 10-14-80 10-15-80 10-16-80 10-17-80 10-18-80 10-19-80 10-20-80 10-21-80 10-22-80 10-23-80 10-24-80 10-25-80 10-26-80 10-27-80 10-28-80 10-29-80 10-30-80 10-31-80 11-1-80 11-2-80 11-3-80 11-4-80 11-5-80 11-6-80 11-7-80 11-8-80 11-9-80 11-10-80 11-11-80 11-12-80 11-13-80 11-14-80 11-15-80 11-16-80 11-17-80 11-18-80 11-19-80 11-20-80 11-21-80 11-22-80 11-23-80 11-24-80 11-25-80 11-26-80 11-27-80 11-28-80 11-29-80 11-30-80 11-31-80 12-1-80 12-2-80 12-3-80 12-4-80 12-5-80 12-6-80 12-7-80 12-8-80 12-9-80 12-10-80 12-11-80 12-12-80 12-13-80 12-14-80 12-15-80 12-16-80 12-17-80 12-18-80 12-19-80 12-20-80 12-21-80 12-22-80 12-23-80 12-24-80 12-25-80 12-26-80 12-27-80 12-28-80 12-29-80 12-30-80 12-31-80 1-1-81 1-2-81 1-3-81 1-4-81 1-5-81 1-6-81 1-7-81 1-8-81 1-9-81 1-10-81 1-11-81 1-12-81 1-13-81 1-14-81 1-15-81 1-16-81 1-17-81 1-18-81 1-19-81 1-20-81 1-21-81 1-22-81 1-23-81 1-24-81 1-25-81 1-26-81 1-27-81 1-28-81 1-29-81 1-30-81 1-31-81 2-1-81 2-2-81 2-3-81 2-4-81 2-5-81 2-6-81 2-7-81 2-8-81 2-9-81 2-10-81 2-11-81 2-12-81 2-13-81 2-14-81 2-15-81 2-16-81 2-17-81 2-18-81 2-19-81 2-20-81 2-21-81 2-22-81 2-23-81 2-24-81 2-25-81 2-26-81 2-27-81 2-28-81 2-29-81 2-30-81 2-31-81 3-1-81 3-2-81 3-3-81 3-4-81 3-5-81 3-6-81 3-7-81 3-8-81 3-9-81 3-10-81 3-11-81 3-12-81 3-13-81 3-14-81 3-15-81 3-16-81 3-17-81 3-18-81 3-19-81 3-20-81 3-21-81 3-22-81 3-23-81 3-24-81 3-25-81 3-26-81 3-27-81 3-28-81 3-29-81 3-30-81 3-31-81 4-1-81 4-2-81 4-3-81 4-4-81 4-5-81 4-6-81 4-7-81 4-8-81 4-9-81 4-10-81 4-11-81 4-12-81 4-13-81 4-14-81 4-15-81 4-16-81 4-17-81 4-18-81 4-19-81 4-20-81 4-21-81 4-22-81 4-23-81 4-24-81 4-25-81 4-26-81 4-27-81 4-28-81 4-29-81 4-30-81 4-31-81 5-1-81 5-2-81 5-3-81 5-4-81 5-5-81 5-6-81 5-7-81 5-8-81 5-9-81 5-10-81 5-11-81 5-12-81 5-13-81 5-14-81 5-15-81 5-16-81 5-17-81 5-18-81 5-19-81 5-20-81 5-21-81 5-22-81 5-23-81 5-24-81 5-25-81 5-26-81 5-27-81 5-28-81 5-29-81 5-30-81 5-31-81 6-1-81 6-2-81 6-3-81 6-4-81 6-5-81 6-6-81 6-7-81 6-8-81 6-9-81 6-10-81 6-11-81 6-12-81 6-13-81 6-14-81 6-15-81 6-16-81 6-17-81 6-18-81 6-19-81 6-20-81 6-21-81 6-22-81 6-23-81 6-24-81 6-25-81 6-26-81 6-27-81 6-28-81 6-29-81 6-30-81 6-31-81 7-1-81 7-2-81 7-3-81 7-4-81 7-5-81 7-6-81 7-7-81 7-8-81 7-9-81 7-10-81 7-11-81 7-12-81 7-13-81 7-14-81 7-15-81 7-16-81 7-17-81 7-18-81 7-19-81 7-20-81 7-21-81 7-22-81 7-23-81 7-24-81 7-25-81 7-26-81 7-27-81 7-28-81 7-29-81 7-30-81 7-31-81 8-1-81 8-2-81 8-3-81 8-4-81 8-5-81 8-6-81 8-7-81 8-8-81 8-9-81 8-10-81 8-11-81 8-12-81 8-13-81 8-14-81 8-15-81 8-16-81 8-17-81 8-18-81 8-19-81 8-20-81 8-21-81 8-22-81 8-23-81 8-24-81 8-25-81 8-26-81 8-27-81 8-28-81 8-29-81 8-30-81 8-31-81 9-1-81 9-2-81 9-3-81 9-4-81 9-5-81 9-6-81 9-7-81 9-8-81 9-9-81 9-10-81 9-11-81 9-12-81 9-13-81 9-14-81 9-15-81 9-16-81 9-17-81 9-18-81 9-19-81 9-20-81 9-21-81 9-22-81 9-23-81 9-24-81 9-25-81 9-26-81 9-27-81 9-28-81 9-29-81 9-30-81 9-31-81 10-1-81 10-2-81 10-3-81 10-4-81 10-5-81 10-6-81 10-7-81 10-8-81 10-9-81 10-10-81 10-11-81 10-12-81 10-13-81 10-14-81 10-15-81 10-16-81 10-17-81 10-18-81 10-19-81 10-20-81 10-21-81 10-22-81 10-23-81 10-24-81 10-25-81 10-26-81 10-27-81 10-28-81 10-29-81 10-30-81 10-31-81 11-1-81 11-2-81 11-3-81 11-4-81 11-5-81 11-6-81 11-7-81 11-8-81 11-9-81 11-10-81 11-11-81 11-12-81 11-13-81 11-14-81 11-15-81 11-16-81 11-17-81 11-18-81 11-19-81 11-20-81 11-21-81 11-22-81 11-23-81 11-24-81 11-25-81 11-26-81 11-27-81 11-28-81 11-29-81 11-30-81 11-31-81 12-1-81 12-2-81 12-3-81 12-4-81 12-5-81 12-6-81 12-7-81 12-8-81 12-9-81 12-10-81 12-11-81 12-12-81 12-13-81 12-14-81 12-15-81 12-16-81 12-17-81 12-18-81 12-19-81 12-20-81 12-21-81 12-22-81 12-23-81 12-24-81 12-25-81 12-26-81 12-27-81 12-28-81 12-29-81 12-30-81 12-31-81 1-1-82 1-2-82 1-3-82 1-4-82 1-5-82 1-6-82 1-7-82 1-8-82 1-9-82 1-10-82 1-11-82 1-12-82 1-13-82 1-14-82 1-15-82 1-16-82 1-17-82 1-18-82 1-19-82 1-20-82 1-21-82 1-22-82 1-23-82 1-24-82 1-25-82 1-26-82 1-27-82 1-28-82 1-29-82 1-30-82 1-31-82 2-1-82 2-2-82 2-3-82 2-4-82 2-5-82 2-6-82 2-7-82 2-8-82 2-9-82 2-10-82 2-11-82 2-12-82 2-13-82 2-14-82 2-15-82 2-16-82 2-17-82 2-18-82 2-19-82 2-20-82 2-21-82 2-22-82 2-23-82 2-24-82 2-25-82 2-26-82 2-27-82 2-28-82 2-29-82 2-30-82 2-31-82 3-1-82 3-2-82 3-3-82 3-4-82 3-5-82 3-6-82 3-7-82 3-8-82 3-9-82 3-10-82 3-11-82 3-12-82 3-13-82 3-14-82 3-15-82 3-16-82 3-17-82 3-18-82 3-19-82 3-20-82 3-21-82 3-22-82 3-23-82 3-24-82 3-25-82 3-26-82 3-27-82 3-28-82 3-29-82 3-30-82 3-31-82 4-1-82 4-2-82 4-3-82 4-4-82 4-5-82 4-6-82 4-7-82 4-8-82 4-9-82 4-10-82 4-11-82 4-12-82 4-13-82 4-14-82 4-15-82 4-16-82 4-17-82 4-18-82 4-19-82 4-20-82 4-21-82 4-22-82 4-23-82 4-24-82 4-25-82 4-26-82 4-27-82 4-28-82 4-29-82 4-30-82 4-31-82 5-1-82 5-2-82 5-3-82 5-4-82 5-5-82 5-6-82 5-7-82 5-8-82 5-9-82 5-10-82 5-11-82 5-12-82 5-13-82 5-14-82 5-15-82 5-16-82 5-17-82 5-18-82 5-19-82 5-20-82 5-21-82 5-22-82 5-23-82 5-24-82 5-25-82 5-26-82 5-27-82 5-28-82 5-29-82 5-30-82 5-31-82 6-1-82 6-2-82 6-3-82 6-4-82 6-5-82 6-6-82 6-7-82 6-8-82 6-9-82 6-10-82 6-11-82 6-12-82 6-13-82 6-14-82 6-15-82 6-16-82 6-17-82 6-18-82 6-19-82 6-20-82 6-21-82 6-22-82 6

NO. OF COPIES RECEIVED	6
DISTRIBUTION	
SANTA FE	1
FILE	
U.S.G.S.	
LAND OFFICE	
OPERATOR	4

NEW MEXICO OIL CONSERVATION COMMISSION

Form C-103
Supersedes Old
C-102 and C-103
Effective 1-1-65

5a. Indicate Type of Lease	
State <input checked="" type="checkbox"/>	Fee <input type="checkbox"/>
5. State Oil & Gas Lease No.	

SUNDRY NOTICES AND REPORTS ON WELLS	
(DO NOT USE THIS FORM FOR PROPOSALS TO DRILL OR TO DEEPEN OR PLUG BACK TO A DIFFERENT RESERVOIR. USE "APPLICATION FOR PERMIT -" (FORM C-101) FOR SUCH PROPOSALS.)	
1. OIL WELL <input type="checkbox"/> GAS WELL <input type="checkbox"/> OTHER- DRY HOLE	7. Unit Agreement Name
2. Name of Operator DOME PETROLEUM CORPORATION	8. Farm or Lease Name STATE 2-16-19-5
3. Address of Operator 501 Airport Drive, Suite 107, Farmington, New Mexico 87401	9. Well No. 2
4. Location of Well UNIT LETTER <u>AH</u> 2310 FEET FROM THE NORTH LINE AND 330 FEET FROM THE EAST LINE, SECTION 16 TOWNSHIP 19N RANGE 5W NMPM.	10. Field and Pool, or Wildcat PAPERS WASH - ENTRADA
15. Elevation (Show whether DF, RT, GR, etc.) 5678 GR	12. County MCKINLEY

16. Check Appropriate Box To Indicate Nature of Notice, Report or Other Data	
NOTICE OF INTENTION TO:	SUBSEQUENT REPORT OF:
PERFORM REMEDIAL WORK <input type="checkbox"/> TEMPORARILY ABANDON <input type="checkbox"/> PULL OR ALTER CASING <input type="checkbox"/> OTHER <input type="checkbox"/>	REMEDIAL WORK <input type="checkbox"/> COMMENCE DRILLING OPNS. <input type="checkbox"/> CASING TEST AND CEMENT JOBS <input type="checkbox"/> OTHER <input type="checkbox"/>
PLUG AND ABANDON <input checked="" type="checkbox"/> CHANGE PLANS <input type="checkbox"/>	ALTERING CASING <input type="checkbox"/> PLUG AND ABANDONMENT <input type="checkbox"/>

17. Describe Proposed or Completed Operations (Clearly state all pertinent details, and give pertinent dates, including estimated date of starting any proposed work. SEE RULE 1103.)

Dome Petroleum Corp. proposes to plug and abandon the above well as follows:

- 1) Pull and lay down rods and pump. Pull and stand back tubing.
- 2) Tally in hole with tubing to PBTD at 5312'. Spot cement plugs in 7" casing as follows:

DEPTH	SACKS CEMENT
5312-5050	55 SX
4250-4200 4100	10 SX
3210-3110	20 SX
2900-2850	10 SX
1450-1400	10 SX
150 - surface	30 SX

Plugs to be class "B" cement with 2% CaCl and 1/4# Floseal/sack.

- 3) Cut off casing at ground level and erect dry hole marker.

VERBAL APPROVAL RECEIVED FROM MR. FRANK CHAVEZ ON 05/24/79.



18. I hereby certify that the information above is true and complete to the best of my knowledge and belief.

SIGNED H. D. HOLLINGSWORTH DRILLING FOREMAN DATE July 19, 1979

APPROVED BY FRANK I. CHAVEZ DEPUTY OIL & GAS INSPECTOR, DIST. #3 DATE JUL 23 1979

CONDITIONS OF APPROVAL, IF ANY:

Second plug to be set or shown corrected

NO. OF COPIES RECEIVED 6
 DISTRIBUTION
 SANTA FE 1
 FILE 1
 U.S.G.S.
 LAND OFFICE
 OPERATOR 4

NEW MEXICO OIL CONSERVATION COMMISSION

Form C-103
 Supersedes Old
 C-102 and C-103
 Effective 1-1-65

5a. Indicate Type of Lease
 State ☒ Fee ☐
 5. State Oil & Gas Lease No.

SUNDRY NOTICES AND REPORTS ON WELLS

(DO NOT USE THIS FORM FOR PROPOSALS TO DRILL OR TO DEEPEN OR PLUG BACK TO A DIFFERENT RESERVOIR. USE "APPLICATION FOR PERMIT -" FORM C-101 FOR SUCH PROPOSALS.)

1. OIL WELL <input type="checkbox"/> GAS WELL <input type="checkbox"/> OTHER <input checked="" type="checkbox"/> DRY HOLE	7. Unit Agreement Name
2. Name of Operator DOME PETROLEUM CORPORATION	8. Farm or Lease Name STATE 16-19-5
3. Address of Operator 501 Airport Drive, Suite 107, Farmington, New Mexico 87401	9. Well No. 2
4. Location of Well UNIT LETTER <u>H</u> <u>2310</u> FEET FROM THE <u>NORTH</u> LINE AND <u>330</u> FEET FROM THE <u>EAST</u> LINE, SECTION <u>16</u> TOWNSHIP <u>19N</u> RANGE <u>5W</u> N.M.P.M.	10. Field and Pool, or Wildcat
15. Elevation (Show whether DF, RT, GR, etc.) 5678' GR	12. County MCKINLEY

Check Appropriate Box To Indicate Nature of Notice, Report or Other Data

NOTICE OF INTENTION TO:

PERFORM REMEDIAL WORK ☐
 TEMPORARILY ABANDON ☐
 PULL OR ALTER CASING ☐
 OTHER ☐
 PLUG AND ABANDON ☐
 CHANGE PLANS ☐

SUBSEQUENT REPORT OF:

REMEDIAL WORK ☐
 COMMENCE DRILLING OPNS. ☐
 CASING TEST AND CEMENT JOB ☐
 OTHER SURFACE RECLAMATION ☒
 ALTERING CASING ☐
 PLUG AND ABANDONMENT ☐

17. Describe Proposed or Completed Operations (Clearly state all pertinent details, and give pertinent dates, including estimated date of starting any proposed work) SEE RULE 1103.

The surface reclamation on the above location has been completed and is ready for inspection. The pits have been backfilled, location cleaned up, contoured, to conform to surrounding terrain, reseeded in compliance with BLM stipulations.

18. I hereby certify that the information above is true and complete to the best of my knowledge and belief.

SIGNED A. R. Kendrich TITLE DRILLING FOREMAN DATE September 5, 1979

SUPERVISOR DISTRICT # 3

Original Signed by A. R. Kendrich

APPROVED BY _____ DATE SEP 6 1979

CONDITIONS OF APPROVAL, IF ANY:

SUNDRY NOTICES AND REPORTS ON WELLS			
<small>(DO NOT USE THIS FORM FOR PROPOSALS TO DRILL OR TO DEEPEN OR PLUG BACK TO A DIFFERENT RESERVOIR. USE "APPLICATION FOR PERMIT --" (FORM C-101) FOR SUCH PROPOSALS.)</small>			
OIL WELL <input checked="" type="checkbox"/> GAS WELL <input type="checkbox"/> OTHER- <input type="checkbox"/>		7. Unit Agreement Name	
Name of Operator		8. Farm or Lease Name	
ome Petroleum Corp.		State 2-16-19-5	
Address of Operator		9. Well No.	
% K&A, Inc. Minerals Management, 501 Airport Dr.		1	
uite 105, Farmington, New Mexico 87401		2	
Location of Well		10. Field and Pool, or Wildcat	
UNIT LETTER H 2310 FEET FROM THE North LINE AND 330 FEET FROM		Papers Wash-Entrada	
THE East LINE, SECTION 16 TOWNSHIP 19N RANGE 5W NMPM.			
15. Elevation (Show whether DF, RT, GR, etc.)		12. County	
5678' GR. 5690' KB		McKinley	

Check Appropriate Box To Indicate Nature of Notice, Report or Other Data	
<p>NOTICE OF INTENTION TO:</p> <div style="display: flex; justify-content: space-between;"> <div style="width: 45%;"> <p>PERFORM REMEDIAL WORK <input type="checkbox"/></p> <p>TEMPORARILY ABANDON <input checked="" type="checkbox"/></p> <p>DRILL OR ALTER CASING <input type="checkbox"/></p> <p>OTHER _____ <input type="checkbox"/></p> </div> <div style="width: 45%;"> <p>PLUG AND ABANDON <input type="checkbox"/></p> <p>CHANGE PLANS <input type="checkbox"/></p> </div> </div>	<p>SUBSEQUENT REPORT OF:</p> <div style="display: flex; justify-content: space-between;"> <div style="width: 45%;"> <p>REMEDIAL WORK <input checked="" type="checkbox"/></p> <p>COMMENCE DRILLING OPNS. <input type="checkbox"/></p> <p>CASING TEST AND CEMENT JQB <input type="checkbox"/></p> <p>OTHER _____ <input type="checkbox"/></p> </div> <div style="width: 45%;"> <p>ALTERING CASING <input type="checkbox"/></p> <p>PLUG AND ABANDONMENT <input type="checkbox"/></p> </div> </div>

Describe Proposed or Completed Operations (Clearly state all pertinent details, and give pertinent dates, including estimated date of starting any proposed work) SEE RULE 1103.

3-15-78 to 4-12-78 Pump tested well. Average 3.5 BO, 26 BW
4-21-78 to 5-8-78 Waiting on pulling unit.
5-9-78 Pulled rods and tubing.
5-10-78 Ran packer and acidizee with 1000 gal. 15% HCL
5-11-78 Ran 2 7/8" tubing to 4500'.
5-12-78 to 6-19-78 Pump tested 100% water.
6-19-78 Shut down. Temporarily Abandoned.

TEMPORARY ABANDONMENT
EXPIRES JUN 1 1979



I hereby certify that the information above is true and complete to the best of my knowledge and belief.

 K & A, Inc. Minerals Management
 Area Manager

TITLE _____ DATE 6-21-78

PROVED BY AK Kendrick TITLE SUPERVISOR DIST. #3 DATE JUN 22 1978

CONDITIONS OF APPROVAL, IF ANY:

11- R. Robinson 11- M. McDonough 11- full