

RECEIVED 5
 CONTRIBUTION
 SANTA FE
 FILE
 DIVISION
 LAND OFFICE
 OPERATOR 1

NEW MEXICO OIL CONSERVATION COMMISSION

30-031-20539

Form 7-14
 Revised 11-77

14. Indicate Type of Lease
 STATE ☐ FEE ☒

15. State Oil & Gas Lease No.
 --

APPLICATION FOR PERMIT TO DRILL, DEEPEN, OR PLUG BACK

1a. Type of Work
 b. Type of Well
 DRILL ☒ DEEPEN ☐ PLUG BACK ☐
 OIL WELL ☒ GAS WELL ☐ OTHER ☐
 c. Name of Operator
 PETROLEUM DEVELOPMENT CORPORATION
 d. Address of Operator
 9720 B Candelaria, NE, Albuquerque, New Mexico 87112
 e. Location of Well
 UNIT LETTER C LOCATED 1650 FEET FROM THE West LINE
 AND 330 FEET FROM THE North LINE OF SEC. 19 TWP. 16N RGE. 9W NMPM
 7. Unit Agreement Name
 --
 8. Farm or Lease Name
 Lee-19
 9. Well No.
 1
 10. Field and Pool, or Wildcat
 Marcellina Dakota
 12. County
 McKinley
 13. Proposed Depth
 1900
 15A. Formation
 Dakota
 20. Rotary or C.T.
 Rotary
 21. Elevations (Show whether DF, RT, etc.)
 7207 GL
 21A. Kind & Status Plug, Bond
 Blanket - active
 21B. Drilling Contractor
 Gene Wilson
 22. Approx. Date Work will start
 July 12, 1978

PROPOSED CASING AND CEMENT PROGRAM

SIZE OF HOLE	SIZE OF CASING	WEIGHT PER FOOT	SETTING DEPTH	SACKS OF CEMENT	EST. TOP
11"	8-5/8"	24#	100'	50	Circ. to surface
6 1/4"	4-1/2"	9.5#	1900'	325	Circ. to surface

Set 8-5/8" 24# casing at approximately 100'. WOC 8 hrs. Pressure test to 600# for 30 minutes.

After logging at TD approximately 1900', set 4-1/2" 9.5# casing. WOC 24 hrs. Pressure test to 600# for 30 minutes.

Complete by jet perforating Dakota "A" Zone, or other zones of interest. Acidize and/or frac as need is indicated.

10-22-78

IN ABOVE SPACE DESCRIBE PROPOSED PROGRAM: IF PROPOSAL IS TO DEEPEN OR PLUG BACK, GIVE DATA ON PRESENT PRODUCTIVE ZONE AND PROPOSED NEW PRODUCTIVE ZONE. GIVE BLOWOUT PREVENTER PROGRAM, IF ANY.

I hereby certify that the information above is true and complete to the best of my knowledge and belief.

Signed Frank S. Chang Title Vice President Date 7-5-78

(This space for State Use)

APPROVED BY Frank S. Chang TITLE Vice President DATE 7-5-78

CONDITIONS OF APPROVAL, IF ANY:

NEW MEXICO OIL CONSERVATION COMMISSION
WELL LOCATION AND ACREAGE DEDICATION PLAT

Form O-101
Supersedes O-122
Effective 1-4-65

All distances must be from the outer boundaries of the Section.

Operator PETROLEUM DEVELOPMENT CORPORATION		Lease Lee #19		Well No. 1
Unit Letter C	Section 19	Township 16 North	Range 9 West	County McKinley
Actual Footage Location of Well: 330 feet from the North line and 1650 feet from the West line				
Ground Level Elev. 7207	Producing Formation Dakota	Pool Marcellina Dakota	Dedicated Acreage: 40 Acres	

1. Outline the acreage dedicated to the subject well by colored pencil or hachure marks on the plat below.
2. If more than one lease is dedicated to the well, outline each and identify the ownership thereof (both as to working interest and royalty).
3. If more than one lease of different ownership is dedicated to the well, have the interests of all owners been consolidated by communitization, unitization, force-pooling, etc?

☐ Yes ☒ No If answer is "yes," type of consolidation _____

If answer is "no," list the owners and tract descriptions which have actually been consolidated. (Use reverse side of this form if necessary.) _____

No allowable will be assigned to the well until all interests have been consolidated (by communitization, unitization, forced-pooling, or otherwise) or until a non-standard unit, eliminating such interests, has been approved by the Commission.

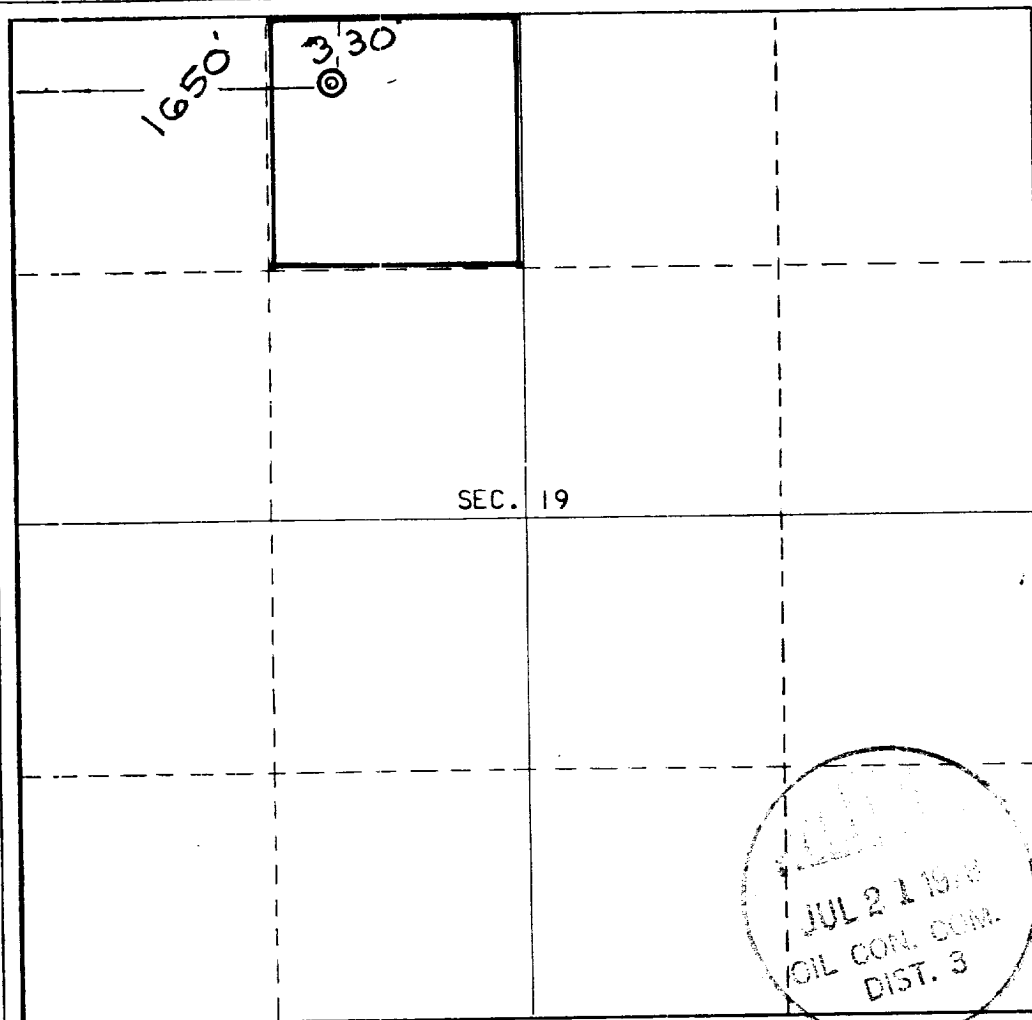

CERTIFICATION

I hereby certify that the information contained herein is true and complete to the best of my knowledge and belief.

CHARLES W. SANDERS

Name

Vice President

Position

Petroleum Development Corp.

Company

7/19/78

Date

Charles W. Sanders

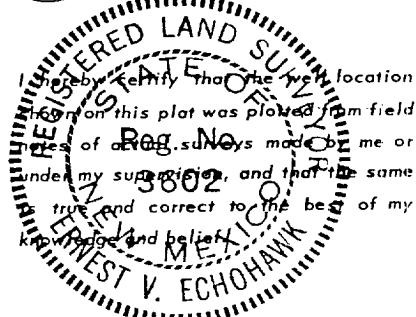

Date Surveyed

July 6, 1978

Registered Professional Engineer and/or Land Surveyor

E.V. Echohawk

Certificate No. **3602**

E.V. Echohawk LS

