

NO. OF COPIES RECEIVED	5
DISTRIBUTION	
SANTA FE	1
FILE	1
U.S.G.S.	2
LAND OFFICE	
OPERATOR	1

# NEW MEXICO OIL CONSERVATION COMMISSION

30-031-20540  
Form C-101  
Revised 1-1-65

5A. Indicate Type of Lease	
STATE <input type="checkbox"/>	FEE <input checked="" type="checkbox"/>
5. State Oil & Gas Lease No.	

## APPLICATION FOR PERMIT TO DRILL, DEEPEN, OR PLUG BACK

1a. Type of Work		7. Unit Agreement Name	
b. Type of Well DRILL <input checked="" type="checkbox"/> DEEPEN <input type="checkbox"/> PLUG BACK <input type="checkbox"/> OIL WELL <input checked="" type="checkbox"/> GAS WELL <input type="checkbox"/> OTHER <input type="checkbox"/> SINGLE ZONE <input type="checkbox"/> MULTIPLE ZONE <input type="checkbox"/>		8. Farm or Lease Name SFPRR	
2. Name of Operator Northern Minerals, Inc.		9. Well No. 28	
3. Address of Operator P. O. Box 2182, Santa Fe, New Mexico 87501		10. Field and Pool, or Wildcat Miguel Creek-Gallup	
4. Location of Well UNIT LETTER B LOCATED 990 FEET FROM THE North LINE AND 1650 FEET FROM THE East LINE OF SEC. 20 TWP. 16N RGE. 6W NMPM		12. County McKinley	
19. Proposed Depth 1200		19A. Formation Miguel Creek-Gallup	20. Rotary or C.T. Rotary
21. Elevations (Show whether DF, RT, etc.) 6725.17 Feet G. L	21A. Kind & Status Plug. Bond Statewide	21B. Drilling Contractor Chesney Drilling Co.	22. Approx. Date Work will start Upon Approval

23.

## PROPOSED CASING AND CEMENT PROGRAM

SIZE OF HOLE	SIZE OF CASING	WEIGHT PER FOOT	SETTING DEPTH	SACKS OF CEMENT	EST. TOP
6-1/4"	4-1/2"	9 lb.	1200	Suff. to Circ.	1170

This well will be a Miguel Creek-Gallup field development well.  
Casing will be run and well completed in the field sand.

APPROVAL VALID  
FOR 90 DAYS UNLESS  
RENEWED COMMENCED,

EXPIRES 10-25-78

IN ABOVE SPACE DESCRIBE PROPOSED PROGRAM: IF PROPOSAL IS TO DEEPEN OR PLUG BACK, GIVE DATA ON PRESENT PRODUCTIVE ZONE AND PROPOSED NEW PRODUCTIVE ZONE. GIVE BLOWOUT PREVENTER PROGRAM, IF ANY.

I hereby certify that the information above is true and complete to the best of my knowledge and belief.

Signed Lloyd Davidson Title President Date 7-26-78

(This space for State Use)

APPROVED BY Frank J. Chang TITLE DEPUTY OIL & GAS INSPECTOR, DIST. #3 DATE JUL 27 1978

CONDITIONS OF APPROVAL, IF ANY:

NEW MEXICO OIL CONSERVATION COMMISSION  
WELL LOCATION AND ACREAGE DEDICATION PLAT

Form C-102  
Supersedes C-128  
Effective 1-1-65

All distances must be from the outer boundaries of the Section.

Operator <b>Northern Minerals, Inc.</b>			Lease <b>Santa Fe Pacific Railroad</b>		Well No. <b>28</b>
Unit Letter <b>B</b>	Section <b>20</b>	Township <b>16 N</b>	Range <b>6 W</b>	County <b>McKinley</b>	
Actual Footage Location of Well: <b>990</b> feet from the <b>North</b> line and <b>1650</b> feet from the <b>East</b> line					
Ground Level Elev. <b>6725.17</b>	Producing Formation <b>Miguel Creek-Gallup</b>	Pool <b>Miguel Creek-Gallup ext</b>		Dedicated Acreage: <b>40</b> Acres	

1. Outline the acreage dedicated to the subject well by colored pencil or hachure marks on the plat below.
2. If more than one lease is dedicated to the well, outline each and identify the ownership thereof (both as to working interest and royalty).
3. If more than one lease of different ownership is dedicated to the well, have the interests of all owners been consolidated by communitization, unitization, force-pooling, etc?

☐ Yes ☐ No If answer is "yes," type of consolidation \_\_\_\_\_

If answer is "no," list the owners and tract descriptions which have actually been consolidated. (Use reverse side of this form if necessary.) \_\_\_\_\_

No allowable will be assigned to the well until all interests have been consolidated (by communitization, unitization, forced-pooling, or otherwise) or until a non-standard unit, eliminating such interests, has been approved by the Commission.

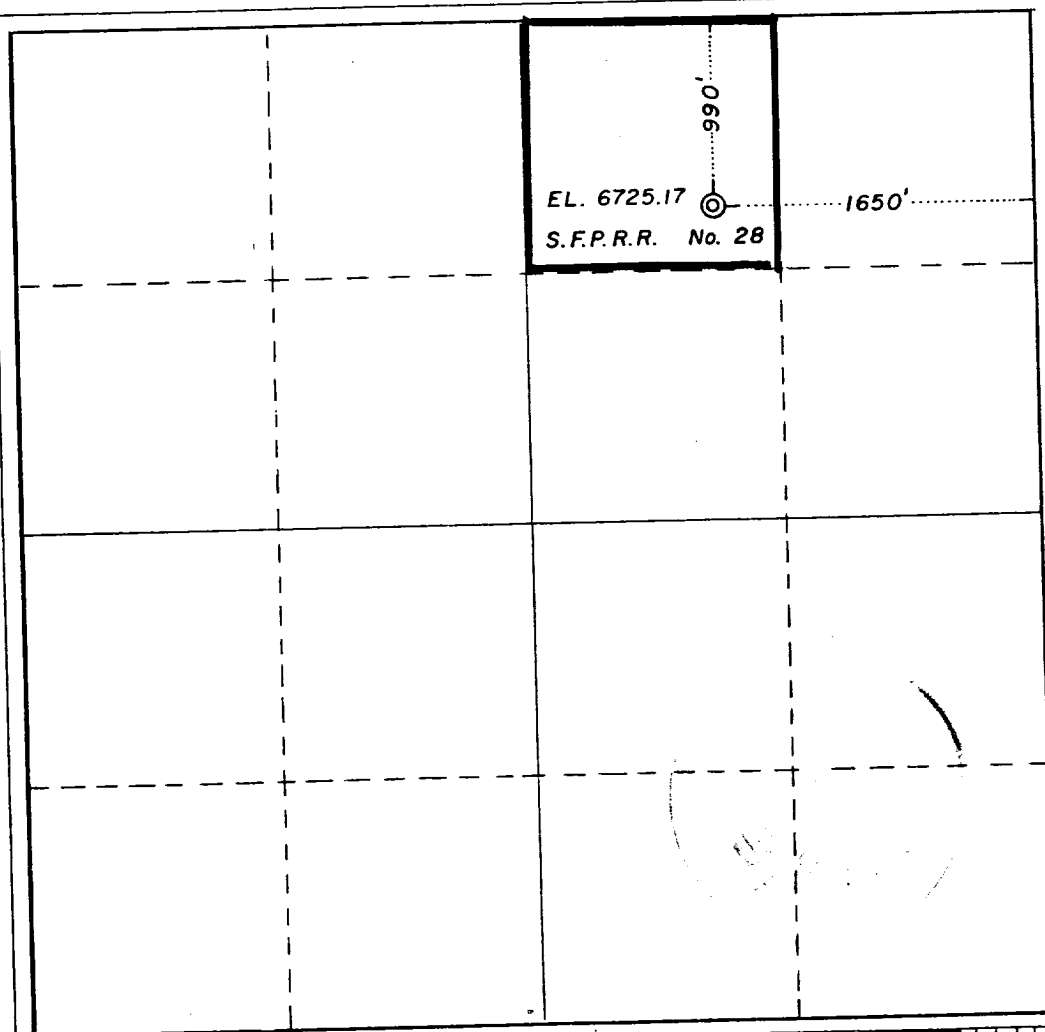

CERTIFICATION

I hereby certify that the information contained herein is true and complete to the best of my knowledge and belief.

Name Lloyd Davidson  
Position President  
Company Northern Minerals, Inc.  
Date July 26, 1978

I hereby certify that the well location shown on this plat was plotted from field notes of actual surveys made by me or under my supervision, and that the same is true and correct to the best of my knowledge and belief.

Date Surveyed July - 19, 1977  
Registered Professional Engineer and/or Land Surveyor

Wesley J. Matheson  
Certificate No. 2031

