

NEW MEXICO OIL AND GAS COMMISSION
WELL LOCATION AND ACREAGE DEDICATION PLAT

Supersedes Form
Effective 1-1-65

All distances must be from the outer boundaries of the Section.

Operator Petco Petroleum Development Corp.		Lease Lee 19		Well No. 1-Y	
Unit Letter C	Section 19	Township 16 North	Range 9 West	County McKinley	
Actual Footage Location of Well: 430 feet from the North line and 1750 feet from the West line					
Ground Level Elev. 7200	Producing Formation Dakota		Pool Marcelling - Dakota		Dedicated Acreage: 40 Acres

1. Outline the acreage dedicated to the subject well by colored pencil or hachure marks on the plat below.
2. If more than one lease is dedicated to the well, outline each and identify the ownership thereof (both as to working interest and royalty).
3. If more than one lease of different ownership is dedicated to the well, have the interests of all owners been consolidated by communitization, unitization, force-pooling, etc?

☐ Yes ☐ No If answer is "yes," type of consolidation _____

If answer is "no," list the owners and tract descriptions which have actually been consolidated. (Use reverse side of this form if necessary.) _____

No allowable will be assigned to the well until all interests have been consolidated (by communitization, unitization, forced-pooling, or otherwise) or until a non-standard unit, eliminating such interests, has been approved by the Commission.

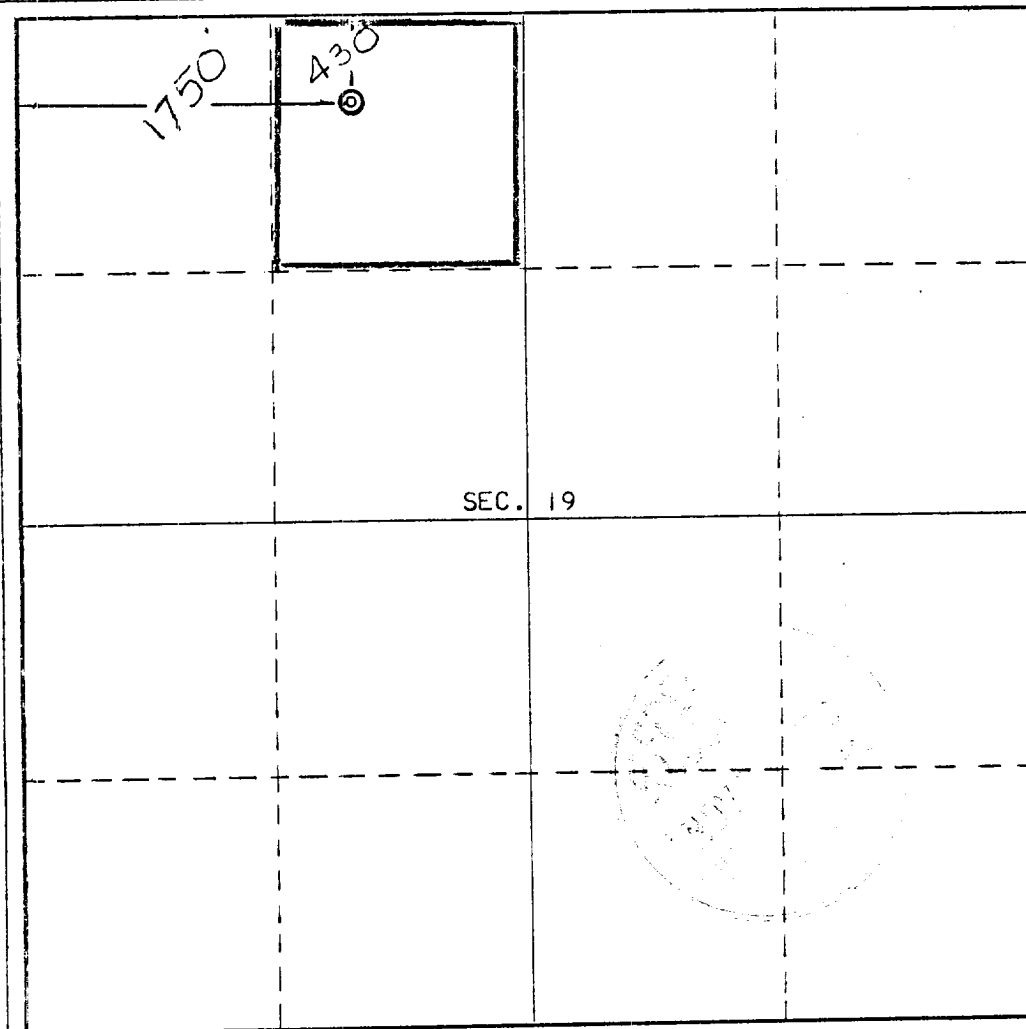

CERTIFICATION

I hereby certify that the information contained herein is true and complete to the best of my knowledge and belief.

Name _____

Position _____

Company _____

Date _____

I hereby certify that the well location shown on this plat was plotted from field notes of actual surveys made by me or under my supervision, and that the same is true and correct to the best of my knowledge and belief.

Date Surveyed _____

November 23, 1978

Registered Professional Engineer
and/or Land Surveyor

E.V. Echoshawk

Certificate No. **3602**

E.V. Echoshawk LS

0 330 660 990 1320 1650 1980 2310 2640 2000 1500 1000 500 0