

NO. OF COPIES RECEIVED	5
DISTRIBUTION	
SANTA FE	1
FILE	2
U.S.G.S.	2
LAND OFFICE	
OPERATOR	1

NEW MEXICO OIL CONSERVATION COMMISSION

30-031-20565
Form C-101
Revised 1-1-65

5A. Indicate Type of Lease	
STATE <input type="checkbox"/>	FEE <input checked="" type="checkbox"/>
5. State Oil & Gas Lease No.	

APPLICATION FOR PERMIT TO DRILL, DEEPEN, OR PLUG BACK

1a. Type of Work				7. Unit Agreement Name	
b. Type of Well OIL WELL <input checked="" type="checkbox"/> GAS WELL <input type="checkbox"/> OTHER <input type="checkbox"/>				8. Farm or Lease Name Santa Fe Pacific	
2. Name of Operator Colorado Plateau Geological Services, Inc.				9. Well No. 47	
3. Address of Operator P.O. Box 537, Farmington, New Mexico 87401				10. Field and Pool, or Wildcat Red Mountain MV	
4. Location of Well UNIT LETTER 0 LOCATED 580 FEET FROM THE South LINE AND 1400 FEET FROM THE East LINE OF SEC. 20 TWP. 20N RGE. 9W NMPM				12. County McKinley	
19. Proposed Depth 435		19A. Formation Mesaverde		20. Rotary or C.T. Rotary	
21. Elevations (Show whether DF, RT, etc.) 6466 GR		21A. Kind & Status Plug. Bond One well \$5000		22. Approx. Date Work will start 5/1/79	

23. PROPOSED CASING AND CEMENT PROGRAM

SIZE OF HOLE	SIZE OF CASING	WEIGHT PER FOOT	SETTING DEPTH	SACKS OF CEMENT	EST. TOP
6-1/4"	4-1/2"	10.50#	420	20	220'

We propose to drill a 6-1/4" hole to approximately 435 feet to test the Red Mountain Mesaverde pay zone in this established field. We will run 4-1/2" casing to approximately 420 feet and cement. Completion will be through open hole approximately 420'-435'.

APPROVAL VALID
FOR 90 DAYS WITHOUT
PAYING FEE

EXPIRES 7-29-79



IN ABOVE SPACE DESCRIBE PROPOSED PROGRAM: IF PROPOSAL IS TO DEEPEN OR PLUG BACK, GIVE DATA ON PRESENT PRODUCTIVE ZONE AND PROPOSED NEW PRODUCTIVE ZONE. GIVE BLOWOUT PREVENTER PROGRAM, IF ANY.

I hereby certify that the information above is true and complete to the best of my knowledge and belief.

Signed Mark E. Weddle Title Vice President Date 4/25/79

(This space for State Use)

APPROVED BY Frank S. Chang TITLE DEPUTY OIL & GAS INSPECTOR, DIST. #3 DATE APR 30 1979

CONDITIONS OF APPROVAL, IF ANY:

Oil & Gas Commission

**NEW MEXICO OIL CONSERVATION COMMISSION
WELL LOCATION AND ACREAGE DEDICATION PLAT**

Form C-102
Supersedes C-128
Effective 1-1-65

All distances must be from the outer boundaries of the Section.

Operator Colorado Plateau Geological Serv. Inc.			Lease Santa Fe Pacific		Well No. 47
Unit Letter 0	Section 20	Township 20N	Range 9W	County McKinley	
Actual Footage Location of Well: 580 feet from the South line and 1400 feet from the East line					
Ground Level Elev. 6466	Producing Formation Mesaverde		Pool Red Mountain		Dedicated Acreage: 40 Acres

1. Outline the acreage dedicated to the subject well by colored pencil or hachure marks on the plat below.
2. If more than one lease is dedicated to the well, outline each and identify the ownership thereof (both as to working interest and royalty).
3. If more than one lease of different ownership is dedicated to the well, have the interests of all owners been consolidated by communitization, unitization, force-pooling, etc?

☐ Yes ☐ No If answer is "yes," type of consolidation _____

If answer is "no," list the owners and tract descriptions which have actually been consolidated. (Use reverse side of this form if necessary.) _____

No allowable will be assigned to the well until all interests have been consolidated (by communitization, unitization, forced-pooling, or otherwise) or until a non-standard unit, eliminating such interests, has been approved by the Commission.

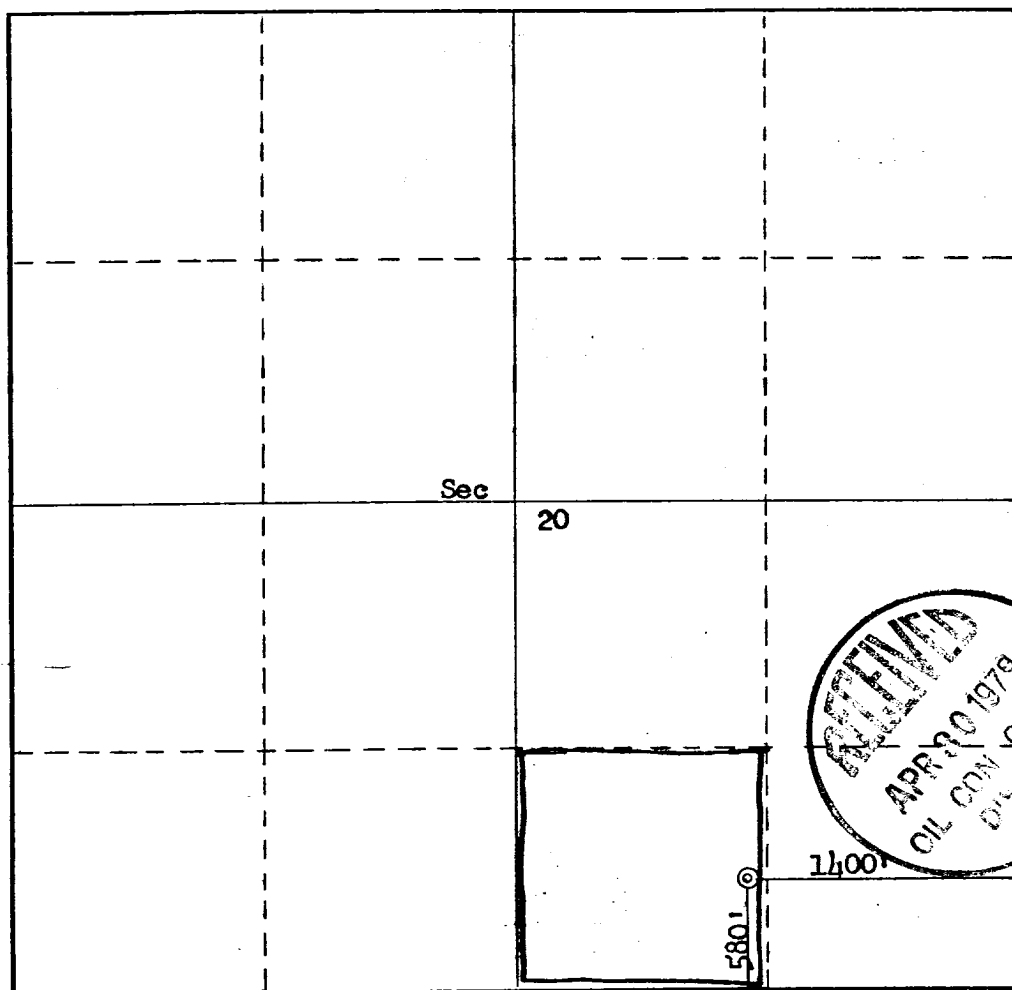

CERTIFICATION

I hereby certify that the information contained herein is true and complete to the best of my knowledge and belief.

Name Mark E. Waddle
Position Vice President
Company Colo. Plateau Geo. Serv., Inc.
Date 4/25/79

I hereby certify that the well location shown on this plat was plotted from field notes of actual surveys made by me or under my supervision, and that the same is true and correct to the best of my knowledge and belief.

Date Surveyed September 12, 1974
Registered Professional Engineer and/or Land Surveyor Fred B. Kerr Jr.
Certificate No. 3950

