

NO. OF COPIES RECEIVED	6
DISTRIBUTION	
SANTA FE	1
FILE	1
U.S.G.S.	2
LAND OFFICE	1
OPERATOR	1

NEW MEXICO OIL CONSERVATION COMMISSION

30-031-20572
Form O-101
Revised 1-4-65

5A. Indicate Type of Lease	
STATE <input checked="" type="checkbox"/>	FED <input type="checkbox"/>
5. State Oil & Gas Lease No.	
-112	

APPLICATION FOR PERMIT TO DRILL, DEEPEN, OR PLUG BACK			
1a. Type of Work		7. Unit Agreement Name	
b. Type of Well DRILL <input checked="" type="checkbox"/> DEEPEN <input type="checkbox"/> PLUG BACK <input type="checkbox"/> OIL WELL <input checked="" type="checkbox"/> GAS WELL <input type="checkbox"/> OTHER <input type="checkbox"/> SINGLE ZONE <input checked="" type="checkbox"/> MULTIPLE ZONE <input type="checkbox"/>		8. Farm or Lease Name	
2. Name of Operator		9. Well No.	
3. Address of Operator		10. Field and Pool, or Wildcat	
4. Location of Well UNIT LETTER _____ LOCATED <u>525</u> FEET FROM THE <u>North</u> LINE AND <u>495</u> FEET FROM THE <u>West</u> LINE OF SEC. <u>32</u> TWP. <u>20</u> RGE. <u>8</u> NMPM		12. County	
19. Proposed Depth		19A. Formation	20. Rotary or C.T.
21. Elevations (Show whether DE, RT, etc.)		21A. Kind & Status Plug. Bond	21B. Drilling Contractor
6,500		slatent road	11-1-79
22. Approx. Date Work will start		1979	

PROPOSED CASING AND CEMENT PROGRAM

SIZE OF HOLE	SIZE OF CASING	WEIGHT PER FOOT	SETTING DEPTH	SACKS OF CEMENT	EST. TOP
8 1/2	8 1/2	2.0	2.00	2.00	ft.

11-1-79

APPROVAL VALID
FOR 90 DAYS OF THE
DRILLING OF THE WELL

EXPIRES 11-1-79



IN ABOVE SPACE DESCRIBE PROPOSED PROGRAM: IF PROPOSAL IS TO DEEPEN OR PLUG BACK, GIVE DATA ON PRESENT PRODUCTIVE ZONE AND PROPOSED NEW PRODUCTIVE ZONE. GIVE BLOWOUT PREVENTER PROGRAM, IF ANY.

I hereby certify that the information above is true and complete to the best of my knowledge and belief.

Signed Louis M. Wynne Title owner Date Aug 3 1979

(This space for State Use)
APPROVED BY Frank S. Chang TITLE DEPUTY OIL & GAS INSPECTOR, DIST. #3 DATE AUG 3 1979
CONDITIONS OF APPROVAL, IF ANY:

NEW MEXICO OIL CONSERVATION COMMISSION

WELL LOCATION AND ACERAGE DEDICATION PLAT

All distances must be from the outer boundaries of the Section

Operator LOUIS M. WYMAN		Lease Jaco		Well No. 62
Unit Letter A	Section 32	Township 20 NORTH	Range 9 WEST	County McKINLEY
Actual Footage Location of Well: 825 feet from the NORTH line and 495 feet from the WEST line				
Ground Level Elev. 6506	Producing Formation	Pool	Dedicated Acreage: Acres	

1. Outline the acreage dedicated to the subject well by colored pencil or hachure marks on the plat below.
2. If more than one lease is dedicated to the well, outline each and identify the ownership thereof (both as to working interest and royalty).
3. If more than one lease of different ownership is dedicated to the well, have the interests of all owners been consolidated by communitization, unitization, force-pooling, etc?

() Yes () No If answer is "yes," type of consolidation

If answer is "no," list the owners and tract descriptions which have actually consolidated. (Use reverse side of this form if necessary.)

No allowable will be assigned to the well until all interests have been consolidated (by communitization, unitization, forced-pooling, or otherwise) or until a non standard unit, eliminating such interests, has been approved by the Commission.

CERTIFICATION

I hereby certify that the information contained herein is true and complete to the best of my knowledge and belief.

Name Louis M. Wyman
 Position owner
 Company Wyman Oil
 Date Aug 3 1979

I hereby certify that the well location shown on this plat was plotted from field notes of actual surveys made by me or under my supervision, and that the same is true and correct to the best of my knowledge and belief.

16 August 1979

Date Surveyed

James P. Leese
 Registered Professional Engineer
 and/or Land Surveyor **JAMES P. LEESE**

1463

Certificate No.

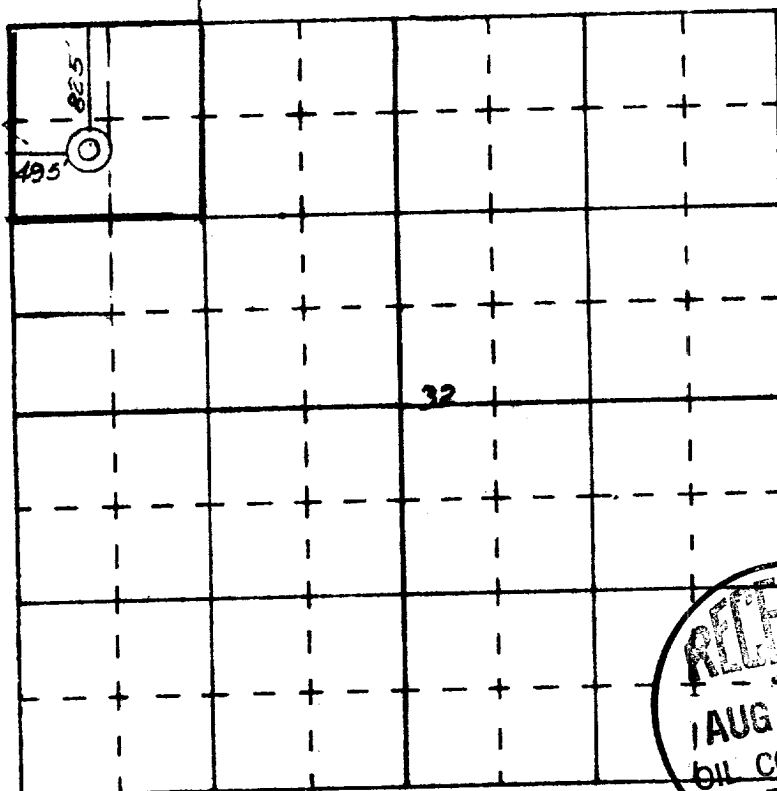

SCALE—4 INCHES EQUALS 1 MILE

SAN JUAN ENGINEERING COMPANY, FARMINGTON, N. M.

